



STATE OF CONNECTICUT  
*CONNECTICUT SITING COUNCIL*

Ten Franklin Square, New Britain, CT 06051

Phone: (860) 827-2935 Fax: (860) 827-2950

E-Mail: [siting.council@ct.gov](mailto:siting.council@ct.gov)

Web Site: [portal.ct.gov/csc](http://portal.ct.gov/csc)

**VIA ELECTRONIC MAIL**

December 8, 2021

Mark Appleby  
Centerline Communications  
750 West Center Street, Floor 3  
West Bridgewater, MA 02379  
[mappleby@clinellc.com](mailto:mappleby@clinellc.com)

RE: **EM-T-MOBILE-062-211026** - T-Mobile notice of intent to modify an existing telecommunications facility located at 150 Willow Street, Hamden, Connecticut.

Dear Mr. Appleby:

The Connecticut Siting Council (Council) is in receipt of your correspondence of December 7, 2021 submitted in response to the Council's December 3, 2021 notification of an incomplete request for exempt modification with regard to the above-referenced matter.

The submission renders the request for exempt modification complete and the Council will process the request in accordance with the Federal Communications Commission 60-day timeframe.

Thank you for your attention and cooperation.

Sincerely,

A handwritten signature in black ink, appearing to read "Melanie Bachman".

Melanie Bachman  
Executive Director

MAB/FOC/laf

**From:** Mark Appleby <mappleby@clinellc.com>

**Sent:** Tuesday, December 7, 2021 2:51 PM

**To:** Robidoux, Evan <Evan.Robidoux@ct.gov>

**Cc:** CSC-DL Siting Council <Siting.Council@ct.gov>; David Barbagallo <dbarbagallo@clinellc.com>

**Subject:** RE: Council Incomplete Letter for EM-T-MOBILE-062-211026 (Willow Street, Hamden)

EXTERNAL EMAIL: This email originated from outside of the organization. Do not click any links or open any attachments unless you trust the sender and know the content is safe.

Evan,

Please find revised exempt-mod application attached with correct generator.



**Mark Appleby** | Site Acquisition Consultant

750 W Center St, Suite 301 | West Bridgewater, MA 02379

Mobile: 860.209.4694 | Fax: 508.819.3017

[mappleby@clinellc.com](mailto:mappleby@clinellc.com) | [www.centerlinecommunications.com](http://www.centerlinecommunications.com)

Centerline Communications  
Mark Appleby  
750 West Center Street, Floor 3  
West Bridgewater, MA 02379  
860-209-4694  
[mappleby@clinellc.com](mailto:mappleby@clinellc.com)

December 7, 2021

Members of the Siting Council  
Connecticut Siting Council  
Ten Franklin Square  
New Britain, CT 06051

Notice of Exempt Modification  
150 Willow Street, Hamden, CT 06410  
Latitude: 41.449392  
Longitude: -72.904572  
T-Mobile Site#: CTNH442A\_Hardening

**EM-T-MOBILE-062-211026**

Dear Ms. Bachman:

T-Mobile currently maintains nine (9) antennas at the 137-foot level of the existing 157-foot monopole tower at 150 Willow Street, Hamden, CT 06410. The 157-foot tower is owned by Vertical Bridge and property is owned by Hamden Fish & Game Protective. T-Mobile now intends to add a 25Kw Generator to its existing concrete pad within the existing compound. No modifications to the tower, antennas or equipment are proposed.

**Planned Modifications**

**Ground:**

Install new:

(1) Generac RD025 25Kw AC Diesel Generator-240 gallon double walled self- containing tank with fuel sensor  
Requires (2) 12- minute run cycles bi-weekly

This facility was approved by the CT Siting Council Docket No.324 on May 10, 2007- 150 Willow Street Hamden, CT with conditions. We used the information from the previous filing. Please see attached.

Please accept this letter as notification pursuant to Regulations of Connecticut State Agencies § 16-50j-73, for construction that constitutes an exempt modification pursuant to R.C.S.A. § 16-50j-72(b)(2). In accordance with R.C.S.A. § 16-50j-73, a copy of this letter is being sent to Mayor Curt B. Leng, Elected Official and Erik Johnson Acting Town Planner for the Town of Hamden, as well as the property owner and the tower owner.

The planned modifications to the facility fall squarely within those activities explicitly provided for in R.C.S.A. § 16-50j-72(b)(2).

1. The proposed modifications will not result in an increase in the height of the existing structure.
2. The proposed modifications will not require the extension of the site boundary.

3. The proposed modifications will not increase noise levels at the facility by six decibels or more, or to levels that exceed state and local criteria.

4. The proposed modifications will not cause a change or alteration in the physical or environmental characteristics of the site.

For the foregoing reasons, T-Mobile respectfully submits that the proposed modifications to the above referenced telecommunications facility constitute an exempt modification under R.C.S.A. § 16-50j-72(b)(2).

Sincerely,

**Mark Appleby**

Mobile: 860-209-4694

Fax: 508-819-3017

Office: 90 Hamilton Ave Southington CT, CT 06489

Email: [mappleby@clinellc.com](mailto:mappleby@clinellc.com)

Attachments

cc: Mayor Curt B. Leng, Town of Hamden -chief elected official  
Erik Johnson Acting Town Planner for the Town of Hamden  
Vertical Bridge - tower owner  
Hamden Fish & Game Protective- property owner

# Exhibit A

Original Facility Approval

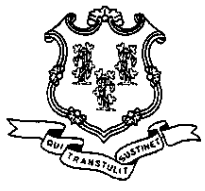

STATE OF CONNECTICUT

CONNECTICUT SITING COUNCIL

Ten Franklin Square, New Britain, CT 06051

Phone: (860) 827-2935 Fax: (860) 827-2950

E-Mail: [siting.council@ct.gov](mailto:siting.council@ct.gov)

Internet: [ct.gov/csc](http://ct.gov/csc)

Daniel F. Caruso  
Chairman

May 10, 2007

Thomas J. Regan, Esq.  
Brown Rudnick Berlack Israels LLP  
CityPlace I, 185 Asylum Street  
Hartford, CT 06103

RE: **DOCKET NO. 324** – Sprint Nextel Corporation application for a Certificate of Environmental Compatibility and Public Need for the construction, maintenance and operation of a wireless telecommunications facility at 150 Willow Street, Hamden, Connecticut.

Dear Attorney Regan:

By its Decision and Order dated May 1, 2007, the Connecticut Siting Council (Council) granted a Certificate of Environmental Compatibility and Public Need (Certificate) for the construction, maintenance and operation of a wireless telecommunications facility at 150 Willow Street, Hamden, Connecticut.

Enclosed are the Council's Certificate, Findings of Fact, Opinion, and Decision and Order.

Very truly yours,

S. Derek Phelps  
Executive Director

SDP/MP/laf

Enclosures (4)



Daniel F. Caruso  
Chairman

# STATE OF CONNECTICUT

## CONNECTICUT SITING COUNCIL

Ten Franklin Square, New Britain, CT 06051

Phone: (860) 827-2935 Fax: (860) 827-2950

E-Mail: [siting.council@ct.gov](mailto:siting.council@ct.gov)

Internet: [ct.gov/csc](http://ct.gov/csc)

May 10, 2007

TO: Parties and Intervenors

FROM: S. Derek Phelps, Executive Director 

RE: **DOCKET NO. 324** – Sprint Nextel Corporation application for a Certificate of Environmental Compatibility and Public Need for the construction, maintenance and operation of a wireless telecommunications facility at 150 Willow Street, Hamden, Connecticut.

---

By its Decision and Order dated May 1, 2007, the Connecticut Siting Council granted a Certificate of Environmental Compatibility and Public Need (Certificate) for the construction, maintenance and operation of a wireless telecommunications facility at 150 Willow Street, Hamden, Connecticut.

Enclosed are the Council's Findings of Fact, Opinion, and Decision and Order.

SDP/MP/laf

Enclosures (3)

c: State Documents Librarian

STATE OF CONNECTICUT )

ss. New Britain, Connecticut :

COUNTY OF HARTFORD )

I hereby certify that the foregoing is a true and correct copy of the Findings of Fact, Opinion, and Decision and Order issued by the Connecticut Siting Council, State of Connecticut.

ATTEST:

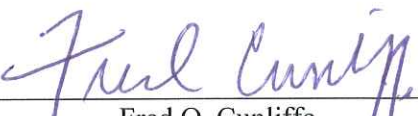
  
\_\_\_\_\_  
Fred O. Cunliffe  
Supervising Siting Analyst  
Connecticut Siting Council

I certify that a copy of the Findings of Fact, Opinion, and Decision and Order in Docket No. 324 has been forwarded by Certified First Class Return Receipt Requested mail on May 10, 2007, to all parties and intervenors of record as listed on the attached service list, dated November 3, 2006.

ATTEST:

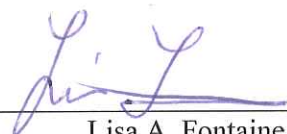
  
\_\_\_\_\_  
Lisa A. Fontaine  
Administrative Assistant  
Connecticut Siting Council



# Exhibit B

Property Card

# 150 WILLOW ST

**Location** 150 WILLOW ST

**Mblu** 3430/ 001/ / /

**Acct#**

**Owner** HAMDEN FISH & GAME  
PROTECTIVE AS

**Assessment** \$367,450

**Appraisal** \$1,028,200

**PID** 18077

**Building Count** 1

## Current Value

Appraisal					
Valuation Year	Building	Extra Features	Outbuildings	Land	Total
2020	\$188,100	\$7,500	\$18,600	\$814,000	\$1,028,200

Assessment					
Valuation Year	Building	Extra Features	Outbuildings	Land	Total
2020	\$131,670	\$5,250	\$13,020	\$217,510	\$367,450

## Owner of Record

**Owner** HAMDEN FISH & GAME PROTECTIVE AS

**Sale Price** \$0

**Co-Owner**

**Certificate**

**Address** P O BOX 5619

**Book & Page** 0232/0049

HAMDEN, CT 06518-0619

**Sale Date** 10/10/1945

**Instrument** 00

## Ownership History

Ownership History					
Owner	Sale Price	Certificate	Book & Page	Instrument	Sale Date
HAMDEN FISH & GAME PROTECTIVE AS	\$0		0232/0049	00	10/10/1945

## Building Information

### Building 1 : Section 1

**Year Built:** 1900

**Living Area:** 3,081

**Building Percent Good:** 60

Building Attributes	
Field	Description

Style:	Clubs/Lodges
Model	Comm/Ind
Grade	C
Stories:	2
Occupancy	1.00
Exterior Wall 1	Vinyl Siding
Exterior Wall 2	
Roof Structure	Gable/Hip
Roof Cover	Asphalt
Interior Wall 1	K PINE/A WD
Interior Wall 2	
Interior Floor 1	Vinyl/Asphalt
Interior Floor 2	
Heating Fuel	Oil
Heating Type	Forced Air-Duc
AC Type	06
Struct Class	
Bldg Use	FISH&GAME
Total Rooms	
Total Bedrms	
Total Baths	
1st Floor Use:	
Heat/AC	NONE
Frame Type	WOOD FRAME
Baths/Plumbing	NONE
Ceiling/Wall	TYPICAL
Rooms/Prtns	LIGHT
Wall Height	8.00
% Comn Wall	

### Building Photo



3430-001-00-0000 04/23/2015

(<http://images.vgsi.com/photos/HamdenCTPhotos/\00\04\38\68.JPG>)

### Building Layout

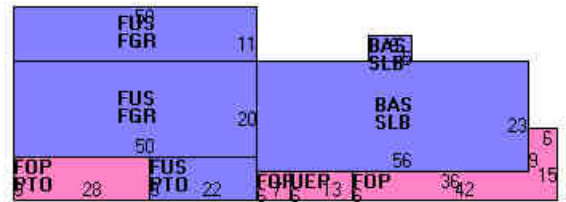

([http://images.vgsi.com/photos/HamdenCTPhotos//Sketches/18077\\_18077](http://images.vgsi.com/photos/HamdenCTPhotos//Sketches/18077_18077))

Building Sub-Areas (sq ft)			Legend	
Code	Description	Gross Area	Living Area	
FUS	Upper Story, Finished	1,748	1,748	
BAS	First Floor	1,333	1,333	
FGR	Garage	1,550	0	
FOP	Porch, Open	600	0	
PTO	Patio	450	0	
SLB	Slab	1,333	0	
UEP	Enclosed Porch, Unfinished	78	0	
		7,092	3,081	

### Extra Features

Extra Features				Legend
Code	Description	Size	Value	Bldg #
FPL1	FIREPLACE AVG	1.00 UNITS	\$2,200	1

A/C	AIR CONDITIONING	1288.00 S.F.	\$3,300	1
FPL	FIREPLACE	1.00 UNITS	\$2,000	1

## Land

### Land Use

**Use Code** 3850  
**Description** FISH&GAME  
**Zone** T1  
**Neighborhood** 130  
**Alt Land Appr** No  
**Category**

### Land Line Valuation

**Size (Acres)** 85.58  
**Frontage** 0  
**Depth** 0  
**Assessed Value** \$217,510  
**Appraised Value** \$814,000

## Outbuildings

Outbuildings						<u>Legend</u>
Code	Description	Sub Code	Sub Description	Size	Value	Bldg #
SHD1	SHED FRAME			740.00 S.F.	\$4,600	1
SHD6	SHED COM MAS			64.00 S.F.	\$700	1
SHD6	SHED COM MAS			360.00 S.F.	\$3,800	1
FGR4	W/LOFT-AVG			576.00 S.F.	\$9,500	1

## Valuation History

Appraisal					
Valuation Year	Building	Extra Features	Outbuildings	Land	Total
2019	\$164,900	\$5,300	\$17,000	\$1,172,000	\$1,359,200
2018	\$164,900	\$5,300	\$17,000	\$1,172,000	\$1,359,200
2017	\$164,900	\$5,300	\$17,000	\$1,172,000	\$1,359,200

Assessment					
Valuation Year	Building	Extra Features	Outbuildings	Land	Total
2019	\$115,430	\$3,710	\$11,900	\$288,530	\$419,570
2018	\$115,430	\$3,710	\$11,900	\$288,530	\$419,570
2017	\$115,430	\$3,710	\$11,900	\$288,530	\$419,570

# Town of Hamden, Connecticut - Assessment Parcel Map

Parcel: 3430-001-00-0000

Address: 150 WILLOW ST

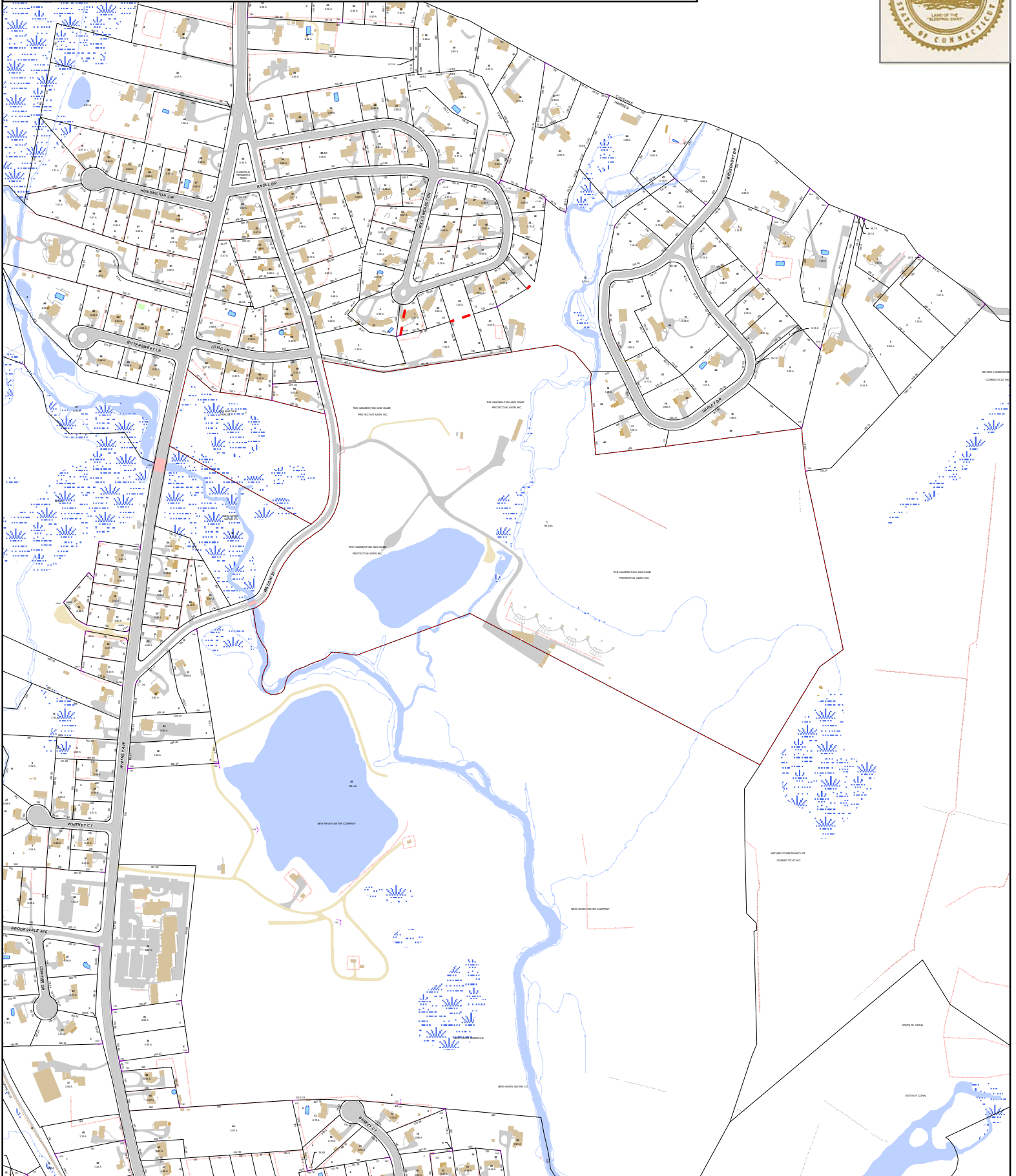

Approximate Scale: 1 inch = 600 feet

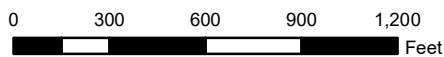

Map Produced: October 2020

Disclaimer: This map is for informational purposes only.  
All information is subject to verification by any user.  
The Town of Hamden and its mapping contractors assume  
no legal responsibility for the information contained herein.

# Exhibit C

Construction Drawings



# GENERAL NOTES

- FOR THE PURPOSE OF CONSTRUCTION DRAWING, THE FOLLOWING DEFINITIONS SHALL APPLY:  
CONTRACTOR - CENTERLINE COMMUNICATIONS  
SUBCONTRACTOR - GENERAL CONTRACTOR (CONSTRUCTION)  
OWNER - T-MOBILE
- PRIOR TO THE SUBMISSION OF BIDS, THE BIDDING SUBCONTRACTOR SHALL VISIT THE CELL SITE TO FAMILIARIZE WITH THE EXISTING CONDITIONS AND TO CONFIRM THAT THE WORK CAN BE ACCOMPLISHED AS SHOWN ON THE CONSTRUCTION DRAWINGS. ANY DISCREPANCY FOUND SHALL BE BROUGHT TO THE ATTENTION OF CONTRACTOR.
- ALL MATERIALS FURNISHED AND INSTALLED SHALL BE IN STRICT ACCORDANCE WITH ALL APPLICABLE CODES, REGULATIONS, AND ORDINANCES. SUBCONTRACTOR SHALL ISSUE ALL APPROPRIATE NOTICES AND COMPLY WITH ALL LAWS, ORDINANCES, RULES, REGULATIONS, AND LAWFUL ORDERS OF ANY PUBLIC AUTHORITY REGARDING THE PERFORMANCE OF THE WORK. ALL WORK CARRIED OUT SHALL COMPLY WITH ALL APPLICABLE MUNICIPAL AND UTILITY COMPANY SPECIFICATIONS AND LOCAL JURISDICTIONAL CODES, ORDINANCES AND APPLICABLE REGULATIONS.
- DRAWINGS PROVIDED HERE ARE NOT TO BE SCALED AND ARE INTENDED TO SHOW OUTLINE ONLY.
- UNLESS NOTED OTHERWISE, THE WORK SHALL INCLUDE FURNISHING MATERIALS, EQUIPMENT, APPURTENANCES, AND LABOR NECESSARY TO COMPLETE ALL INSTALLATIONS AS INDICATED ON THE DRAWINGS.
- "KITTING LIST" SUPPLIED WITH THE BID PACKAGE IDENTIFIES ITEMS THAT WILL BE SUPPLIED BY CONTRACTOR. ITEMS NOT INCLUDED IN THE BILL OF MATERIALS AND KITTING LIST SHALL BE SUPPLIED BY THE SUBCONTRACTOR.
- THE SUBCONTRACTOR SHALL INSTALL ALL EQUIPMENT AND MATERIALS IN ACCORDANCE WITH MANUFACTURER'S RECOMMENDATIONS UNLESS SPECIFICALLY STATED OTHERWISE.
- IF THE SPECIFIED EQUIPMENT CANNOT BE INSTALLED AS SHOWN ON THESE DRAWINGS, THE SUBCONTRACTOR SHALL PROPOSE AN ALTERNATIVE INSTALLATION SPACE FOR APPROVAL BY THE CONTRACTOR.
- SUBCONTRACTOR SHALL DETERMINE ACTUAL ROUTING OF CONDUIT, POWER AND T1 CABLES, GROUNDING CABLES AS SHOWN ON THE POWER, GROUNDING AND TELCO PLAN DRAWING. SUBCONTRACTOR SHALL UTILIZE EXISTING TRAYS AND/OR SHALL ADD NEW TRAYS AS NECESSARY. SUBCONTRACTOR SHALL CONFIRM THE ACTUAL ROUTING WITH THE CONTRACTOR.
- THE SUBCONTRACTOR SHALL PROTECT EXISTING IMPROVEMENTS, PAVEMENTS, CURBS, LANDSCAPING AND STRUCTURES. ANY DAMAGED PART SHALL BE REPAIRED AT SUBCONTRACTOR'S EXPENSE TO THE SATISFACTION OF OWNER.
- SUBCONTRACTOR SHALL LEGALLY AND PROPERLY DISPOSE OF ALL SCRAP MATERIALS SUCH AS COAXIAL CABLES AND OTHER ITEMS REMOVED FROM THE EXISTING FACILITY. ANTENNAS REMOVED SHALL BE RETURNED TO THE OWNER'S DESIGNATED LOCATION.
- SUBCONTRACTOR SHALL LEAVE PREMISES IN CLEAN CONDITION.
- ALL CONCRETE REPAIR WORK SHALL BE DONE IN ACCORDANCE WITH AMERICAN CONCRETE INSTITUTE (ACI) 301.
- ANY NEW CONCRETE NEEDED FOR THE CONSTRUCTION SHALL BE AIR-ENTRAINED AND SHALL HAVE 4000 PSI STRENGTH AT 28 DAYS. ALL CONCRETE WORK SHALL BE DONE IN ACCORDANCE WITH ACI 318 CODE REQUIREMENTS.

- ALL STRUCTURAL STEEL WORK SHALL BE DETAILED, FABRICATED AND ERECTED IN ACCORDANCE WITH AISC SPECIFICATIONS. ALL STRUCTURAL STEEL SHALL BE ASTM A36 (Fy = 36 ksi) UNLESS OTHERWISE NOTED. PIPES SHALL BE ASTM A53 TYPE E (Fy = 36 ksi). ALL STEEL EXPOSED TO WEATHER SHALL BE HOT DIPPED GALVANIZED. TOUCHUP ALL SCRATCHES AND OTHER MARKS IN THE FIELD AFTER STEEL IS ERECTED USING A COMPATIBLE ZINC RICH PAINT.
- CONSTRUCTION SHALL COMPLY WITH SPECIFICATIONS AND "GENERAL CONSTRUCTION SERVICES FOR CONSTRUCTION OF T-MOBILE MOBILITY SITES."
- SUBCONTRACTOR SHALL VERIFY ALL EXISTING DIMENSIONS AND CONDITIONS PRIOR TO COMMENCING ANY WORK. ALL DIMENSIONS OF EXISTING CONSTRUCTION SHOWN ON THE DRAWINGS MUST BE VERIFIED. SUBCONTRACTOR SHALL NOTIFY THE CONTRACTOR OF ANY DISCREPANCIES PRIOR TO ORDERING MATERIAL OR PROCEEDING WITH CONSTRUCTION.
- THE EXISTING CELL SITE IS IN FULL COMMERCIAL OPERATION. ANY CONSTRUCTION WORK BY SUBCONTRACTOR SHALL NOT DISRUPT THE EXISTING NORMAL OPERATION. ANY WORK ON EXISTING EQUIPMENT MUST BE COORDINATED WITH CONTRACTOR. ALSO, WORK SHOULD BE SCHEDULED FOR AN APPROPRIATE MAINTENANCE WINDOW USUALLY IN LOW TRAFFIC PERIODS AFTER MIDNIGHT.
- SINCE THE CELL SITE IS ACTIVE, ALL SAFETY PRECAUTIONS MUST BE TAKEN WHEN WORKING AROUND HIGH LEVELS OF ELECTROMAGNETIC RADIATION. EQUIPMENT SHOULD BE SHUTDOWN PRIOR TO PERFORMING ANY WORK THAT COULD EXPOSE THE WORKERS TO DANGER. PERSONAL RF EXPOSURE MONITORS ARE ADVISED TO BE WORN TO ALERT OF ANY DANGEROUS EXPOSURE LEVELS.
- APPLICABLE BUILDING CODES:  
SUBCONTRACTOR'S WORK SHALL COMPLY WITH ALL APPLICABLE NATIONAL, STATE, AND LOCAL CODES AS ADOPTED BY THE LOCAL AUTHORITY HAVING JURISDICTION (AHJ) FOR THE LOCATION. THE EDITION OF THE AHJ ADOPTED CODES AND STANDARDS IN EFFECT ON THE DATE OF CONTRACT AWARD SHALL GOVERN THE DESIGN.  
  
BUILDING CODE: IBC 2015 & CONNECTICUT STATE BUILDING CODE 2018  
ELECTRICAL CODE: 2017 NATIONAL ELECTRICAL CODE  
LIGHTNING CODE: NFPA 70-2017
- SUBCONTRACTOR'S WORK SHALL COMPLY WITH THE LATEST EDITION OF THE FOLLOWING STANDARDS:  
  
AMERICAN CONCRETE INSTITUTE (ACI) 318; BUILDING CODE REQUIREMENTS FOR STRUCTURAL CONCRETE;  
  
AMERICAN INSTITUTE OF STEEL CONSTRUCTION (AISC)  
  
MANUAL OF STEEL CONSTRUCTION, ASD, FOURTEENTH EDITION;  
  
TELECOMMUNICATIONS INDUSTRY ASSOCIATION (TIA) 222-G, STRUCTURAL STANDARDS FOR STEEL  
  
ANTENNA TOWER AND ANTENNA SUPPORTING STRUCTURES; REFER TO ELECTRICAL DRAWINGS FOR SPECIFIC ELECTRICAL STANDARDS.

FOR ANY CONFLICTS BETWEEN SECTIONS OF LISTED CODES AND STANDARDS REGARDING MATERIAL, METHODS OF CONSTRUCTION, OR OTHER REQUIREMENTS, THE MOST RESTRICTIVE REQUIREMENT SHALL GOVERN. WHERE THERE IS CONFLICT BETWEEN A GENERAL REQUIREMENT AND A SPECIFIC REQUIREMENT, THE SPECIFIC REQUIREMENT SHALL GOVERN.

# RF NOTES

- ACTUAL LENGTHS SHALL BE DETERMINED PER SITE CONDITION BY SUBCONTRACTOR
- THE DESIGN IS BASED ON RF DATA SHEETS, SIGNED AND APPROVED.
- RADIO SIGNAL CABLE AND RACEWAY SHALL COMPLY WITH THE REQUIREMENTS OF THE NATIONAL ELECTRICAL CODE (NEC, NFPA 70), CHAPTER 8.
- ALL SPECIFIED MATERIAL FOR EACH LOCATION (E.G. OUT DOORS-OCCUPIED, INDOORS-UNOCCUPIED, PLENUMS, RISER SHAFTS, ETC.) SHALL BE APPROVED, LISTED, OR LABELED AS REQUIRED BY THE NEC.
- RADIO SIGNAL CABLE SHALL BE SUPPORTED AT MINIMUM OF EVERY THREE (3) FEET EXCEPT INSIDE MONOPOLES OR MONOPOLES WHERE CABLE AND CONNECTOR MANUFACTURERS SUPPORT RECOMMENDATIONS SHALL BE FOLLOWED. MANUFACTURER RECOMMENDATION CABLES SUPPORT ACCESSORIES SHALL BE USED.
- THE OUTDOOR CABLE SUPPORT SYSTEM SHALL BE PROVIDED WITH AN ICE SHIELD TO SUPPORT AND PROTECT ANTENNA CABLE RUNS.
- DRIP LOOPS SHALL BE REQUIRED ON ALL OUTSIDE CABLES. CABLES SHALL BE SLOPED AWAY FROM BUILDING OR OUTDOOR BTS CABINETS TO PREVENT WATER FROM ENTERING THROUGH THE COAXIAL CABLE PORT.
- ALL FEEDER LINE AND JUMPER CONNECTORS SHALL BE 7/16 DIN CABLE CONNECTORS THAT MEET IP68 STANDARDS.
- 7/16 DIN CONNECTORS REQUIRE NO ADDITIONAL WEATHER PROOFING IN INDOOR APPLICATIONS IF INSTALLED AND TORQUED PROPERLY. IN OUTDOOR APPLICATIONS WEATHER PROOFING IS REQUIRED AND THE FOLLOWING PROCEDURE SHOULD BE FOLLOWED.
- USING WEATHERPROOFING KIT APPROVED BY CABLE MANUFACTURER AND CONTRACTOR START TAPE APPROXIMATELY 5 INCHES FROM THE CONNECTOR, AND WRAP 2 INCHES TOWARD THE CONNECTOR, THEN REVERSE THE TAPE SO THAT THE STICKY SIDE IS UP. TAPE OVER THE CONNECTOR OR SURGE ARRESTOR UNTIL THREE (3) TO FOUR (4) INCHES BEYOND THE CONNECTOR AND REVERSE AGAIN WITH THE STICKY SIDE DOWN FOR ANOTHER INCH OR TWO. PASS THE BUTYL RUBBER AND FINISH WITH A FINAL LAYER OF TAPE.
- ANTENNAS SHALL BE PAINTED WHEN REQUIRED, BY THE LANDLORD OR AUTHORITY OF HAVING JURISDICTION IN ACCORDANCE WITH ANTENNA MANUFACTURERS' SURFACES PREPARATION AND PAINTING REQUIREMENTS.
- CABLE SHIELDS AND TOWER CONDUITS SHALL BE GROUNDED AT THE TOP OF THE TOWER WITHIN 10 FEET OF THEIR CONNECTORS, AND AT THE BOTTOM OF THE TOWER ABOUT 6 INCHES BEFORE THEY TURN TOWARD THE FACILITY. THEY SHALL BE GROUNDED AT THE MIDPOINT OF THE TOWERS THAT ARE BETWEEN 60 FEET AND 200 FEET HIGH, AND AT INTERVALS OF 60 FEET OR LESS ON TOWERS THAT ARE HIGHER THAN 200 FEET.

## ANTENNA CABLE AND SCHEDULING NOTES

- SUBCONTRACTOR SHALL VERIFY THE ACTUAL LENGTH IN THE FIELD BEFORE INSTALLATION.
- TAG AND COLOR CODE ALL MAIN CABLES AT LOCATIONS PER T-MOBILE ANTENNA CABLE MARKING STANDARD:
  - TOP OF TOWER END OF MAIN COAX
  - BOTTOM OF TOWER END OF MAIN COAX
  - DIRECTLY BEFORE AND AFTER RF EQUIPMENT
  - END OF JUMPERS AT BTS EQUIPMENT
- ANTENNAS SHALL BE PROCURED AND INSTALLED WITH DOWN TILT MOUNTING BRACKETS SUPPLIED BY ANTENNA MANUFACTURER.
- PRIOR APPROVAL IS REQUIRED BEFORE PERFORMING ANY WORK ON EXISTING CELL SITE EQUIPMENT.

# T-Mobile NORTHEAST LLC

T-MOBILE NORTHEAST, LLC.  
35 GRIFFIN RD S  
BLOOMFIELD, CT 06002  
PHONE: (860) 629-1700



750 W CENTER ST, SUITE 301  
WEST BRIDGEWATER, MA 02379  
PHONE: 781.713.4725

## REVISIONS

REV	DATE	DESCRIPTION	BY
0	12/07/21	ISSUED FOR CONSTRUCTION	SS
A	10/01/21	ISSUED FOR REVIEW	RL

DESIGNED BY: RL	APPROVED BY: WRD
--------------------	---------------------

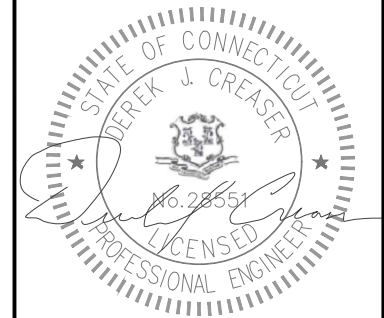

DATE: 12/07/2021

IT IS A VIOLATION OF LAW FOR ANY PERSON UNLESS THEY ARE ACTING UNDER THE DIRECTION OF A LICENSED PROFESSIONAL ENGINEER TO ALTER THIS DOCUMENT. UNLESS EXPLICITLY AGREED TO BY THE ENGINEER IN WRITING, THE ENGINEER DISCLAIMS ALL LIABILITY ASSOCIATED WITH THE REUSE, ALTERATION OR MODIFICATION OF THE CONTENTS HEREIN.

# ABBREVIATIONS

AGL	ABOVE GRADE LEVEL	G.C.	GENERAL CONTRACTOR	RF	RADIO FREQUENCY
AWG	AMERICAN WIRE GAUGE	MGB	MASTER GROUND BUS		
BCW	BARE COPPER WIRE	MIN	MINIMUM	TBD	TO BE DETERMINED
BTS	BASE TRANSCEIVER STATION	PROPOSED	NEW	TBR	TO BE REMOVED
EXISTING	EXISTING	N.T.S.	NOT TO SCALE	TBRR	TO BE REMOVED AND REPLACED
EG	EQUIPMENT GROUND	REF	REFERENCE	TYP	TYPICAL
EGR	EQUIPMENT GROUND RING	REQ	REQUIRED		

SITE NAME: <b>TMO CTNH442A</b>
SITE ID: <b>CTNH442A</b>
SITE ADDRESS: <b>150 WILLOW STREET HAMDEN, CT 06518 NEW HAVEN COUNTY</b>
SHEET TITLE: <b>GENERAL NOTES</b>
DRAWING: <b>GN-1</b>



# T-Mobile NORTHEAST LLC

T-MOBILE NORTHEAST, LLC.  
35 GRIFFIN RD S  
BLOOMFIELD, CT 06002  
PHONE: (860) 629-1700



750 W CENTER ST, SUITE 301  
WEST BRIDGEWATER, MA 02379  
PHONE: 781.713.4725

## REVISIONS

REV	DATE	DESCRIPTION	BY
0	12/07/21	ISSUED FOR CONSTRUCTION	SS
A	10/01/21	ISSUED FOR REVIEW	RL

DESIGNED BY: RL  
APPROVED BY: WRD

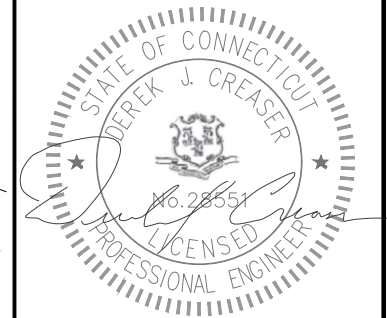

DATE: 12/07/2021

IT IS A VIOLATION OF LAW FOR ANY PERSON UNLESS THEY ARE ACTING UNDER THE DIRECTION OF A LICENSED PROFESSIONAL ENGINEER TO ALTER THIS DOCUMENT, UNLESS EXPLICITLY AGREED TO BY THE ENGINEER IN WRITING. THE ENGINEER DISCLAIMS ALL LIABILITY ASSOCIATED WITH THE REUSE, ALTERATION OR MODIFICATION OF THE CONTENTS HEREIN.

SITE NAME: TMO CTNH442A  
SITE ID: CTNH442A  
SITE ADDRESS: 150 WILLOW STREET  
HAMDEN, CT 06518  
NEW HAVEN COUNTY

SHEET TITLE: **COMPOUND & EQUIPMENT PLAN**  
DRAWING: **A-1**

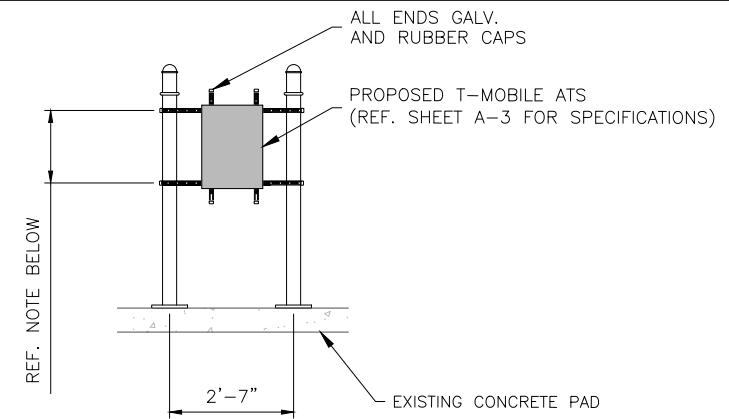

NOTE:  
HORIZONTAL & VERTICAL UNISTRUT TO BE SPACED SO EQUIPMENT MOUNTING HOLES ALIGN.

3  
A-1  
**H-FRAME DETAIL**

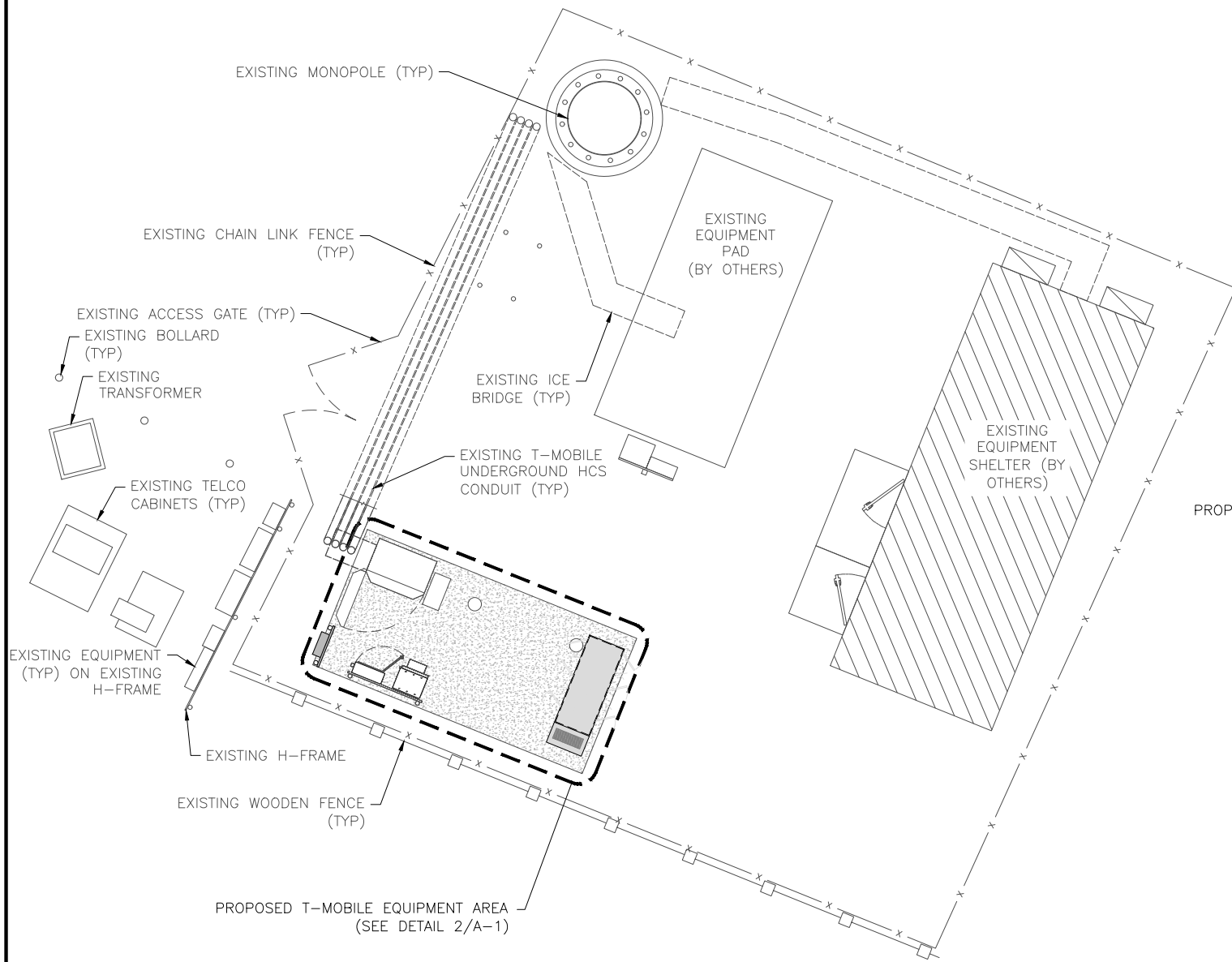

1  
A-1  
**COMPOUND PLAN**

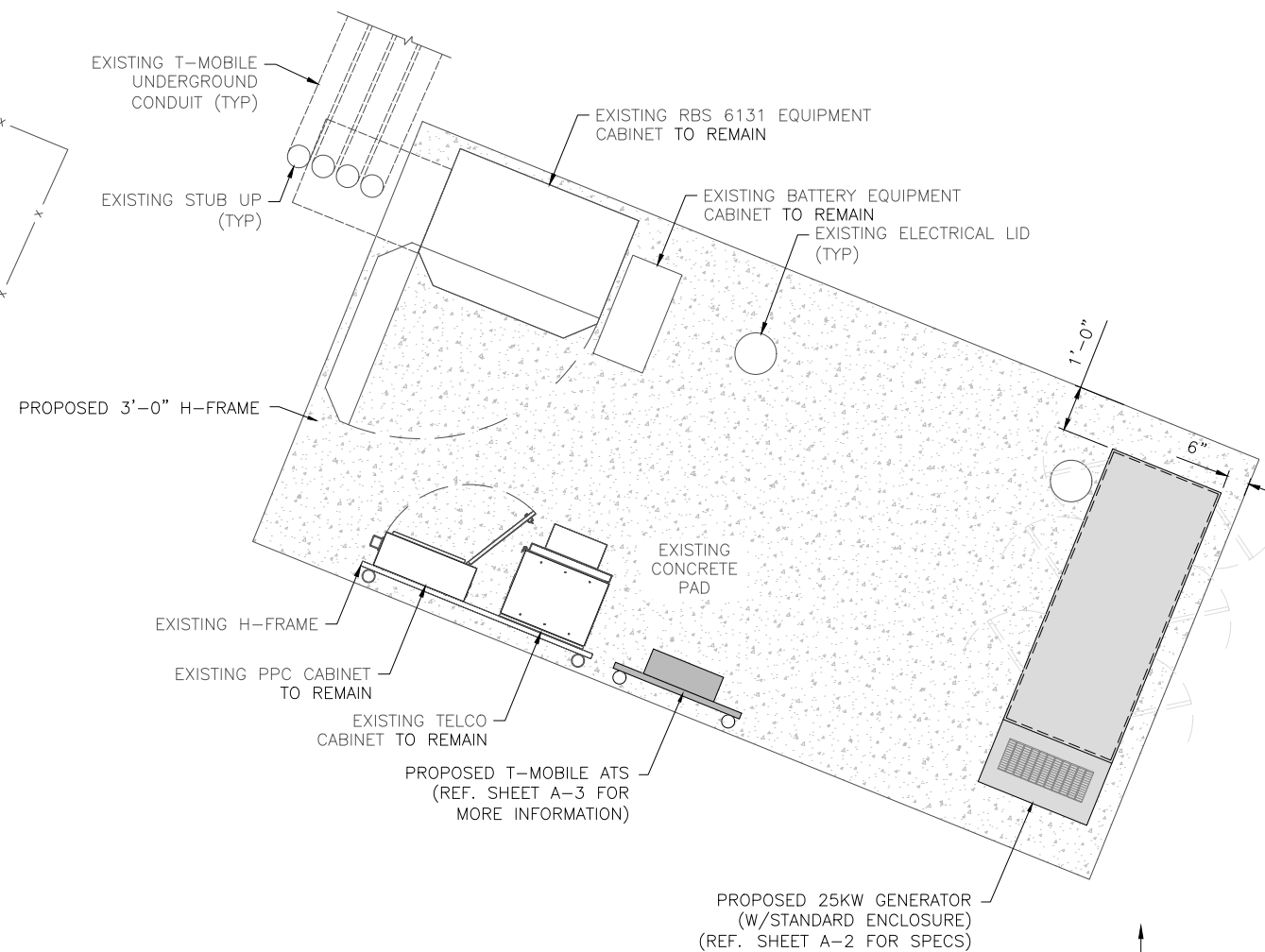
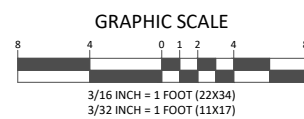

2  
A-1  
**PROPOSED EQUIPMENT PLAN**

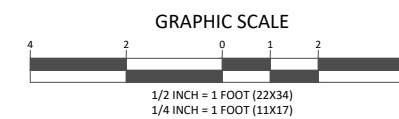

**SD025 | 2.2L | 25 kW**  
**INDUSTRIAL DIESEL GENERATOR SET**  
 EPA Certified Stationary Emergency



**Standby Power Rating**  
 25 kW, 32 kVA, 60 Hz

**Prime Power Rating\***  
 23 kW, 28 kVA, 60 Hz

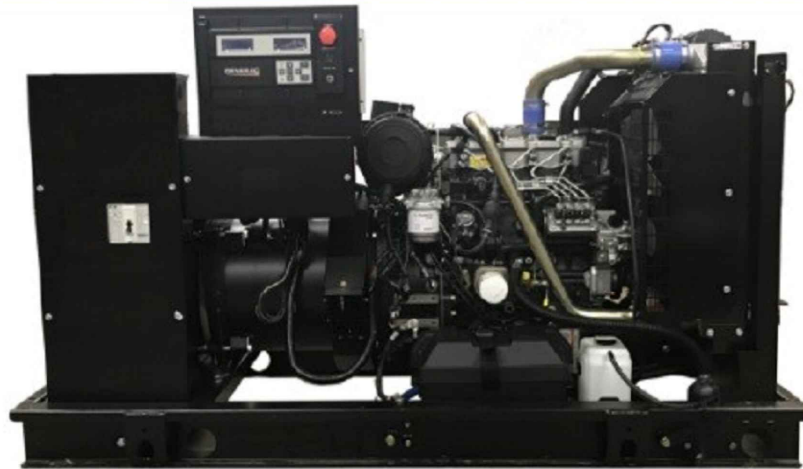

Image used for illustration purposes only



\*EPA Certified Prime ratings are not available in the US or its Territories

**Codes and Standards**

Not all codes and standards apply to all configurations. Contact factory for details.

UL2200, UL508, UL489, UL142

CSA C22.2

BS5514 and DIN 6271

SAE J1349

NFPA 37, 70, 99, 110

NEC700, 701, 702, 708

ISO 3046, 7637, 8528, 9001

NEMA ICS10, MG1, 250, ICS6, AB1

ANSI C62.41

**Powering Ahead**

For over 50 years, Generac has provided innovative design and superior manufacturing.

Generac ensures superior quality by designing and manufacturing most of its generator components, including alternators, enclosures and base tanks, control systems and communications software.

Generac gensets utilize a wide variety of options, configurations and arrangements, allowing us to meet the standby power needs of practically every application.

Generac searched globally to ensure the most reliable engines power our generators. We choose only engines that have already been proven in heavy-duty industrial applications under adverse conditions.

Generac is committed to ensuring our customers' service support continues after their generator purchase.

SPEC SHEET  
1 of 6

**SD025 | 2.2L | 25 kW**  
**INDUSTRIAL DIESEL GENERATOR SET**  
 EPA Certified Stationary Emergency



**DIMENSIONS AND WEIGHTS\***

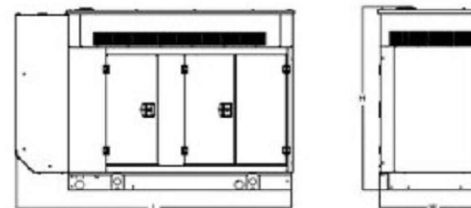
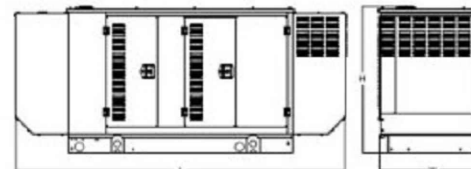
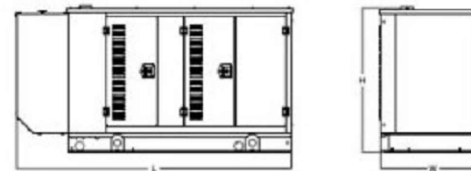

**OPEN SET (Includes Exhaust Flex)**

Run Time - Hours	Usable Capacity - Gal (L)	L x W x H - in (mm)	Weight - lbs (kg)	
			Steel	Aluminum
No Tank	-	76.0 (1,930) x 37.4 (950) x 44.8 (1,138)	1,580 (718)	
25	54 (204)	76.0 (1,930) x 37.4 (950) x 57.8 (1,468)	1,198 (936)	
62	132 (501)	76.0 (1,930) x 37.4 (950) x 69.8 (1,773)	2,290 (1,040)	
90	190 (719)	106.0 (2,692) x 37.4 (950) x 73.8 (1,874)	2,504 (1,138)	
100	211 (799)	76.0 (1,930) x 37.4 (950) x 81.8 (2,078)	2,499 (1,135)	
142	300 (1,136)	92.9 (2,360) x 37.4 (950) x 85.3 (2,167)	2,562 (1,163)	

**WEATHER PROTECTED ENCLOSURE**

Run Time - Hours	Usable Capacity - Gal (L)	L x W x H - in (mm)	Weight - lbs (kg) Enclosure Only	
			Steel	Aluminum
No Tank	-	94.8 (2,409) x 38.0 (965) x 49.5 (1,258)	1,952 (887)	1,821 (827)
25	54 (204)	94.8 (2,409) x 38.0 (965) x 62.5 (1,588)	1,367 (1,105)	1,307 (1,045)
62	132 (501)	94.8 (2,409) x 38.0 (965) x 74.5 (1,893)	2,662 (1,209)	2,531 (1,149)
90	190 (719)	106.0 (2,692) x 38.0 (965) x 78.5 (1,994)	2,876 (1,307)	2,745 (1,247)
100	211 (799)	94.8 (2,409) x 38.0 (965) x 86.5 (2,198)	2,871 (1,304)	2,740 (1,244)
142	300 (1,136)	94.8 (2,409) x 38.0 (965) x 90.0 (2,287)	2,934 (1,332)	2,803 (1,272)

**LEVEL 1 ACOUSTIC ENCLOSURE**

Run Time - Hours	Usable Capacity - Gal (L)	L x W x H - in (mm)	Weight - lbs (kg) Enclosure Only	
			Steel	Aluminum
No Tank	-	112.5 (2,857) x 38.0 (965) x 49.5 (1,258)	2,085 (947)	1,918 (871)
25	54 (204)	112.5 (2,857) x 38.0 (965) x 62.5 (1,588)	1,427 (1,165)	1,351 (1,089)
62	132 (501)	112.5 (2,857) x 38.0 (965) x 74.5 (1,893)	2,795 (1,269)	2,628 (1,193)
90	190 (719)	112.5 (2,857) x 38.0 (965) x 78.5 (1,994)	3,009 (1,367)	2,842 (1,291)
100	211 (799)	112.5 (2,857) x 38.0 (965) x 86.5 (2,198)	3,004 (1,364)	2,837 (1,288)
142	300 (1,136)	112.5 (2,857) x 38.0 (965) x 90.0 (2,287)	3,067 (1,392)	2,900 (1,316)

**LEVEL 2 ACOUSTIC ENCLOSURE**

Run Time - Hours	Usable Capacity - Gal (L)	L x W x H - in (mm)	Weight - lbs (kg) Enclosure Only	
			Steel	Aluminum
No Tank	-	94.8 (2,409) x 38.0 (965) x 61.1 (1,551)	2,090 (950)	1,921 (873)
25	54 (204)	94.8 (2,409) x 38.0 (965) x 74.1 (1,881)	1,430 (1,168)	1,353 (1,091)
62	132 (501)	94.8 (2,409) x 38.0 (965) x 86.1 (2,186)	2,800 (1,272)	2,631 (1,195)
90	190 (719)	106.0 (2,692) x 38.0 (965) x 90.1 (2,287)	3,014 (1,370)	2,845 (1,293)
100	211 (799)	94.8 (2,409) x 38.0 (965) x 98.1 (2,491)	3,009 (1,367)	2,840 (1,290)
142	300 (1,136)	94.8 (2,409) x 38.0 (965) x 101.6 (2,580)	3,072 (1,395)	2,903 (1,318)

\* All measurements are approximate and for estimation purposes only. Specification characteristics may change without notice. Please contact a Generac Power Systems Industrial Dealer for detailed installation drawings.

Generac Power Systems, Inc. | P.O. Box 8 | Waukesha, WI 53189  
 P: (262) 544-4811 ©2019 Generac Power Systems, Inc. All rights reserved. All specifications are subject to change without notice.

Part No. 10000028435  
 Rev. A 04/02/19

**T-Mobile**  
**NORTHEAST LLC**

T-MOBILE NORTHEAST, LLC.  
 35 GRIFFIN RD S  
 BLOOMFIELD, CT 06002  
 PHONE: (860) 629-1700



750 W CENTER ST, SUITE 301  
 WEST BRIDGEWATER, MA 02379  
 PHONE: 781.713.4725

**REVISIONS**

REV	DATE	DESCRIPTION	BY
0	12/07/21	ISSUED FOR CONSTRUCTION	SS
A	10/01/21	ISSUED FOR REVIEW	RL

DESIGNED BY: RL  
 APPROVED BY: WRD

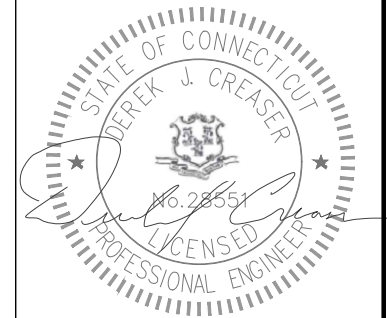

**DATE: 12/07/2021**

IT IS A VIOLATION OF LAW FOR ANY PERSON UNLESS THEY ARE ACTING UNDER THE DIRECTION OF A LICENSED PROFESSIONAL ENGINEER TO ALTER THIS DOCUMENT. UNLESS EXPLICITLY AGREED TO BY THE ENGINEER IN WRITING, THE ENGINEER DISCLAIMS ALL LIABILITY ASSOCIATED WITH THE REUSE, ALTERATION OR MODIFICATION OF THE CONTENTS HEREIN.

**SITE NAME:**  
 TMO CTNH442A

**SITE ID:**  
 CTNH442A

**SITE ADDRESS:**  
 150 WILLOW STREET  
 HAMDEN, CT 06518  
 NEW HAVEN COUNTY

**SHEET TITLE:**  
 GENERATOR DETAIL

**DRAWING:**  
 A-2

SPEC SHEET  
6 of 6

## Automatic Transfer Switches

# GENERAC®

## Service and non-Service rated Automatic Smart Transfer Switches

### 100 - 400 Amps, Single Phase

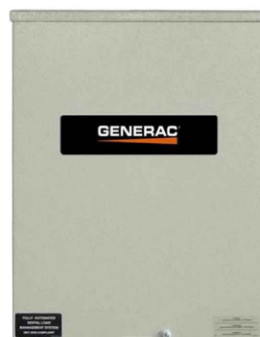

\*CUL only applies to non-service rated switches

Automatic Transfer Switches

Automatic Transfer Switches

1 of 2 2 of 2

# GENERAC®

## Automatic Smart Transfer Switches

### 100-400 Amps, Single Phase

#### Functions

All timing and sensing functions originate in the generator controller

Utility voltage drop-out.....	<65%
Timer to generator start .....	10 second factory set, adjustable between 2-1500 seconds by a qualified dealer*
Engine warm up delay .....	5 seconds
Standby voltage sensor .....	65% for 5 seconds
Utility voltage pickup.....	>80%
Re-transfer time delay .....	15 seconds
Engine cool-down timer .....	60 seconds
Exerciser .....	5 or 12 minutes adjustable weekly/Bi-weekly/Monthly**

The transfer switch can be operated manually without power applied.

\*When used in conjunction with units utilizing Evolution™ controls \*\*Adjustable via the controller

#### Specifications

Model	RXSC100A3	RXSC200A3
Amps	100	200
Voltage	120/240, 1Ø	120/240, 1Ø
Load Transition Type (Automatic)	Open Transition	Open Transition
Enclosure Type	NEMA/UL3R	NEMA/UL3R
UL Rating	UL/CUL	UL/CUL
Withstand Rating (Amps)	10,000	10,000
Lug Range	1/0 - #14	250 MCM - #6

#### Dimensions

Model	RXSC100A3	RXSC200A3
Height (in./mm)	H1	17.24/437.9
	H2	20/508
Width (in./mm)	W1	12.5/317.5
	W2	14.6/370.8
Depth (in./mm)	7.09/180.1	7.09/180.1
Weight (lbs./kilos)	20/9.07	20/9.07

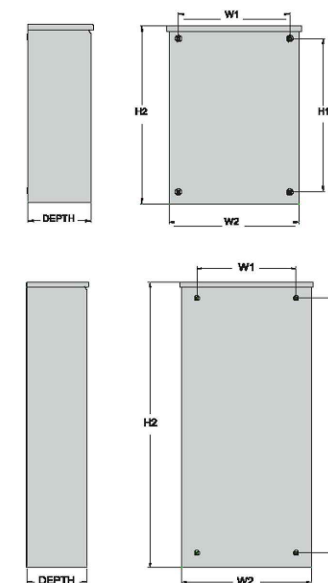

#### Description

Generac Automatic Transfer Switches are designed for use with single phase generators that utilize an Evolution™ or Nexus™ Controller. The 100, 200, and 400 amp open transition switches are available in single phase in both service equipment rated and non-service equipment rated configurations. The 150 and 300 amp open transition switches are only available in a service rated equipment configuration.

#### Standard Features

Service rated (RXSW) Generac Automatic Transfer Switches are housed in an aluminum NEMA/UL Type 3R enclosure\*, with electrostatically applied and baked powder paint. The Heavy Duty Generac Contactor is a UL recognized device, designed for years of service. The controller at the generator handles all the timing, sensing, exercising functions, and transfer commands. All switches are covered by a 5 year limited warranty.

\*Non-service rated (RXSC) switches are housed in a steel enclosure.

#### DPM Technology

Through the use of digital power technology (DPM), these switches have the capability to manage up to 4 individual HVAC (24 VAC controlled) loads with no additional hardware. When used in tandem with Smart Management Modules, up to 8 more loads can be managed as well, providing the most installation efficient power management options available.



Generac Power Systems, Inc. • 545 W29290 HWY. 59, Waukesha, WI 53189 • generac.com  
©2017 Generac Power Systems, Inc. All rights reserved. All specifications are subject to change without notice. Bulletin 10000013459-A 04/24/17

# T-Mobile

## NORTHEAST LLC

T-MOBILE NORTHEAST, LLC.  
35 GRIFFIN RD S  
BLOOMFIELD, CT 06002  
PHONE: (860) 629-1700



750 W CENTER ST, SUITE 301  
WEST BRIDGEWATER, MA 02379  
PHONE: 781.713.4725

#### REVISIONS

REV	DATE	DESCRIPTION	BY
0	12/07/21	ISSUED FOR CONSTRUCTION	SS
A	10/01/21	ISSUED FOR REVIEW	RL

DESIGNED BY: RL	APPROVED BY: WRD
--------------------	---------------------

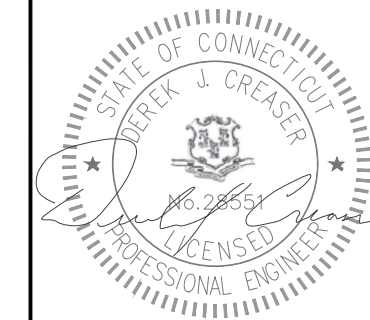

DATE: 12/07/2021

IT IS A VIOLATION OF LAW FOR ANY PERSON UNLESS THEY ARE ACTING UNDER THE DIRECTION OF A LICENSED PROFESSIONAL ENGINEER TO ALTER THIS DOCUMENT. UNLESS EXPLICITLY AGREED TO BY THE ENGINEER IN WRITING, THE ENGINEER DISCLAIMS ALL LIABILITY ASSOCIATED WITH THE REUSE, ALTERATION OR MODIFICATION OF THE CONTENTS HEREIN.

SITE NAME: TMO CTNH442A
SITE ID: CTNH442A
SITE ADDRESS: 150 WILLOW STREET HAMDEN, CT 06518 NEW HAVEN COUNTY

SHEET TITLE: ATS SPEC SHEET
--------------------------------

DRAWING: A-3
-----------------

# ELECTRICAL NOTES

- SUBMITTAL OF BID INDICATES THAT THE CONTRACTOR IS COGNIZANT OF ALL JOB SITE CONDITIONS AND WORK TO BE PERFORMED UNDER THIS CONTRACT.
- CONTRACTOR SHALL PERFORM ALL VERIFICATIONS, OBSERVATION TESTS, AND EXAMINATION WORK PRIOR TO ORDERING OF ANY EQUIPMENT AND THE ACTUAL CONSTRUCTION. CONTRACTOR SHALL ISSUE A WRITTEN NOTICE OF ALL FINDINGS TO THE PROJECT MANAGER LISTING ALL MALFUNCTIONS, FAULTY EQUIPMENT AND DISCREPANCIES.
- THESE PLANS ARE DIAGRAMMATIC ONLY, FOLLOW AS CLOSELY AS POSSIBLE.
- CONTRACTOR SHALL COORDINATE ALL WORK BETWEEN TRADES AND ALL OTHER SCHEDULING AND PROVISIONARY CIRCUMSTANCES SURROUNDING THE PROJECT.
- CONTRACTOR SHALL PROVIDE ALL LABOR, MATERIALS, INSURANCE, EQUIPMENT, INSTALLATION CONSTRUCTION TOOLS, TRANSPORTATION, ETC., FOR COMPLETE AND FUNCTIONALLY OPERATING SYSTEMS ENERGIZED AND READY FOR USE THROUGHOUT AS INDICATED ON DRAWINGS, AS SPECIFIED HEREIN AND/OR AS OTHERWISE REQUIRED.
- ALL MATERIALS AND EQUIPMENT SHALL BE NEW AND IN PERFECT CONDITION WHEN INSTALLED AND SHALL BE OF THE BEST GRADE AND OF THE SAME MANUFACTURER THROUGHOUT FOR EACH CLASS OR GROUP OF EQUIPMENT. ELECTRICAL MATERIALS SHALL BE LISTED AND APPROVED BY UNDERWRITER'S LABORATORIES AND SHALL BEAR THE INSPECTION LABEL "J" WHERE SUBJECT TO

- SUCH APPROVAL. MATERIALS SHALL MEET WITH APPROVAL OF ALL GOVERNING BODIES HAVING JURISDICTION OVER THE CONSTRUCTION. MATERIALS SHALL BE MANUFACTURED IN ACCORDANCE WITH ALL CURRENT APPLICABLE STANDARDS ESTABLISHED BY ANSI, NEMA AND NBFU. ALL MATERIALS AND EQUIPMENT SHALL BE APPROVED FOR THEIR INTENDED USE AND LOCATION.
- ALL WORK SHALL COMPLY WITH ALL APPLICABLE GOVERNING STATE, COUNTY AND CITY CODES AND OSHA, NFPA, NEC & ASHRAE REQUIREMENTS.
  - ENTIRE JOB SHALL BE GUARANTEED FOR A PERIOD OF ONE (1) YEAR AFTER THE DATE OF JOB ACCEPTANCE. ALL WORK, MATERIAL AND EQUIPMENT FOUND TO BE FAULTY DURING THAT PERIOD SHALL BE CORRECTED AT ONCE, UPON WRITTEN NOTIFICATION, AT THE EXPENSE OF THE CONTRACTOR.
  - PROPERLY SEAL ALL PENETRATIONS. PROVIDE UL LISTED FIRE-STOPS WHERE PENETRATIONS ARE MADE THROUGH FIRE-RATED ASSEMBLIES. WATER-TIGHT USING SILICONE SEALANT.
  - DELIVER ALL BROCHURES, OPERATING MANUALS, CATALOGS AND SHOP DRAWINGS TO THE PROJECT MANAGER AT JOB COMPLETION. PROVIDE MAINTENANCE MANUALS FOR MECHANICAL EQUIPMENT. AFFIX MAINTENANCE LABELS TO MECHANICAL EQUIPMENT.
  - ALL CONDUCTORS SHALL BE COPPER. MINIMUM CONDUCTOR SIZE SHALL BE #12 AWG., UNLESS OTHERWISE NOTED. CONDUCTORS SHALL BE TYPE THHW, RATED IN ACCORDANCE WITH NEC 110-14(C).
  - ALL CIRCUIT BREAKERS, FUSES AND ELECTRICAL EQUIPMENT SHALL HAVE AN INTERRUPTING RATING NOT LESS THE MAXIMUM INTERRUPTING CURRENT TO WHICH

- THEY MAY BE SUBJECTED.
- THE ENTIRE ELECTRICAL INSTALLATION SHALL BE GROUNDED IN ACCORDANCE WITH THE NATIONAL ELECTRICAL CODE; ARTICLES 250 & 810 AND THE UTILITY COMPANY STANDARDS.
  - CONDUIT:
    - RIGID CONDUIT SHALL BE U.L. LABEL GALVANIZED ZINC COATED WITH ZINC INTERIOR AND SHALL BE USED WHEN INSTALLED IN OR UNDER CONCRETE SLABS, IN CONTACT WITH THE EARTH, UNDER PUBLIC ROADWAYS, IN MASONRY WALLS OR EXPOSED ON BUILDING EXTERIOR. RIGID CONDUIT IN CONTACT WITH EARTH SHALL BE 1/2 LAPPED WRAPPED WITH HUNTS WRAP PROCESS NO. 3.
    - ELECTRICAL METALLIC TUBING SHALL HAVE U.L. LABEL, FITTINGS SHALL BE GLAND RING COMPRESSION TYPE. EMT SHALL BE USED ONLY FOR INTERIOR RUNS.
    - LIQUID-TIGHT FLEXIBLE METAL CONDUIT SHALL BE U.L. LISTED AND SHALL BE USED AT FINAL CONNECTIONS TO MECHANICAL EQUIPMENT & RECTIFIERS AND WHERE PERMITTED BY CODE. ALL CONDUIT IN EXCESS OF SIX FEET IN LENGTH SHALL CONTAIN A FULL-SIZE GROUND CONDUCTOR.
    - CONDUIT RUNS SHALL BE SURFACE MOUNTED ON CEILINGS OR WALLS UNLESS NOTED OTHERWISE. ALL CONDUIT SHALL RUN PARALLEL OR PERPENDICULAR TO WALLS, FLOOR, CEILING, OR BEAMS. VERIFY EXACT ROUTING OF ALL EXPOSED CONDUIT WITH THE PROJECT MANAGER PRIOR TO INSTALLING.

- PVC CONDUIT MAY BE PROVIDED ONLY WHERE SHOWN, OR IN UNDERGROUND INSTALLATIONS. PROVIDE UV-RESISTANT CONDUIT WHERE EXPOSED TO THE ATMOSPHERE. PROVIDE GROUND CONDUCTOR IN ALL PVC RUNS; EXCEPT WHERE PERMITTED BY CODE TO OMIT.
- ALL ELECTRICAL EQUIPMENT SHALL BE LABELED WITH PERMANENT ENGRAVED PLASTIC LABELS. BACKGROUND SHALL BE BLACK WITH WHITE LETTERS; EXCEPT AS REQUIRED BY CODE TO FOLLOW A DIFFERENT SCHEME.
- UPON COMPLETION OF WORK, CONDUCT CONTINUITY, SHORT CIRCUIT, AND FALL OF POTENTIAL GROUNDING TESTS FOR APPROVAL. SUBMIT TEST REPORTS TO PROJECT MANAGER. GROUNDING SYSTEM RESISTANCE SHALL NOT EXCEED 5 OHMS. IF THE RESISTANCE VALUE IS EXCEEDED, NOTIFY THE PROJECT MANAGER FOR FURTHER INSTRUCTION ON METHODS FOR REDUCING THE RESISTANCE VALUE.
- CLEAN PREMISES OF ALL DEBRIS RESULTING FROM WORK AND LEAVE WORK IN A COMPLETE AND UNDAMAGED CONDITION. LEGALLY DISPOSE OF ALL REMOVED, UNUSED AND EXCESS MATERIAL GENERATED BY THE WORK OF THIS CONTRACT. DELIVER ITEMS INDICATED ON THE DRAWINGS TO THE OWNER IN GOOD CONDITION. OBTAIN SIGNED RECEIPT UPON DELIVERY.
- COORDINATE WITH UTILITY COMPANY FOR CONNECTION OF TEMPORARY AND PERMANENT POWER TO THE SITE. THE TEMPORARY POWER AND ALL HOOKUP COSTS SHALL BE PAID BY THE CONTRACTOR.
- VERIFY ALL EXISTING CIRCUITRY PRIOR TO REMOVAL AND NEW WORK. MAINTAIN POWER TO ALL OTHER AREAS & CIRCUITS NOT SCHEDULED FOR REMOVAL.
- RED LINED AS-BUILT PLANS SHALL BE PROVIDED TO THE CONSTRUCTION MANAGER.

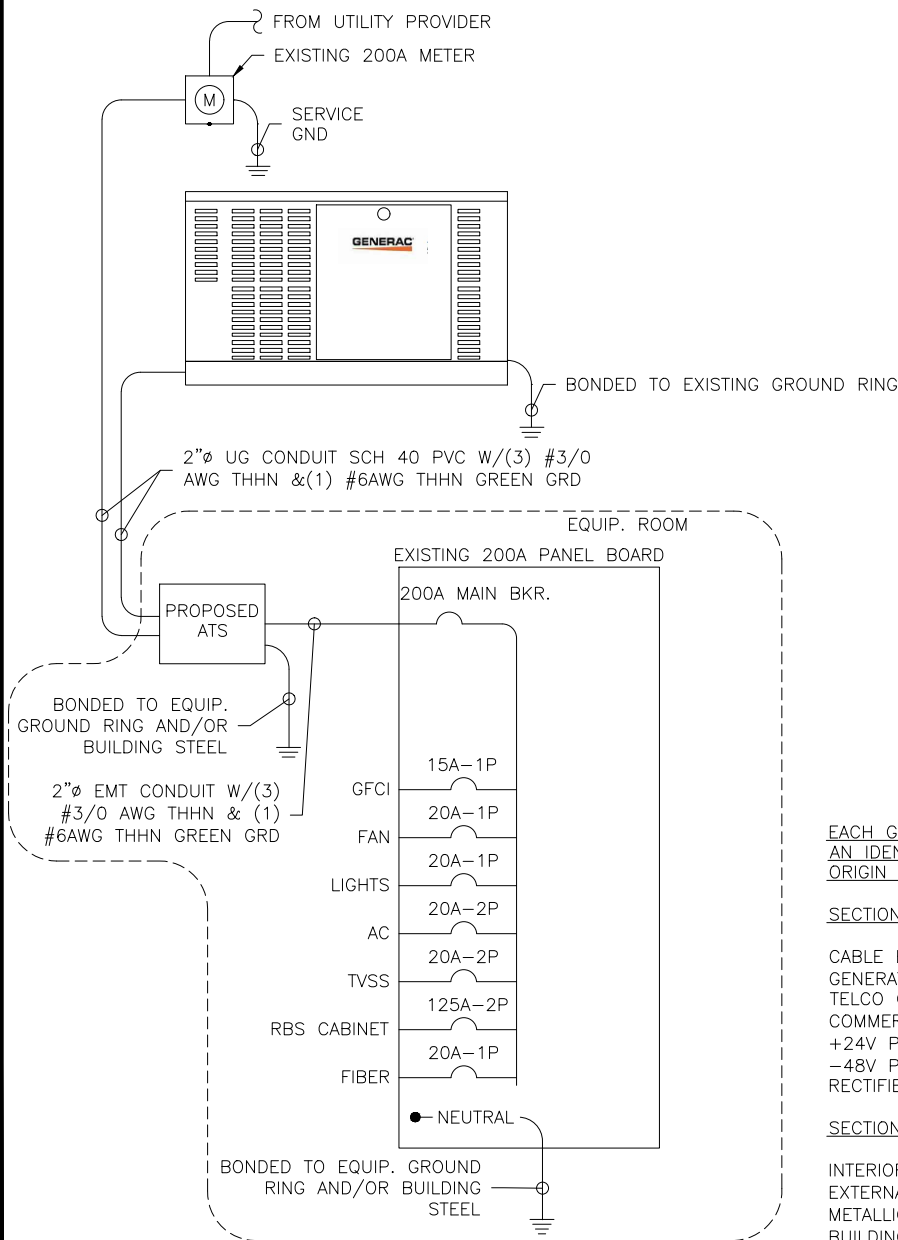

1 ONE LINE DIAGRAM  
E-1

EACH GROUND CONDUCTOR TERMINATING ON ANY GROUND BAR SHALL HAVE AN IDENTIFICATION TAG ATTACHED AT EACH END THAT WILL IDENTIFY ITS ORIGIN AND DESTINATION.

SECTION "P" - SURGE PRODUCERS

- CABLE ENTRY PORTS (HATCH PLATES) (#2)
- GENERATOR FRAMEWORK (IF AVAILABLE) (#2)
- TELCO GROUND BAR
- COMMERCIAL POWER COMMON NEUTRAL/GROUND BOND (#2)
- +24V POWER SUPPLY RETURN BAR (#2)
- 48V POWER SUPPLY RETURN BAR (#2)
- RECTIFIER FRAMES.

SECTION "A" - SURGE ABSORBERS

- INTERIOR GROUND RING (#2)
- EXTERNAL EARTH GROUND FIELD (BURIED GROUND RING) (#2)
- METALLIC COLD WATER PIPE (IF AVAILABLE) (#2)
- BUILDING STEEL (IF AVAILABLE) (#2)

2 GROUND WIRE SCHEDULE  
E-1

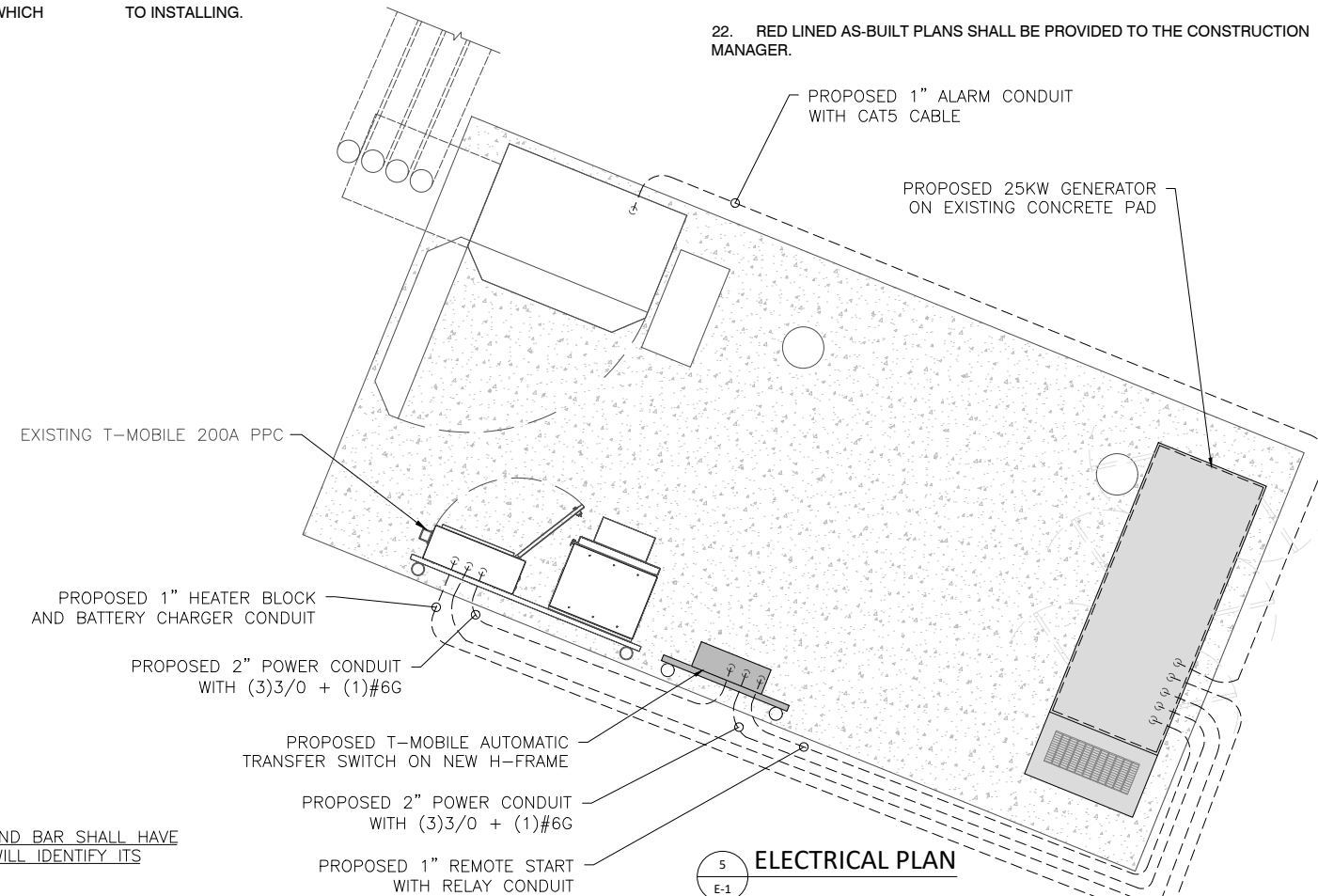

5 ELECTRICAL PLAN  
E-1

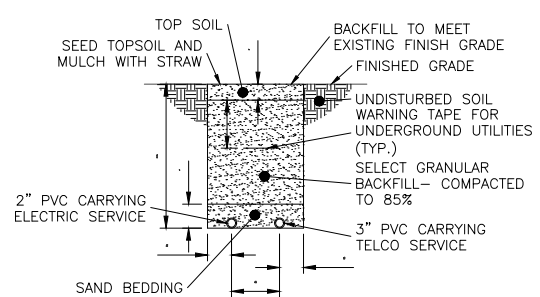

NOTE: EXCAVATE EXISTING SUBGRADE AS REQUIRED TO INSTALL CONDUITS IN ACCORDANCE WITH OSHA AND ALL APPLICABLE CODES.

3 TYPICAL TRENCH DETAIL  
E-1

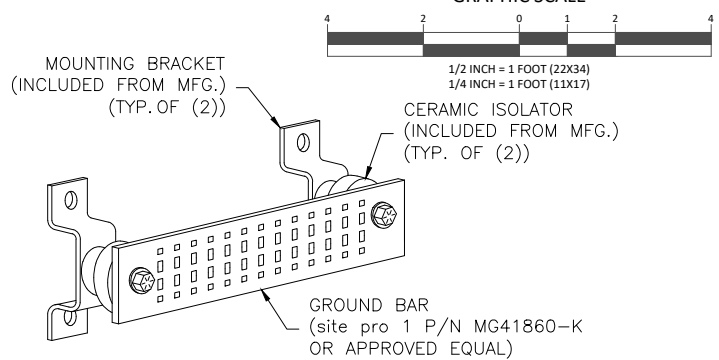

4 GROUND BAR DETAIL  
E-1

**T-Mobile**  
NORTHEAST LLC

T-MOBILE NORTHEAST, LLC.  
35 GRIFFIN RD S  
BLOOMFIELD, CT 06002  
PHONE: (860) 629-1700



750 W CENTER ST, SUITE 301  
WEST BRIDGEWATER, MA 02379  
PHONE: 781.713.4725

REVISIONS			
REV	DATE	DESCRIPTION	BY
0	12/07/21	ISSUED FOR CONSTRUCTION	SS
A	10/01/21	ISSUED FOR REVIEW	RL

DESIGNED BY: RL	APPROVED BY: WRD
--------------------	---------------------

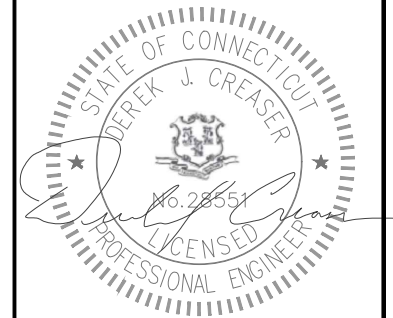

DATE: 12/07/2021

IT IS A VIOLATION OF LAW FOR ANY PERSON UNLESS THEY ARE ACTING UNDER THE DIRECTION OF A LICENSED PROFESSIONAL ENGINEER TO ALTER THIS DOCUMENT. UNLESS EXPLICITLY AGREED TO BY THE ENGINEER IN WRITING, THE ENGINEER DISCLAIMS ALL LIABILITY ASSOCIATED WITH THE REUSE, ALTERATION OR MODIFICATION OF THE CONTENTS HEREIN.

SITE NAME:  
**TMO CTNH442A**

SITE ID:  
**CTNH442A**

SITE ADDRESS:  
**150 WILLOW STREET  
HAMDEN, CT 06518  
NEW HAVEN COUNTY**

SHEET TITLE:  
**ELECTRICAL PLAN & DETAILS**

DRAWING:  
**E-1**

## GROUNDING NOTES:

- GROUNDING SHALL COMPLY WITH ARTICLE 250 OF THE NATIONAL ELECTRICAL CODE.
- ALL GROUNDING DEVICES SHALL BE U.L. APPROVED OR LISTED FOR THEIR INTENDED USE.
- ALL WIRES SHALL BE AWG THHN/THWN COPPER UNLESS NOTED OTHERWISE.
- GROUNDING CONNECTIONS TO GROUND RODS, GROUND RING WIRE, TOWER BASE AND FENCE POSTS SHALL BE EXOTHERMIC ("CADWELDS") UNLESS NOTED OTHERWISE. CLEAN SURFACES TO SHINY METAL. WHERE GROUND WIRES ARE CADWELDED TO GALVANIZED SURFACES, SPRAY CADWELD WITH GALVANIZING PAINT.
- GROUNDING CONNECTIONS TO GROUND BARS ARE TO BE TWO-HOLE BRASS MECHANICAL CONNECTORS WITH STAINLESS STEEL HARDWARE (INCLUDING SCREW SET) CLEAN GROUND BAR TO SHINY METAL. AFTER MECHANICAL CONNECTION, TREAT WITH PROTECTIVE ANTIOXIDANT COATING.
- GROUND COAXIAL CABLE SHIELDS AT BOTH ENDS WITH MANUFACTURER'S GROUNDING KITS.
- ROUTE GROUNDING CONDUCTORS THE SHORTEST AND STRAIGHTEST PATH POSSIBLE. BEND GROUNDING LEADS WITH A MINIMUM 12" RADIUS.
- INSTALL #2 AWG GREEN-INSULATED STRANDED WIRE FOR ABOVE GRADE GROUNDING AND #2 TINNED SOLID COPPER WIRE FOR BELOW GRADE GROUNDING UNLESS OTHERWISE NOTED.
- REFER TO GROUNDING PLAN FOR GROUND BAR LOCATIONS. GROUNDING CONNECTIONS SHALL BE EXOTHERMIC TYPE ("CADWELDS") TO ANTENNA MOUNTS AND GROUND RING. REMAINING GROUNDING CONNECTIONS SHALL BE COMPRESSION FITTINGS. CONNECTIONS TO GROUND BARS SHALL BE MADE WITH TWO-HOLE LUGS.
- THE GROUND ELECTRODE SYSTEM SHALL CONSIST OF DRIVEN GROUND RODS POSITION ACCORDING TO GROUNDING PLAN. THE GROUND RODS SHALL BE 5/8"x10'-0" COPPER CLAD STEEL INTERCONNECTED WITH #2 TINNED SOLID COPPER WIRE BURIED 36" BELOW GRADE. BURY GROUND RODS A MAXIMUM OF 15' APART, AND A MINIMUM OF 8' APART.
- IF ROCK IS ENCOUNTERED GROUND RODS SHALL BE PLACED AT AN OBLIQUE ANGLE NOT TO EXCEED 45°.
- EXOTHERMIC WELDS SHALL BE MADE IN ACCORDANCE WITH ERICO PRODUCTS BULLETIN A-AT.
- CONSTRUCTION OF GROUND RING AND CONNECTIONS TO EXISTING GROUND RING SYSTEM SHALL BE DOCUMENTED WITH PHOTOGRAPHS PRIOR TO BACKFILLING SITE. PROVIDE PHOTOS TO THE CONSTRUCTION MANAGER.
- ALL GROUND LEADS EXCEPT THOSE TO THE EQUIPMENT ARE TO BE #2 TINNED SOLID COPPER WIRE. ALL EXTERIOR GROUND BARS TINNED COPPER.
- PRIOR TO INSTALLING LUGS ON GROUND WIRES, APPLY THOMAS & BETTS KOPR-SHIELD (TM OF JET LUBE INC.). PRIOR TO BOLTING GROUND WIRE LUGS TO GROUND BARS, APPLY KOPR-SHIELD OR EQUAL.
- ENGAGE AN INDEPENDENT ELECTRICAL TESTING FIRM TO TEST AND VERIFY THAT IMPEDANCE DOES NOT EXCEED FIVE OHMS TO GROUND BY MEANS OF "FALL OF POTENTIAL TEST". TEST SHALL BE WITNESSED BY A T-MOBILE REPRESENTATIVE, AND RECORDED ON THE "GROUND RESISTANCE TEST" FORM.
- WHERE BARE COPPER GROUND WIRES ARE ROUTED FROM ANY CONNECTION ABOVE GRADE TO GROUND RING, INSTALL WIRE IN 3/4" PVC SLEEVE, FROM 1' BELOW GRADE AND SEAL TOP WITH SILICONE MATERIAL.
- PREPARE ALL BONDING SURFACES FOR GROUNDING CONNECTIONS BY REMOVING ALL PAINT AND CORROSION DOWN TO SHINY METAL. FOLLOWING CONNECTION, APPLY APPROPRIATE ANTI-OXIDIZATION PAINT.
- ANY SITE WHERE THE EQUIPMENT (BTS, CABLE BRIDGE, PPC, GENERATOR, ETC.) IS LOCATED WITHIN 6 FEET OF METAL FENCING, THE GROUND RING SHALL BE BONDED TO THE NEAREST FENCE POST USING (3) RUNS OF #2 BARE TINNED COPPER WIRE.

GROUNDING LEGEND	
	COAXIAL CABLE SHIELD GROUND KIT CONNECTION
	COMPRESSION FITTING CONNECTION
	EXOTHERMIC WELD CONNECTION
	5/8"x10' COPPER-CLAD STEEL GROUND ROD
	5/8"x10' COPPER-CLAD STEEL GROUND ROD WITH INSPECTION WELL
	EXISTING GROUND WIRING
	EXISTING GROUND WIRING
	TINNED COPPER GROUND BAR
CGB	COLLECTOR GROUND BAR
MGB	MAIN GROUND BAR

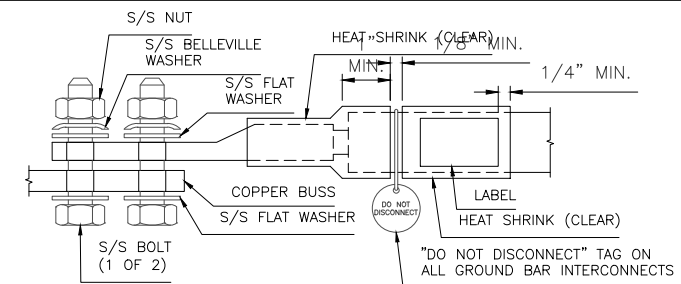

NOTES:

- ALL HARDWARE 18-8 STAINLESS STEEL INCLUDING BELLEVILLES. COAT ALL SURFACES WITH ANTI-OXIDATION COMPOUND BEFORE MATING.
- FOR GROUND BOND TO STEEL ONLY: INSERT A DRAGON TOOTH WASHER BETWEEN LUG AND STEEL, COAT ALL SURFACES WITH ANTI-OXIDATION COMPOUND.
- COAT ALL BARRELS WITH ANTI-OXIDATION COMPOUND BEFORE CRIMPING.

1 GENERAL LUG DETAIL  
G-1

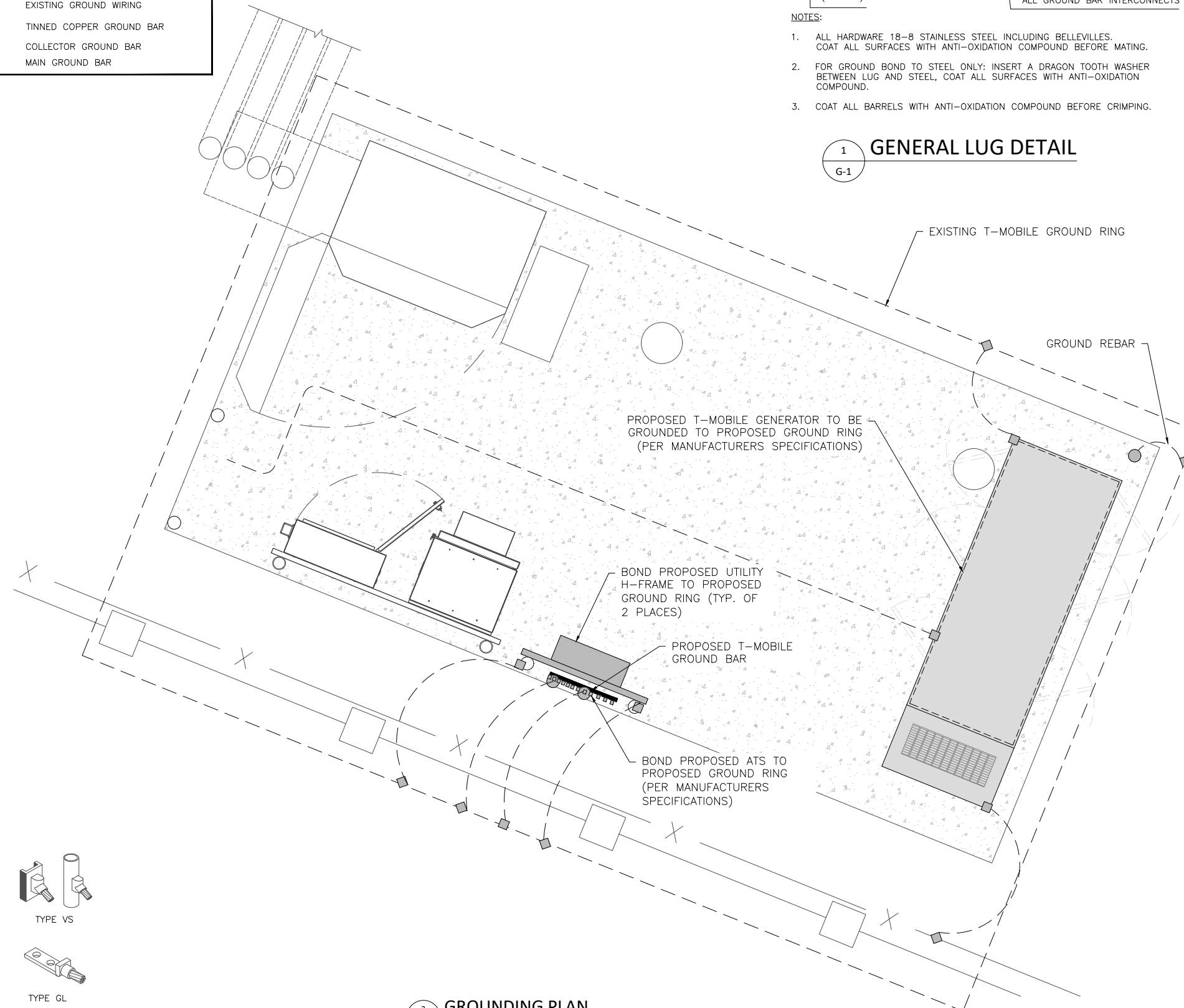

3 GROUNDING PLAN  
G-1

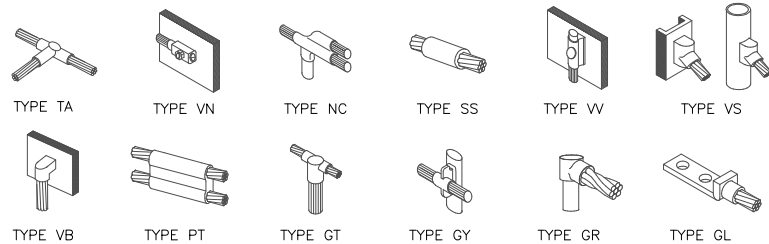
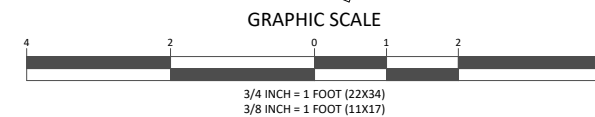

2 GROUNDING CONNECTION DETAILS  
G-1

**T-Mobile**  
NORTHEAST LLC

T-MOBILE NORTHEAST, LLC.  
35 GRIFFIN RD S  
BLOOMFIELD, CT 06002  
PHONE: (860) 629-1700



750 W CENTER ST, SUITE 301  
WEST BRIDGEWATER, MA 02379  
PHONE: 781.713.4725

REVISIONS

REV	DATE	DESCRIPTION	BY
0	12/07/21	ISSUED FOR CONSTRUCTION	SS
A	10/01/21	ISSUED FOR REVIEW	RL

DESIGNED BY: RL	APPROVED BY: WRD
--------------------	---------------------

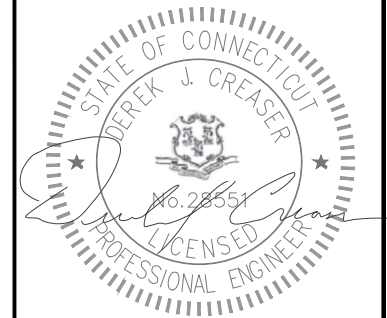

DATE: 12/07/2021

IT IS A VIOLATION OF LAW FOR ANY PERSON UNLESS THEY ARE ACTING UNDER THE DIRECTION OF A LICENSED PROFESSIONAL ENGINEER TO ALTER THIS DOCUMENT. UNLESS EXPLICITLY AGREED TO BY THE ENGINEER IN WRITING, THE ENGINEER DISCLAIMS ALL LIABILITY ASSOCIATED WITH THE REUSE, ALTERATION OR MODIFICATION OF THE CONTENTS HEREIN.

SITE NAME: TMO CTNH442A
SITE ID: CTNH442A
SITE ADDRESS: 150 WILLOW STREET HAMDEN, CT 06518 NEW HAVEN COUNTY
SHEET TITLE: GROUNDING PLAN
DRAWING: G-1

# Generac RD025 Design Document

Diesel, AC, 25kW External Fill Tank Model#7192-0 SKU#33651

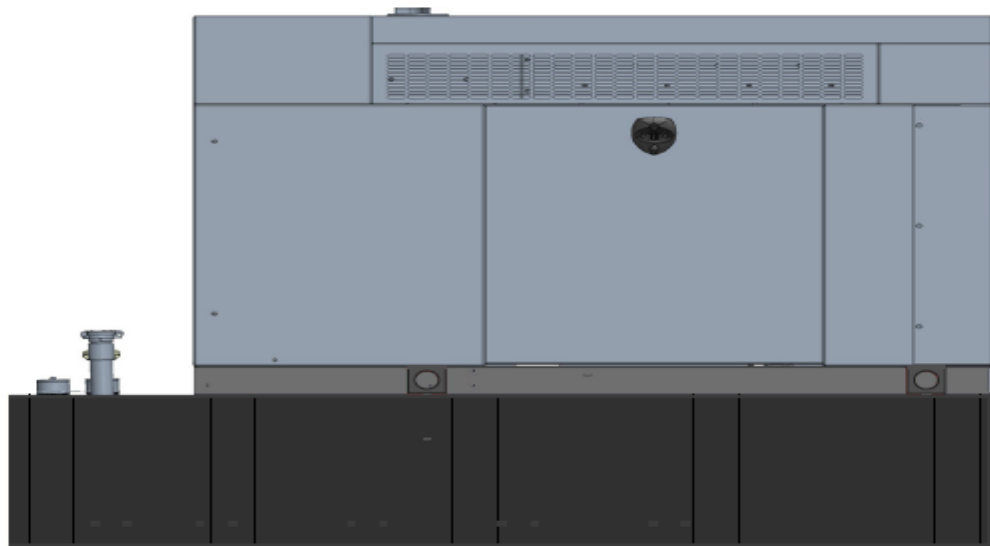

The following are responsible for this project document:

Kevin Smith

SR. Engineer (770) 256-3594

Project Design Spec Revision	1.0	Last Date:08/23/2018	5/14/2018
Final doc URL (~Dnnnnn):			
Location	Use the InfoRouter Search (Advanced) putting the Document ID (nnnnn without the D) to find the location of the master document.		
Template URL:	<a href="http://docs.eng.t-mobile.com/InfoRouter/docs/~D423750">http://docs.eng.t-mobile.com/InfoRouter/docs/~D423750</a>	Slightly updated 1/2011	

## Table of Contents

<b>1</b>	<b>Introduction / Project Summary .....</b>	<b>3</b>
1.1	Purpose of Project	3
1.2	Feature Description	3
1.3	Dimensions	3
<b>2</b>	<b>Fuel Tanks.....</b>	<b>4</b>
<b>3</b>	<b>RXSC200A3 ATS/ Controller .....</b>	<b>4</b>
3.1	Hardware	4
<b>4</b>	<b>Architecture/Alarms.....</b>	<b>7</b>
4.1	Interfaces and Alarming	7
<b>5</b>	<b>Regulatory Requirements .....</b>	<b>9</b>
<b>6</b>	<b>Configuration/Diagrams .....</b>	<b>9</b>
<b>7</b>	<b>Maintenance.....</b>	<b>14</b>

# 1 Introduction / Project Summary

## 1.1 Purpose of Project

T-Mobile’s nationwide cell site hardening plan is providing a refuellable backup power system capable of powering a site for a minimum of 48 hours before refueling is required. The purpose of this project is to give T-Mobile customers reliable service during power outages and provide a sufficient layer of coverage. This design document is for Generac’s RD025 model#7192-0, which is a Diesel AC generator with a capacity of 25kW.

## 1.2 Feature Description

The Generac RD025 is a 25kW AC, diesel generator is one of the generators selected as part of the T-Mobile RFP in support of the nationwide cell site hardening plan. The RD025 has a Level 2 acoustic enclosure, 3 phase sensing, and +/-0.25% digital voltage regulation. It is equipped with RS232, RS485 and canbus remote ports and Evolution control panel. It is also equipped with a automatic transfer switch, the RXSC200A3 (Automatic Transfer Switch) Controls the process of transferring commercial AC power and generator power. The RXSC200A3 is a 200Amp, switch that is programmed to perform engine test runs and also has adjustable engine run time capabilities. For RXSC200A3 Owners Manual and full feature descriptions [LINK](#)

## 1.3 Dimensions

The dimensions of a level 2 Acoustic Enclosure L x W x H in inches 103.4 x 35 x 91.7. T-Mobile requires a 36-inch radius around the generator that will cover the 18” door swing on the generator.

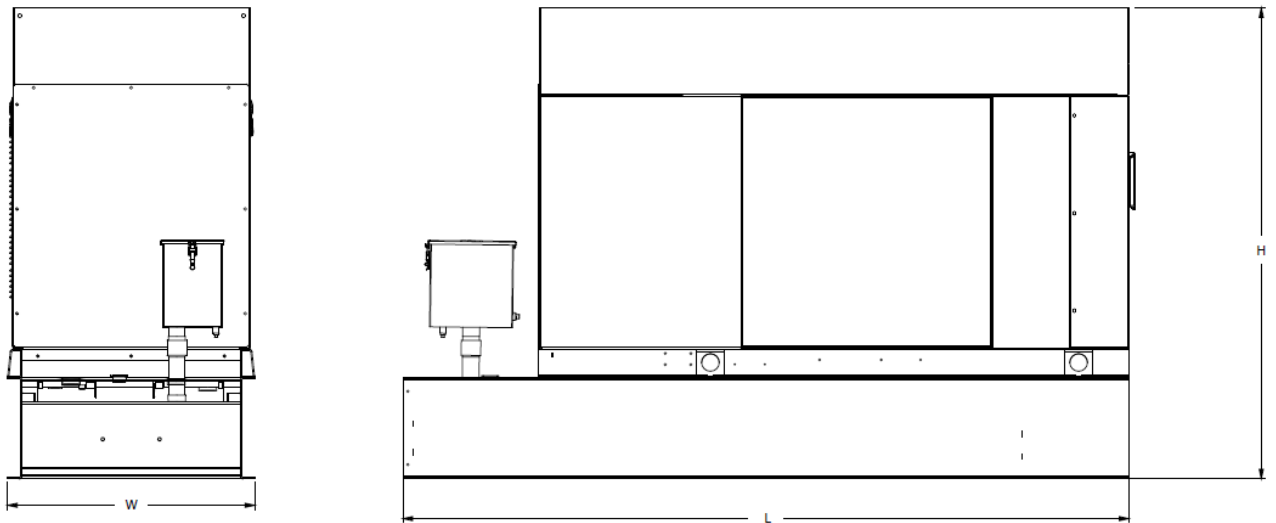

Weights and Dimensions

Unit Weight - lbs	Unit Weight with Skid - lbs	Dimensions (L x W x H) - in
2,123	2,161	103.4 x 35.0 x 73.8



## 2 Fuel Tanks

The RD025 has a 102.7" 240 Gallon Double-Wall UL142 Base tank to provide 98 hours of backup power at full load deployed on site. Below is the Install drawing for the 240-gallon tank for the RD025kW.

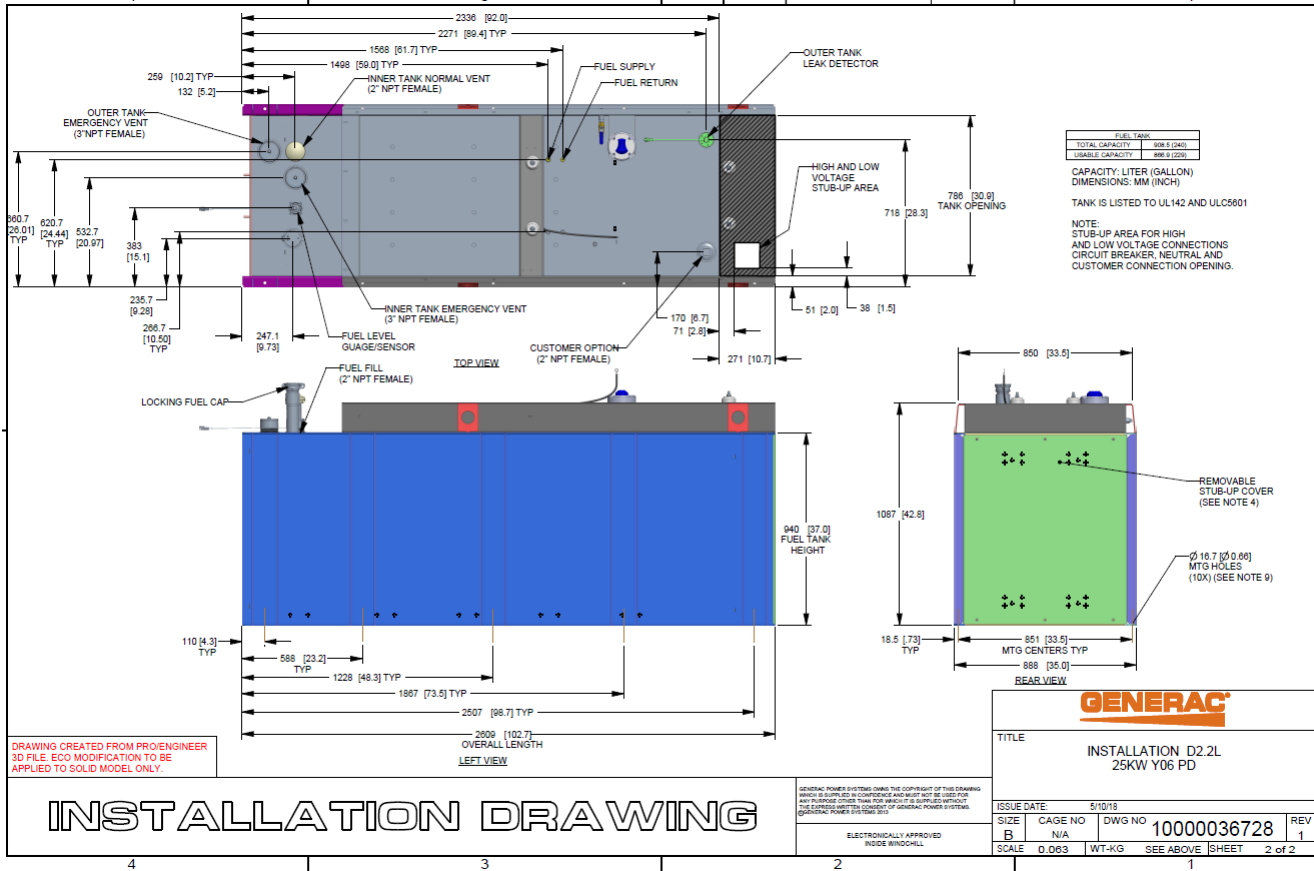

## 3 RXSC200A3 ATS/ Controller

### 3.1 Hardware

The RD025 will come with a RXSC200A3 and an Evollution controller. The sites considered for the RD025 should not have a DC power consumption above 20kW

RXSC200A3 [Link](#)

RXSC200A3 install drawing [Link](#)

Evolution controller spec sheet [Link](#)

RD025 installation drawings and supporting documentation [Link](#)

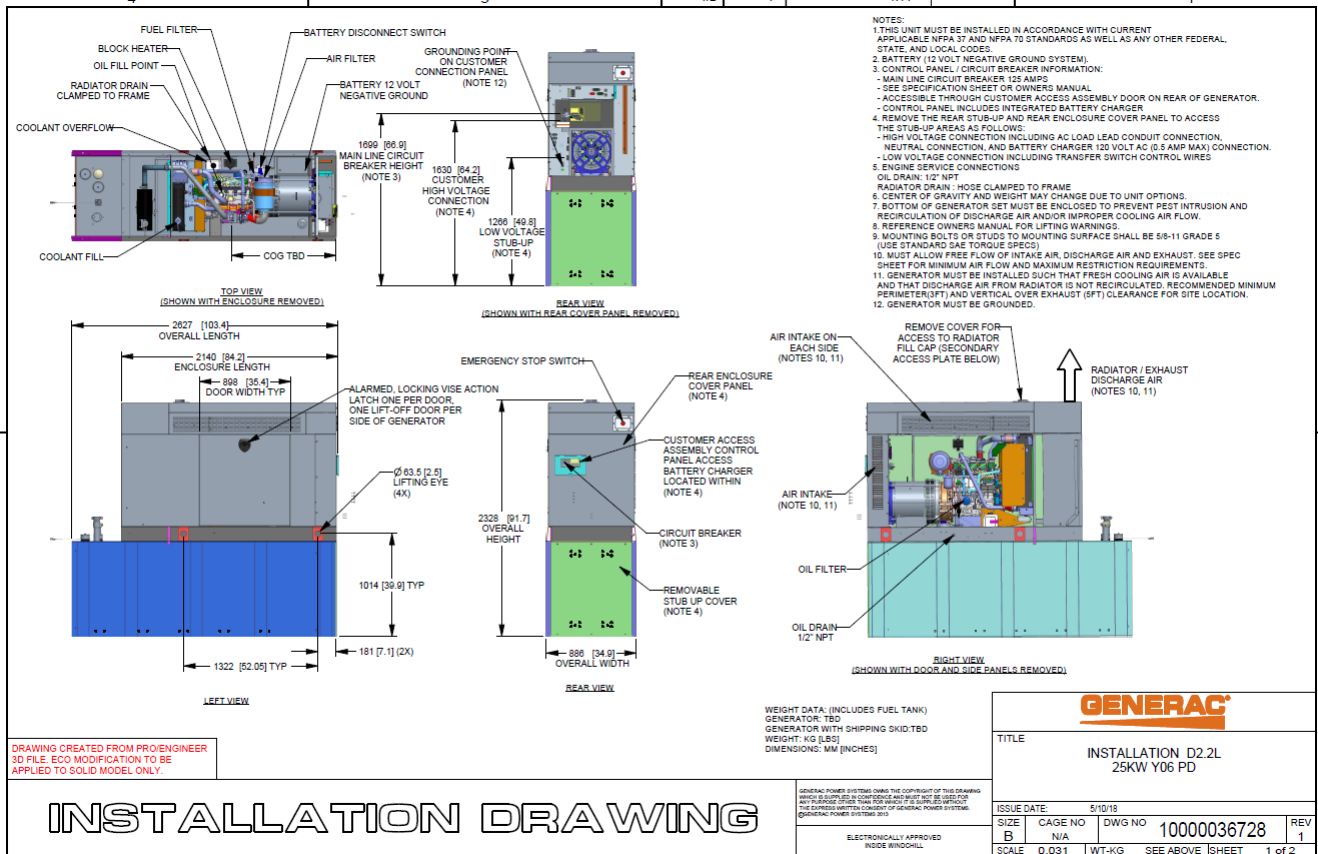

### 3.2 RXSC200A3 Automatic Transfer Switch

The RXSC200A3 (Automatic Transfer Switch) is equipped with the following functions. Utility voltage drop-out <65%. Timer to Generator start: 10 second factory set, adjustable between 2-1500 seconds. Engine Warm up delay: 5 seconds. Standby Voltage Sensor: 65% for 5 seconds. Utility Voltage Pickup >80%. Re-Transfer Time Delay: 15 seconds. Engine Cool-Down Timer: 60 seconds. Exerciser: 5 or 12 minute adjustable weekly/by-weekly/monthly. The transfer switch can also be operated manually without power applied

**RXSC200A3 Dimensions**

Model		RXSC200A3
Height (in./mm)	H1	17.24/437.9
	H2	20/508
Width (in./mm)	W1	12.5/317.5
	W2	14.6/370.8
Depth (in./mm)		7.09/180.1
Weight (lbs./kilos)		20/9.07

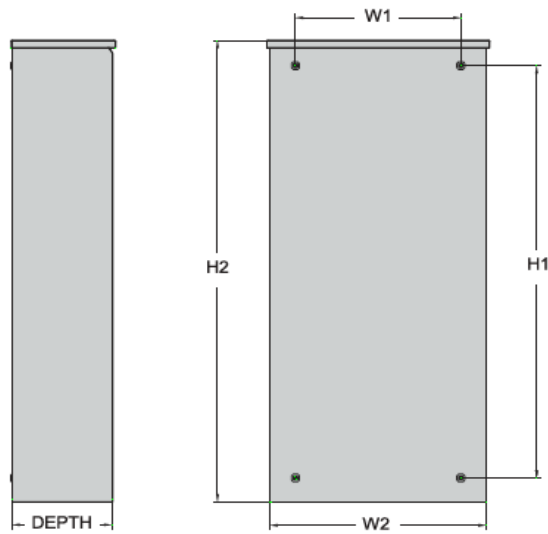

## 4 Architecture/Alarms

### 4.1 Interfaces and Alarming

The generator will be monitored by external alarms, conduit and cat five cables have to be installed from the Evolution Controllers Low Voltage Box located in the Generac generator to the appropriate cell site equipment. Nokia FSEB or FSEE and in Ericsson the SAU.

At a Nokia site, this connection is at the FSEB or an FSEE module. For the wiring diagram and instructions for the FSEB click the [Link](#) (The FSEE is the Nokia module that will be replacing the FSEB. For details on the FSEE contact: HQNokiaCellsiteDesigns@T-Mobile.com)

Ericsson sites will connect to the SAU module via OVP Expansion Kit for 8 External Alarms. Product number: UTOVP-ALM8EXP. For the wiring diagram and instructions for this click the [link](#)

The RXSC200A3 has auxiliary contacts that will facilitate the *ATS in Emergency position* alarm and will be a Normally Closed contact. Below is the wiring schematic for this contact and it can be found in the RXSC200A3 owners manual.

#### Auxiliary Contact

See [Figure 3-4](#). If desired, there is one normally-closed Auxiliary Contact (A) on the transfer switch to operate customer accessories, remote advisory lights, or remote annunciator devices. A suitable power source must be connected to the common terminal. If needed, an extra auxiliary contact can be added.

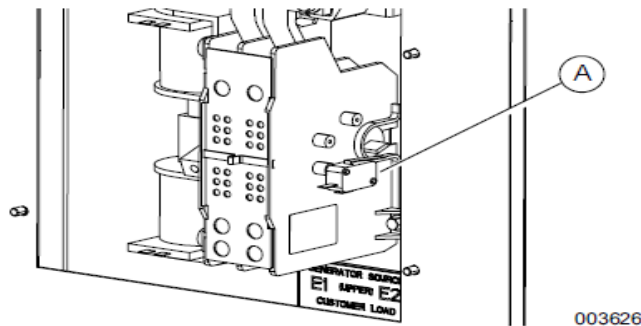

**Figure 3-4. Auxiliary Contact**

The auxiliary contact is normally closed when the transfer switch is in utility mode. The contacts will open when the transfer switch is in the standby power mode.

**NOTE:** Auxiliary Contact is rated 10 amps at 125 or 250 volts AC, and 0.6 amps at 125 volts DC.

**CAUTION**

Equipment damage. Exceeding rated voltage and current will damage the auxiliary contacts. Verify that voltage and current are within specification before energizing this equipment.

(000134a)

T-Mobile has four relays available from the Generac controller that are user-defined. T-Mobile can have four-alarm categories and a limitless number of subcategories. T-Mobile will utilize Normally Closed (NC) dry contacts for alarms in Low Voltage Connection box in the spare outputs section. Ericsson cabinets need to be equipped with the alarm expansion kit (UTOVP-ALM8EXP) to handle external alarms.

Customer Connections Inside the RD025

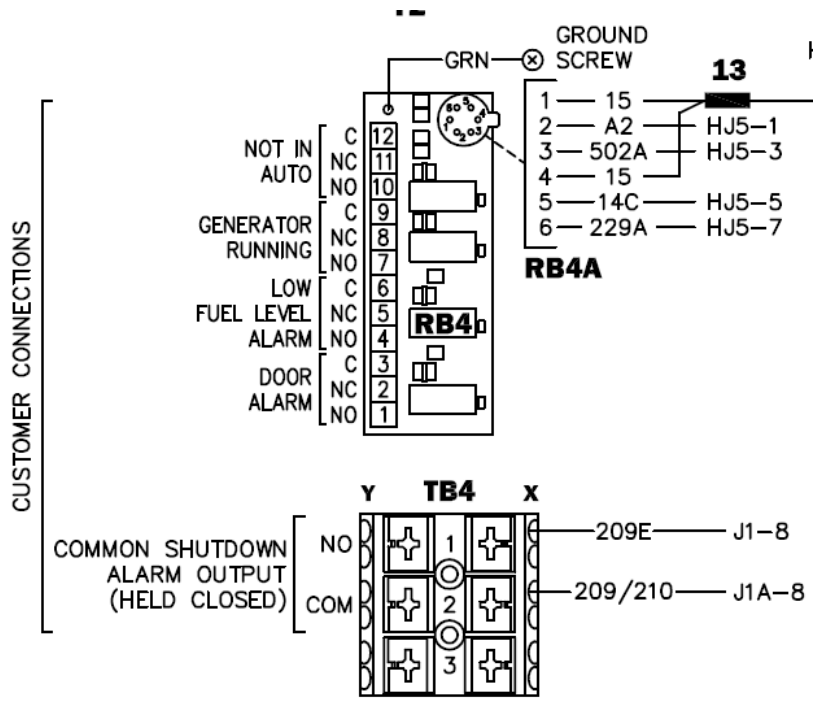

Ericsson UTOVP- ALM8EXP



UTOVP-ALM8EXP	OVP Expansion Kit for 8 External Alarms	Qty
<b>Product no</b>	<b>Denomination</b>	
UTOVP-ALM8EXP	OVP Expansion Kit for 8 External Alarms	1
NFD30234/08	OVERVOLTAGE ARRESTER/OVP-ALM 8	1
RPM777143/01200	CABLE WITH CONNECTOR/SIGNAL CABLE	2

Evolution Controller Customer Connections	Nokia FSEB Alarm Connections 13-24	T-Mobile Standard Alarms
NC#8-Gen Running	NC 4110 grd 4111 pin 13	Generator Running
NC#11-Not In Auto	NC 4110 grd 4111 pin 14	Generator Alarm Critical
NC#2-Door Alarm	NC 4110 grd 4111 pin 15	Generator Alarm NSI
NC#5-Low Fuel	NC 4110 grd 4111 pin 16	Low Fuel
RXSC200A3-Auxiliary Contacts	NC 4110 grd 4111 pin 17	ATS in Emergency Position

Evolution Controller Customer Connections	Ericsson Alarm 8expConnections	T-Mobile Standard Alarms
NC#8- Gen. Running	NC - A5	Generator Running
NC#11-Not In Auto	NC - A6	Generator Alarm Critical
NC#2-Door Alarm	NC - A7	Generator Alarm NSI
NC#5-Low Fuel	NC - A8	Low Fuel
RXSC200A3-Auxiliary Contacts	NC - A9	ATS in Emergency Position

## 5 Regulatory Requirements

Level 2 Acoustic Enclosure provides a noise level of 67.5dBA. It is EPA certified and meets NFPA 99 and 110 requirements(NFPA National Fire Protection Association). The RD025 generator engines is a tier 4 engine and meets the EPA final standards.

## 6 Configuration/Diagrams

The physical configuration of the Generator and the RXSC200A3 is, ATS before the PPC to ensure overcurrent protection when commercial power is restored. The RD025 and the RXSC200A3 has to be wired to Commercial AC power.

Commercial Power Connection Points  
On The RXSC200A3

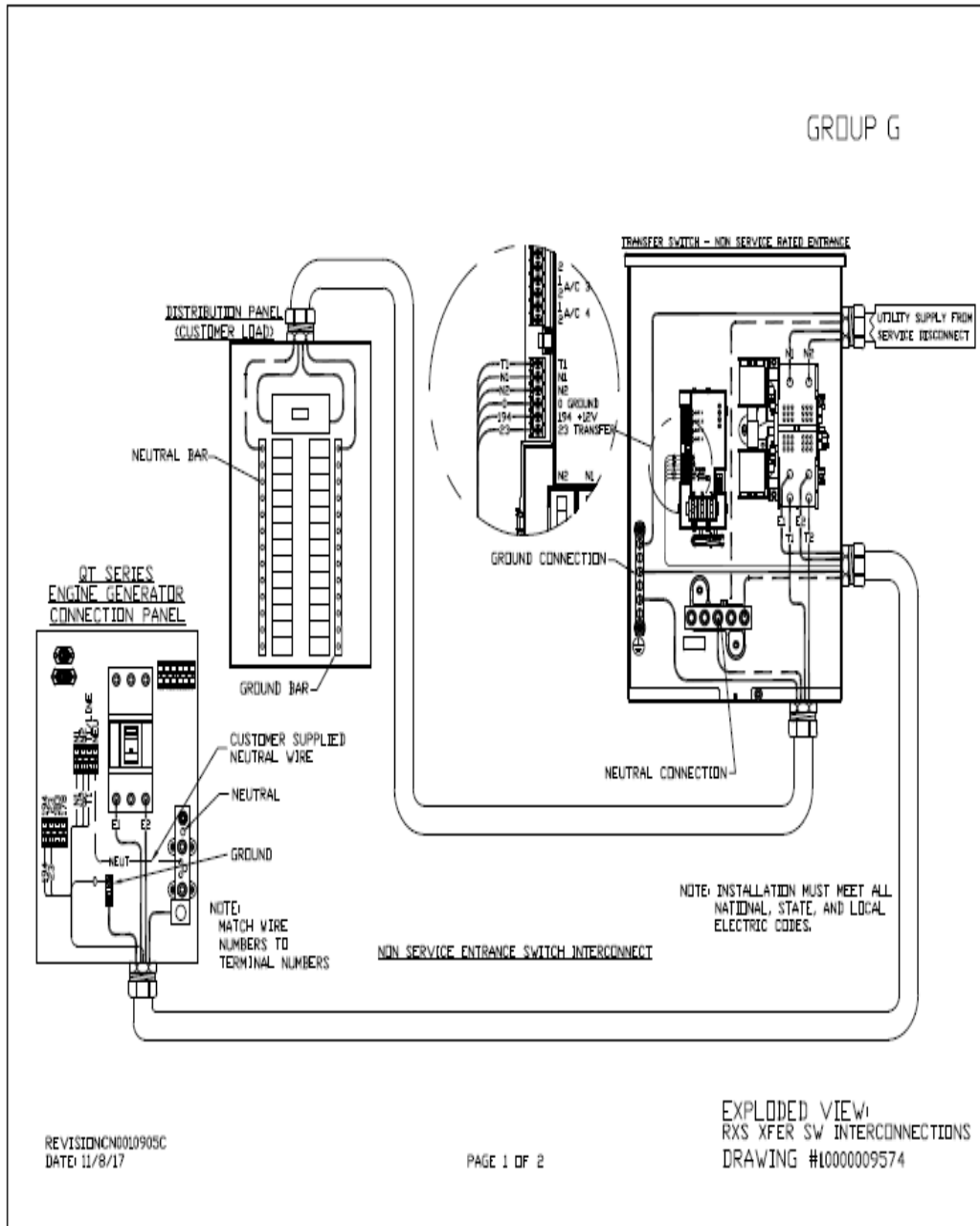



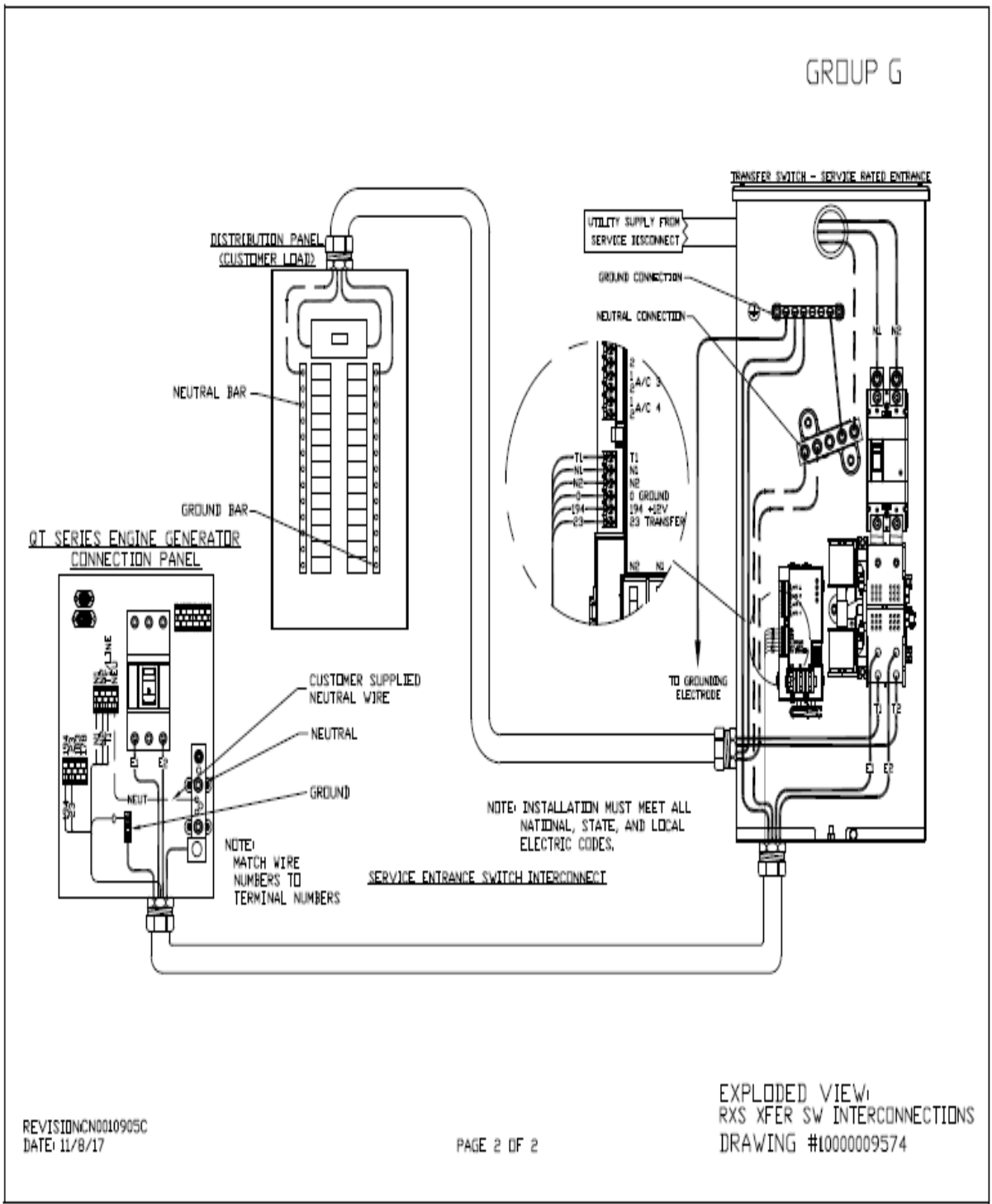

### Compound Diagram:

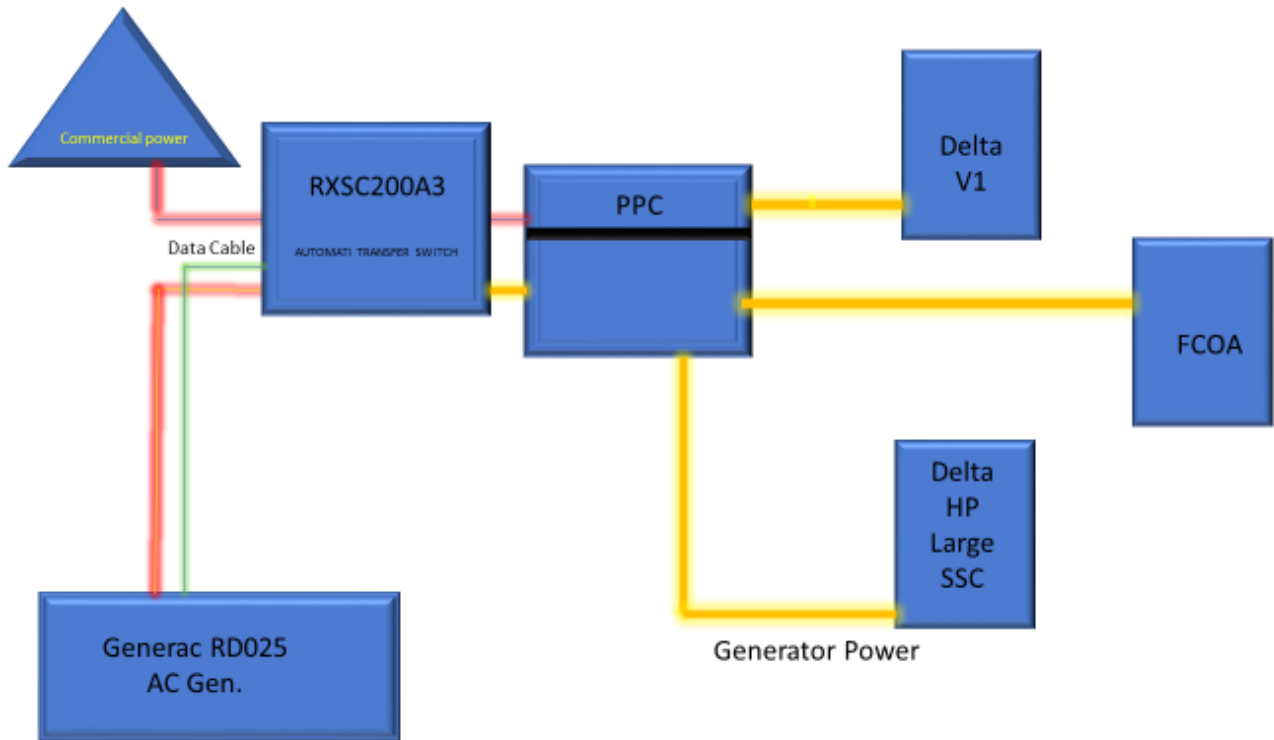

## 7 Maintenance

---

T-Mobile is recommending preventive maintenance to be performed every 250 hours of run-time or every 12 months, whichever comes first.

T-Mobile requires this minimum service checklist for the generator engine:

- Check engine mounts and support. Tighten fasteners.
- Check all the engine hoses and clamps for proper fit, and any signs of cracking and fatigue from wear.
- Inspect all belts for signs of cracking and fatigue from wear and adjust for proper tension.
- Inspect the exhaust system for leaks, burns and wet stacking. Drain exhaust line and tighten any clamps and flange bolts.
- Inspect silencer and plumbing for leaks, cracks or any other signs of wear.
- Inspect the system for fuel, oil and coolant leaks and signs of corrosion.
- Replace water separator.
- Replace water filter/ conditioner.
- Check Anti-Freeze (Spector-Analysis).
- Check coolant level and add, if needed.
- Inspect radiator mounting for signs or wear and cracking.
- Inspect/ clean air filter and change per manufacturer specifications.
- Inspect air intakes and outlets and tighten clamps and brackets, if applicable.
- Replace fuel filter.
- Inspect the carburetor fuel injection system, fuel injection pump and choke, if equipped. Adjust to manufacturers specifications.
- Change engine oil, oil filter and record the date on the filter casing.
- Check engine heater operation, if equipped.
- Check and adjust the battery charger operations, and charge rate within the manufacturer's recommended operating specifications.

- Inspect the battery housing, hardware connections, and cables for corrosion and wear.
- Check the battery electrolyte levels and specific gravity levels.
- Load test generator battery.
- Check, adjust and record generator output voltage, as necessary.
- Check and record the alternator charge rate.
- During inspection run the generator for 30 minutes under load. During this time, and after the engine is at full operational speed and has reached engine operating temperature; determine and record the condition of all inspection points: oil pressure, water/ coolant temperature, Fuel pressure, generator gauge, indicator operations, generator battery.
- Check the engine timing and adjust to manufacturers specifications, if necessary.
- Inspect, adjust and record governor and frequency, if necessary.
- Verify that the low fuel alarm is operational and configured correctly to trigger when the fuel tank reaches 50% of fuel tank capacity.

Check fuel level and refuel the generator during the preventive/ corrective maintenance visit.

# Exhibit D

**Proof of Postage**

UPS CampusShip: View/Print Label

- 1. **Ensure there are no other shipping or tracking labels attached to your package.** Select the Print button on the print dialog box that appears. Note: If your browser does not support this function select Print from the File menu to print the label.
- 2. **Fold the printed label at the solid line below.** Place the label in a UPS Shipping Pouch. If you do not have a pouch, affix the folded label using clear plastic shipping tape over the entire label.
- 3. **GETTING YOUR SHIPMENT TO UPS**  
**Customers with a Daily Pickup**  
 Your driver will pickup your shipment(s) as usual.

**Customers without a Daily Pickup**

Take your package to any location of The UPS Store®, UPS Access Point(TM) location, UPS Drop Box, UPS Customer Center, Staples® or Authorized Shipping Outlet near you. Items sent via UPS Return Services(SM) (including via Ground) are also accepted at Drop Boxes. To find the location nearest you, please visit the Resources area of CampusShip and select UPS Locations.



Schedule a same day or future day Pickup to have a UPS driver pickup all your CampusShip packages.  
Hand the package to any UPS driver in your area.

UPS Access Point™  
CVS STORE # 1060  
326 MAIN ST  
SOUTHINGTON ,CT 06489

UPS Access Point™  
MICHAELS STORE # 1279  
99 EXECUTIVE BLVD  
SOUTHINGTON ,CT 06489

UPS Access Point™  
ADVANCE AUTO PARTS STORE 8525  
151 QUEEN ST  
SOUTHINGTON ,CT 06489

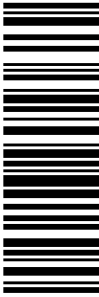
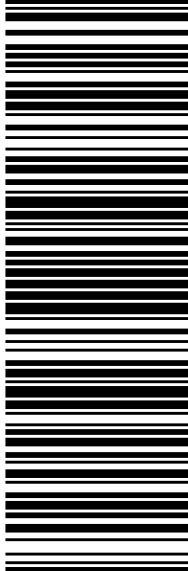
FOLD HERE

<p>MARK APPLEBY 8602094694 CENTERLINE COMMUNICATIONS 90 HAMILTON AVENUE SOUTHINGTON CT 06489-3883</p> <p><b>SHIP TO:</b> MELANIE A. BACHMAN 18608272935 CONNECTICUT SITING COUNCIL EXECUTIVE DIRECTOR TEN FRANKLIN SQUARE <b>NEW BRITAIN CT 06051-2655</b></p>	<p><b>1 LBS</b> <b>1 OF 1</b> DWT: 12,10,1</p> <p><b>CT 067 9-06</b></p> 	<p><b>UPS GROUND</b> TRACKING #: 1Z 9Y4 503 P2 1410 5058</p> 	<p><b>BILLING: P/P</b> <b>ATTENTION UPS DRIVER: SHIPPER RELEASE</b></p>  <p>CS 22.0.18. WNTNV50 50.0A 12/2021*</p>
--------------------------------------------------------------------------------------------------------------------------------------------------------------------------------------------------------------------------------------------------------------------------------------------------------	------------------------------------------------------------------------------------------------------------------------------------------------------------------	------------------------------------------------------------------------------------------------------------------------------------------------------	-------------------------------------------------------------------------------------------------------------------------------------------------------------------------------------------------------------



# Shipment Receipt

**Transaction Date:** 07 Dec 2021

**Tracking Number:**

1Z9Y4503P214105058

## 1 Address Information

<b>Ship To:</b>	<b>Ship From:</b>	<b>Return Address:</b>
Connecticut Siting Council Melanie A. Bachman Ten Franklin Square Executive Director NEW BRITAIN CT 060512655 Telephone:18608272935	Centerline Communications Mark Appleby 90 Hamilton Avenue SOUTHINGTON CT 064893883 Telephone:8602094694 email:mappleby@clinellc.com Residential	Centerline Communications Mark Appleby 90 Hamilton Avenue SOUTHINGTON CT 064893883 Telephone:8602094694 email:mappleby@clinellc.com Residential

## 2 Package Information

	Weight	Dimensions / Packaging	Declared Value	Reference Numbers
1.	0.7 lbs (1.0 lbs billable)	12 x 10 x 1in. Other Packaging		

## 3 UPS Shipping Service and Shipping Options

**Service:** UPS Ground Service  
**Delivered By:** End of Day Wednesday, Dec 8, 2021



Please note that extremely high volume on November 14, 2021 - January 15, 2022 may add one day in transit for a small number of Ground shipments. See if you may be affected:  
[Check for Service Impacts](#)

<b>Shipping Fees Subtotal:</b>	9.72 USD	<b>Additional Shipping Options</b>	
<b>Transportation</b>	8.76 USD	<b>Deliver Without Signature</b>	
<b>Fuel Surcharge</b>	0.96 USD	Package1: Deliver Without Signature	0.00 USD
		<b>Quantum View Notify E-mail Notifications:</b>	No Charge
		1 mappleby@clinellc.com: Ship	

## 4 Payment Information

**Bill Shipping Charges to:** Shipper's Account 9Y4503

<b>Shipping Charges:</b>	9.72 USD
<b>Subtotal Shipping Charges:</b>	9.72 USD
<b>Total Charged:</b>	9.72 USD

Note: This document is not an invoice. Your final invoice may vary from the displayed reference rates.

\* For delivery and guarantee information, see the UPS Service Guide ({}). To speak to a customer service representative, call 1-800-PICK-UPS for domestic services and 1-800-782-7892 for international services.