



STATE OF CONNECTICUT
CONNECTICUT SITING COUNCIL

Ten Franklin Square, New Britain, CT 06051

Phone: (860) 827-2935 Fax: (860) 827-2950

E-Mail: siting.council@ct.gov

Web Site: portal.ct.gov/csc

VIA ELECTRONIC MAIL

October 31, 2022

Katie Adams
SR Site Acquisition Specialist
Network Building & Consulting
100 Apollo Drive, Suite 303
Chelmsford, MA 01824
kadams@nbcllc.com

RE: EM-VER-052-220908 – Cellco Partnership d/b/a Verizon Wireless notice of intent to modify an existing telecommunications facility located at 8040 Birdseye Road, Farmington, Connecticut.

Dear Katie Adams:

The Connecticut Siting Council (Council) is in receipt of your correspondence of October 24, 2022 submitted in response to the Council's October 14, 2022 notification of an incomplete request for exempt modification with regard to the above-referenced matter.

The submission renders the request for exempt modification complete and the Council will process the request in accordance with the Federal Communications Commission 60-day timeframe.

Thank you for your attention and cooperation.

Sincerely,

Melanie A. Bachman
Executive Director

MAB/MP /emr

From: Katie Adams <kadams@nbcllc.com>
Sent: Monday, October 24, 2022 3:10 PM
To: Fontaine, Lisa <Lisa.Fontaine@ct.gov>
Cc: CSC-DL Siting Council <Siting.Council@ct.gov>
Subject: RE: EM-VER-052-220908 - Birdseye Road, Farmington - Incomplete

EXTERNAL EMAIL: This email originated from outside of the organization. Do not click any links or open any attachments unless you trust the sender and know the content is safe.

Good Afternoon,

Please see the attached Signed and Stamped modification drawings for Verizon at Birdseye Road in Farmington. Please let me know if you need any additional documentation.

Thank you!

Katie Adams
SR Site Acquisition Specialist

NETWORK BUILDING + CONSULTING
100 Apollo Drive | Suite 303 | Chelmsford, MA | 01824
M 781-392-7547





**MOUNT MODIFICATION DRAWINGS
EXISTING 15.50' PLATFORM**

**TOWER OWNER: CROWN CASTLE
TOWER OWNER SITE NUMBER: 876335**

**CARRIER SITE NAME: NEW BRITAIN 5 CT
CARRIER SITE NUMBER: 467249
FUZE ID: 16244128**

**130 BIRDSEYE ROAD
FARMINGTON, CT 06032
HARTFORD COUNTY**

**LATITUDE: 41.71581666° N
LONGITUDE: 72.81039444° W**

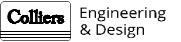

www.colliersengineering.com

Copyright © 2022. All Rights Reserved. The design of all the information contained herein is the property of Colliers Engineering & Design, Inc. All other information contained herein is the property of its respective owner. Reproduction or distribution of this document without the express written consent of Colliers Engineering & Design, Inc. is prohibited.

Doing Business as MASER



811 PROTECT YOURSELF
ALL STATES REQUIRE NOTIFICATION OF
UTILITY LOCATIONS OR ANY PERSON
PREPARING TO EXCAVATE THE EARTH'S
SURFACE OWNERS IN ANY STATE

Know what's below.
Call before you dig.

FOR STATE SPECIFIC 811 CALL PHONE NUMBERS VISIT:
WWW.CALL811.COM

SCALE	AS SHOWN	CONVERSION	22777025A
REV	DATE	DESCRIPTION	BY

Digitally signed by Peter Albano
Date: 2022.05.25 14:22:04 -0400

IT IS A VIOLATION OF LAW FOR ANY PERSON,
UNLESS THEY ARE ACTING UNDER THE DIRECTION
OF THE RESPONSIBLE LICENSED PROFESSIONAL
ENGINEER, TO ALTER THIS DOCUMENT.

SITE NAME:
**NEW BRITAIN 5 CT
467249**
**130 BIRDSEYE ROAD
FARMINGTON, CT 06032
HARTFORD COUNTY**

STAMPED
1055 Washington Boulevard
Farmington, CT 06031
Phone: 203.374.0800
COLLIERS ENGINEERING & DESIGN, CT, INC.
DESIGN: 16 (2022) 05 (MOUNT MOD) 001

TITLE SHEET

ST-1

DESIGN CRITERIA
WIND LOADS BASIC WIND SPEED (3 SECOND GUST), V = 117 MPH EXPOSURE CATEGORY B TOPOGRAPHIC METHOD II TOPOGRAPHIC CONSIDERED N/A MEAN BASE ELEVATION (AMSL) = 413.61'
ICE LOADS ICE WIND SPEED (3 SECOND GUST), V = 50 MPH ICE THICKNESS = 1.50 IN
SEISMIC LOADS SEISMIC DESIGN CATEGORY B SHORT TERM MCEER GROUND MOTION, S ₁ = .189 LONG TERM MCEER GROUND MOTION, S ₂ = .055

PROJECT INFORMATION
APPLICANT/LESSEE COMPANY: VERIZON WIRELESS CLIENT REPRESENTATIVE COMPANY: VERIZON WIRELESS PROJECT MANAGER COMPANY: COLLIERS ENGINEERING & DESIGN CONTACT: PETER ALBANO PHONE: 856.797.0412 E-MAIL: PETER.ALBANO@COLLIERSENGINEERING.COM

CONTRACTOR PMI REQUIREMENTS
PMI LOCATION: HTTPS://PMI.VZWSMART.COM SMART TOOL PROJECT #: 10149043 VZSW LOCATION CODE (PSLC): 467249 ANALYSIS DATE: 5/25/2022 PMI REQUIREMENTS EMBEDDED WITHIN MOUNT MODIFICATION REPORT

SHEET INDEX																		
<table border="1"> <tr> <th>SHEET</th> <th>DESCRIPTION</th> </tr> <tr> <td>ST-1</td> <td>TITLE SHEET</td> </tr> <tr> <td>SBO-M</td> <td>BILL OF MATERIALS</td> </tr> <tr> <td>SGN-1</td> <td>GENERAL NOTES</td> </tr> <tr> <td>SCF-1</td> <td>CLIMBING FACILITY DETAIL</td> </tr> <tr> <td>SS-1</td> <td>MODIFICATION DETAILS</td> </tr> <tr> <td>SS-2</td> <td>GEOMETRY VERIFICATION SKETCHES</td> </tr> <tr> <td>SS-3</td> <td>MOUNT PHOTOS</td> </tr> <tr> <td></td> <td>SPECIFICATION SHEETS</td> </tr> </table>	SHEET	DESCRIPTION	ST-1	TITLE SHEET	SBO-M	BILL OF MATERIALS	SGN-1	GENERAL NOTES	SCF-1	CLIMBING FACILITY DETAIL	SS-1	MODIFICATION DETAILS	SS-2	GEOMETRY VERIFICATION SKETCHES	SS-3	MOUNT PHOTOS		SPECIFICATION SHEETS
SHEET	DESCRIPTION																	
ST-1	TITLE SHEET																	
SBO-M	BILL OF MATERIALS																	
SGN-1	GENERAL NOTES																	
SCF-1	CLIMBING FACILITY DETAIL																	
SS-1	MODIFICATION DETAILS																	
SS-2	GEOMETRY VERIFICATION SKETCHES																	
SS-3	MOUNT PHOTOS																	
	SPECIFICATION SHEETS																	

**COPYRIGHT ©2022
COLLIERS ENGINEERING & DESIGN
ALL RIGHTS RESERVED**
THIS DRAWING AND ALL THE INFORMATION CONTAINED HEREIN IS AUTHORIZED FOR USE ONLY BY THE PARTY FOR WHOM THE WORK WAS CONTRACTED OR TO WHOM IT IS CERTIFIED. THIS DRAWING MAY NOT BE COPIED, REUSED, DISCLOSED, DISTRIBUTED OR RELIED UPON FOR ANY OTHER PURPOSE WITHOUT THE EXPRESS WRITTEN CONSENT OF COLLIERS ENGINEERING & DESIGN.

NOTE: DO NOT SCALE DRAWINGS FOR CONSTRUCTION.

BILL OF MATERIALS

SECTION 1 - VZWSMART KITS

QUANTITY	MANUFACTURER	PART NUMBER	DESCRIPTION	NOTES	UNIT WEIGHT (LBS.)	WEIGHT (LBS.)
3	VZWSMART	VZWSMART-PLK3	SUPPORT RAIL CORNER BRACKET		30	90
3		VZWSMART-P40-238X072	72" LONG, PIPE 2 STD (2.375"OD X 0.154" THK)		22	66
9		VZWSMART-MSKI	CROSSOVER PLATE		14	126

SECTION 2 - OTHER REQUIRED PARTS

QUANTITY	MANUFACTURER	PART NUMBER	DESCRIPTION	NOTES	UNIT WEIGHT (LBS.)	WEIGHT (LBS.)
3	-	-	186" LONG, P2 1/2 STD	GALVANIZED	90	270
3	-	-	36" LONG, L3X3X1/4	GALVANIZED	15	45
3	SITE PRO I	SP219	CROSSOVER PLATE	OR EOR APPROVED EQUAL, CONTACT MASER CONSULTING FOR APPROVAL OF SUBSTITUTION.	13	39
TOTAL:						636

NOTES:

- THE MANUFACTURERS LISTED ARE THE APPROVED VENDORS FOR THE VZW MOUNT KITS. EACH MANUFACTURER WILL BE AWARE OF WHICH KITS HAVE BEEN THROUGH THE VZW APPROVAL PROCESS AND THEY ARE IN TURN APPROVED TO SELL. PLEASE NOTE THAT THE MATERIAL UTILIZED ON THE MOUNT MODIFICATIONS WILL BE REVIEWED AS A PART OF THE DESKTOP PMI COMPLETED BY THE SMART TOOL VENDOR. IT WILL BE REQUIRED THAT THE VZW KITS SPECIFIED ARE UTILIZED IN THE MODIFICATIONS.
- ALL MATERIALS REQUIRED FOR THE DESIGNED MODIFICATIONS BUT NOT LISTED IN THIS SHEET ARE ASSUMED TO BE PROVIDED BY THE CONTRACTOR.

VZWSMART KITS - APPROVED VENDORS

COMMSCOPE	
CONTACT	SALVADOR ANGUIANO
PHONE	(817) 304-7492
EMAIL	SALVADOR.ANGUIANO@COMMSCOPE.COM
WEBSITE	WWW.COMMSCOPE.COM
METROSITE FABRICATORS, LLC	
CONTACT	KENT RAMEY
PHONE	(706) 335-7045 (O), (706) 982-9788 (M)
EMAIL	KENT@METROSITELLC.COM
WEBSITE	METROSITEFABRICATORS.COM
PERFECT VISION	
CONTACT	WIRELESS SALES
PHONE	(844) 887-6723
EMAIL	WWW.PERFECT-VISION.COM
WEBSITE	WIRELESSALES@PERFECT-VISION.COM
SABRE INDUSTRIES, INC.	
CONTACT	ANGIE WELCH
PHONE	(866) 428-6937
EMAIL	AKWELCH@SABREINDUSTRIES.COM
WEBSITE	WWW.SABRESITESOLUTIONS.COM
SITE PRO I	
CONTACT	PAULA BOSWELL
PHONE	(972) 236-9843
EMAIL	PAULA.BOSWELL@VALMONT.COM
WEBSITE	WWW.SITEPROI.COM

VZWSMART KITS - APPROVED VENDORS

NEWAVE	
CONTACT	NEWAVE SALES TEAM
PHONE	(971) 239-4762
EMAIL	SALES@NEWAVETC.COM
WEBSITE	WWW.NEWAVETC.COM
BETTER METAL, LLC	
CONTACT	DAVID STANSBERRY
PHONE	(615) 535-0990 (O), (615) 631-2520 (M)
EMAIL	DL@BETTERMETAL.COM
WEBSITE	WWW.BETTERMETAL.COM

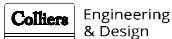

www.colliersengineering.com

Copyright © 2022 Colliers Engineering & Design, P.C. All rights reserved. The drawing or bill of materials is the property of Colliers Engineering & Design, P.C. and shall remain the property of Colliers Engineering & Design, P.C. No part of this drawing or bill of materials may be reproduced, stored in a retrieval system, or transmitted, in any form or by any means, electronic, mechanical, photocopying, recording, or by any information storage and retrieval system, without the prior written permission of Colliers Engineering & Design, P.C.

Doing Business as MASER CONSULTING



PROTECT YOURSELF
 ALL STATES REQUIRE A LICENSE FOR THE PROVISION OF ENGINEERING, ARCHITECTURE, OR ANY PROFESSION. PREPARING TO OBTAIN THE LICENSES OF THESE PROFESSIONS IS AN OBLIGATION.
 Know your state. Call before you die.
 FOR STATE SPECIFIC DIRECT PHONE NUMBERS VISIT: WWW.CALLST1.COM

Scale: AS SHOWN Drawing No: 22777029A

REV	DATE	DESCRIPTION	ISSUED BY	CHECKED BY

Digitally signed by Loren H. Fisher Date: 2022.05.25 14:22:19 -0400



IT IS A VIOLATION OF LAW FOR ANY PERSON, UNLESS THEY ARE ACTING UNDER THE DIRECTION OF THE RESPONSIBLE LICENSED PROFESSIONAL ENGINEER, TO ALTER THIS DOCUMENT.

SITE NAME:
 NEW BRITAIN 5 CT
 467249
 130 BIRDEYE ROAD
 FARMINGTON, CT 06032
 HARTFORD COUNTY

Colliers Engineering & Design
 1055 Washington Boulevard
 Stamford, CT 06901
 Phone: 203.374.0800
 COLLIERS ENGINEERING & DESIGN, P.C.
 DOES NOT REPRESENT MASER CONSULTING

SHEET: **BILL OF MATERIALS**

SHEET NUMBER: **SBOM-I**

PROJECT NOTES

- SEE MODIFICATION NOTES
- THE CONTRACTOR SHALL COMPLY WITH ALL APPLICABLE CODES, ORDINANCES, LAWS AND REGULATIONS OF ALL MUNICIPALITIES, UTILITY COMPANIES OR OTHER PUBLIC/GOVERNING AUTHORITIES.
- THE CONTRACTOR SHALL BE RESPONSIBLE FOR OBTAINING ALL PERMITS AND INSPECTIONS THAT MAY BE REQUIRED BY ANY FEDERAL, STATE, COUNTY OR MUNICIPAL AUTHORITIES.
- THE CONTRACTOR SHALL NOTIFY THE CONSTRUCTION MANAGER, IN WRITING, OF ANY CONFLICTS, ERRORS OR OMISSIONS PRIOR TO THE SUBMISSION OF BIDS OR PERFORMANCE OF WORK.
- THE CONTRACTOR SHALL BE RESPONSIBLE FOR PROTECTING ALL EXISTING SITE IMPROVEMENTS PRIOR TO COMMENCING CONSTRUCTION. THE CONTRACTOR SHALL REPAIR ANY DAMAGE AS A RESULT OF CONSTRUCTION OF THIS FACILITY AT THE CONTRACTOR'S EXPENSE TO THE SATISFACTION OF THE OWNER.
- THE SCOPE OF WORK FOR THIS PROJECT SHALL INCLUDE PROVIDING ALL MATERIALS, EQUIPMENT AND LABOR REQUIRED TO COMPLETE THIS PROJECT. ALL EQUIPMENT SHALL BE INSTALLED IN ACCORDANCE WITH MANUFACTURER'S RECOMMENDATIONS.
- THE CONTRACTOR SHALL VISIT THE PROJECT SITE PRIOR TO SUBMITTING THE BID TO VERIFY THAT THE PROJECT CAN BE CONSTRUCTED IN ACCORDANCE WITH THE CONTRACT DOCUMENTS AND CONSTRUCTION DRAWINGS.
- THE CONTRACTOR SHALL VERIFY ALL EXISTING DIMENSIONS AND CONDITIONS PRIOR TO COMMENCING ANY WORK. ALL DIMENSIONS OF EXISTING CONSTRUCTION SHOWN ON THESE DRAWINGS MUST BE VERIFIED. THE CONTRACTOR SHALL NOTIFY THE CONSTRUCTION MANAGER OF ANY DISCREPANCIES PRIOR TO ORDERING MATERIAL OR PROCEEDING WITH CONSTRUCTION.
- SINCE THE CELL SITE MAY BE ACTIVE, ALL SAFETY PRECAUTIONS MUST BE TAKEN WHEN WORKING AROUND HIGH LEVELS OF ELECTROMAGNETIC RADIATION. EQUIPMENT SHOULD BE SHUTDOWN PRIOR TO PERFORMING ANY WORK THAT COULD EXPOSE THE WORKERS TO DANGER. PERSONAL RF EXPOSURE MONITORS ARE REQUIRED TO BE WORN TO ALERT OF ANY POTENTIALLY DANGEROUS EXPOSURE LEVELS.
- NO NOISE, SMOKE, DUST OR ODOR WILL RESULT FROM THIS FACILITY AS TO CAUSE A NUISANCE.
- THE FACILITY IS UNMANNED AND NOT FOR HUMAN HABITATION (NO HANDICAP ACCESS IS REQUIRED).

CONTRACTOR SHALL BE RESPONSIBLE FOR THE STRENGTH AND STABILITY OF THE STRUCTURE DURING ERECTION. CONTRACTOR SHALL PROVIDE TEMPORARY SUPPORT, SHORING, BRACING AND ANY OTHER STRUCTURAL SYSTEMS AS REQUIRED TO RESIST ALL FORCES THAT MAY OCCUR DURING HANDLING AND ERECTION UNTIL THE STRUCTURE IS FULLY COMPLETED. TEMPORARY SUPPORTS, BRACING AND OTHER STRUCTURAL SYSTEMS REQUIRED DURING CONSTRUCTION SHALL REMAIN THE CONTRACTOR'S PROPERTY AFTER THEIR USE.

- ALL INSTALLATIONS PERFORMED ON THIS STRUCTURE SHALL BE COMPLETED IN ACCORDANCE WITH THE GOVERNING PROVISIONS OF THE STANDARD FOR INSTALLATION, ALTERATION AND MAINTENANCE OF ANTENNA SUPPORTING STRUCTURES AND ANTENNAS, ANSI/TIA-322.
- CONTRACTOR SHALL SECURE SITE BACK TO EXISTING CONDITION UNDER SUPERVISION OF OWNER. ALL FENCE, STONE, GEOFABRIC, GROUNDING, AND SURROUNDING GRADE SHALL BE REPLACED AND REPAIRED AS REQUIRED TO ACHIEVE OWNER APPROVAL. POSITIVE DRAINAGE AWAY FROM TOWER SITE SHALL BE MAINTAINED.
- CONNECTIONS BETWEEN ITEMS SUPPORTED BY THE STRUCTURE AND THE STRUCTURE NOT SPECIFICALLY DETAILED IN THE CONTRACT DOCUMENTS ARE THE RESPONSIBILITY OF THE CONTRACTOR. SUCH CONNECTIONS SHALL BE DESIGNED, COORDINATED AND INSPECTED BY A PROFESSIONAL STRUCTURAL ENGINEER LICENSED IN THE STATE OF THE PROJECT. SUBMIT SIGNED AND SEALED CALCULATIONS DURING SHOP DRAWING REVIEW.
- DO NOT SCALE DRAWINGS.
- DO NOT USE THESE DRAWINGS FOR ANY OTHER SITE.
- ALL MATERIAL UTILIZED FOR THIS PROJECT MUST BE NEW AND FREE OF ANY DEFECTS. ANY MATERIAL SUBSTITUTIONS INCLUDING BUT NOT LIMITED TO ALTERED SIZE AND/OR STRENGTHS, MUST BE APPROVED BY THE OWNER AND ENGINEER IN WRITING.
- THE MOUNT UNDER NO CIRCUMSTANCES SHOULD BE USED AS A TIE OFF POINT.

STRUCTURAL STEEL

- DESIGN, DETAILING, FABRICATION AND ERECTION OF STRUCTURAL STEEL SHALL CONFORM TO THE FOLLOWING PUBLICATIONS EXCEPT AS SPECIFICALLY INDICATED IN THE CONTRACT DOCUMENTS.
 - AMERICAN INSTITUTE OF STEEL CONSTRUCTION (AISC) MANUAL OF STEEL CONSTRUCTION (15TH EDITION)
 - SPECIFICATION FOR STRUCTURAL JOINTS USING ASTM A325 OR A490 BOLTS
 - AISC CODE OF STANDARD PRACTICE
- STRUCTURAL STEEL SHALL CONFORM TO THE FOLLOWING UNLESS OTHERWISE SHOWN:

CHANNELS, ANGLES, PLATES, ETC.	ASTM A36 (GR 36)
STEEL PIPE	ASTM A53 (GR 35)
BOLTS	ASTM A325
NUTS	ASTM A563
LOCK WASHERS	LOCKING STRUCTURAL GRADE

- ALL SUBSTITUTIONS PROPOSED BY THE CONTRACTOR SHALL BE APPROVED IN WRITING BY THE ENGINEER. CONTRACTOR SHALL PROVIDE DOCUMENTATION TO ENGINEER FOR VERIFYING THE SUBSTITUTE IS SUITABLE FOR USE AND MEETS ORIGINAL DESIGN CRITERIA. DIFFERENCES FROM THE ORIGINAL DESIGN, INCLUDING MAINTENANCE, REPAIR AND REPLACEMENT, SHALL BE NOTED. ESTIMATES OF COSTS/CREDITS ASSOCIATED WITH THE SUBSTITUTION (INCLUDING RE-DESIGN COSTS AND COSTS TO SUB-CONTRACTORS) SHALL BE PROVIDED TO THE ENGINEER. CONTRACTOR SHALL PROVIDE ADDITIONAL DOCUMENTATION AND/OR SPECIFICATIONS TO THE ENGINEER AS REQUESTED.
- PROVIDE STRUCTURAL STEEL SHOP DRAWINGS TO ENGINEER FOR APPROVAL PRIOR TO FABRICATION.
 - SUBMIT SHOP DRAWINGS TO
PETER.ALBANO@COLLIERSENGINEERING.COM
 - PROVIDE MASER CONSULTING PROJECT # AND MASER CONSULTING PROJECT ENGINEER CONTACT IN THE BODY OF THE EMAIL.
- DRILL NO HOLES IN ANY NEW OR EXISTING STRUCTURAL STEEL MEMBERS OTHER THAN THOSE SHOWN ON STRUCTURAL DRAWINGS WITHOUT THE APPROVAL OF THE ENGINEER OF RECORD.
- GALVANIZED ASTM A325 BOLTS SHALL NOT BE REUSED.
- ALL NEW STEEL SHALL BE HOT BE DIPPED GALVANIZED FOR FULL WEATHER PROTECTION. IN ADDITION ALL NEW STEEL SHALL BE PAINTED TO MATCH EXISTING STEEL. CONTRACTOR SHALL OBTAIN WRITTEN PERMISSION TO PROTECT STEEL BY ANY OTHER MEANS.
- CONTRACTOR SHALL PROTECT CUT ENDS OF ALL FIELD-CUT STEEL WITH TWO (2) COATS OF COLD GALVANIZATION (ZINGA OR ZINC COTE).
- ALL BOLT ASSEMBLIES FOR STRUCTURAL MEMBERS REPRESENTED IN THIS DRAWING REQUIRE LOCKING DEVICES TO BE INSTALLED IN ACCORDANCE WITH TIA-222-H SECTION 4.9.2 REQUIREMENTS.
- WHERE CONNECTIONS ARE NOT FULLY DETAILED ON THESE DRAWINGS, FABRICATOR SHALL DESIGN CONNECTIONS TO RESIST LOADS AND FORCES WHERE SHOWN ON DRAWINGS AND AS OUTLINED IN SPECIFICATIONS.
- FOR MEMBERS BEING REPLACED, PROVIDE NEW BOLTS AND MATCH EXISTING SIZE AND GRADE. MAINTAIN AISC REQUIREMENTS FOR MINIMUM BOLT DISTANCE AND SPACING.

- ALL PROPOSED AND/OR REPLACED BOLTS SHALL BE OF SUFFICIENT LENGTH SUCH THAT THE END OF THE BOLT IS AT LEAST FLUSH WITH THE FACE OF THE NUT. IT IS NOT PERMITTED FOR THE BOLT END TO BE BELOW THE FACE OF THE NUT AFTER TIGHTENING IS COMPLETED.
- GALVANIZED ASTM A325 BOLTS SHALL NOT BE REUSED.
- ALL EXISTING PAINTED GALVANIZED SURFACES DAMAGED DURING REHAB INCLUDING AREAS UNDER STIFFENER PLATES SHALL BE WIRE BRUSHED CLEAN, REPAIRED BY COLD GALVANIZING (ZINGA OR ZINC COTE), AND REPAINTED TO MATCH THE EXISTING FINISH (IF APPLICABLE).
- ALL HOLES IN STEEL MEMBERS SHALL BE SIZED 1/16" LARGER THAN THE BOLT DIAMETER. STANDARD HOLES SHALL BE USED UNLESS NOTED OTHERWISE.

WELDING NOTES

- ALL WELDING SHALL BE DONE IN ACCORDANCE WITH AWS D1.0 (LATEST EDITION). THIS SHALL INCLUDE A CERTIFIED WELD INSPECTION (CWI) FOR ACCEPTANCE OR REJECTION OF ALL WELDING OPERATIONS, PRE, DURING, AND POST INSTALLATION, USING THE ACCEPTANCE CRITERIA OF AWS D1.1.
- CONTRACTOR IS RESPONSIBLE FOR COMMISSIONING A THIRD PARTY CERTIFIED WELD INSPECTOR (CWI) THROUGHOUT THE ENTIRETY OF THE PROJECT. A PASSING CWI REPORT SHALL BE PROVIDED TO THE ENGINEER UPON COMPLETION OF THE PROJECT.
- THE CERTIFIED WELD INSPECTOR SHALL INDICATE, IN A WRITTEN CWI REPORT, THAT ALL WELDING OPERATIONS PRE, DURING, AND POST INSTALLATION WERE CONDUCTED IN ACCORDANCE WITH AWS D1.1 WITH PHOTOGRAPHS AND DOCUMENTATION SUPPORTING THE ACCEPTANCE OR REJECTION OF ALL WELDING. ALL CWI WELD INSPECTION DOCUMENTATION AND PHOTOS SHALL BE SUBMITTED DURING THE PMI.
- IN CASES WHERE A WELD IS SPECIFIED BETWEEN TWO MEMBERS IN WHICH THERE IS A GAP IN BETWEEN, THE WELD IS TO BE BUILT-UP SUCH THAT THE SIZE OF WELD ON THE MEMBER IS EQUAL TO THAT SHOWN IN THE DRAWINGS.
- OXY FUEL GAS WELDING OR BRAZING IS STRICTLY PROHIBITED. SPECIFICALLY, NO TORCH CUTTING IS PERMITTED ON SITE. ALL HOLES SHALL BE CUT WITH A GRINDER.
- CONTRACTOR SHALL EXERCISE CAUTION WHEN WELDING A GALVANIZED SURFACE.
- CONTRACTOR SHALL HAVE A BRE PROTECTION PLAN IN PLACE THAT CONFORMS WITH ALL OSHA, ANSISFP A10.48, ANSI Z49.1, AND LOCAL JURISDICTIONAL REQUIREMENTS.

BOLT SCHEDULE (IN.)				
BOLT DIAMETER	STANDARD HOLE	SHORT SLOT	MIN. EDGE DISTANCE	SPACING
1/2	9/16	9/16 x 11/16	7/8	1 1/2
5/8	1 1/16	11/16 x 7/8	1 1/8	1 7/8
3/4	1 3/16	1 3/16 x 1	1 1/4	2 1/4
7/8	1 5/16	1 5/16 x 1 1/8	1 1/2	2 5/8
1	1 1/16	1 1/16 x 1 5/16	1 3/4	3

WORKABLE GAGES (IN.)	
LEG	GAGE
4	2 1/2
3 1/2	2
3	1 3/4
2 1/2	1 3/8
2	1 1/8

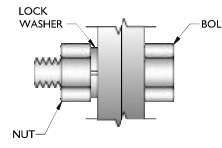

- NOTES:**
- ALL DIMENSIONS REPRESENTED IN THE ABOVE TABLES ARE AISC MINIMUM REQUIREMENTS. CONTRACTOR SHALL VERIFY EXISTING CONDITIONS IN FIELD AND NOTIFY ENGINEER IF DISTANCES ARE LESS THAN THOSE PROVIDED.
 - THE DIMENSIONS PROVIDED ARE MINIMUM REQUIREMENTS. ACTUAL DIMENSIONS OF PROPOSED MEMBERS WITHIN THESE DRAWINGS MAY VARY FROM THE AISC MINIMUM REQUIREMENTS.
 - SHORT SLOT HOLES SHALL ONLY BE USED WHEN DEPICTED IN THE DRAWINGS
 - MATCH EXISTING GAGES WHEN APPLICABLE. UNLESS MINIMUM EDGE DISTANCES ARE COMPROMISED.

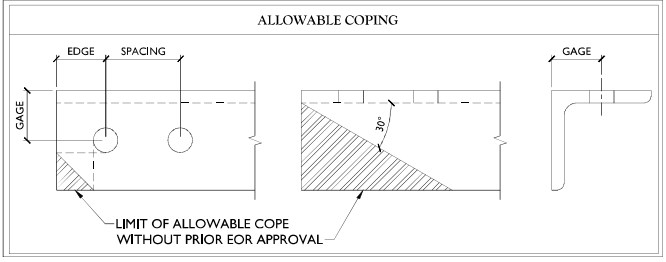

GENERAL NOTES

- THESE MODIFICATIONS HAVE BEEN DESIGNED IN ACCORDANCE WITH THE GOVERNING PROVISIONS OF THE TELECOMMUNICATIONS INDUSTRY STANDARD TIA-222-H. MATERIALS AND SERVICES PROVIDED BY THE CONTRACTOR SHALL CONFORM TO THE ABOVE MENTIONED CODES.
- CONTRACTOR SHALL TAKE ALL PRECAUTIONS NECESSARY TO PREVENT DAMAGE TO EXISTING STRUCTURES. ANY DAMAGE TO EXISTING STRUCTURES AS A RESULT OF THE CONTRACTOR'S WORK OR FROM DAMAGE DUE TO OTHER CAUSES SHALL BE REPAIRED AT THE CONTRACTOR'S EXPENSE TO THE SATISFACTION OF THE OWNER.
- CONTRACTOR SHALL VERIFY ALL DIMENSIONS AND EXISTING CONDITIONS BEFORE BEGINNING WORK, ORDERING MATERIAL, AND PREPARING OF SHOP DRAWINGS. ANY DISCREPANCIES BETWEEN FIELD CONDITIONS AND THE CONTRACT DOCUMENTS SHALL BE BROUGHT TO THE IMMEDIATE ATTENTION OF THE ENGINEER. IF THE CONTRACTOR DISCOVERS ANY EXISTING CONDITIONS THAT ARE NOT REPRESENTED ON THESE DRAWINGS, OR ANY CONDITIONS THAT WOULD INTERFERE WITH THE INSTALLATION OF THE MODIFICATIONS, NOTIFY THE ENGINEER IMMEDIATELY.
- IT IS ASSUMED THAT ANY STRUCTURAL MODIFICATION WORK SPECIFIED ON THESE PLANS WILL BE ACCOMPLISHED BY KNOWN/LEAD-GEARLE WORKMEN WITH TOWER CONSTRUCTION EXPERIENCE.
- THE CONTRACTOR SHALL SUPERVISE AND DIRECT THE WORK AND SHALL BE SOLELY RESPONSIBLE FOR ALL CONSTRUCTION METHODS, MEANS, TECHNIQUES, SEQUENCES, AND PROCEDURES.
- ALL CONSTRUCTION MEANS AND METHODS, INCLUDING BUT NOT LIMITED TO, ERECTION PLANS, RIGGING PLANS, CLIMBING PLANS, AND RESCUE PLANS SHALL BE THE RESPONSIBILITY OF THE GENERAL CONTRACTOR RESPONSIBLE FOR THE EXECUTION OF THE WORK CONTAINED HEREIN AND SHALL MEET ANSITIA-322 (LATEST EDITION), OSHA, AND GENERAL INDUSTRY STANDARDS. ALL RIGGING PLANS SHALL ADHERE TO ANSITIA-322 (LATEST EDITION) INCLUDING THE REQUIRED INVOLVEMENT OF A QUALIFIED ENGINEER FOR CLASS IV CONSTRUCTION.
- THE CONTRACTOR IS SOLELY RESPONSIBLE FOR INITIATING, MAINTAINING, AND SUPERVISING ALL SAFETY PROGRAMS IN ACCORDANCE WITH APPLICABLE SAFETY CODES.
- WORK SHALL ONLY BE PERFORMED DURING CALM DRY DAYS (WINDS LESS THAN 30-MPH), THE STRUCTURE SHOWN ON THE DRAWINGS IS STRUCTURALLY SOUND ONLY IN THE COMPLETED FORM. THE

Colliers Engineering & Design
www.colliersengineering.com
Doing Business as **MASER CONSULTING**

verizon

811 PROTECT YOURSELF. ALL STATES REQUIRE YOU TO CALL OR VISIT www.call811.com PRIOR TO EXCAVATION. CALL BEFORE YOU DIG.

STATE: CT PROJECT: 22777025A

Deal Shift

DATE: 2022-05-25 14:22:19-0400

COLLIERS ENGINEERING & DESIGN CT, P.C.
CT PROFESSIONAL

SITE NAME:
NEW BRITAIN 5 CT
467249
130 BIRDEYE ROAD
FARMINGTON, CT 06032
HARTFORD COUNTY

Colliers Engineering & Design
1035 Washington Boulevard
Farmington, CT 06031
Phone: 203.374.0800
COLLIERS ENGINEERING & DESIGN CT, P.C.
DESIGN: PETER ALBANO (CONTRACTOR)

MODIFICATION NOTES

SGN-I

NOTE:

A DESKTOP MAPPING WAS COMPLETED AND THERE IS INSUFFICIENT INFORMATION ON THE CLIMBING FACILITY

CLIMBING FACILITY LOCATION

SCALE: N.T.S.

NOTE:

A DESKTOP MAPPING WAS COMPLETED AND THERE IS INSUFFICIENT INFORMATION ON THE CLIMBING FACILITY

CLIMBING FACILITY PHOTO

STRUCTURAL NOTES:

- CONTRACTOR TO INSPECT CLIMBING FACILITIES AT SITE AND ENSURE THAT THE SAFETY CLIMB IS IN GOOD CONDITION AND THAT THE WIRE ROPE DOES NOT OR WILL NOT INTERFERE WITH THE EXISTING OR PROPOSED MOUNT CONNECTIONS, CONTRACTOR SHALL INSTALL SAFETY CLIMB WIRE ROPE GUIDED AROUND MOUNT CONNECTIONS AS NEEDED.
- INSTALL SHALL NOT CAUSE HARM TO THE STRUCTURE, CLIMBING FACILITY, SAFETY CLIMB, OR ANY SYSTEM INSTALLED ON THE STRUCTURE. TIMELY NOTICE AND DOCUMENTATION SHALL BE PROVIDED BY CONTRACTORS TO THE EOR (OF STRUCTURAL DESIGN) IF AN OBSTRUCTION WAS REQUIRED TO MEET THE RF SYSTEM DESIGN REQUIREMENTS AND PERFORMANCES.

Colliers Engineering & Design

www.colliersengineering.com

Copyright © 2022 Colliers Engineering & Design, P.C. All rights reserved. The drawing is the intellectual property of Colliers Engineering & Design, P.C. No part of this drawing may be reproduced, stored in a retrieval system, or transmitted in any form or by any means, electronic, mechanical, photocopying, recording, or by any information storage and retrieval system, without the prior written permission of Colliers Engineering & Design, P.C.

Doing Business as **MASER**

verizon

811 PROTECT YOURSELF
ALL STATES REQUIRE HOME OWNERS OF MECHANICAL, ELECTRICAL, OR ANY PERSON PREPARING TO EXCAVATE THE EARTH'S SURFACE, TOWNHOLE, BLINDS, ETC.

Know what's below.
Call before you dig.
FOR STATE SPECIFIC STREET MARKING NUMBERS VISIT: WWW.CALL11.COM

SCALE: AS SHOWN DRAWING NUMBER: 22777029A

REV	DATE	DESCRIPTION	DRAWN BY	CHECKED BY

Digitally signed by USER: H. HARTNEY
Date: 2022.05.25 14:22:19 -0400



COLLIERS ENGINEERING & DESIGN, P.C.
C.T. PROFESSIONAL

IT IS A VIOLATION OF LAW FOR ANY PERSON, UNLESS THEY ARE ACTING UNDER THE DIRECTION OF THE RESPONSIBLE LICENSED PROFESSIONAL ENGINEER, TO ALTER THIS DOCUMENT.

SITE NAME:

**NEW BRITAIN 5 CT
467249**
130 BIRDEYE ROAD
FARMINGTON, CT 06032
HARTFORD COUNTY

Colliers Engineering & Design
1035 Washington Boulevard
Stamford, CT 06901
Phone: 203.374.0800
COLLIERS ENGINEERING & DESIGN, P.C.
DOES NOT REPRESENT ANY CONTRACTORS

CLIMBING FACILITY DETAIL

SCF-I

LEGEND:

- PROPOSED
- RELOCATED
- EXISTING

MOUNT MODIFICATION SCHEDULE				
NO.	ELEVATION	QUANTITY	DESCRIPTION	NOTES
1		3	PROPOSED SUPPORT RAIL CORNER BRACKET (PART #: VZWSMART-PLK3) WITH 3/8" LONG L3X3X1/4	CONTRACTOR TO VERIFY THE LENGTH REQUIRED AND TRIM AS NECESSARY IN ACCORDANCE WITH THE 'STRUCTURAL STEEL' NOTES ON SHEET SGN-1. CONTRACTOR SHALL CONNECT PROPOSED L3X3X1/4 ANGLES TO CORNER BRACKETS USING THE PROVIDED (8) 5/8" DIA. BOLTS, (4) BOLTS PER CONNECTION.
2	108'-0"	3	PROPOSED 72" LONG, P2 STD (PART #: VZWSMART-P40-238X072)	
3		3	PROPOSED 186" LONG, P2 1/2 STD SUPPORT RAIL	

NOTES:
MOUNT MEMBERS NOT SHOWN FOR CLARITY U.N.O.

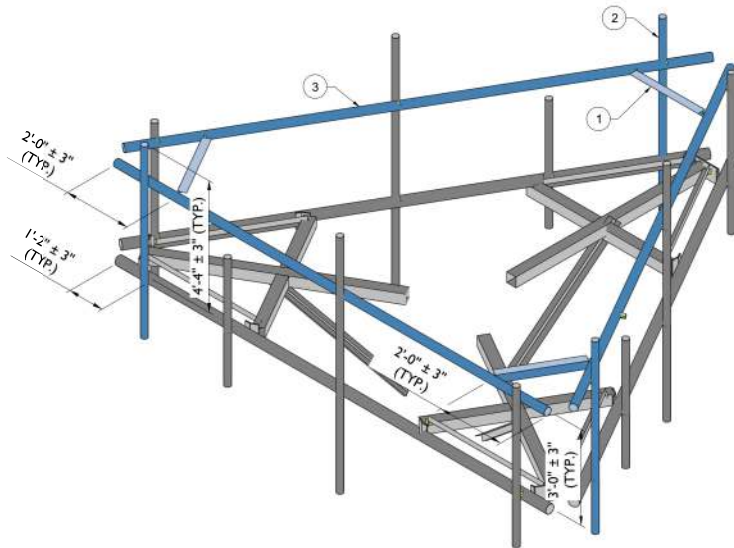

1 PROPOSED ISOMETRIC VIEW
SCALE: N.T.S.

Colliers Engineering & Design

www.colliersengineering.com

Copyright © 2022 Colliers Engineering & Design, Inc. All rights reserved. The design of all the information contained herein is the property of Colliers Engineering & Design, Inc. and shall remain confidential and proprietary. No part of this document may be reproduced, stored in a retrieval system, or transmitted in any form or by any means, electronic, mechanical, photocopying, recording, or by any information storage and retrieval system, without the prior written permission of Colliers Engineering & Design, Inc.

Doing Business as **MASER**

verizon

811 PROTECT YOURSELF
ALL STATES REQUIRE YOU TO CALL OR VISIT THE WEBSITE OF YOUR STATE TO IDENTIFY THE LOCATION OF UTILITIES BEFORE YOU EXCAVATE. PREPARE TO IDENTIFY THE UTILITIES BEFORE YOU EXCAVATE.
Know what's below. Call before you dig.
FOR STATE SPECIFIC STREET PHONE NUMBERS VISIT: WWW.CALL11.COM

Scale: AS SHOWN Drawing No: 22777025A

REV	DATE	DESCRIPTION	DRAWN BY	CHECKED BY

Digitally signed by Derek H. Hartman
Date: 2022.05.25 14:22:20 -0400

Derek Hartman

PROFESSIONAL ENGINEER
COLLIERS ENGINEERING & DESIGN CT, P.C.
C7-16000001

IT IS A VIOLATION OF LAW FOR ANY PERSON, UNLESS THEY ARE ACTING UNDER THE DIRECTION OF THE RESPONSIBLE LICENSED PROFESSIONAL ENGINEER, TO ALTER THIS DOCUMENT.

SITE NAME:
NEW BRITAIN 5 CT
467249
130 BIRDSEYE ROAD
FARMINGTON, CT 06032
HARTFORD COUNTY

Colliers Engineering & Design
1055 Washington Boulevard
Stamford, CT 06901
Phone: 203.374.0800
COLLIERS ENGINEERING & DESIGN CT, P.C.
DOES NOT REPRESENT AS MASON CONTRACTORS

MODIFICATION DETAILS

SS-1

EXISTING MEMBERS			
NO.	DESCRIPTION	SHAPE & LENGTH	NOTES
1.	MOUNT PIPE		TYP. OF 6, 2 PER SECTOR
2.	MOUNT PIPE		TYP. OF 3, 1 PER SECTOR
3.	MOUNT PIPE		TYP. OF 3, 1 PER SECTOR
4.	FACE HORIZONTAL		TYP. OF 3, 1 PER SECTOR
5.	STANDOFF HORIZONTAL		TYP. OF 3, 1 PER SECTOR
6.	CROSSMEMBER		TYP. OF 6, 2 PER SECTOR
7.	CORNER PLATE		TYP. OF 3, 1 PER SECTOR
8.	KICKER		TYP. OF 3, 1 PER SECTOR
9.	POLE DIAMETER @ MOUNT CENTERLINE		

LIST ALL SHAPES:
 ANGLE (LEG1xLEG2xTH): EX. L2x2x1/4
 CHANNEL (DEPTHxFLANGE WIDTH): EX. CH6"x1-7/8"
 PIPE (ODxTH): EX. PIPE 2.4"x0.12"
 PLATE (THxDEPTH): EX. PLATE 1/2"x2"

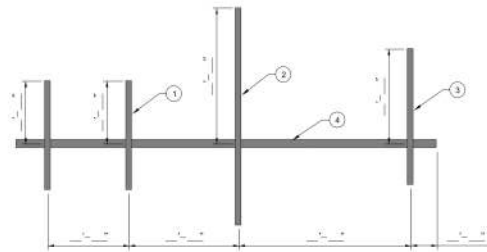

2 EXISTING MOUNT GEOMETRY VERIFICATION FRONT ELEVATION VIEW
 SCALE: N.T.S.

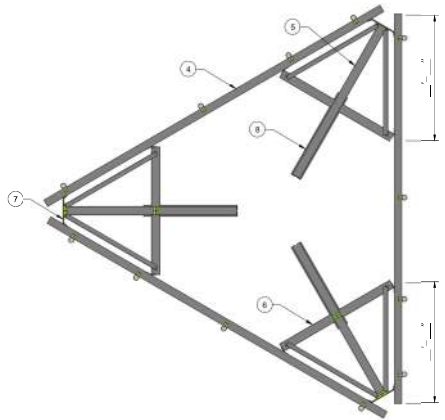

1 EXISTING MOUNT GEOMETRY VERIFICATION PLAN VIEW
 SCALE: N.T.S.

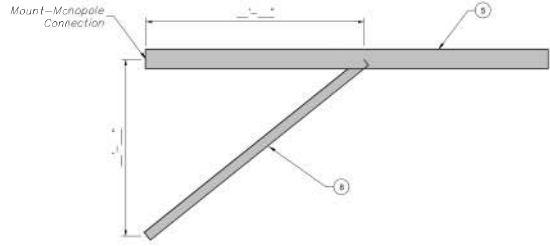

2 EXISTING MOUNT GEOMETRY VERIFICATION SIDE ELEVATION VIEW
 SCALE: N.T.S.

NOTE:
CONTRACTOR SHALL RECORD ALL DIMENSIONS AND MEMBER SIZES SHOWN IN THIS SKETCH. DOCUMENT VIA PHOTOS AND SKETCHES AND PROVIDE TO THE EOR FOR EVALUATION.

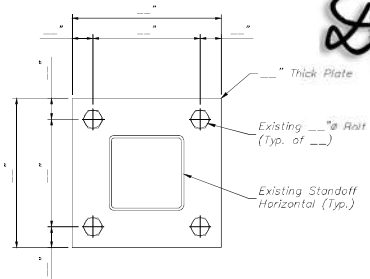

3 MOUNT CONNECTION DETAIL
 SCALE: N.T.S.

Colliers Engineering & Design
 www.colliersengineering.com
 Copyright © 2022. All Rights Reserved. The drawing is the property of Colliers Engineering & Design. No part of this drawing may be reproduced, stored in a retrieval system, or transmitted in any form or by any means, electronic, mechanical, photocopying, recording, or by any information storage and retrieval system, without the prior written permission of Colliers Engineering & Design.

Doing Business as **MASER**

verizon

811 PROTECT YOURSELF
 ALL STATES REQUIRE YOU TO CALL BEFORE YOU DIG. CALL BEFORE YOU DIG. PREPARE TO UNCOVER THE HAZARDS OF UNKNOWN UTILITIES AND SERVICES.

Know what's below. Call before you dig.
 FOR STATE SPECIFIC DIRECT DIALING NUMBERS VISIT: WWW.CALL11.COM

Scale: AS SHOWN Drawing No: 22777029A

REV	DATE	DESCRIPTION	DRAWN BY	CHECKED BY

Digitally signed by USER: H. HARTSHORN
 Date: 2022.05.25 14:22:20 -0400

Desk Draft

COLLIERS ENGINEERING & DESIGN CT, P.C.
 CT REG. PROFESSIONAL ENGINEER

IT IS A VIOLATION OF LAW FOR ANY PERSON, UNLESS THEY ARE ACTING UNDER THE DIRECTION OF THE RESPONSIBLE LICENSED PROFESSIONAL ENGINEER, TO ALTER THIS DOCUMENT.

SITE NAME:
 NEW BRITAIN 5 CT
 467249
 130 BIRDSEYE ROAD
 FARMINGTON, CT 06032
 HARTFORD COUNTY

STAMFORD
 1055 Washington Boulevard
 Stamford, CT 06901
 Phone: 203.374.0800
 COLLIERS ENGINEERING & DESIGN CT, P.C.
 DOES NOT REPRESENT MASON CONSULTANTS

PREP BY: GEOMETRY VERIFICATION SKETCHES
 PREP NUMBER: SS-2



MOUNT PHOTO 1



MOUNT PHOTO 2



MOUNT PHOTO 3



MOUNT PHOTO 4

Colliers Engineering & Design

www.colliersengineering.com

Copyright © 2020 Colliers Engineering & Design, P.C. All rights reserved. The bearing of all of the information contained herein is based on the data provided to us by the client. We do not warrant, represent or make any other statement as to the accuracy, completeness or reliability of the information provided to us by the client. We do not accept any liability for any errors or omissions in this document or any other documents prepared by us or our consultants or subcontractors.

Doing Business as **MASER**

verizon

811 PROTECT YOURSELF
ALL STATES REQUIRE HOMEOWNERS OF
RESIDENTIAL PROPERTIES OR ANY PERSON
PREPARING TO EXCAVATE THE EARTH'S
SURFACE TO CALL 811 ANY TIME

Know what's below.
Call before you dig.

FOR STATE SPECIFIC STREET NUMBER NUMBERS VISIT:
WWW.CALL811.COM

SCALE: AS SHOWN DRAWING NUMBER: 22717025A

REV	DATE	DESCRIPTION	DRAWN BY	CHECKED BY

Digitally signed by USER: H. HARTSHORN
Date: 2022.05.25 14:22:20 -0400

Deak Duff

PROFESSIONAL ENGINEER
13710
COLLIERS ENGINEERING & DESIGN, P.C.
C.T. REG. 06000013

IT IS A VIOLATION OF LAW FOR ANY PERSON, UNLESS THEY ARE ACTING UNDER THE DIRECTION OF THE RESPONSIBLE LICENSED PROFESSIONAL ENGINEER, TO ALTER THIS DOCUMENT.

SITE NAME:
NEW BRITAIN 5 CT
467249
130 BIRDEYE ROAD
FARMINGTON, CT 06032
HARTFORD COUNTY

STAMPED
1055 Washington Boulevard
Stamford, CT 06901
Phone: 203.374.0800
COLLIERS ENGINEERING & DESIGN, P.C.
DOES NOT REPRESENT OR WARRANT ANY OTHER CONSULTANTS

PREP BY: MOUNT PHOTOS

PREP NUMBER: SS-3

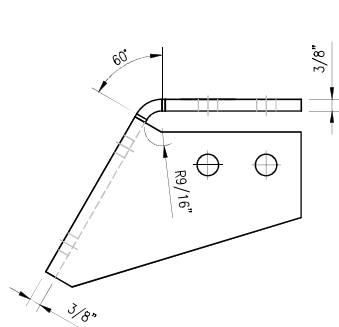

TOP VIEW

CBP-L

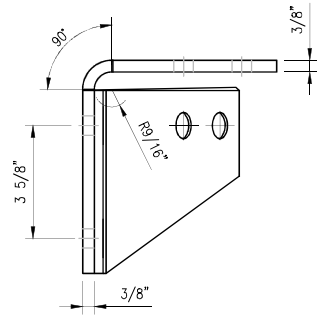

SIDE VIEW

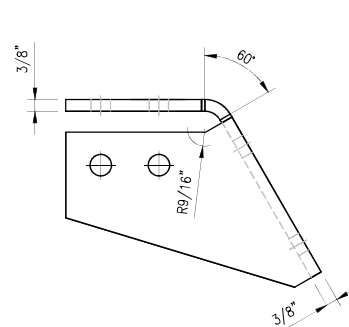

TOP VIEW

CBP-R

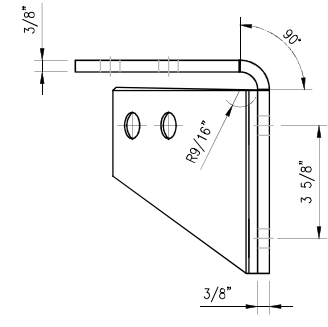

SIDE VIEW

NOTES:

- HOT-DIPPED GALVANIZED PER ASTM A123.

VZWSMART-PLK3 (SUPPORT RAIL CORNER BRACKET)

ITEM NO.	QTY.	PART NO.	DESCRIPTION	SHEET #	WT	
1	1	CBP-L	CORNER BENT PLATE BRACKET	PLK3-F1	9	
2	1	CBP-R	CORNER BENT PLATE BRACKET	PLK3-F1	9	
3	4	MS02-625-300-500	RU-BOLT 5/8" X 3" (L.W. X 5" I.L. A36 (OR EQUIV.))	RBC-1	5	
4	8	---	BOLT 5/8" X 2" A325	---	3	
5	16	FW-625	5/8" HDG USS FLAT WASHER	---	1	
6	16	LW-625	5/8" HDG LOCK WASHER	---	0	
7	16	NUT-625	5/8" HDG HEX NUT	---	2	
					GALVANIZED WT	30

DRAWN BY: HLR CHECKED BY: HMA

REV.	DESCRIPTION	BY	DATE
△	FIRST ISSUE	H.R.	05/08/20
△			
△			
△			

SHEET TITLE:
 VZWSMART-PLK3
 SUPPORT RAIL CORNER
 BRACKET

SHEET NUMBER: VZWSMART-PLK3 REV #: 0

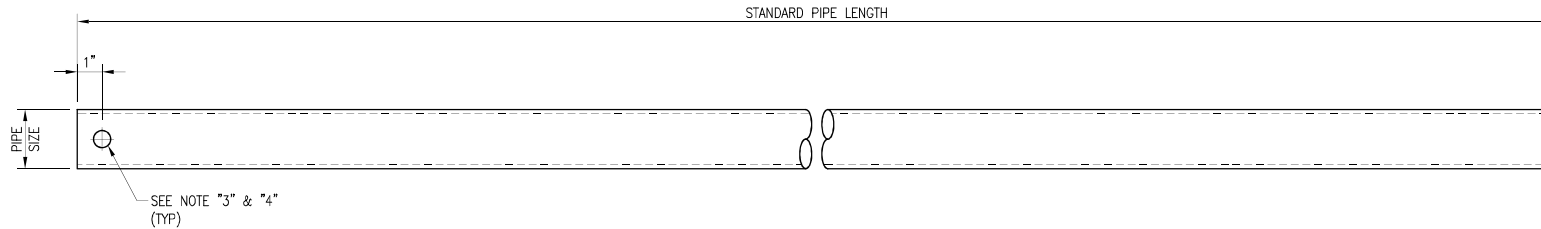

SEE NOTE "3" & "4"
 (TYP)

VZWSMART Standard Pipe		
VZWSMART Number	Size	Length
P40-238X048	PIPE 2 SCH40 (2.375" OD x 0.154" THK)	48"
P40-238X072	PIPE 2 SCH40 (2.375" OD x 0.154" THK)	72"
P40-238X096	PIPE 2 SCH40 (2.375" OD x 0.154" THK)	96"
P40-238X120	PIPE 2 SCH40 (2.375" OD x 0.154" THK)	120"
P40-238X126	PIPE 2 SCH40 (2.375" OD x 0.154" THK)	126"
P40-238X150	PIPE 2 SCH40 (2.375" OD x 0.154" THK)	150"
P40-238X174	PIPE 2 SCH40 (2.375" OD x 0.154" THK)	174"
P40-278X048	PIPE 2.5 SCH40 (2.875" OD x 0.203" THK)	48"
P40-278X072	PIPE 2.5 SCH40 (2.875" OD x 0.203" THK)	72"
P40-278X096	PIPE 2.5 SCH40 (2.875" OD x 0.203" THK)	96"
P40-278X120	PIPE 2.5 SCH40 (2.875" OD x 0.203" THK)	120"
P40-278X126	PIPE 2.5 SCH40 (2.875" OD x 0.203" THK)	126"
P40-278X150	PIPE 2.5 SCH40 (2.875" OD x 0.203" THK)	150"
P40-278X174	PIPE 2.5 SCH40 (2.875" OD x 0.203" THK)	174"
P40-312X048	PIPE 3 SCH40 (3.5" OD x 0.216" THK)	48"
P40-312X072	PIPE 3 SCH40 (3.5" OD x 0.216" THK)	72"
P40-312X126	PIPE 3 SCH40 (3.5" OD x 0.216" THK)	126"
P40-312X150	PIPE 3 SCH40 (3.5" OD x 0.216" THK)	150"
P40-312X174	PIPE 3 SCH40 (3.5" OD x 0.216" THK)	174"

NOTE:
 APPROVED SMART KIT VENDORS ARE ALLOWED TO SUBSTITUTE AT THEIR DISCRETION
 PIPES LISTED ON THIS PAGE FOR CUSTOM LENGTH COMPONENTS OF MATCHING SIZE.
 SUBSTITUTIONS SHALL MEET THE ORIGINAL STRUCTURAL INTENT.

- NOTES:**
1. ALL PIPE GRADE A53-B OR BETTER.
 2. HOT-DIPPED GALVANIZED PER ASTM A123.
 3. ALL HOLES ARE 11/16" DIA. U.N.O
 4. HOLES MAY OR MAY NOT BE PRESENT, DEPEND UPON MANUFACTURE DISCRETION.
 5. ALL FIELD CUT AND DRILLED SURFACES SHALL BE REPAIRED WITH A MINIMUM OF TWO COATS OF ZINGA OR ZINC COTE PER ASTM A780 AND MANUFACTURER'S RECOMMENDATIONS.

DRAWN BY: BT | CHECKED BY: HMA/KW

REV.	DESCRIPTION	BY	DATE
1	FIRST ISSUE	BT	08/04/21

SHEET TITLE:
 VZWSMART
 STANDARD PIPE

SHEET NUMBER: VZWSMART-PIPE | REV #: 0

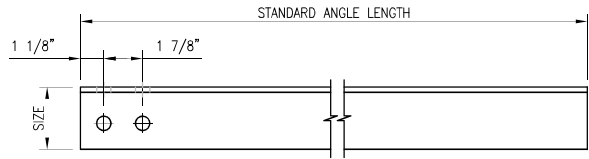

HOLE STYLE "A"

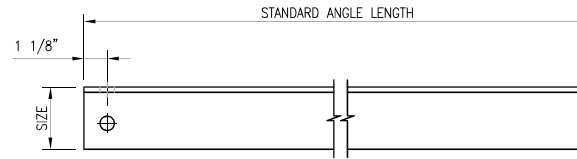
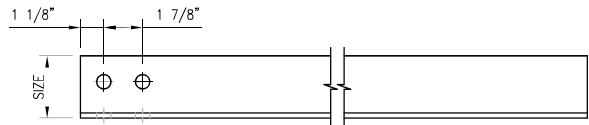

HOLE STYLE "B"

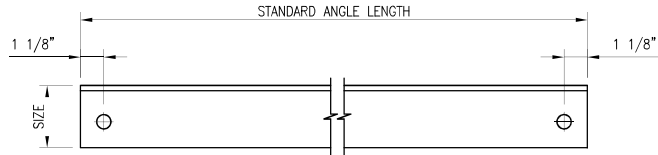
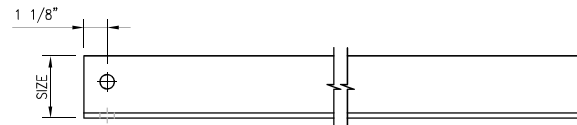

HOLE STYLE "C"

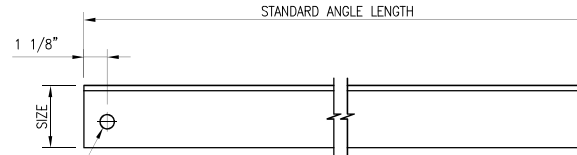

HOLE STYLE "D"

SEE NOTE "3" & "4" (TYP)

NOTE:
 APPROVED SMART KIT VENDORS ARE ALLOWED TO SUBSTITUTE AT THEIR DISCRETION ANGLES LISTED ON THIS PAGE FOR CUSTOM LENGTH COMPONENTS OF MATCHING SIZE. SUBSTITUTIONS SHALL MEET THE ORIGINAL STRUCTURAL INTENT.

- NOTES:**
1. ALL ANGLE GRADE A36 OR BETTER.
 2. HOT-DIPPED GALVANIZED PER ASTM A123.
 3. ALL HOLES ARE 11/16" DIA. U.N.O
 4. HOLES MAY OR MAY NOT BE PRESENT, DEPEND UPON MANUFACTURE DISCRETION.
 5. ALL FIELD CUT AND DRILLED SURFACES SHALL BE REPAIRED WITH A MINIMUM OF TWO COATS OF ZINGA OR ZINC COTE PER ASTM A780 AND MANUFACTURER'S RECOMMENDATIONS.

VZWSMART Standard Angle					
VZWSMART Number	Size	Length	Hole Style	Hole Gage	Also Used In:
A-PLK2-01	L 3" X 3" X 1/4"	96"	A	1-3/4"	VZWSMART-PLK2
A-PLK5-01	L 3" X 3" X 3/16"	96"	B	1-3/4"	VZWSMART-PLK5
A-SFK3-01	L 2-1/2" X 2-1/2" X 1/4"	96"	C	1-3/8"	VZWSMART-SFK3, -SFK3-SL, -PLK6, & -PLK8
A-L25X25X4X120	L 2-1/2" X 2-1/2" X 1/4"	120"	D	1-5/16"	
A-L25X25X4X240	L 2-1/2" X 2-1/2" X 1/4"	240"	D	1-5/16"	
A-L30X30X4X120	L 3" X 3" X 1/4"	120"	D	1-1/2"	
A-L30X30X4X240	L 3" X 3" X 1/4"	240"	D	1-1/2"	
A-L40X40X4X120	L 4" X 4" X 1/4"	120"	D	2"	
A-L40X40X4X240	L 4" X 4" X 1/4"	240"	D	2"	
A-L50X30X6X120	L 5" X 3" X 3/8"	120"	D	2-1/2"	
A-L50X50X6X120	L 5" X 5" X 3/8"	120"	D	2-1/2"	

DRAWN BY: BT CHECKED BY: HMA/KW

REV. DESCRIPTION BY DATE
 △ FIRST ISSUE BT 08/04/21

△
 △
 △

SHEET TITLE:

VZWSMART
 STANDARD ANGLE

SHEET NUMBER: REV #:

VZWSMART-ANGLE 0

FITS 2.375" O.D. AND 2.875" O.D.
 VERTICAL PIPE.
 (NOT INCLUDED IN THIS KIT)

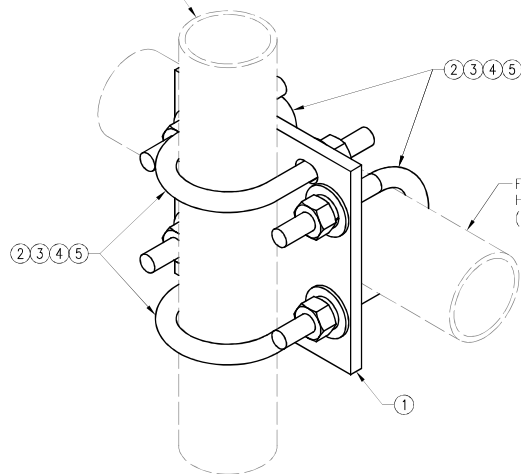

FITS 2.375" O.D. AND 2.875" O.D.
 HORIZONTAL PIPE.
 (NOT INCLUDED IN THIS KIT)

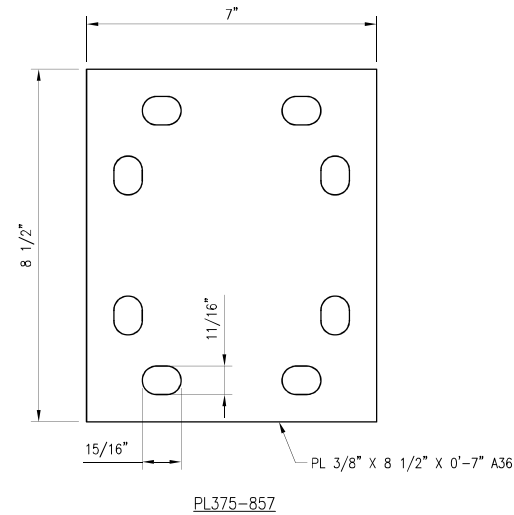

NOTES:
 1. HOT-DIPPED GALVANIZED PER ASTM A123.

VZWSMART-MSK1 (CROSSOVER PLATE)					
ITEM NO.	QTY.	PART NO.	DESCRIPTION	SHEET #	WT
1	1	PL375-857	PL 3/8" X 8 1/2" X 0'-7" A36	MSK1-F1	6
2	4	MS02-625-300-500	RU-BOLT 5/8" X 3" LW. X 5" LL. A36 (OR EQUIV.)	RBC-1	5
3	8	FW-625	5/8" HDG USS FLAT WASHER	---	1
4	8	LW-625	5/8" HDG LOCK WASHER	---	0
5	8	NUT-625	5/8" HDG HEX NUT	---	1
GALVANIZED WT					14

DRAWN BY: HJR	CHECKED BY: HMA		
REV.	DESCRIPTION	BY	DATE
△	FIRST ISSUE	HJR	05/08/20
△			
△			
△			

SHEET TITLE:
**VZWSMART-MSK1
 CROSSOVER PLATE**

SHEET NUMBER: **VZWSMART-MSK1** REV #: **0**

PARTS LIST						
ITEM	QTY	PART NO.	PART DESCRIPTION	LENGTH	UNIT WT.	NET WT.
1	1	X-SP219	SMALL SUPPORT CROSS PLATE	8 1/4 in	8.61	8.61
2	2	X-UB1306	1/2" X 3-5/8" X 6" X 3" U-BOLT (HDG.)		0.83	1.66
3	2	X-UB1212	1/2" X 2-1/2" X 4-1/2" X 2" U-BOLT (HDG.)		0.63	1.25
4	8	G12FW	1/2" HDG USS FLATWASHER		0.03	0.27
5	8	G12LW	1/2" HDG LOCKWASHER		0.01	0.11
6	8	G12NUT	1/2" HDG HEAVY 2H HEX NUT		0.07	0.57
					TOTAL WT. #	12.47

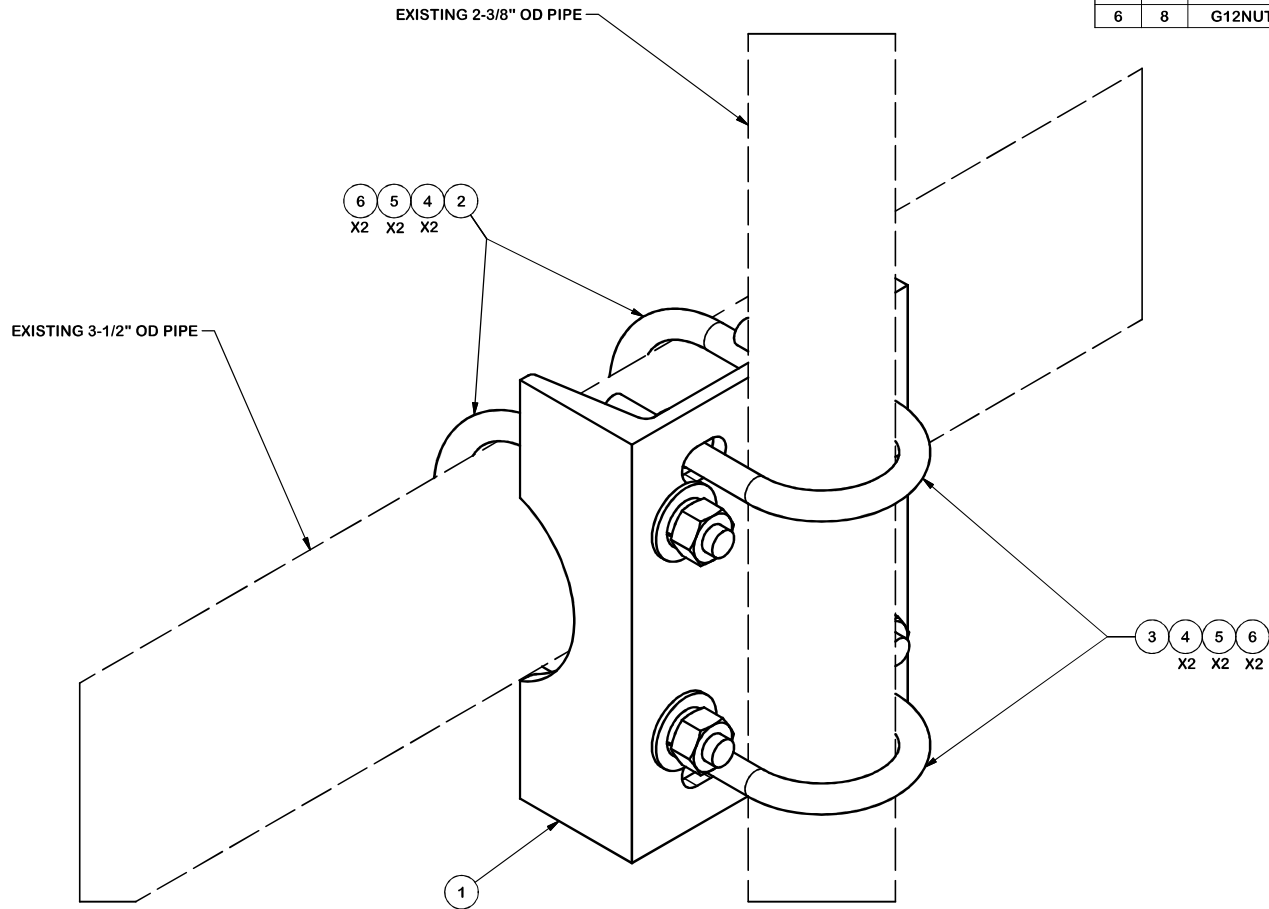

TOLERANCE NOTES

TOLERANCES ON DIMENSIONS, UNLESS OTHERWISE NOTED ARE:
 SAWED, SHEARED AND GAS CUT EDGES ($\pm 0.030"$)
 DRILLED AND GAS CUT HOLES ($\pm 0.030"$) - NO CONING OF HOLES
 LASER CUT EDGES AND HOLES ($\pm 0.010"$) - NO CONING OF HOLES
 BENDS ARE $\pm 1/2$ DEGREE
 ALL OTHER MACHINING ($\pm 0.030"$)
 ALL OTHER ASSEMBLY ($\pm 0.060"$)

PROPRIETARY NOTE:
 THE DATA AND TECHNIQUES CONTAINED IN THIS DRAWING ARE PROPRIETARY INFORMATION OF VALMONT INDUSTRIES AND CONSIDERED A TRADE SECRET. ANY USE OR DISCLOSURE WITHOUT THE CONSENT OF VALMONT INDUSTRIES IS STRICTLY PROHIBITED.

DESCRIPTION
PIPE MOUNT KIT

CPD NO. 4518	DRAWN BY KC8 6/26/2012	ENG. APPROVAL
CLASS 81	SUB 01	DRAWING USAGE CUSTOMER
		CHECKED BY CEK 1/23/2013

SITE PRO 1
 A valmont COMPANY

Engineering Support Team:
 1-888-753-7446

Locations:
 New York, NY
 Atlanta, GA
 Los Angeles, CA
 Plymouth, IN
 Salem, OR
 Dallas, TX

PART NO. SP219	PAGE 1 OF 1
DWG. NO. SP219	