

Mathews, Lisa A

em-t-mobile-034-160601

From: Kyle Richers <krichers@transcendwireless.com>
Sent: Tuesday, June 07, 2016 9:06 AM
To: Mathews, Lisa A; krichers@transcendwireless.com
Cc: CSC-DL Siting Council
Subject: RE: T-Mobile Incomplete EM
Attachments: CT11108 Roof Top 24 Hospital Ave Danbury Ct Parcel Maps Mon 6-6-16.1-2.pdf

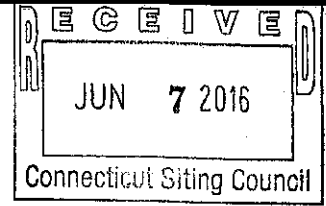

Good Morning Lisa,

Please see the attached parcel map/parcel address for 24 Hospital Ave. in Danbury. Let me know if anything else is needed.

Thanks

From: Mathews, Lisa A [<mailto:Lisa.A.Mathews@ct.gov>]
Sent: Thursday, June 02, 2016 4:19 PM
To: krichers@transcendwireless.com
Cc: CSC-DL Siting Council <Siting.Council@ct.gov>
Subject: T-Mobile Incomplete EM

Please see the attached correspondence.

Lisa A. Mathews
Office Assistant
Connecticut Siting Council
10 Franklin Square
New Britain, CT 06051
Lisa.A.Mathews@ct.gov
(860) 827-2957

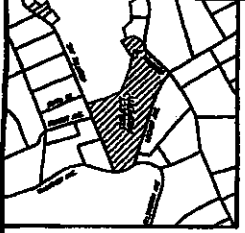

R E C E I V E D

JUN 7 2016

Connecticut Siting Council

Handwritten notes:
 2/1/16
 [unclear]

DATE	7-1-16
NO.	21,487 Ac.
REV.	REV-3
DATE	Nov. 8, 2012
BY	Proprietors
NO.	100-106-111-00
NO.	1111211-1-00

Map Prepared For
Daubury Hospital
 Hospital Ave., Locust Ave. & Osborne St.
 Danbury, Connecticut

NEW ENGLAND LAND SURVEYING, P.C.
 110 MAIN ST. 3RD FL. DANBURY, CT 06810
 TEL: 860-349-1111 FAX: 860-349-1112
 www.neland.com

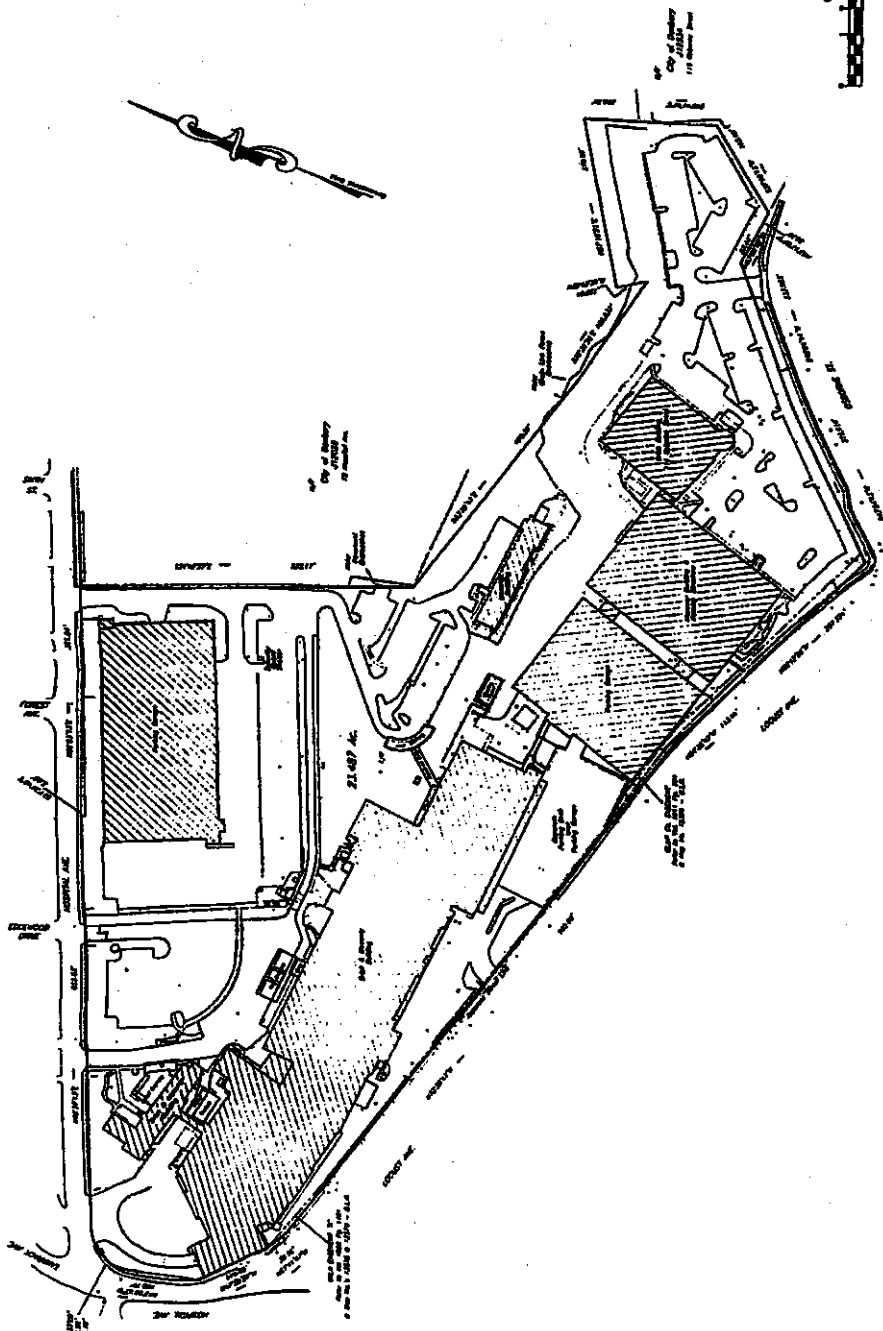

12857

- Notes:**
- This map represents a Property Survey based on a platting and not prepared in accordance with Conn. Regs. 28a-200-1 through 28a-200-10.
 - Boundary Accuracies are shown in feet and inches.
 - Platting of this map is in accordance with Conn. Regs. 28a-200-1 through 28a-200-10.
 - Platting of this map is in accordance with Conn. Regs. 28a-200-1 through 28a-200-10.
 - Platting of this map is in accordance with Conn. Regs. 28a-200-1 through 28a-200-10.

- Legend:**
- — — — — Guard Rail Fence
 - — — — — Chain Link Fence
 - — — — — Light Pole
 - — — — — Utility Pole
 - — — — — Gas Valve
 - — — — — Valve (underground)
 - — — — — Hydrant

12857

12857

12857

12857

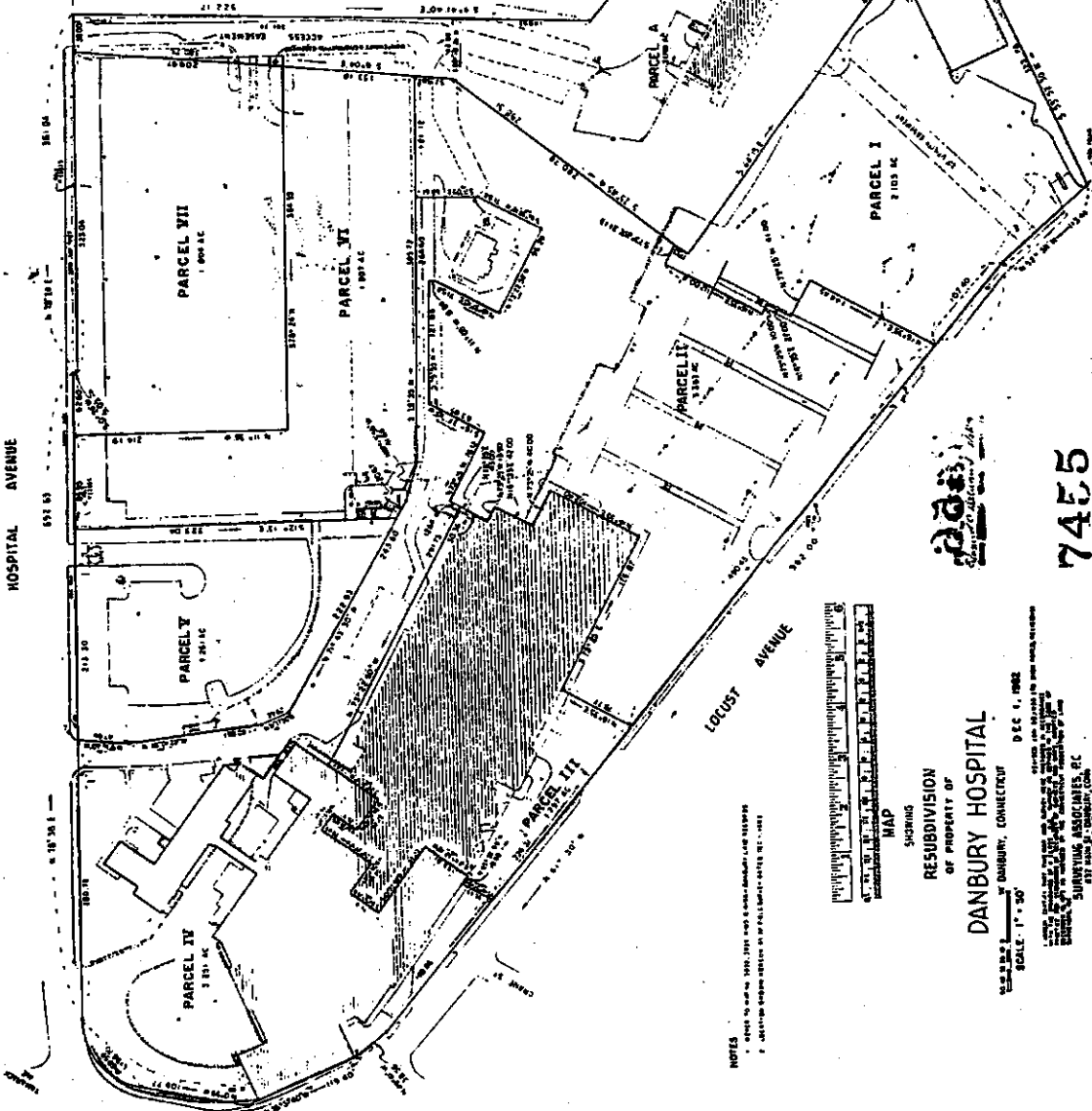
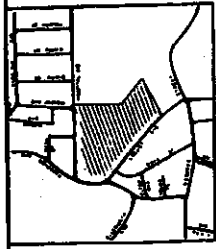

RECORDED AND FILED
DEC 15 1982
CITY OF DANBURY



7455

NOTES
1. THIS MAP IS TO BE CONSIDERED A PRELIMINARY MAP.
2. ALL DIMENSIONS ARE IN FEET AND DECIMALS THEREOF.



SHOWING
RESUBDIVISION
OF PROPERTY OF
DANBURY HOSPITAL

DANBURY HOSPITAL

SCALE: 1" = 50'
DEC 15 1982

PREPARED BY
SURVEYING ASSOCIATES, P.C.
1175 MAIN STREET
DANBURY, CONNECTICUT 06810
TEL: (203) 753-1111
FAX: (203) 753-1112