

April 16, 2026

Via Electronic and U.S. Mail

Melanie A. Bachman, Esq.
Executive Director/Staff Attorney
Connecticut Siting Council
10 Franklin Square
New Britain, CT 06051

Re: **Notice of Exempt Modification
Travelers Championship – Temporary Telecommunications Facility
Cromwell, Connecticut**

Dear Attorney Bachman:

Pursuant to R.C.S.A. Section 16-50j-72(d), this letter will serve as notice that Cellco Partnership d/b/a Verizon Wireless (“Cellco”) intends to install a temporary wireless facility (a/k/a “Cell on Wheels” or “COW”) for use prior to and during the 2026 Travelers Championship, scheduled for June 25-28, 2026. Cellco intends to install the COW on a 104-acre parcel owned by Eversource Energy (“Eversource”) and leased to the Greater Hartford Community Foundation, (a/k/a Travelers Championship) in Cromwell, Connecticut (the “Property”).

Included in Attachment 1 is a letter from the Greater Hartford Community foundation authorizing the filing of this notice. Included in Attachment 2 is a Lease Exhibit showing the proposed COW location and specifications for the COW, antennas and equipment that Cellco intends to use at the Property. In accordance with R.C.S.A. Section 16-50j-73, a copy of this filing has been sent to James Demetriades, Mayor for the Town of Cromwell and Andrew Armstrong, Cromwell’s Director of Planning and Development. A copy of this letter is also being sent to Eversource, the owner of the Property and to the Travelers Championship.

The COW that Cellco intends to install at the Property is a trailer-mounted wireless facility with a retractable and guyed tower mast extending to a height of 60 feet above ground

34396100-v1

Robinson+Cole

Melanie A. Bachman, Esq.
April 16, 2026
Page 2

level ("AGL"). Cellco will attach two (2) panel antennas at centerline heights of 58 feet AGL and 53 feet AGL on the mast. The COW will be powered by a diesel-fueled portable generator.

The proposed temporary telecommunications facility satisfies the criteria set forth in R.C.S.A. Section 16-50j-72(d), as a facility that will provide temporary wireless service for an event of State-wide significance. The COW will provide additional network capacity to accommodate increased wireless voice and data services needed leading up to and during the event. Cellco expects that the COW will be brought to the site on or about June 10, 2026 and will be removed on or about June 29, 2026.

The operation of the COW will not result in a total radio frequency (RF) emissions levels that exceed the Federal Communications Commission (FCC) safety standard. Included in Attachment 3 are Far Field Approximation Tables for the frequencies Cellco intends to deploy at the Property. These tables demonstrate that the temporary facility will operate well within FCC emissions standard.

Finally, in Attachment 4 is a copy of the Town Assessor's parcel map including owner information for the Property. A Certificate of Mailing verifying that this filing has been sent to municipal officials and the Property owner is included in Attachment 5.

Based on the foregoing, Cellco respectfully requests acknowledgement of this notice for the installation of a temporary wireless facility at the Property. Please feel free to contact me if you have any questions or need any additional information.

Sincerely,



Kenneth C. Baldwin

Attachments

Copy to:

James Demetriades, Mayor
Andrew Armstrong, Director of Planning and Development
Nathan Grube, Greater Hartford Community Foundation
Chris Gelinias, Eversource Energy
Daniel Fitzpatrick, Verizon Wireless, via email
Brian Ross, Structure Consulting, via email

ATTACHMENT 1

GREATER HARTFORD COMMUNITY FOUNDATION, INC.
90 State House Square, 11th Floor
Hartford, Connecticut 06103

**RE: Evidence of Agreement and Landowner's Consent to File for
Permits/Approvals to be Granted to Cellco Partnership d/b/a Verizon
Wireless**

To Whom It May Concern:

The Greater Hartford Community Foundation, Inc. is the lessee of certain real property located in the Town of Cromwell at Golf Club Road and identified as Map/Lot 60/77 on the tax map of the Town of Cromwell ("Subject Property").

Please be advised that Greater Hartford Community Foundation, Inc. has entered into an agreement with Cellco Partnership d/b/a Verizon Wireless ("Applicant") to install a temporary wireless communications facility on a portion of the Subject Property, and permission is hereby granted to Applicant to make application for Building, Zoning, Planning, or any other Land Use or Regulatory Permit(s) required to effectuate the installation of said wireless facility.

The Applicant, or its agent, is hereby authorized to execute the required application(s) regarding this matter. Permission is also hereby granted for public officials and Board, Commission or Council members, as required, to enter upon the Subject Property for the limited purpose of inspecting the specific site and access that are the subject of Applicant's proposed installation.

Sincerely,

GREATER HARTFORD COMMUNITY FOUNDATION, INC

By: 
Name: Nathan Grube
Title: Executive Director
Date: 04/14/26

ATTACHMENT 2

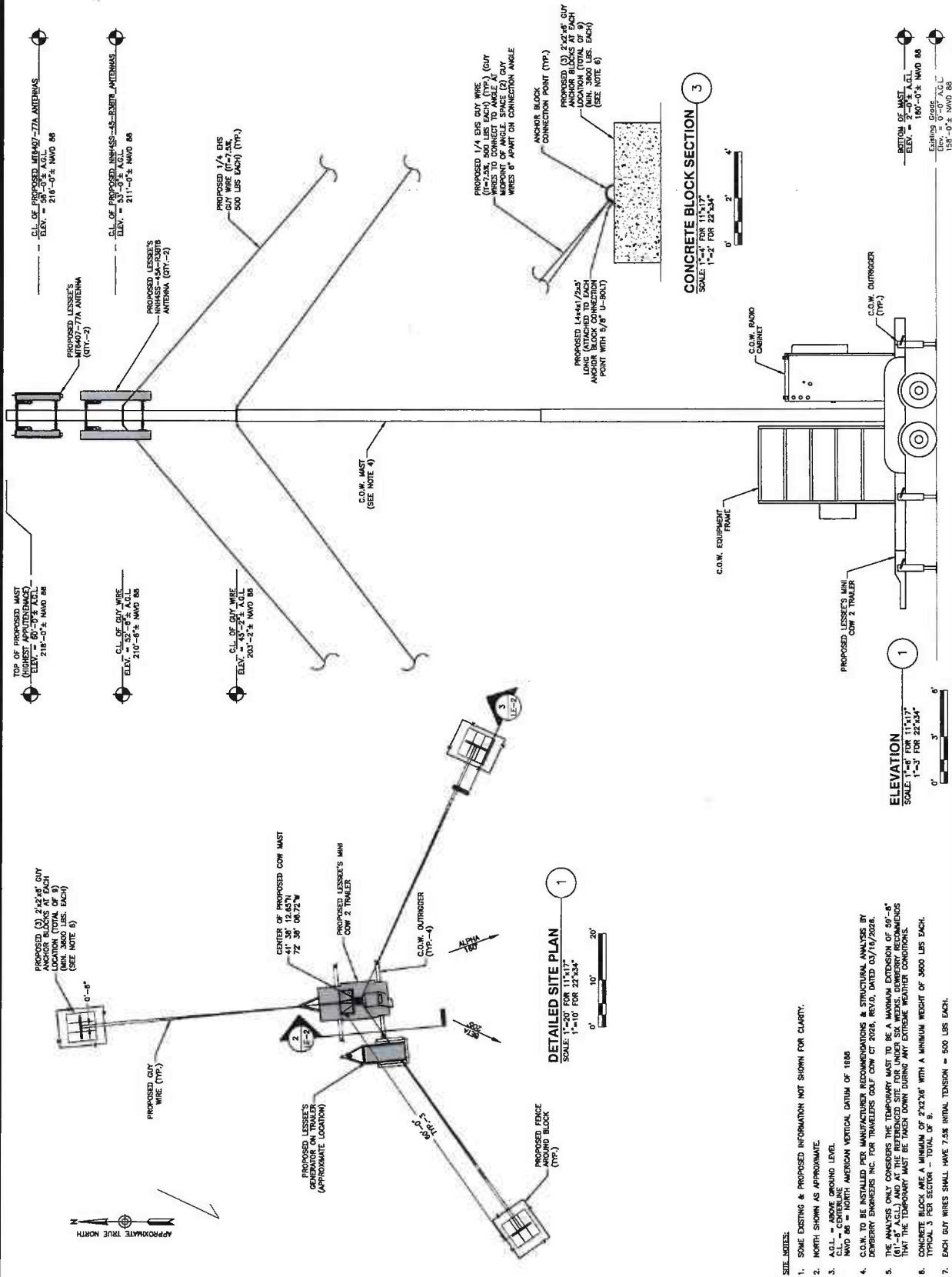

- SITE NOTES:**
- SOME EXISTING & PROPOSED INFORMATION NOT SHOWN FOR CLARITY.
 - NORTH SHOWN AS APPROXIMATE.
 - A.G.L. = ABOVE GROUND LEVEL.
 - C.O.W. TO BE INSTALLED PER MANUFACTURER RECOMMENDATIONS & STRUCTURAL ANALYSIS BY DEWBERRY ENGINEERS INC. FOR TRAVELERS GOLF COW CT 2026, REV.D. DATED 03/18/2026.
 - THE ANALYSIS ONLY CONSIDERS THE TEMPORARY MAST TO BE A MAXIMUM EXTENSION OF 84'-8" (81'-4" A.G.L.) AND OF THE REFERENCED SITE FOR UNDER SEA WEATHER CONDITIONS. THAT THE TEMPORARY MAST BE TAKEN DOWN DURING ANY EXTREME WEATHER CONDITIONS.
 - CONCRETE BLOCK ARE A MINIMUM OF 2'x2'x4" WITH A MINIMUM WEIGHT OF 3000 LBS EACH. TYPICAL 3 PER SECTOR - TOTAL OF 9.
 - EACH GUY WIRES SHALL HAVE 7.5X INITIAL TENSION = 500 LBS EACH.

NNH4SS-45A-R3BT8



16-port sector antenna, 4x 698–896, 8x 1695–2360 and 4x 3550–3700 MHz, 45° HPBW, 3x RETs and 3x SBTs.

- Features broadband Low Band (698-896 MHz), Mid Band(1695-2360 MHz) and High Band (3550-3700 MHz) arrays for 4T4R (4X MIMO) capability for bands 5, 13, 25, 66 and 48. Also covers bands 12, 14, 29, and 30
- Perfect antenna to add 3.5GHz CBRS to macro sites
- Array configuration provides capability for 4T4R (4X MIMO) on Low Band, dual 4T4R (4X MIMO) on Mid Band and 4T4R (4X MIMO) on High Band
- Excellent wind loading characteristics
- Non-stacked mid band array design provides higher gain and narrower vertical beamwidth than traditional antenna designs

General Specifications

Antenna Type	Sector
Band	Multiband
Color	Light Gray (RAL 7035)
Grounding Type	RF connector inner conductor and body grounded to reflector and mounting bracket
Performance Note	Outdoor usage
Radome Material	Fiberglass, UV resistant
Radiator Material	Low loss circuit board
Reflector Material	Aluminum
RF Connector Location	Bottom
RF Connector Quantity, high band	4
RF Connector Quantity, mid band	8
RF Connector Quantity, low band	4
RF Connector Quantity, total	16

Remote Electrical Tilt (RET) Information

RET Hardware	CommRET v2
RET Interface	8-pin DIN Female 8-pin DIN Male
RET Interface, quantity	3 female 3 male
Input Voltage	10–30 Vdc
Internal Bias Tee	Port 1 Port 5 Port 7

NNH4SS-45A-R3BT8

Internal RET	Low band (1) Mid band (2)
Power Consumption, active state, maximum	10 W
Power Consumption, idle state, maximum	2 W
Protocol	3GPP/AISG 2.0

Dimensions

Width	457 mm 17.992 in
Depth	178 mm 7.008 in
Length	1399 mm 55.079 in
Net Weight, antenna only	29.5 kg 65.036 lb

Array Layout

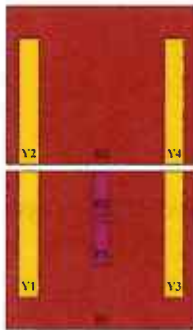

Array ID	Frequency (MHz)	RF Connector	RET (SPEL)	AISG No.	AISG RET UID
	698-896	1 - 2	1	AISG1	CPxxxxxxxxxxxxxxxxR1
	698-896	3 - 4			
Y1	1695-2360	5 - 6	2	AISG2	CPxxxxxxxxxxxxxxxxY1
Y3	1695-2360	9 - 10			
Y2	1695-2360	7 - 8	3	AISG3	CPxxxxxxxxxxxxxxxxY2
Y4	1695-2360	11 - 12			
	3550-3700	13 - 14	N/A	NA	N/A
	3550-3700	15 - 16			

(Sized colored boxes are not true depictions of array sizes)

Port Configuration

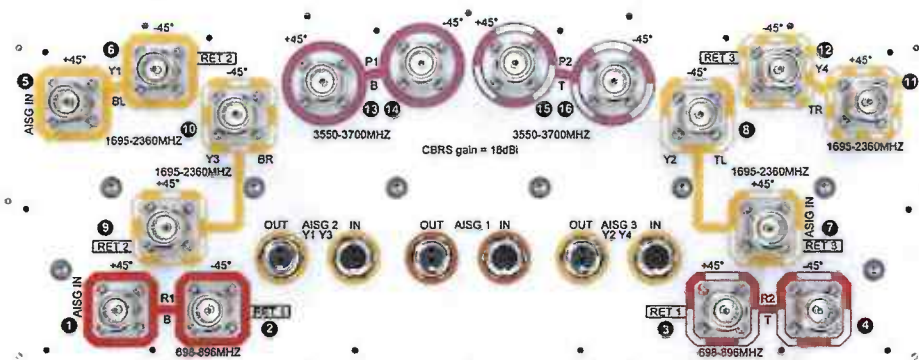

Electrical Specifications

NNH4SS-45A-R3BT8

Impedance	50 ohm
Operating Frequency Band	1695 – 2360 MHz 3550 – 3700 MHz 698 – 896 MHz
Polarization	±45°
Total Input Power, maximum	1,600 W @ 50 °C

Electrical Specifications

	R1,R2	R1,R2	Y1-Y4	Y1-Y4	Y1-Y4	Y1-Y4	P1,P2
Frequency Band, MHz	698–806	806–896	1695–1880	1850–1990	1920–2180	2300–2360	3550–3700
RF Port	1-4	1-4	5-12	5-12	5-12	5-12	13-16
Gain, dBi	12.7	13.3	15.3	15.7	16.3	16.5	15
Beamwidth, Horizontal, degrees	48	44	44	41	39	37	45
Beamwidth, Vertical, degrees	36	30.4	14.5	13.6	12.8	11.1	15.6
Beam Tilt, degrees	2–18	2–18	0–10	0–10	0–10	0–10	8
USLS (First Lobe), dB	19	17	16	17	16	15	16
Front-to-Back Ratio at 180°, dB	33	30	31	32	31	30	31
CPR at Boresight, dB	20	20	17	18	18	20	14
Isolation, Cross Polarization, dB	25	25	25	25	25	25	25
Isolation, Inter-band, dB	25	25	25	25	25	25	25
VSWR Return loss, dB	1.5 14.0	1.5 14.0	1.5 14.0	1.5 14.0	1.5 14.0	1.5 14.0	1.5 14.0
PIM, 3rd Order, 2 x 20 W, dBc	-153	-153	-153	-153	-153	-153	-145
Input Power per Port at 50°C, maximum, watts	300	300	250	250	250	200	100

Mechanical Specifications

Effective Projective Area (EPA), frontal	0.74 m ² 7.965 ft ²
Effective Projective Area (EPA), lateral	0.15 m ² 1.615 ft ²
Wind Loading @ Velocity, frontal	788.0 N @ 150 km/h (177.1 lbf @ 150 km/h)
Wind Loading @ Velocity, lateral	159.0 N @ 150 km/h (35.7 lbf @ 150 km/h)
Wind Loading @ Velocity, maximum	788.0 N @ 150 km/h (177.1 lbf @ 150 km/h)
Wind Loading @ Velocity, rear	692.0 N @ 150 km/h (155.6 lbf @ 150 km/h)
Wind Speed, maximum	241 km/h (150 mph)

Packaging and Weights

NNH4SS-45A-R3BT8

Width, packed	526 mm 20.709 in
Depth, packed	283 mm 11.142 in
Length, packed	1566 mm 61.654 in
Weight, gross	41.9 kg 92.374 lb

Regulatory Compliance/Certifications

Agency	Classification
CHINA-ROHS	Below maximum concentration value
REACH-SVHC	Compliant as per SVHC revision on www.andrew.com/ProductCompliance
ROHS	Compliant
UK-ROHS	Compliant



Included Products

BSAMNT-3	-	Wide Profile Antenna Downtilt Mounting Kit for 2.4 - 4.5 in (60 - 115 mm) OD round members. Kit contains one scissor top bracket set and one bottom bracket set.
----------	---	--

* Footnotes

Performance Note	Severe environmental conditions may degrade optimum performance
-------------------------	---

SAMSUNG

SAMSUNG C-Band 64T64R Massive MIMO Radio

for High Capacity and Wide Coverage

Samsung C-Band 64T64R Massive MIMO Radio enables mobile operators to increase coverage range, boost data speeds and ultimately offer enriched 5G experiences to users in the U.S..

Model Code: MT6407-77A

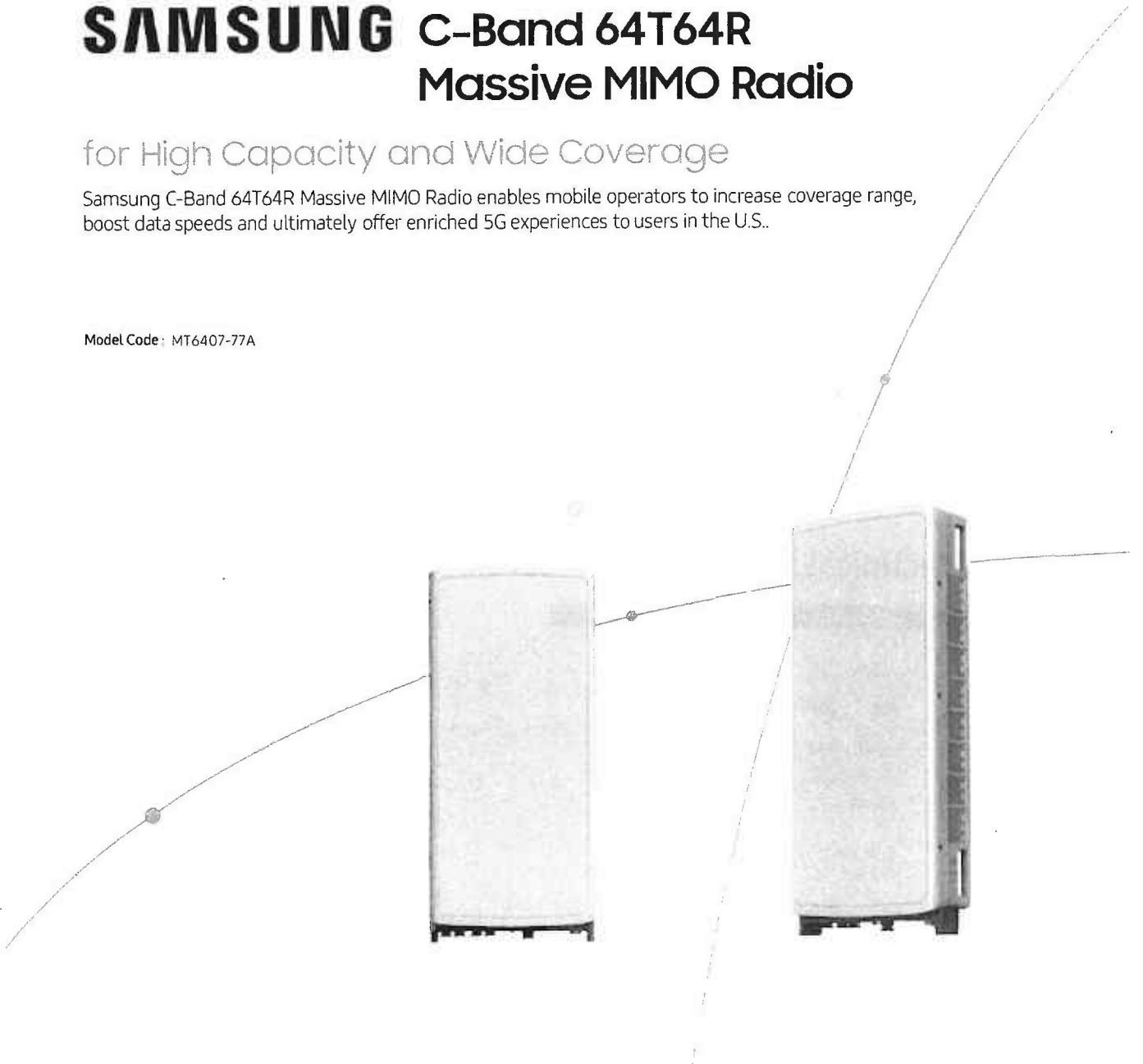

Points of Differentiation

Wide Bandwidth

With capability to support up to 2 CC carrier configuration, Samsung C-Band massive MIMO Radio supports 200 MHz bandwidth in the C-Band spectrum.

Samsung C-Band massive MIMO Radio covers the entire C-Band 280 MHz spectrum, so it can meet the operator's needs in current A block and future B/C blocks

C-Band spectrum supported by Massive MIMO Radio

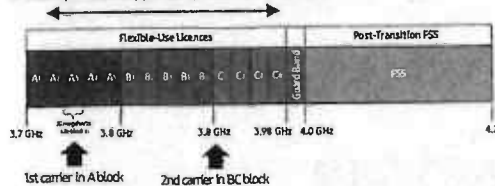

Enhanced Performance

C-Band massive MIMO Radio creates sharp beams and extends networks' coverage on the critical mid-band spectrum using a large number of antenna elements and high output power to boost data speeds.

This helps operators reduce their CAPEX as they now need less products to cover the same area than before.

Furthermore, as C-Band massive MIMO Radio supports MU-MIMO (Multi-user MIMO), it enables to increase user throughput by minimizing interference.



Future Proof Product

Samsung C-Band 64T64R Massive MIMO radio supports not only CPRI but also eCPRI as front-haul interface. It enables operators can cut down on OPEX/CAPEX by reducing front-haul bandwidth through low layer split and using ethernet based higher efficient line.

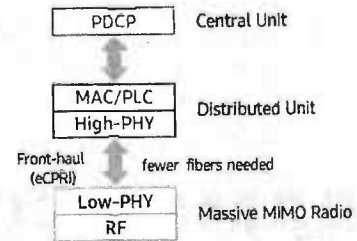

Well Matched Design

Samsung C-Band Massive MIMO radio utilizes 64 antennas, supports up to 280MHz bandwidth, and delivers a 200W output power. Despite the above advanced performance, the Radio has a compact size of 50.9L and 79.4lbs. This makes it easy to install the Radio.

It is designed to look solid and compact, with a low profile appearance so that, when installed, harmonizes well with the surrounding environment.

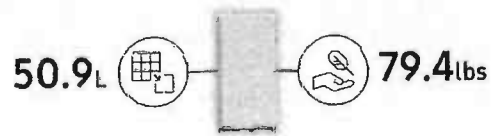

Technical Specifications

Item	Specification
Tech	NR
Band	n77
Frequency Band	3700 - 3980 MHz
EIRP	78.5dBm (53.0 dBm+25.5 dBi)
IBW/OBW	280 MHz / 200 MHz
Installation	Pole/Wall
Size/Weight	16.06 x 35.06 x 5.51 inch (50.86L) / 79.4 lbs

ATTACHMENT 3

*Guidelines adopted by the FCC on August 1, 1996, 47 CFR Section 1.1310 based on NCRP Report 86, 1986 and generally on ANSI/IEEE C95.1-1992

MHz = Megahertz
 mW/cm² = milliwatts per square centimeter
 ERP = Effective Radiated Power

Absolute worst case maximum values used, including the following assumptions:

1. closest accessible point is distance from antenna to base of pole;
2. continuous transmission from all available channels at full power for indefinite time period;
3. calculation takes into account a point of interest of 2m or 6.56ft

Location		Travelers Gold Tournament Temp 2026			
Date	4/14/2026	PCS		850	700
Operating Frequency (MHz)	3,700	2,145	1,970	869	746
General Population MPE (mW/cm ²)	1	1	1	0.579333333	0.497333333
ERP Per Transmitter (Watts)	33,688	3,785	2,090	1,186	989
Number of Transmitters	2	4	4	4	4
Antenna Centerline (CL) (feet)	58	53	53	53	53
Total ERP (Watts)	67,376	15,140	8,360	4,744	3,956
Total ERP (dBm)	78	72	69	67	66
63.29%					

RF Exposure 6.56ft Above Ground Level Far Field Formula (per FCC OET65)

--- Total %
 General Pwr Density
 Pop MPE (mW/cm²)

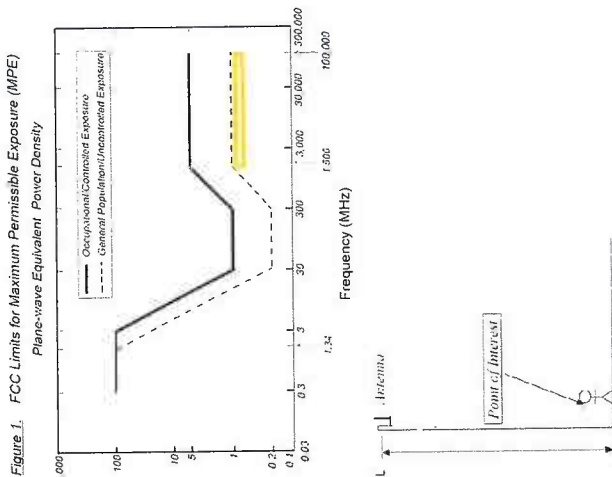
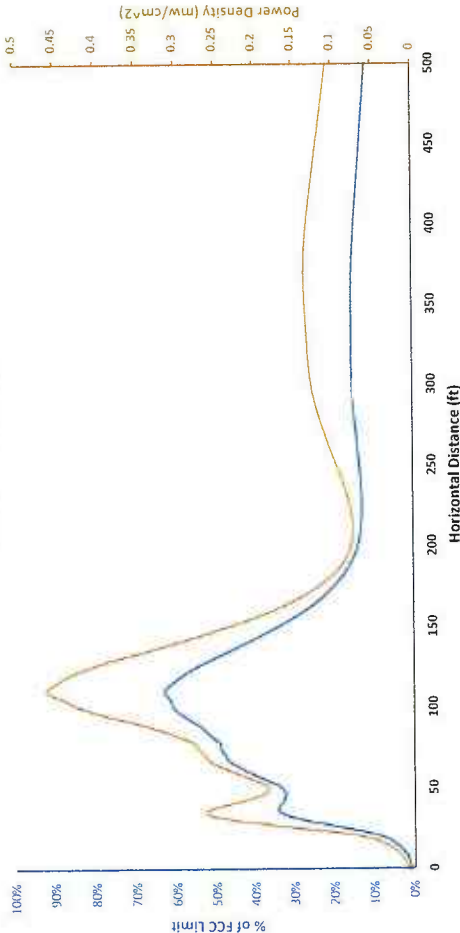

Angle Below Horizon	Power Density (mW/cm ²)					Distance	Total Pwr Density (mW/cm ²)	Total % General Pop						
	C-Band	AW5	PCS	850	700 MHz									
90	0.007975302	0.000317823	9.64419E-05	0.000547273	0.000675019	0.00%	0.03%	0.01%	0.09%	0.00%	0.14%	0.009611859	1.07%	
89	0.007973274	0.000317724	7.48394E-05	0.000628158	0.000811298	0.00%	0.03%	0.01%	0.11%	0.00%	0.16%	0.020388052	1.11%	
88	0.008152771	0.000317426	1.67388E-05	0.000974081	0.000974081	0.00%	0.80%	0.00%	0.82%	0.00%	0.12%	0.00%	0.010181964	1.17%
87	0.008332062	0.000319893	2.25448E-05	0.000826008	0.001117109	0.00%	0.83%	0.00%	0.04%	0.00%	0.22%	0.00%	0.010596716	1.24%
86	0.008510948	0.000318865	0.000162966	0.000924771	0.0012221	0.00%	0.85%	0.00%	0.06%	0.00%	0.15%	0.00%	0.01140976	1.33%
85	0.008891619	0.000868548	0.000224323	0.001011143	0.001336362	0.00%	0.89%	0.00%	0.09%	0.00%	0.17%	0.00%	0.012331995	1.44%
84	0.009073197	0.001141035	0.000262651	0.001079736	0.001594633	0.00%	0.91%	0.00%	0.11%	0.00%	0.19%	0.00%	0.013016876	1.53%
83	0.009469244	0.001398074	0.000267677	0.001126028	0.001594633	0.00%	0.95%	0.00%	0.14%	0.00%	0.19%	0.00%	0.013855655	1.63%
82	0.00987744	0.001525762	0.000260356	0.001175661	0.002174022	0.00%	0.99%	0.00%	0.15%	0.00%	0.21%	0.00%	0.01457779	1.72%
81	0.010537705	0.001552385	5.04949E-05	0.001223324	0.00233751	0.00%	1.05%	0.00%	0.16%	0.00%	0.21%	0.00%	0.01539726	1.83%
80	0.01098041	0.001579685	0.000282261	0.001301935	0.002375204	0.00%	1.10%	0.00%	0.16%	0.00%	0.23%	0.00%	0.0161813924	1.99%
79	0.011701996	0.001801752	0.000444001	0.001354297	0.002888678	0.00%	1.17%	0.00%	0.18%	0.00%	0.23%	0.00%	0.020583118	2.20%
78	0.012754634	0.002251847	0.000637704	0.001474204	0.003464729	0.00%	1.28%	0.00%	0.27%	0.00%	0.25%	0.00%	0.02877405	2.83%
77	0.013578141	0.002685965	0.000743328	0.00164104	0.004228932	0.00%	1.36%	0.00%	0.29%	0.00%	0.26%	0.00%	0.039583118	3.19%
76	0.014783397	0.002919962	0.000808096	0.001868083	0.005040895	0.00%	1.48%	0.00%	0.27%	0.00%	0.28%	0.00%	0.05420423	3.53%
75	0.015720519	0.003100042	0.000800066	0.00207676	0.006004792	0.00%	1.57%	0.00%	0.31%	0.00%	0.30%	0.00%	0.072702773	3.86%
74	0.016707164	0.003444004	0.000795793	0.002307212	0.006826516	0.00%	1.67%	0.00%	0.34%	0.00%	0.34%	0.00%	0.090042506	3.86%
73	0.018159988	0.004003853	0.000715416	0.002446228	0.007936126	0.00%	1.82%	0.00%	0.40%	0.00%	0.42%	0.00%	0.033326161	4.31%

ATTACHMENT 4

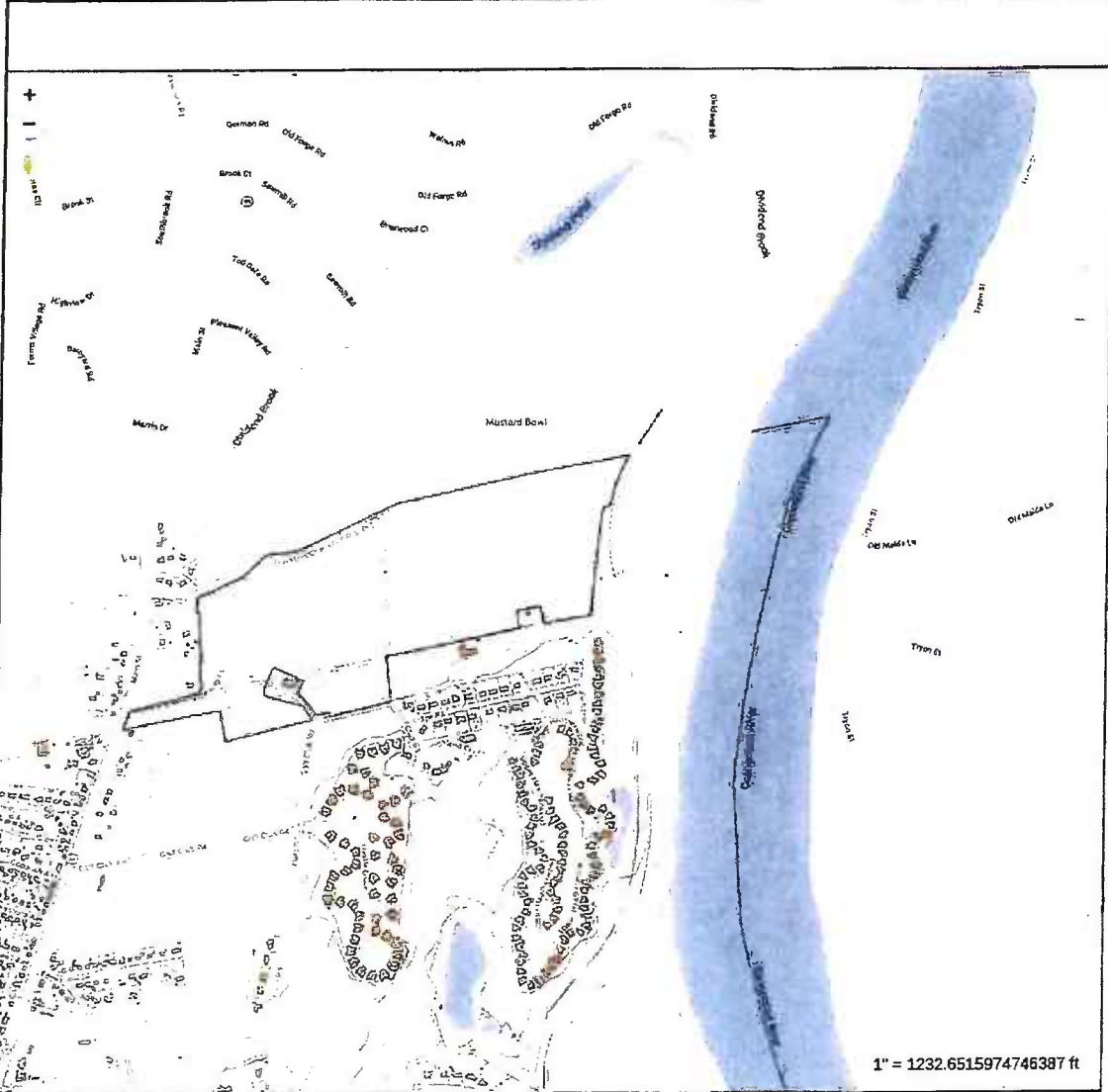

Property Information
 Property ID 00095700
 Location 674 MAIN STREE
 Owner
 Owner Address
 Map Block Lot

**MAP FOR REFERENCE ONLY
 NOT A LEGAL DOCUMENT**
 Town of Cromwell, CT makes no claims and no warranties, expressed or implied, concerning the validity or accuracy of the GIS data presented on this map.
 Geometry updated 8/30/2022
 Data updated on a daily basis

Print map scale is approximate.
 Critical layout or measurement activities should not be done using this resource.



Patriot Properties Inc.

Printed By: Shawna 11/04/2022 2:23:00PM

TOWN OF CROWWELL
Parcel ID: 0009S700 Location: 674 MAIN STREET
Map-Lot 60-77 Last Revision - October 1, 2022

Current Value Information	PA 480 Value	Mkt Adj Cost Building Value	Total Value	Outbuildings	Total Value	Total Assessed
Use Code 200	5,121,900	0	5,121,900	0	5,121,900	3,585,330
Percent 100	5,121,900	0	5,121,900	0	5,121,900	3,585,330
TOTAL						

Current Owner: CONNECTICUT LIGHT POWER
PO BOX 270 HARTFORD CT 06106

Previous Value Information	Land Value	Blgd Value	Outbuildings	Total Value	Total Assessment
Tax Yr 2021	4,784,300	0	0	4,784,300	3,358,010
2020	4,784,300	0	0	4,784,300	3,358,010
2019	4,784,300	0	0	4,784,300	3,358,010
2018	4,784,300	0	0	4,784,300	3,358,010
2017	4,784,300	0	0	4,784,300	3,358,010
2016	4,387,490	0	0	4,387,490	3,078,260

General Notes: Census 5703
Flood: Topo: 3,358,010
Street Period: 3,358,010
Dev. Map ZZ-36YY-3
Dev. Map 3,358,010
Zoning Data: Desc. %
BP 100.00

Utilities: 4 Sewer Avail
7 Water Avail
BAA

Property Factors: Census 5703
Flood: Topo: 3,358,010
Street Period: 3,358,010
Dev. Map ZZ-36YY-3
Dev. Map 3,358,010
Zoning Data: Desc. %
BP 100.00

Activity Information

Date	Results	Visited By	Date	Permit #	Description	Amount	% Comp	Visit Date	GO Date	GeneralNotes
07/29/2022	Change - Value Change Company	DH	05/07/2020	26780	Electric	50,000	0			COMMUNICATION POLE
06/06/2017	Change - Value Change Company	John Valenti	10/04/2019	26421	Electric	1,175	0			SUB PANEL-PUMP HOUSE
05/17/2017	No Change - Field Review	Deva Starnard								
01/20/2011	Map Filed Average Chg	Shawna Barton								
02/08/2010	Map Filed Average Chg									
12/28/2006	Measure & Inspected									

Sales Information: Vol-Page 89-703 Type 07/07/1971 Sale Price 0 Sale Verif GeneralNotes

Building Permit Information

Use	Description	Units	Neigh	Special Land Calc	Appraised Value	PA 480 Neigh Asmt Order	Notes
200	Commercial Vac	43,680	SF	0	2,439,800	0 4260	
200	Commercial Vac	102,190	AC	2,892,500	0	0 4260	
Total Area: 102.19					Total Appraised: 5,121,900	Assessed Value: 3,585,330	

Land Data: PA 480 Use Aamt: 0 Total Appraised: 5,121,900 Assessed Value: 3,585,330

Disclaimer: This information is believed to be correct but is subject to change and is not warranted.

ATTACHMENT 5

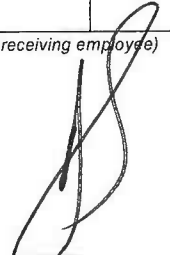

Name and Address of Sender Kenneth C. Baldwin, Esq. Robinson & Cole LLP One State Street Hartford, CT 06103	TOTAL NO. of Pieces Listed by Sender 4	TOTAL NO. of Pieces Received at Post Office™ 4	Affix Stamp Here <i>Postmark with Date of Receipt.</i> 
	Postmaster, per (name of receiving employee) 		

USPS® Tracking Number Firm-specific Identifier	Address (Name, Street, City, State, and ZIP Code™)	Postage	Fee	Special Handling	Parcel Airlift
1.	James Demetriades, Mayor Town of Cromwell 41 West Street Cromwell, CT 06416				
2.	Andrew Armstrong, Director of Planning and Development Town of Cromwell 41 West Street Cromwell, CT 06416				
3.	Nathan Grube Greater Hartford Community Foundation 90 State House Square, 11 th Floor Hartford, CT 06103				
4.	Christopher Gelinias Eversource 107 Selden Street Berlin, CT 06037				
5.					
6.					