

April 28, 2017

*Via Federal Express*

Melanie A. Bachman, Esq.  
Executive Director/Staff Attorney  
Connecticut Siting Council  
10 Franklin Square  
New Britain, CT 06051

**Re: Notice of Exempt Modification  
Travelers Championship – Temporary Telecommunications Facility  
Cromwell, Connecticut**

Dear Ms. Bachman:

Pursuant to R.C.S.A. Section 16-50j-72(d), this letter will serve as notice that Cellco Partnership d/b/a Verizon Wireless (“Cellco”) intends to install a temporary wireless repeater facility (a/k/a “Cell Repeater on Wheels” or “CROW”) for use prior to and during this year’s Travelers Championship scheduled for June 19-25, 2017, at TPC River Highlands, Golf Club Road in Cromwell, Connecticut (the “Property”). Included in [Attachment 1](#) is a letter from the Travelers Championship authorizing the filing of this notice. Also included in [Attachment 2](#) is an overall site plan of the TPC River Highlands property showing the proposed location for Cellco’s CROW. In accordance with R.C.S.A. Section 16-50j-73, a copy of this filing has been sent to Enzo Faienza, Mayor for the Town of Cromwell and Stuart Popper, Cromwell’s Director of Planning and Development.

The CROW that Cellco intends to install at the Property is a trailer-mounted wireless repeater with a retractable tower mast. (See CROW specifications included in [Attachment 3](#)). Cellco will attach a single antenna to the top of the mast. Equipment associated with the CROW will be located inside a cabinet on the trailer. The equipment will be connected to an existing power source on the Property.

16385566-v1

Melanie A. Bachman, Esq.  
April 28, 2017  
Page 2

The proposed temporary telecommunications facility satisfies the criteria set forth in R.C.S.A. Section 16-50j-72(d), as a facility that will provide temporary wireless service for an event of State-wide significance. The CROW will provide additional network capacity to accommodate increased wireless voice and data services needed during the event. Cellco expects that the CROW will be brought to the site on or about June 12, 2017, and will be removed on or about July 2, 2017.

The operation of the CROW will not result in a total radio frequency (RF) emissions levels that exceed the Federal Communications Commission (FCC) safety standard. The “worst-case” calculation of RF emissions from the CROW would be 63.15% of the FCC standard. (See General Power Density table included in Attachment 4). Actual RF emissions levels from this temporary facility will be substantially lower than these worst-case approximations. The only noise associated with the CROW’s operations occurs when the tower mast is raised and lowered with the help of a small 7 kW generator located on the trailer. Otherwise, during normal operations the CROW does not generate any noise.

Lastly, a copy of the Town Assessor’s parcel map including owner information is included in Attachment 5.

Based on the foregoing, Cellco respectfully requests acknowledgement of this notice for the installation of a temporary wireless facility at the Travelers Championship in Cromwell, Connecticut. Please feel free to contact me if you have any questions or need any additional information.

Sincerely,

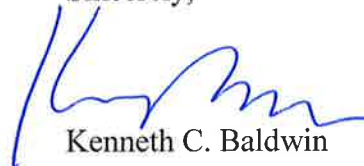

Kenneth C. Baldwin

KCB/kmd  
Attachments  
Copy to:

Enzo Faienza, Mayor  
Tim Parks  
Mark Brauer  
Shelby Docker

# **ATTACHMENT 1**



**TRAVELERS**  
CHAMPIONSHIP

March 29, 2017

Tony Befera, Manager-Real Estate &  
Project Implementation  
Cellco Partnership d/b/a Verizon Wireless  
99 East River Drive, 9<sup>th</sup> Floor  
East Hartford, CT 06108

Re: Cellco Partnership d/b/a Verizon Wireless  
Proposed Temporary Communications Facility  
at One Golf Club Rd, Cromwell, CT 06416

Dear Mr. Befera:

The Greater Hartford Community Foundation, Inc., is the owner of the property at One Golf Club Rd, Cromwell, Connecticut (the "Property") during the Traveler's Championship Tournament. This letter authorizes Verizon Wireless and/or its authorized agent to file for all necessary federal, state or local permits approvals for the proposed wireless telecommunication facility at the Property.

Sincerely,

  
Nathan Grube, Executive Director

cc: Kenneth Baldwin  
Shelby Docker

# **ATTACHMENT 2**

LEASE EXHIBIT

A&E OFFICE:  
 7A LYBERTY WAY  
 WESTFORD, MA 01886  
 1 (972) 755-1882

LATITUDE: 41° 37' 30.22" N  
 LONGITUDE: 72° 38' 25.44" W  
 GROUND ELEV.: 151'± A.M.S.L.  
 SITE COORDINATES & GROUND ELEVATION PROVIDED BY LESSEE.

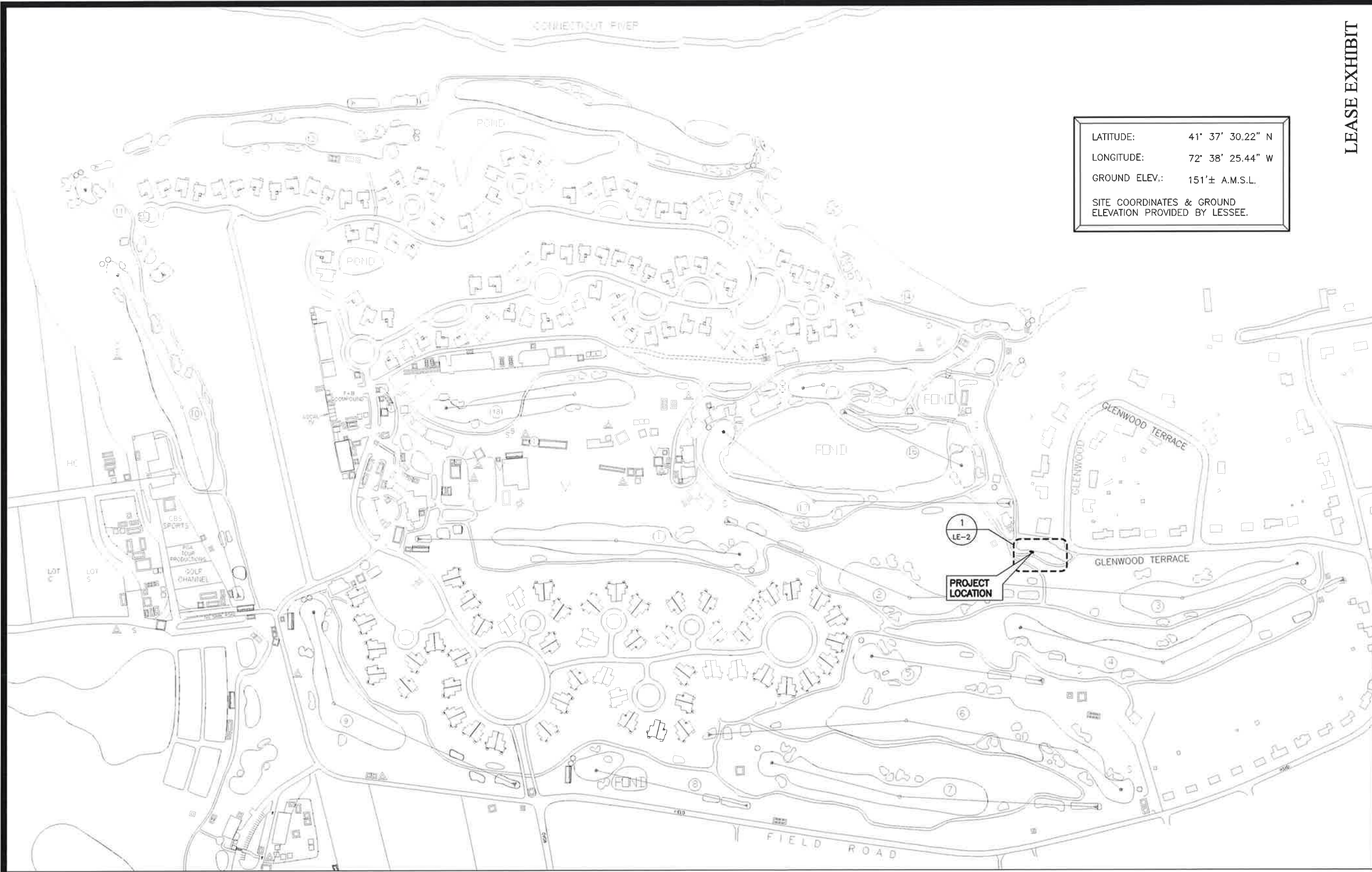

THIS DOCUMENT IS THE DESIGN PROPERTY AND COPYRIGHT OF NEXIUS AND FOR THE EXCLUSIVE USE BY THE TITLE CLIENT. DUPLICATION OR USE WITHOUT THE EXPRESS WRITTEN CONSENT OF THE CREATOR IS STRICTLY PROHIBITED.

DRAWING SCALES ARE INTENDED FOR 11"x17" SIZE PRINTED MEDIA ONLY. ALL OTHER PRINTED SIZES ARE DEEMED "NOT TO SCALE".

SUBMITTALS			
REV	DATE	DESCRIPTION	BY
A	02/23/17	FOR REVIEW	JM

SITE INFO:  
 SITE NAME:  
**TRAVELERS CHAMPIONSHIP TOURNAMENT CROW**  
 SITE ADDRESS:  
**1 GOLF CLUB ROAD  
 ACCESS VIA  
 GLENWOOD TERRACE  
 CROMWELL, CT 06416**

CHECKED BY: **KB**      DATE: **02/23/17**

PROJECT NUMBER: **-**

SHEET NUMBER:  
**LE-1**



APPROX. NORTH

**1** OVERALL SITE PLAN  
 SCALE: 1" = 400'

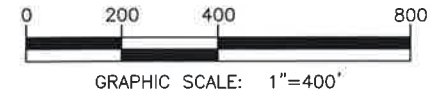

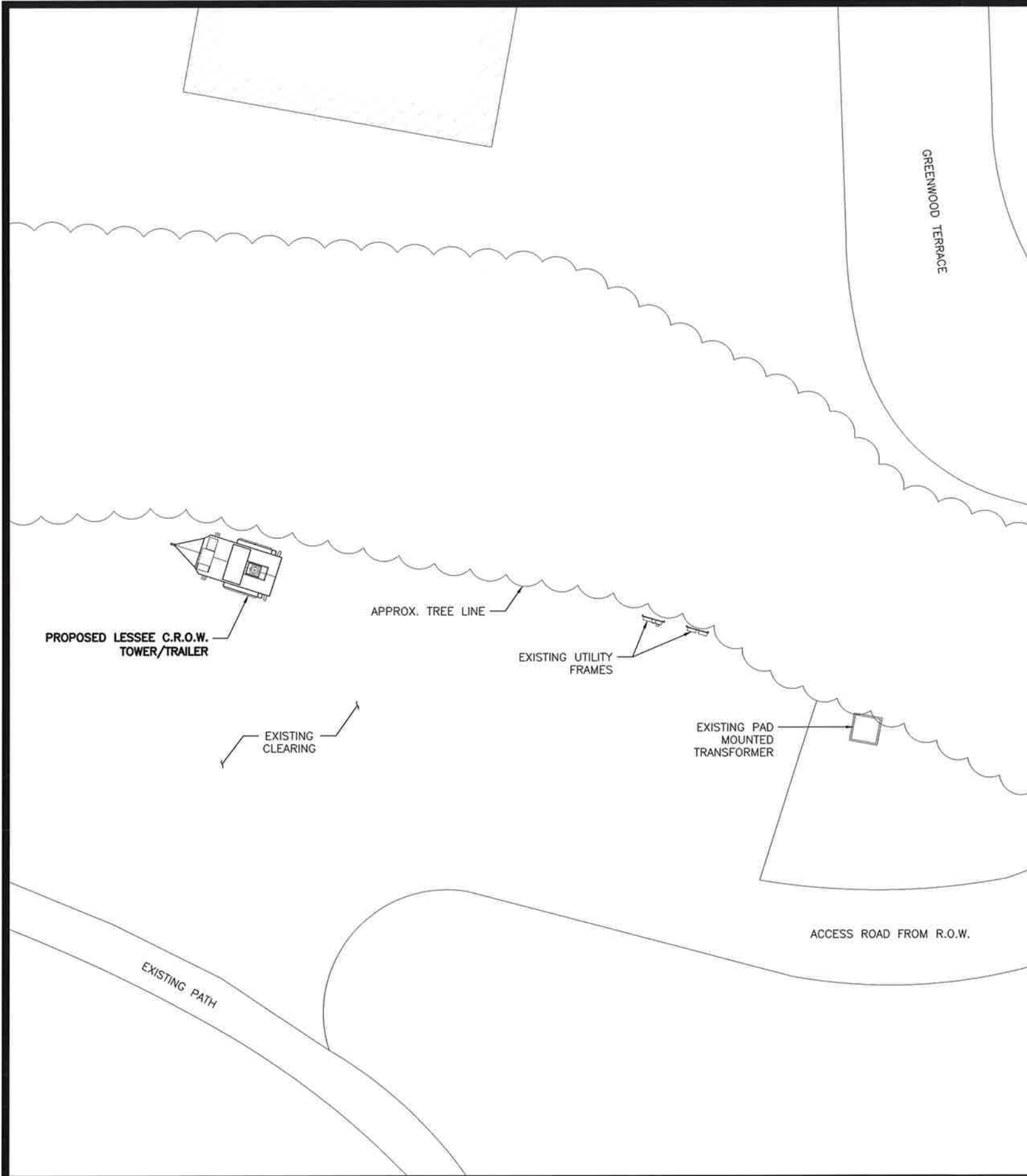

1 PARTIAL SITE PLAN  
SCALE: 1" = 20'

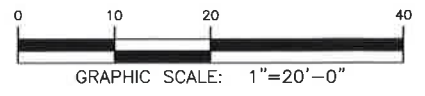

- NOTES:
1. THE PROPOSED LESSEE ANTENNA CONFIGURATION TO CONSIST OF A TOTAL OF (2) ANTENNAS, ASSOCIATED CABLES & APPURTENANCES.
  2. POWER & PROPOSED LESSEE C.R.O.W. FACILITY TO BE PROVIDED BY OWNER. UTILITY DEMARC WILL BE DETERMINED & COORDINATED WITH OWNER PRIOR TO C.R.O.W. MOBILIZATION.

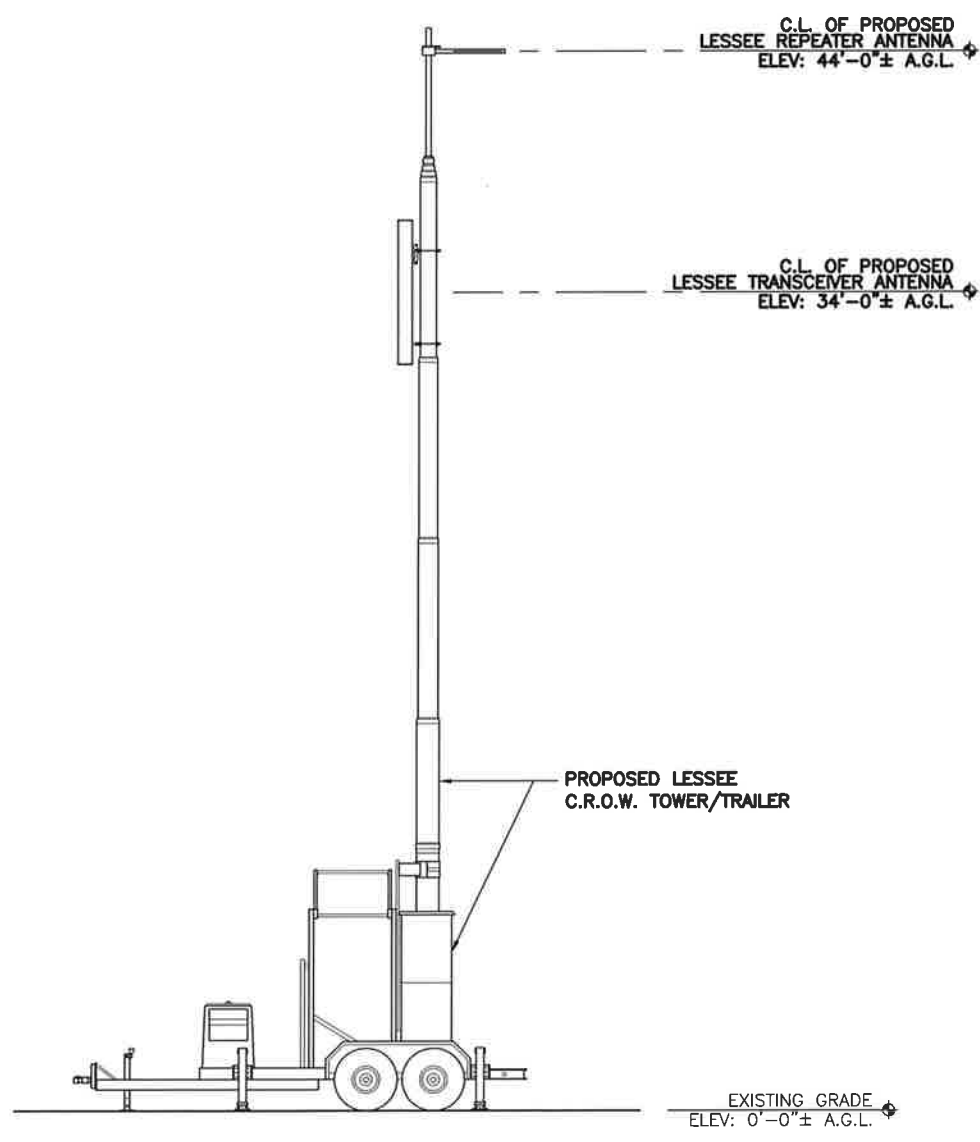

2 ELEVATION  
SCALE: 1/8" = 1'-0"

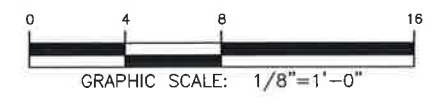

PREPARED BY:



A&E OFFICE:  
7A LYBERTY WAY  
WESTFORD, MA 01886  
1 (972) 755-1882

THIS DOCUMENT IS THE DESIGN PROPERTY AND COPYRIGHT OF NEXIUS AND FOR THE EXCLUSIVE USE BY THE TITLE CLIENT. DUPLICATION OR USE WITHOUT THE EXPRESS WRITTEN CONSENT OF THE CREATOR IS STRICTLY PROHIBITED.

DRAWING SCALES ARE INTENDED FOR 11"x17" SIZE PRINTED MEDIA ONLY. ALL OTHER PRINTED SIZES ARE DEEMED "NOT TO SCALE".

SUBMITTALS			
REV	DATE	DESCRIPTION	BY
A	02/23/17	FOR REVIEW	JM

SITE INFO:

SITE NAME:  
TRAVELERS CHAMPIONSHIP TOURNAMENT CROW

SITE ADDRESS:  
1 GOLF CLUB ROAD  
ACCESS VIA  
GLENWOOD TERRACE  
CROMWELL, CT 06416

CHECKED BY: KB DATE: 02/23/17

PROJECT NUMBER: --

SHEET NUMBER:  
**LE-2**

# **ATTACHMENT 3**



ENGINEER: EAL

THIS DRAWING IS THE CONFIDENTIAL PROPERTY AND CONTAINS TRADE SECRETS OF CELEXION, LLC. ANY USE OF THESE DRAWINGS OR THE INFORMATION CONTAINED HEREIN FOR ANY REASON OTHER THAN AS EXPRESSLY AUTHORIZED BY CELEXION, LLC IS STRICTLY PROHIBITED. THIS DRAWING HAS BEEN DISTRIBUTED WITH THE UNDERSTANDING THAT FUTURE REVISIONS OR IMPROVEMENTS WILL BE NECESSARILY MADE TO IT AS NECESSARY TO MAINTAIN ITS CONFIDENTIAL NATURE.

5031 Hazel Jones Road  
Bossier City, LA 71111  
Voice: 318-213-2900  
Fax: 318-213-2919  
www.celexion.com

**CELEXION**  
A Division of Sobro Industries, Inc.

CUSTOMER:

PROJECT:  
**ACLX23  
TOWER TRAILER  
COVER SHEET /  
PARTS LIST**

DESIGNER:	DATE:
DRAWN BY:	DATE:
CHECKED BY:	DATE:
APPROVED BY:	DATE:
APPROVED BY:	DATE:
SHEET NO.:	1 OF 12
DRAWING NO.:	ACLX23

- NOTES:**
- ALL PARTS TO BE FABRICATED SHALL BE DONE PRIOR TO WELDING TO ASSEMBLY (e.g. CUT, DRILL, PUNCH HOLES, ETC.). SEE PART DRAWINGS FOR DETAILS.
  - ALL WELDS SHALL BE SEAL WELDS UNLESS NOTED OTHERWISE.
  - ALL WELDS SHALL BE CLEANED AND FREE OF FLUX, SLAG, AND WELD SPATTER.
  - ALL HOLES SHALL BE DEBURRED AND FREE FROM SHARP OR JAGGED EDGES.
  - ALL PENETRATIONS THROUGH STEEL MUST BE PROTECTED FROM CORROSION PLATFORM AND MAST CRADLE:
- THREE COAT SYSTEM**
- ZINC RICH PRIMER (CATHACOAT® 302H)
  - EPoxy MID-COAT (BAR-RUST® 235)
  - URETHANE TOP COAT (DEVTHANE® 369)
- TRAILER AND TRAILER PARTS:**
- PRIMER (EPOXY) AND PAINT URETHANE BLACK (GLOSS)
  - ASSEMBLY WEIGHT: N/A (ESTIMATED W/O EQUIPMENT)
  - "NO CHANGES" SHALL BE MADE WITHOUT ENGINEER APPROVAL.
  - FOR QUESTIONS ABOUT CONSTRUCTION OR QUOTED PARTS NOT ILLUSTRATED ON PLANS CONTACT VICTOR HASSELL (EXT. 2802)
- KNOWN ITEMS INCLUDE:**
- ADDITIONAL DOTTO LIGHTING
  - SPARE TIRE MOUNT
  - (2) 48" x 18" x 18" TOOL BOXES
  - MAST CONTROL VALVE
  - MAST AIR COMPRESSOR
  - HYDRAULIC MOTOR FOR LEVELING SYSTEM
  - HYDRAULICS FOR MAST (MOTOR & 2 HYDRAULIC CYLINDERS)

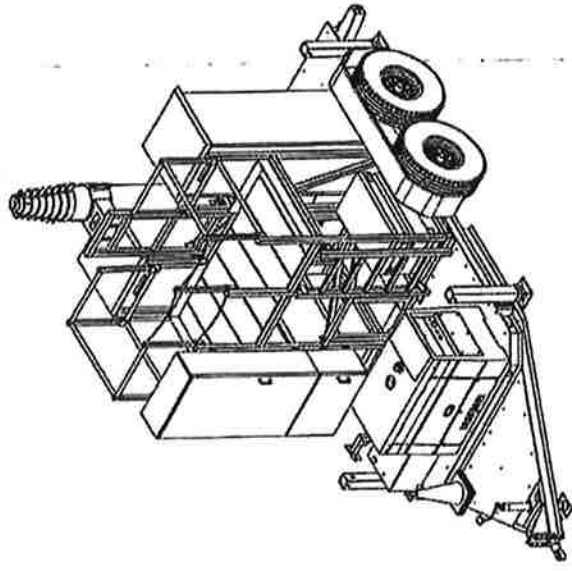

ITEM	QTY	U/M	P/N	DESCRIPTION	LENGTH	WIDTH	PCS
1	1	EA	140334	GRIP CHUTE PLANK, 12X12, 25' L	27.5625 ft		1
2	1	EA	140335	GRIP CHUTE PLANK, 12X12, 25' L	27.5625 ft		1
3	1	EA	140336	GRIP CHUTE PLANK, 12X12, 25' L	27.5625 ft		1
4	2	EA	140337	GRIP CHUTE PLANK, 12X12, 25' L	27.5625 ft		2
5	2	EA	140338	GRIP CHUTE PLANK, 12X12, 25' L	27.5625 ft		2
6	2	EA	140339	GRIP CHUTE PLANK, 12X12, 25' L	27.5625 ft		2
7	2	EA	140340	GRIP CHUTE PLANK, 12X12, 25' L	27.5625 ft		2
8	2	EA	140341	GRIP CHUTE PLANK, 12X12, 25' L	27.5625 ft		2
9	2	EA	140342	GRIP CHUTE PLANK, 12X12, 25' L	27.5625 ft		2
10	2	EA	140343	GRIP CHUTE PLANK, 12X12, 25' L	27.5625 ft		2
11	2	EA	140344	GRIP CHUTE PLANK, 12X12, 25' L	27.5625 ft		2
12	2	EA	140345	GRIP CHUTE PLANK, 12X12, 25' L	27.5625 ft		2
13	2	EA	140346	GRIP CHUTE PLANK, 12X12, 25' L	27.5625 ft		2
14	2	EA	140347	GRIP CHUTE PLANK, 12X12, 25' L	27.5625 ft		2
15	2	EA	140348	GRIP CHUTE PLANK, 12X12, 25' L	27.5625 ft		2
16	2	EA	140349	GRIP CHUTE PLANK, 12X12, 25' L	27.5625 ft		2
17	2	EA	140350	GRIP CHUTE PLANK, 12X12, 25' L	27.5625 ft		2
18	2	EA	140351	GRIP CHUTE PLANK, 12X12, 25' L	27.5625 ft		2
19	2	EA	140352	GRIP CHUTE PLANK, 12X12, 25' L	27.5625 ft		2
20	2	EA	140353	GRIP CHUTE PLANK, 12X12, 25' L	27.5625 ft		2
21	2	EA	140354	GRIP CHUTE PLANK, 12X12, 25' L	27.5625 ft		2
22	2	EA	140355	GRIP CHUTE PLANK, 12X12, 25' L	27.5625 ft		2
23	2	EA	140356	GRIP CHUTE PLANK, 12X12, 25' L	27.5625 ft		2
24	2	EA	140357	GRIP CHUTE PLANK, 12X12, 25' L	27.5625 ft		2
25	2	EA	140358	GRIP CHUTE PLANK, 12X12, 25' L	27.5625 ft		2
26	2	EA	140359	GRIP CHUTE PLANK, 12X12, 25' L	27.5625 ft		2
27	2	EA	140360	GRIP CHUTE PLANK, 12X12, 25' L	27.5625 ft		2
28	2	EA	140361	GRIP CHUTE PLANK, 12X12, 25' L	27.5625 ft		2
29	2	EA	140362	GRIP CHUTE PLANK, 12X12, 25' L	27.5625 ft		2
30	2	EA	140363	GRIP CHUTE PLANK, 12X12, 25' L	27.5625 ft		2
31	2	EA	140364	GRIP CHUTE PLANK, 12X12, 25' L	27.5625 ft		2
32	2	EA	140365	GRIP CHUTE PLANK, 12X12, 25' L	27.5625 ft		2
33	2	EA	140366	GRIP CHUTE PLANK, 12X12, 25' L	27.5625 ft		2
34	2	EA	140367	GRIP CHUTE PLANK, 12X12, 25' L	27.5625 ft		2
35	2	EA	140368	GRIP CHUTE PLANK, 12X12, 25' L	27.5625 ft		2
36	2	EA	140369	GRIP CHUTE PLANK, 12X12, 25' L	27.5625 ft		2
37	2	EA	140370	GRIP CHUTE PLANK, 12X12, 25' L	27.5625 ft		2
38	2	EA	140371	GRIP CHUTE PLANK, 12X12, 25' L	27.5625 ft		2
39	2	EA	140372	GRIP CHUTE PLANK, 12X12, 25' L	27.5625 ft		2
40	2	EA	140373	GRIP CHUTE PLANK, 12X12, 25' L	27.5625 ft		2
41	2	EA	140374	GRIP CHUTE PLANK, 12X12, 25' L	27.5625 ft		2
42	2	EA	140375	GRIP CHUTE PLANK, 12X12, 25' L	27.5625 ft		2
43	2	EA	140376	GRIP CHUTE PLANK, 12X12, 25' L	27.5625 ft		2
44	2	EA	140377	GRIP CHUTE PLANK, 12X12, 25' L	27.5625 ft		2
45	2	EA	140378	GRIP CHUTE PLANK, 12X12, 25' L	27.5625 ft		2
46	2	EA	140379	GRIP CHUTE PLANK, 12X12, 25' L	27.5625 ft		2
47	2	EA	140380	GRIP CHUTE PLANK, 12X12, 25' L	27.5625 ft		2
48	2	EA	140381	GRIP CHUTE PLANK, 12X12, 25' L	27.5625 ft		2
49	2	EA	140382	GRIP CHUTE PLANK, 12X12, 25' L	27.5625 ft		2
50	2	EA	140383	GRIP CHUTE PLANK, 12X12, 25' L	27.5625 ft		2
51	2	EA	140384	GRIP CHUTE PLANK, 12X12, 25' L	27.5625 ft		2
52	2	EA	140385	GRIP CHUTE PLANK, 12X12, 25' L	27.5625 ft		2
53	2	EA	140386	GRIP CHUTE PLANK, 12X12, 25' L	27.5625 ft		2
54	2	EA	140387	GRIP CHUTE PLANK, 12X12, 25' L	27.5625 ft		2
55	2	EA	140388	GRIP CHUTE PLANK, 12X12, 25' L	27.5625 ft		2

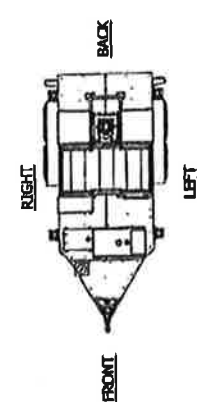

STRUCTURAL LAYOUT

ENGINEER: SGA

THIS DRAWING IS THE CONFIDENTIAL PROPERTY AND CONTAINS TRADE SECRETS OF CELLXION, LLC. ANY USE OF THESE DRAWINGS OR THE INFORMATION CONTAINED HEREIN FOR ANY PERSON OTHER THAN AS EXPRESSLY AUTHORIZED BY CELLXION, LLC IS STRICTLY PROHIBITED. THIS DRAWING HAS BEEN DISTRIBUTED WITH THE UNDERSTANDING THAT ANYONE RECEIVING OR OTHERWISE OBTAINING POSSESSION OF IT WILL BE EXPRESSLY NOTICED OF ITS CONFIDENTIAL NATURE.

**Cellxion**  
A Division of Sabre Industries, Inc.  
5031 Hazel Jones Road  
Bossier City, LA 71111  
Voice: 318-213-2910  
Fax: 318-213-2919  
www.cellxion.com

CUSTOMER:

PROJECT:  
**RCL123  
TOWER TRAILER  
OVERVIEW**

FILE NO:	RCL123-001	DATE:	
DESIGNER:	C. J. FLORES	DATE:	3/21/2017
DRAWN BY:	C. J. FLORES	DATE:	3/21/2017
CHECKED BY:	J. GORDON	DATE:	3/29/2017
ENGINEER:	J. GORDON	DATE:	3/29/2017
APPROVED BY:		DATE:	

SHEET NO.:	2 OF 12
DRAWING NO.:	RCL123

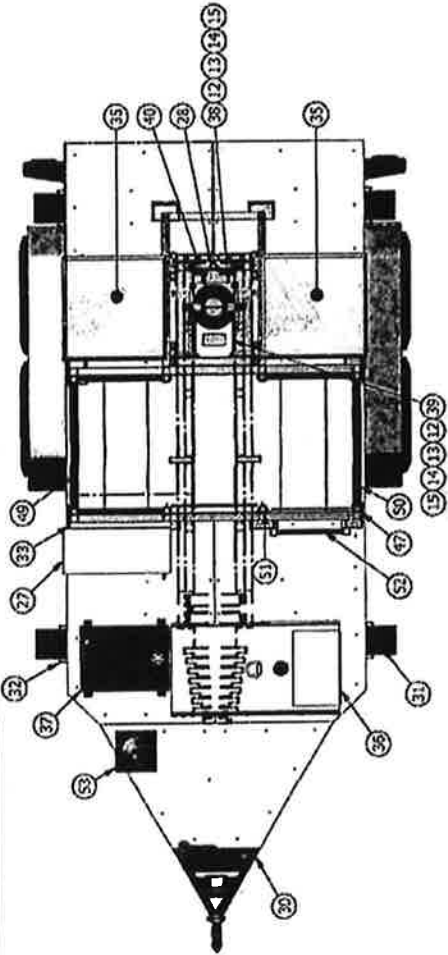

TOP VIEW  
SCALE 1:32

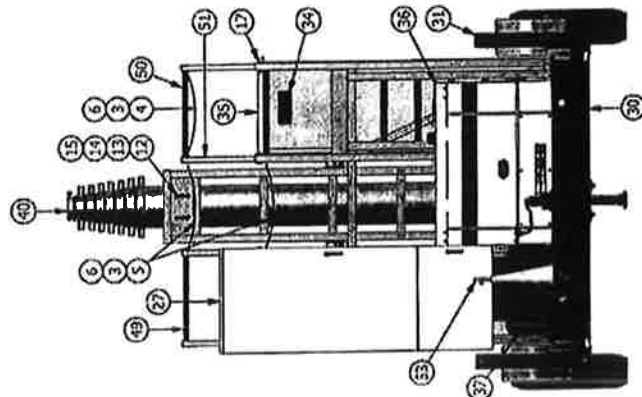

FRONT VIEW  
SCALE 1:32

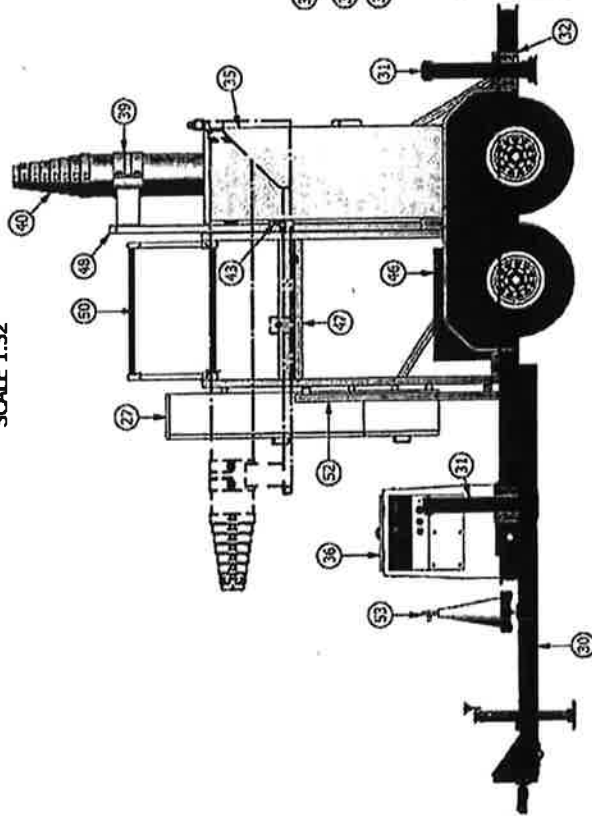

LEFT VIEW  
SCALE 1:32

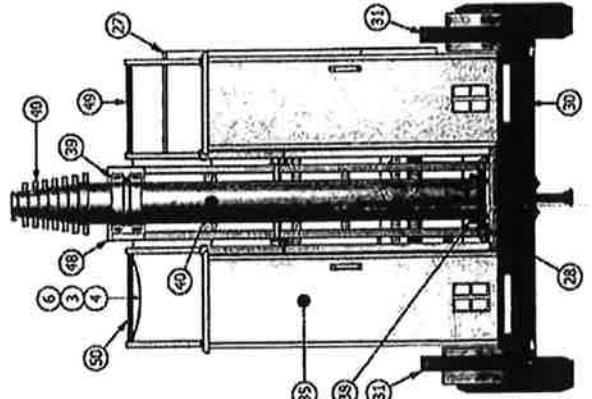

BACK VIEW  
SCALE 1:32

ENGINEER SEAL

THIS DRAWING IS THE PROPERTY OF CEILIXION, INC. ANY REUSE OR REPRODUCTION OF THIS DRAWING WITHOUT THE WRITTEN PERMISSION OF CEILIXION, INC. IS STRICTLY PROHIBITED. THIS DRAWING HAS BEEN DEVELOPED WITH THE UNDERSTANDING THAT ANYONE RECEIVING OR OTHERWISE OBTAINING POSSESSION OF IT WILL BE EXPRESSLY NOTIFIED OF ITS CONFIDENTIAL NATURE.

A Division of Sabre Industries, Inc.  
**Ceilixion**  
 5031 Hazel Jones Road  
 Bossier City, LA 71111  
 Fax: 318-213-2919  
 www.ceilixion.com

PROJECT:  
**RCL223  
 TOWER TRAILER  
 PLATFORM  
 PLACEMENT**

DATE: 1/22/2012  
 DRAWN BY: C. JAMES  
 CHECKED BY: L. LORSON  
 ENGINEER BY: R. COOPER  
 APPROVED BY: [Signature]  
 SHEET NO.: 3 OF 12  
 DRAWING NO.: RCL223

ITEM	P/N	DESCRIPTION	LENGTH	WIDTH
1	10000000	WHEEL		
2	10000000	WHEEL		
3	10000000	WHEEL		
4	10000000	WHEEL		
5	10000000	WHEEL		
6	10000000	WHEEL		
7	10000000	WHEEL		
8	10000000	WHEEL		
9	10000000	WHEEL		
10	10000000	WHEEL		
11	10000000	WHEEL		
12	10000000	WHEEL		
13	10000000	WHEEL		
14	10000000	WHEEL		
15	10000000	WHEEL		
16	10000000	WHEEL		
17	10000000	WHEEL		
18	10000000	WHEEL		
19	10000000	WHEEL		
20	10000000	WHEEL		
21	10000000	WHEEL		
22	10000000	WHEEL		
23	10000000	WHEEL		
24	10000000	WHEEL		
25	10000000	WHEEL		
26	10000000	WHEEL		
27	10000000	WHEEL		
28	10000000	WHEEL		
29	10000000	WHEEL		
30	10000000	WHEEL		
31	10000000	WHEEL		
32	10000000	WHEEL		
33	10000000	WHEEL		
34	10000000	WHEEL		
35	10000000	WHEEL		
36	10000000	WHEEL		
37	10000000	WHEEL		
38	10000000	WHEEL		
39	10000000	WHEEL		
40	10000000	WHEEL		
41	10000000	WHEEL		
42	10000000	WHEEL		
43	10000000	WHEEL		
44	10000000	WHEEL		
45	10000000	WHEEL		
46	10000000	WHEEL		
47	10000000	WHEEL		
48	10000000	WHEEL		
49	10000000	WHEEL		
50	10000000	WHEEL		
51	10000000	WHEEL		
52	10000000	WHEEL		
53	10000000	WHEEL		
54	10000000	WHEEL		
55	10000000	WHEEL		
56	10000000	WHEEL		
57	10000000	WHEEL		
58	10000000	WHEEL		
59	10000000	WHEEL		
60	10000000	WHEEL		
61	10000000	WHEEL		
62	10000000	WHEEL		
63	10000000	WHEEL		
64	10000000	WHEEL		
65	10000000	WHEEL		
66	10000000	WHEEL		
67	10000000	WHEEL		
68	10000000	WHEEL		
69	10000000	WHEEL		
70	10000000	WHEEL		
71	10000000	WHEEL		
72	10000000	WHEEL		
73	10000000	WHEEL		
74	10000000	WHEEL		
75	10000000	WHEEL		
76	10000000	WHEEL		
77	10000000	WHEEL		
78	10000000	WHEEL		
79	10000000	WHEEL		
80	10000000	WHEEL		
81	10000000	WHEEL		
82	10000000	WHEEL		
83	10000000	WHEEL		
84	10000000	WHEEL		
85	10000000	WHEEL		
86	10000000	WHEEL		
87	10000000	WHEEL		
88	10000000	WHEEL		
89	10000000	WHEEL		
90	10000000	WHEEL		
91	10000000	WHEEL		
92	10000000	WHEEL		
93	10000000	WHEEL		
94	10000000	WHEEL		
95	10000000	WHEEL		
96	10000000	WHEEL		
97	10000000	WHEEL		
98	10000000	WHEEL		
99	10000000	WHEEL		
100	10000000	WHEEL		

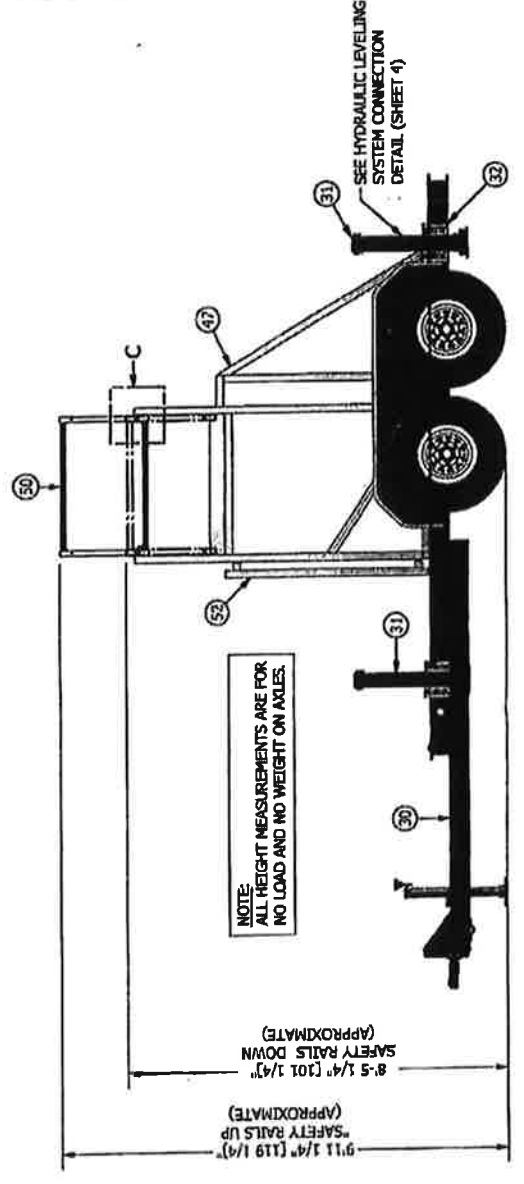
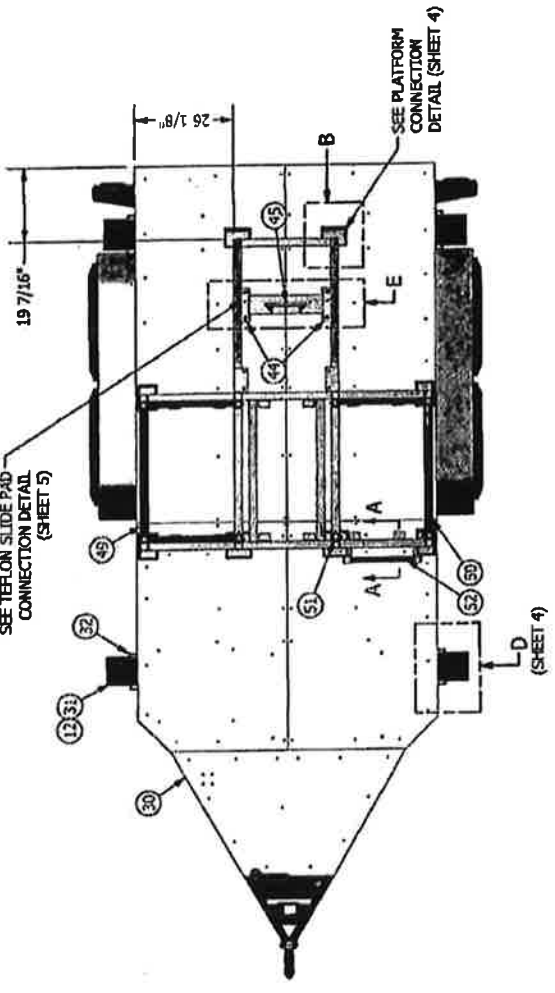

LEFT VIEW  
SCALE 1:32

SUB - PART LIST

ITEM	P/N	DESCRIPTION	LENGTH	WIDTH
1	10000000	WHEEL		
2	10000000	WHEEL		
3	10000000	WHEEL		
4	10000000	WHEEL		
5	10000000	WHEEL		
6	10000000	WHEEL		
7	10000000	WHEEL		
8	10000000	WHEEL		
9	10000000	WHEEL		
10	10000000	WHEEL		
11	10000000	WHEEL		
12	10000000	WHEEL		
13	10000000	WHEEL		
14	10000000	WHEEL		
15	10000000	WHEEL		
16	10000000	WHEEL		
17	10000000	WHEEL		
18	10000000	WHEEL		
19	10000000	WHEEL		
20	10000000	WHEEL		
21	10000000	WHEEL		
22	10000000	WHEEL		
23	10000000	WHEEL		
24	10000000	WHEEL		
25	10000000	WHEEL		
26	10000000	WHEEL		
27	10000000	WHEEL		
28	10000000	WHEEL		
29	10000000	WHEEL		
30	10000000	WHEEL		
31	10000000	WHEEL		
32	10000000	WHEEL		
33	10000000	WHEEL		
34	10000000	WHEEL		
35	10000000	WHEEL		
36	10000000	WHEEL		
37	10000000	WHEEL		
38	10000000	WHEEL		
39	10000000	WHEEL		
40	10000000	WHEEL		
41	10000000	WHEEL		
42	10000000	WHEEL		
43	10000000	WHEEL		
44	10000000	WHEEL		
45	10000000	WHEEL		
46	10000000	WHEEL		
47	10000000	WHEEL		
48	10000000	WHEEL		
49	10000000	WHEEL		
50	10000000	WHEEL		
51	10000000	WHEEL		
52	10000000	WHEEL		
53	10000000	WHEEL		
54	10000000	WHEEL		
55	10000000	WHEEL		
56	10000000	WHEEL		
57	10000000	WHEEL		
58	10000000	WHEEL		
59	10000000	WHEEL		
60	10000000	WHEEL		
61	10000000	WHEEL		
62	10000000	WHEEL		
63	10000000	WHEEL		
64	10000000	WHEEL		
65	10000000	WHEEL		
66	10000000	WHEEL		
67	10000000	WHEEL		
68	10000000	WHEEL		
69	10000000	WHEEL		
70	10000000	WHEEL		
71	10000000	WHEEL		
72	10000000	WHEEL		
73	10000000	WHEEL		
74	10000000	WHEEL		
75	10000000	WHEEL		
76	10000000	WHEEL		
77	10000000	WHEEL		
78	10000000	WHEEL		
79	10000000	WHEEL		
80	10000000	WHEEL		
81	10000000	WHEEL		
82	10000000	WHEEL		
83	10000000	WHEEL		
84	10000000	WHEEL		
85	10000000	WHEEL		
86	10000000	WHEEL		
87	10000000	WHEEL		
88	10000000	WHEEL		
89	10000000	WHEEL		
90	10000000	WHEEL		
91	10000000	WHEEL		
92	10000000	WHEEL		
93	10000000	WHEEL		
94	10000000	WHEEL		
95	10000000	WHEEL		
96	10000000	WHEEL		
97	10000000	WHEEL		
98	10000000	WHEEL		
99	10000000	WHEEL		
100	10000000	WHEEL		

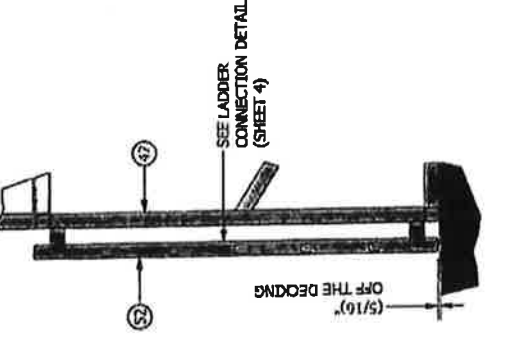

DETAIL A-A  
SCALE 1:16

ENGINEER: S&L

THIS DRAWING IS THE CONFIDENTIAL PROPERTY AND CONTAINS TRADE SECRETS OF CELLIXION, LLC. ANY USE OF THESE DRAWINGS OR THE INFORMATION CONTAINED HEREIN FOR ANY PURPOSE OTHER THAN AS EXPRESSLY AUTHORIZED BY CELLIXION, LLC IS STRICTLY PROHIBITED. THIS DRAWING HAS BEEN DISTRIBUTED WITH THE UNDERSTANDING THAT ANYONE RECEIVING OR OTHERWISE OBTAINING POSSESSION OF IT WILL BE EXPRESSLY NOTIFIED OF ITS CONFIDENTIAL NATURE.

**Cellixion**  
A Division of Sphre Industries, Inc.  
5031 Hazel Jones Road  
Bossier City, LA 71111  
Voice: 318-213-2900  
Fax: 318-213-2919  
www.cellixion.com

DATE:

PROJECT:  
**RC123**  
TOWER TRAILER  
PLATFORM  
CONNECTION DETAILS

PLANNING:	RC12321-0-0	DATE:	
DRAWN BY:	J.P.F.	DATE:	2/22/2012
CHECKED BY:	J.P.F.	DATE:	2/22/2012
DESIGNED BY:	J. LONROY	DATE:	2/22/2012
BY COMPANY:	R. COOPER	DATE:	2/22/2012
APPROVED BY:		DATE:	

SHEET NO.:  
**1 OF 12**  
DRAWING NO.:  
**RC123**

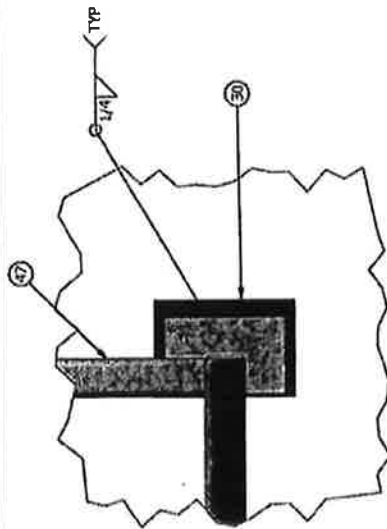

**DETAIL B**  
PLATFORM CONNECTION DETAIL  
SCALE 1:6

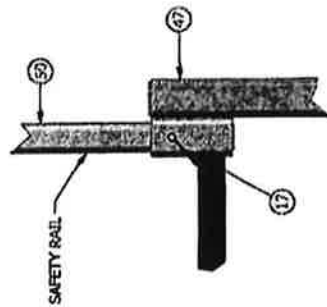

**DETAIL C**  
SAFETY PIN DETAIL  
SCALE 1:6

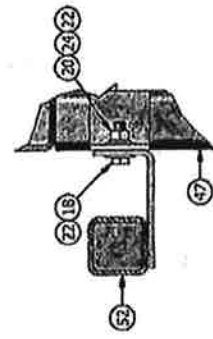

**LADDER CONNECTION DETAIL**  
SCALE 1:4

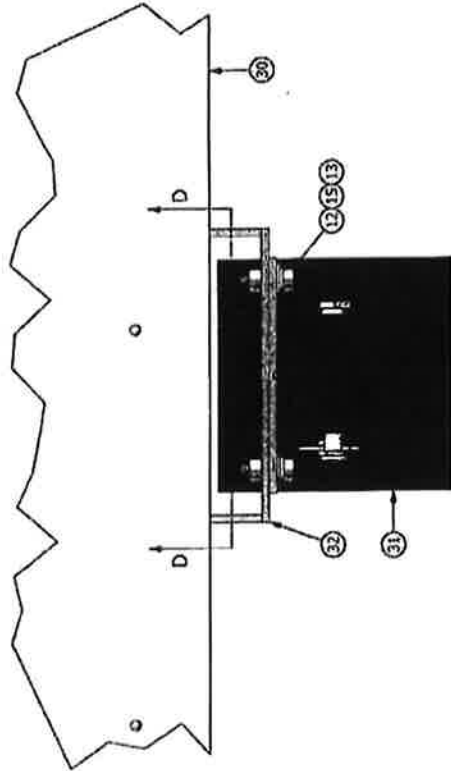

**DETAIL D**  
SCALE 1:4

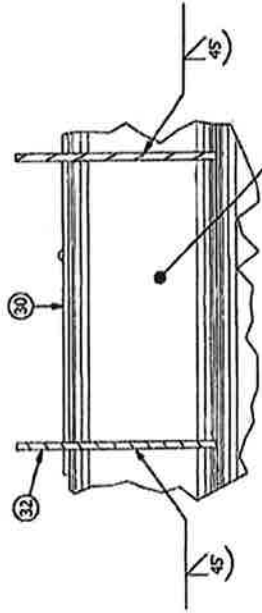

**SECTION D-D**  
SCALE 1:4

PREPARE SURFACE BEFORE WELDING

ENGINEER SEAL

THIS DRAWING IS THE CONFIDENTIAL PROPERTY AND CONTAINS TRADE SECRETS OF CELIXION, LLC. ANY USE OF THESE DRAWINGS OR THE INFORMATION CONTAINED HEREIN FOR ANY REASON OTHER THAN AS EXPRESSLY AUTHORIZED BY CELIXION, LLC IS STRICTLY PROHIBITED. THIS DRAWING HAS BEEN DISTRIBUTED WITH THE UNDERSTANDING THAT ANYONE RECEIVING OR OTHERWISE OBTAINING POSSESSION OF IT WILL BE DEEMED TO HAVE RECEIVED IT AS CONFIDENTIAL AND NOT TO BE DISCLOSED TO ANY OTHER PARTY.

**Celixion**  
A Division of Sabre Industries, Inc.  
5031 Hazel Jones Road  
Bossier City, LA 71111  
Voice: 318-213-2900  
Fax: 318-213-2919  
www.celixion.com

CUSTOMER:

PROJECT:  
**ACX23**  
TOWER TRAILER  
TEFLON SLIDE BLOCK  
PLACEMENT / CONN DETAILS

DESIGN BY:	DATE:
CHECKED BY:	DATE:
APPROVED BY:	DATE:
SHEET NO.:	5 OF 12
DRAWING NO.:	ACX23
REV:	

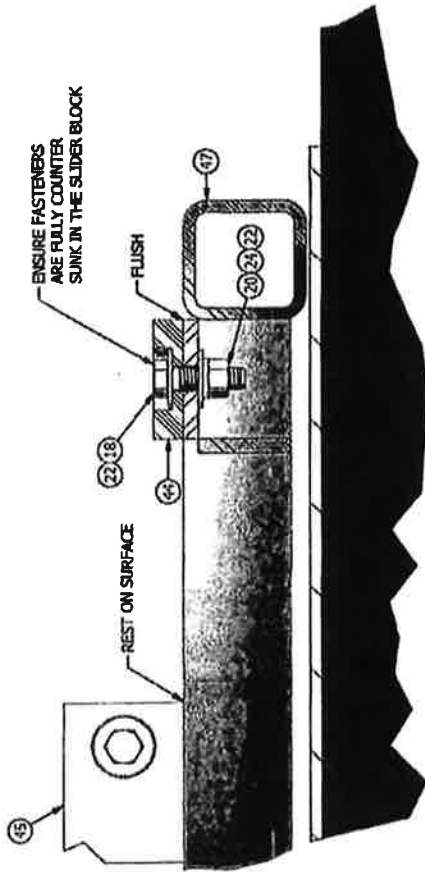

SECTION E-E  
TYPICAL TEFLON SLIDE BLOCK CONNECTION DETAIL  
SCALE 1:2

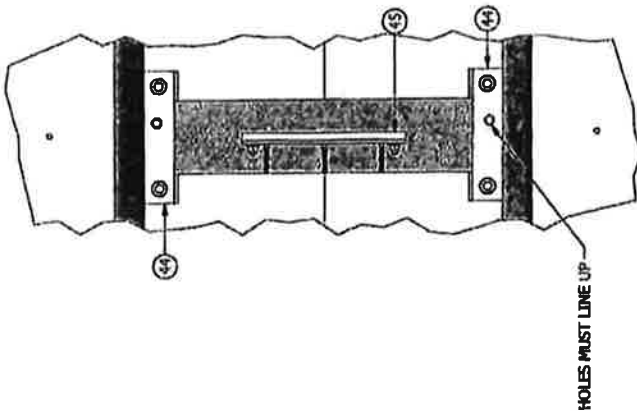

DETAIL E  
"CONTD" FROM SHEET 3"  
SCALE 1:8

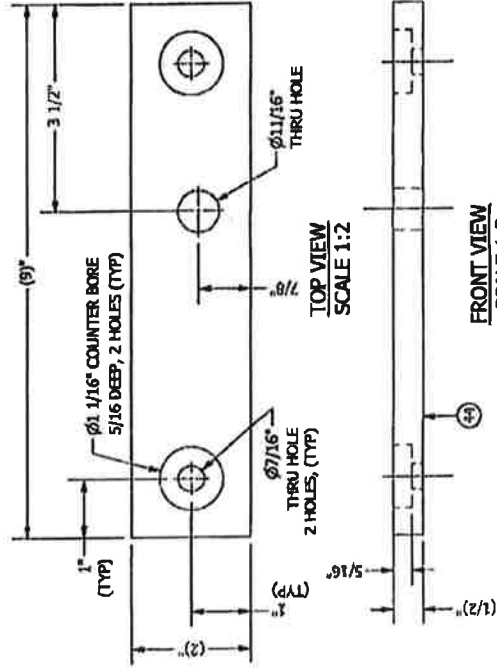

TOP VIEW  
SCALE 1:2

FRONT VIEW  
SCALE 1:2

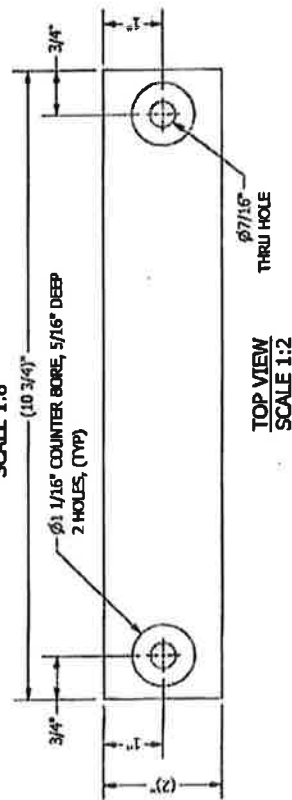

TOP VIEW  
SCALE 1:2

ENGINEER'S SEAL

THIS DRAWING IS THE CONFIDENTIAL PROPERTY AND CONTAINS TRADE SECRETS OF CEXILION, LLC. ANY USE OF THESE DRAWINGS OR THE INFORMATION CONTAINED HEREIN FOR ANY PERSON OTHER THAN AS EXPRESSLY AUTHORIZED BY CEXILION, LLC IS STRICTLY PROHIBITED. THIS DRAWING HAS BEEN DISTRIBUTED WITH THE UNDERSTANDING THAT ANYONE RECEIVING OR OTHERWISE OBTAINING POSSESSION OF IT WILL BE EXPRESSLY NOTIFIED OF ITS CONFIDENTIAL NATURE.

**CEXILION**  
 A Division of Sabre Industries, Inc.  
 5031 Hazel Jones Road  
 Bossier City, LA 71111  
 Voice: 318-213-2900  
 Fax: 318-213-2919  
 www.cexilion.com

CUSTOMER

PROJECT:  
**RCJX23**  
**TOWER TRAILER**  
**GRIP STRUT**  
**PLACEMENT / CONN DETAILS**

RELEASED:	DATE:
RCJX23/04/07	2/22/2012
ISSUED BY:	DATE:
C. LYLES	2/28/2012
DRAWN BY:	DATE:
C. LYLES	2/28/2012
CHECKED BY:	DATE:
L. LORRDON	2/28/2012
ENGINEERED BY:	DATE:
A. COOPER	2/28/2012
APPROVED BY:	DATE:
SHEET NO.:	6 OF 12
DRAWING NO.:	RCJX23

ITEM	P/N	DESCRIPTION	LENGTH	WIDTH
1	24024	GRIP STRUT PLANK 1x4x107 1/2" X 2"	37.000" P	
2	24025	GRIP STRUT PLANK 1x4x107 1/2" X 2"	37.000" P	
3	24026	GRIP STRUT PLANK 1x4x107 1/2" X 2"	37.000" P	
4	24027	GRIP STRUT PLANK 1x4x107 1/2" X 2"	37.000" P	
5	24028	GRIP STRUT PLANK 1x4x107 1/2" X 2"	37.000" P	
6	24029	GRIP STRUT PLANK 1x4x107 1/2" X 2"	37.000" P	
7	24030	GRIP STRUT PLANK 1x4x107 1/2" X 2"	37.000" P	
8	24031	GRIP STRUT PLANK 1x4x107 1/2" X 2"	37.000" P	
9	24032	GRIP STRUT PLANK 1x4x107 1/2" X 2"	37.000" P	
10	24033	GRIP STRUT PLANK 1x4x107 1/2" X 2"	37.000" P	
11	24034	GRIP STRUT PLANK 1x4x107 1/2" X 2"	37.000" P	
12	24035	GRIP STRUT PLANK 1x4x107 1/2" X 2"	37.000" P	

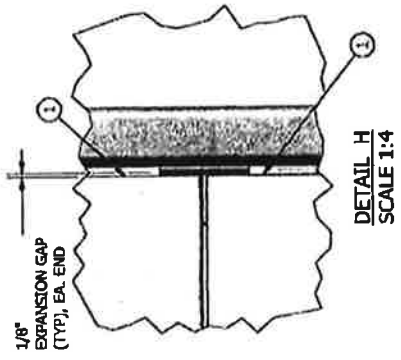
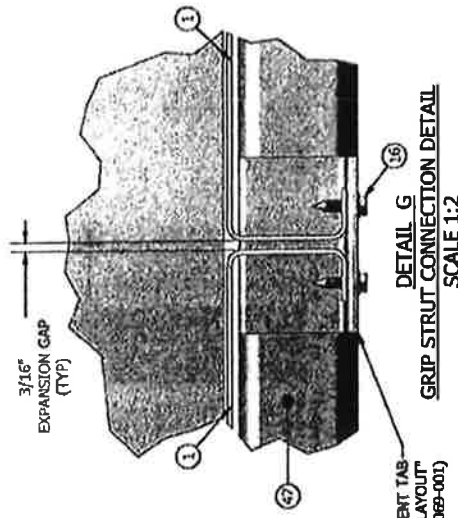
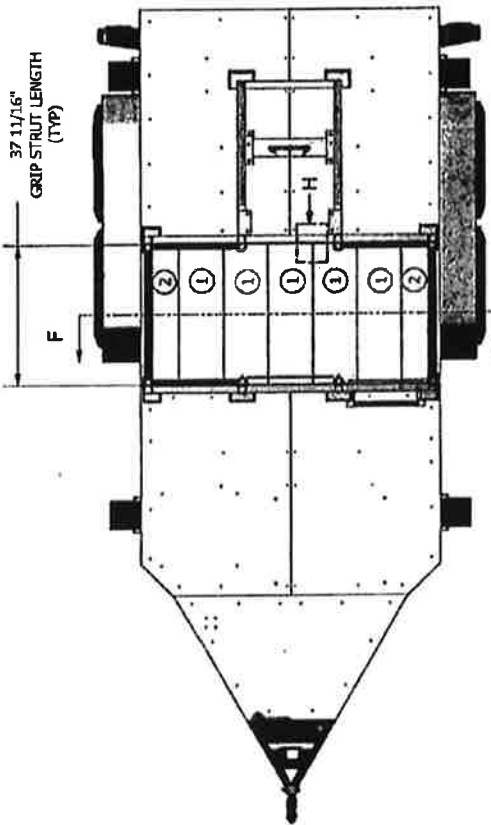
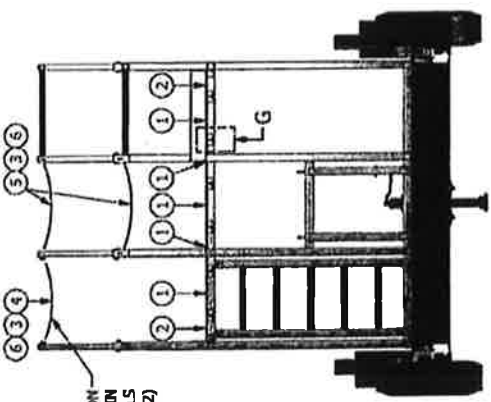

PART REPRESENTATION FOR SAFETY CHAIN ATTACHMENT DETAILS SEE (SHEET 12)

SUB - PART LIST			
ITEM	P/N	DESCRIPTION	LENGTH   WIDTH
10	1000000	WHEEL ASSEMBLY	
11	1000000	WHEEL ASSEMBLY	
12	1000000	WHEEL ASSEMBLY	
13	1000000	WHEEL ASSEMBLY	
14	1000000	WHEEL ASSEMBLY	
15	1000000	WHEEL ASSEMBLY	
16	1000000	WHEEL ASSEMBLY	
17	1000000	WHEEL ASSEMBLY	
18	1000000	WHEEL ASSEMBLY	
19	1000000	WHEEL ASSEMBLY	
20	1000000	WHEEL ASSEMBLY	
21	1000000	WHEEL ASSEMBLY	
22	1000000	WHEEL ASSEMBLY	
23	1000000	WHEEL ASSEMBLY	
24	1000000	WHEEL ASSEMBLY	
25	1000000	WHEEL ASSEMBLY	
26	1000000	WHEEL ASSEMBLY	
27	1000000	WHEEL ASSEMBLY	
28	1000000	WHEEL ASSEMBLY	
29	1000000	WHEEL ASSEMBLY	
30	1000000	WHEEL ASSEMBLY	
31	1000000	WHEEL ASSEMBLY	
32	1000000	WHEEL ASSEMBLY	
33	1000000	WHEEL ASSEMBLY	
34	1000000	WHEEL ASSEMBLY	
35	1000000	WHEEL ASSEMBLY	
36	1000000	WHEEL ASSEMBLY	
37	1000000	WHEEL ASSEMBLY	
38	1000000	WHEEL ASSEMBLY	
39	1000000	WHEEL ASSEMBLY	
40	1000000	WHEEL ASSEMBLY	
41	1000000	WHEEL ASSEMBLY	
42	1000000	WHEEL ASSEMBLY	
43	1000000	WHEEL ASSEMBLY	
44	1000000	WHEEL ASSEMBLY	
45	1000000	WHEEL ASSEMBLY	
46	1000000	WHEEL ASSEMBLY	
47	1000000	WHEEL ASSEMBLY	
48	1000000	WHEEL ASSEMBLY	
49	1000000	WHEEL ASSEMBLY	
50	1000000	WHEEL ASSEMBLY	

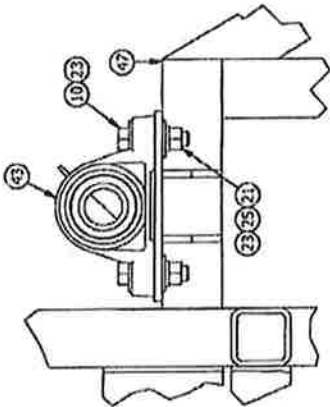

**PILLOW BLOCK CONNECTION DETAIL**  
SCALE 1:4

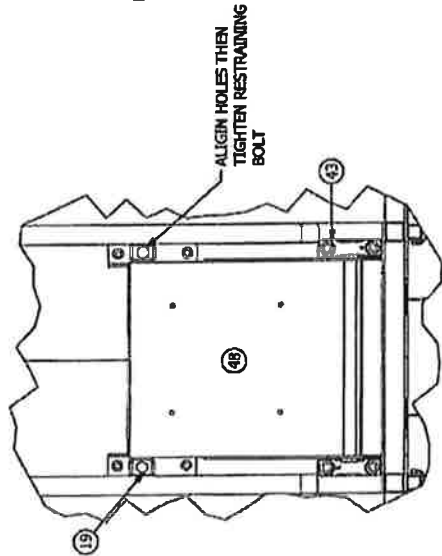

**CRADLE - TOP VIEW**  
SCALE 1:12

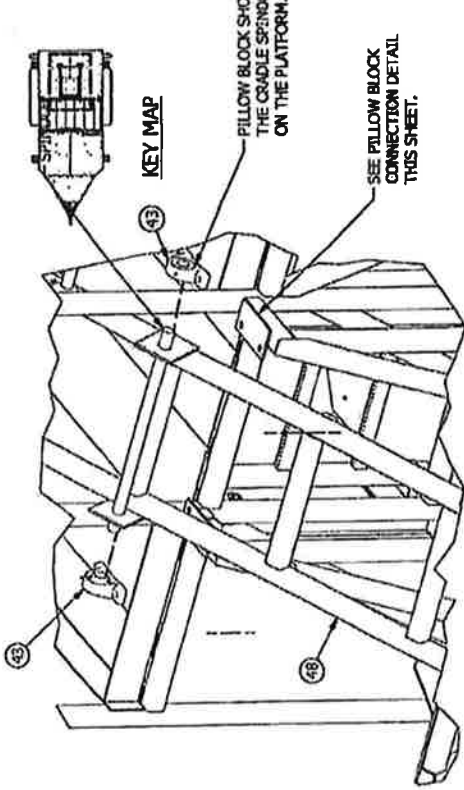

**CRADLE PLACEMENT DETAIL**  
ISOMETRIC VIEW

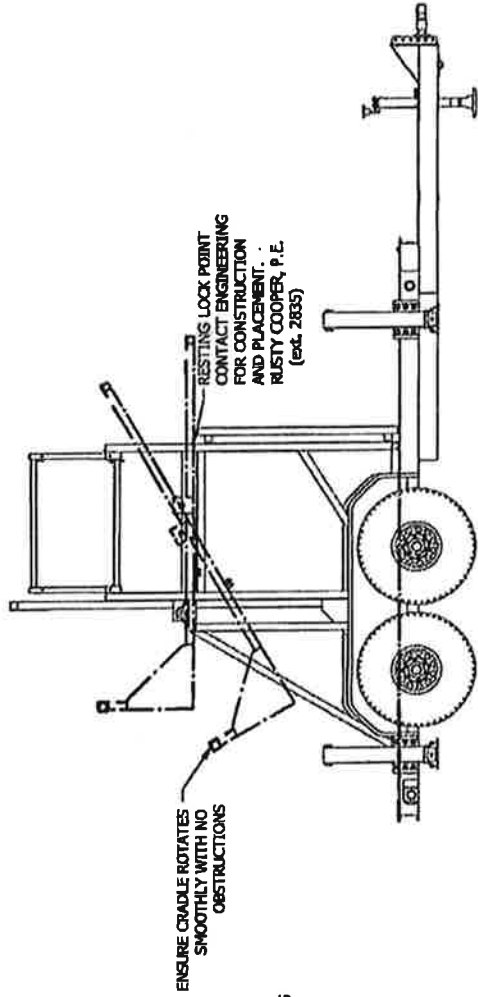

**RIGHT SIDE VIEW**  
SCALE 1:32

ENGINEER: SGA

THIS DRAWING IS THE PROPERTY OF CEILIXION, LLC. IT IS TO BE USED ONLY FOR THE PROJECT AND LOCATION SPECIFICALLY IDENTIFIED HEREIN. NO PART OF THIS DRAWING IS TO BE REPRODUCED OR TRANSMITTED IN ANY FORM OR BY ANY MEANS, ELECTRONIC OR MECHANICAL, INCLUDING PHOTOCOPYING, RECORDING, OR BY ANY INFORMATION STORAGE AND RETRIEVAL SYSTEM, WITHOUT THE EXPRESS WRITTEN PERMISSION OF CEILIXION, LLC. ANY REPRODUCTION OR TRANSMISSION OF THIS DRAWING WITHOUT THE EXPRESS WRITTEN PERMISSION OF CEILIXION, LLC IS STRICTLY PROHIBITED. THIS DRAWING HAS BEEN DISTRIBUTED WITH THE UNDERSTANDING THAT ANY REPRODUCTION OR TRANSMISSION OF IT WILL BE AT THE USER'S SOLE RISK AND WITHOUT OBTAINING PERMISSION OF CEILIXION, LLC. CEILIXION, LLC IS NOT RESPONSIBLE FOR ANY DAMAGE TO PERSONS OR PROPERTY CAUSED BY THE USE OF THIS DRAWING.

**Ceilixon**  
A Division of Sabre Industries, Inc.  
5031 Hazel Jones Road  
Bossier City, LA 70111  
Voice: 318-213-2900  
Fax: 318-213-2919  
www.ceilixon.com

CUSTOMER:

PROJECT:  
**ROCKY MOUNTAIN  
TOWER TRAILER  
MAST CRADLE  
PLACEMENT / CONN DETAILS**

RESPONSE:	DATE:
ADJUSTED:	3/23/2012
DESIGN:	DATE:
CHECKED BY:	3/26/2012
DESIGNED BY:	DATE:
ENGINEERED BY:	3/26/2012
APPROVED BY:	DATE:
APPROVED BY:	DATE:

SHEET NO.:	7 OF 12
DRAWING NO.:	ROCKY29
REV:	

SUB - PART LIST			
ITEM#	P/N	DESCRIPTION	LENGTH WIDTH
12	44626	WHEEL 1/2" X 1/2" 10T - STAINLESS STEEL	
13	44626	WHEELS 1/2" X 1/2" 10T - STAINLESS STEEL	
14	44626	WHEELS 1/2" X 1/2" 10T - STAINLESS STEEL	
15	44626	WHEELS 1/2" X 1/2" 10T - STAINLESS STEEL	
16	44626	WHEELS 1/2" X 1/2" 10T - STAINLESS STEEL	
17	44626	WHEELS 1/2" X 1/2" 10T - STAINLESS STEEL	
18	44626	WHEELS 1/2" X 1/2" 10T - STAINLESS STEEL	
19	44626	WHEELS 1/2" X 1/2" 10T - STAINLESS STEEL	
20	44626	WHEELS 1/2" X 1/2" 10T - STAINLESS STEEL	
21	44626	WHEELS 1/2" X 1/2" 10T - STAINLESS STEEL	
22	44626	WHEELS 1/2" X 1/2" 10T - STAINLESS STEEL	
23	44626	WHEELS 1/2" X 1/2" 10T - STAINLESS STEEL	
24	44626	WHEELS 1/2" X 1/2" 10T - STAINLESS STEEL	
25	44626	WHEELS 1/2" X 1/2" 10T - STAINLESS STEEL	
26	44626	WHEELS 1/2" X 1/2" 10T - STAINLESS STEEL	
27	44626	WHEELS 1/2" X 1/2" 10T - STAINLESS STEEL	
28	44626	WHEELS 1/2" X 1/2" 10T - STAINLESS STEEL	
29	44626	WHEELS 1/2" X 1/2" 10T - STAINLESS STEEL	
30	44626	WHEELS 1/2" X 1/2" 10T - STAINLESS STEEL	
31	44626	WHEELS 1/2" X 1/2" 10T - STAINLESS STEEL	
32	44626	WHEELS 1/2" X 1/2" 10T - STAINLESS STEEL	
33	44626	WHEELS 1/2" X 1/2" 10T - STAINLESS STEEL	
34	44626	WHEELS 1/2" X 1/2" 10T - STAINLESS STEEL	
35	44626	WHEELS 1/2" X 1/2" 10T - STAINLESS STEEL	
36	44626	WHEELS 1/2" X 1/2" 10T - STAINLESS STEEL	
37	44626	WHEELS 1/2" X 1/2" 10T - STAINLESS STEEL	
38	44626	WHEELS 1/2" X 1/2" 10T - STAINLESS STEEL	
39	44626	WHEELS 1/2" X 1/2" 10T - STAINLESS STEEL	
40	44626	WHEELS 1/2" X 1/2" 10T - STAINLESS STEEL	

- NOTES:**
1. ENSURE PILOT HOLES ON BRACKET MOUNTING PLATE ARE DRILLED FOR 1/2" BOLT AND PAINTED WITH 3 PART PAINT PROCESS. (REF PART DRAWING - 561069-002)
  2. MAST BRACKET WILL DETERMINE THE PLACEMENT OF THE MAST BASEPLATE. MOUNT MAST BRACKET THEN LEVEL MAST IN CRADLE MOUNTING PLATE AND MATCH DRILL THROUGH BASEPLATE HOLES INTO BRACKET MOUNTING PLATE. (TOUCH UP WITH 3 PART PAINT)

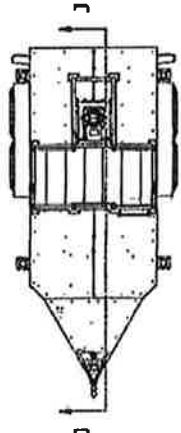

**KEY MAP**

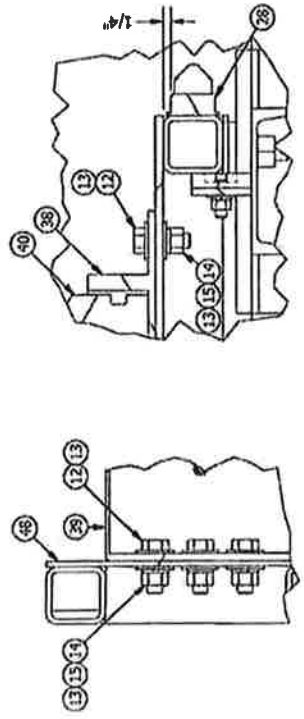

**BRACKET CONNECTION DETAIL**  
SCALE 1:4

**BASEPLATE CONNECTION DETAIL**  
SCALE 1:4

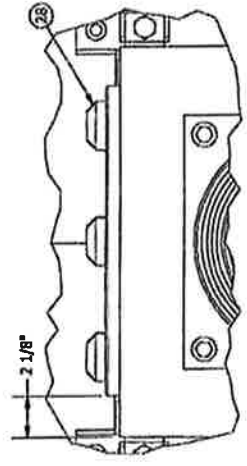

**DOTD LIGHT DETAIL**  
SCALE 1:6

**DOTD NOTE:**  
CONTACT VICTOR HASSELL (ext. 2802)  
FOR FURTHER DOTD LIGHT  
LOCATIONS

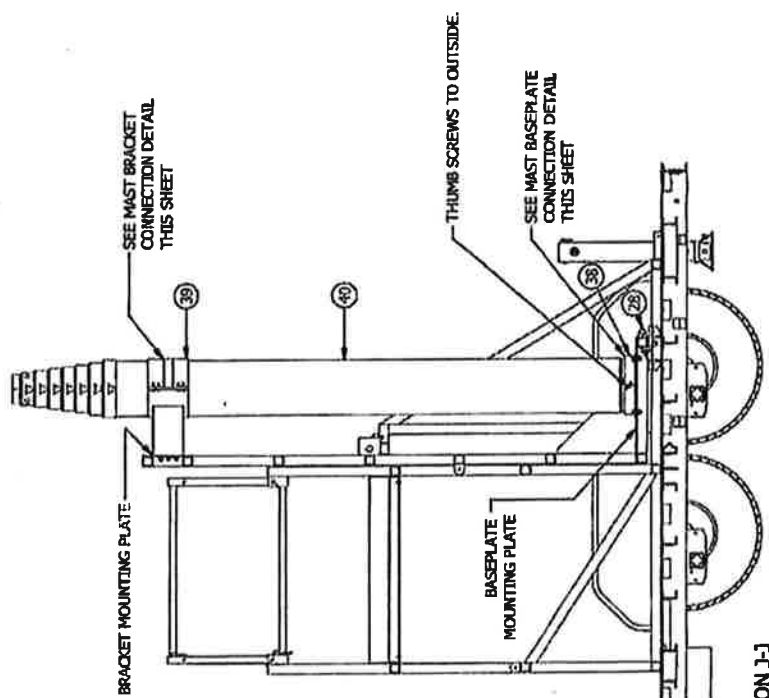

**SECTION J-1**  
**MAST PLACEMENT DETAIL**  
SCALE 1:24

<p>ENGINEER SEAL</p>	<p>THESE DRAWINGS IS THE CONFIDENTIAL PROPERTY AND CONTAINS TRADE SECRETS OF CELLUXION, LLC. ANY USE OF THESE DRAWINGS OR THE INFORMATION CONTAINED HEREIN FOR ANY REASON OTHER THAN AS EXPRESSLY AUTHORIZED BY CELLUXION, LLC IS STRICTLY PROHIBITED. THIS DRAWING HAS BEEN DISTRIBUTED WITH THE UNDERSTANDING THAT ANYONE RECEIVING OR OTHERWISE OBTAINING POSSESSION OF IT WILL BE EXPRESSLY NOTIFIED OF ITS CONFIDENTIAL NATURE.</p>	<p><b>Celluxion</b> A Division of Sabro Industries, Inc. 5031 Hazel Jones Road Bossier City, LA 71111 Voice: 318-213-2900 Fax: 318-213-2919 www.celluxion.com</p>	<p>CUSTOMER:</p> <p>PROJECT: <b>RCLX23</b> <b>TOWER TRAILER</b> <b>HEAVY DUTY MAST</b> <b>PLACEMENT / CONN DETAILS</b></p> <table border="1"> <tr> <td>DATE:</td> <td>3/23/2017</td> </tr> <tr> <td>DESIGNED BY:</td> <td>J. L. GORDON</td> </tr> <tr> <td>CHECKED BY:</td> <td>J. L. GORDON</td> </tr> <tr> <td>APPROVED BY:</td> <td>J. L. GORDON</td> </tr> <tr> <td>DATE:</td> <td>3/23/2017</td> </tr> </table>	DATE:	3/23/2017	DESIGNED BY:	J. L. GORDON	CHECKED BY:	J. L. GORDON	APPROVED BY:	J. L. GORDON	DATE:	3/23/2017
DATE:	3/23/2017												
DESIGNED BY:	J. L. GORDON												
CHECKED BY:	J. L. GORDON												
APPROVED BY:	J. L. GORDON												
DATE:	3/23/2017												
<p>SHEET NO. 8 OF 12</p> <p>DRAWING NO. RCLX23</p>		<p>DATE: 3/23/2017</p> <p>DESIGNED BY: J. L. GORDON</p> <p>CHECKED BY: J. L. GORDON</p> <p>APPROVED BY: J. L. GORDON</p>											



SUB - PART LIST			
ITEM	P/N	DESCRIPTION	WIDTH
7	100010	WASHER, 1/2" X 3/8" X 1/8" SS	
8	100011	WASHER, 1/2" X 3/8" X 1/8" SS	
9	100012	WASHER, 1/2" X 3/8" X 1/8" SS	
10	100013	WASHER, 1/2" X 3/8" X 1/8" SS	
11	100014	WASHER, 1/2" X 3/8" X 1/8" SS	
12	100015	WASHER, 1/2" X 3/8" X 1/8" SS	
13	100016	WASHER, 1/2" X 3/8" X 1/8" SS	
14	100017	WASHER, 1/2" X 3/8" X 1/8" SS	
15	100018	WASHER, 1/2" X 3/8" X 1/8" SS	
16	100019	WASHER, 1/2" X 3/8" X 1/8" SS	
17	100020	WASHER, 1/2" X 3/8" X 1/8" SS	
18	100021	WASHER, 1/2" X 3/8" X 1/8" SS	
19	100022	WASHER, 1/2" X 3/8" X 1/8" SS	
20	100023	WASHER, 1/2" X 3/8" X 1/8" SS	
21	100024	WASHER, 1/2" X 3/8" X 1/8" SS	
22	100025	WASHER, 1/2" X 3/8" X 1/8" SS	
23	100026	WASHER, 1/2" X 3/8" X 1/8" SS	
24	100027	WASHER, 1/2" X 3/8" X 1/8" SS	
25	100028	WASHER, 1/2" X 3/8" X 1/8" SS	
26	100029	WASHER, 1/2" X 3/8" X 1/8" SS	
27	100030	WASHER, 1/2" X 3/8" X 1/8" SS	

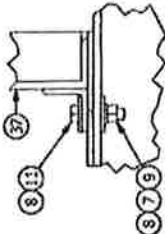

RUEL TANK CONNECTION DETAIL  
SCALE 1:4

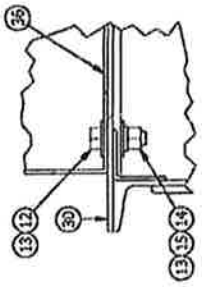

GENERATOR CONNECTION DETAIL  
SCALE 1:4

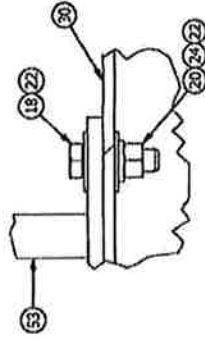

SAFETY CONE STAND CONNECTION DETAIL  
SCALE 1:2

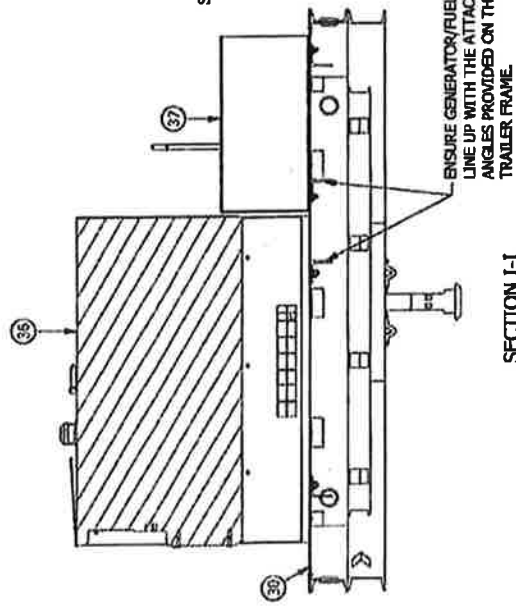

SECTION I-I  
SCALE 1:16

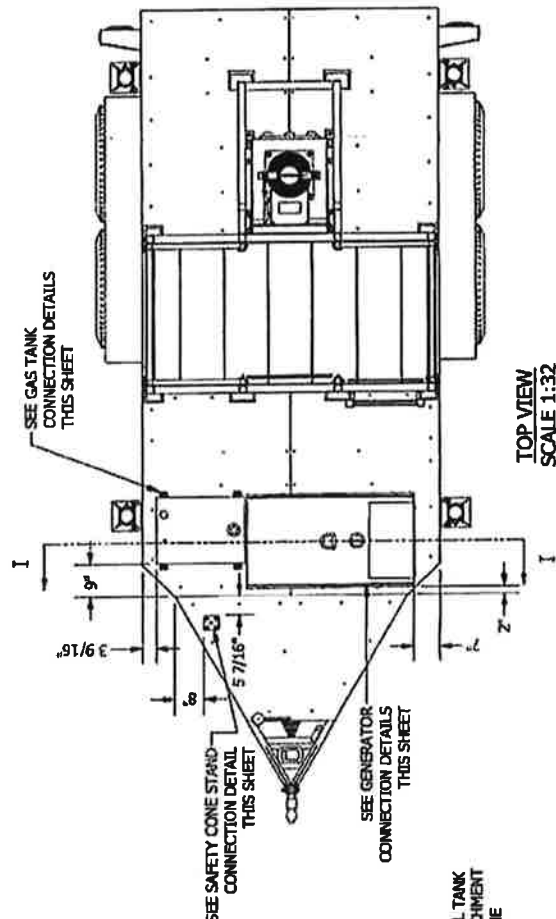

TOP VIEW  
SCALE 1:32

ENGINEER SEAL  THIS DRAWING IS THE PROPRIETARY PROPERTY AND CONTAINS TRADE SECRETS OF CELLUXION, LLC. ANY USE OF THESE DRAWINGS OR THE INFORMATION CONTAINED HEREIN FOR ANY REASON OTHER THAN AS EXPRESSLY AUTHORIZED BY CELLUXION, LLC IS STRICTLY PROHIBITED. THIS DRAWING HAS BEEN DISTRIBUTED WITH THE UNDERSTANDING THAT ANYONE RECEIVING OR OTHERWISE OBTAINING POSSESSION OF IT WILL BE DEEMED TO HAVE ACCEPTED ITS CONFIDENTIAL NATURE.		A Division of Sabre Industries, Inc. 5031 Hazel Jones Road Bossier City, LA 71111 VOICE: 318-213-2900 FAX: 318-213-2919 WWW.CELLUXION.COM	CUSTOMER:  PRODUCT: <b>RCX23</b> <b>TOWER TRAILER</b> <b>GENERATOR / FUEL TANK</b> <b>PLACEMENT / CONN DETAILS</b>	REVISION: RCX23-001 DESIGN BY: C. LYLES DRAWN BY: C. LYLES CHECKED BY: L. LADDON ENGINEERED BY: R. COOPER APPROVED BY: DATE: 02/20/12 DATE: 02/20/12 DATE: 02/20/12 DATE: 02/20/12 DATE: 02/20/12 DATE: 02/20/12 SHEET NO.: 9 OF 12 DRAWING NO.: RCX23 REV:
---	--	--	--	--

ENGINEER SEAL

THIS DRAWING IS THE CONFIDENTIAL PROPERTY AND CONTAINS TRADE SECRETS OF CELLIXION, LLC. ANY USE OF THESE DRAWINGS OR THE INFORMATION CONTAINED HEREIN FOR ANY PURPOSES OTHER THAN AS AUTHORIZED BY CELLIXION, LLC IS STRICTLY PROHIBITED. THIS DRAWING HAS BEEN DISTRIBUTED WITH THE UNDERSTANDING THAT ANY INFORMATION CONTAINED HEREIN IS THE PROPERTY OF CELLIXION, LLC AND IS NOT TO BE REPRODUCED OR TRANSMITTED IN ANY FORM OR BY ANY MEANS, ELECTRONIC OR MECHANICAL, INCLUDING PHOTOCOPYING, RECORDING, OR BY ANY INFORMATION STORAGE AND RETRIEVAL SYSTEM.

**Cellixion**  
 A Division of Sabre Industries, Inc.  
 5031 Hazel Jones Road  
 Bossier City, LA 71111  
 Voice: 318-213-2900  
 Fax: 318-213-2919  
 www.cellixion.com

DATE: 2/22/2012  
 DESIGNED BY: C. LYLES  
 DRAWN BY: C. LYLES  
 CHECKED BY: J. COOPER  
 APPROVED BY: J. COOPER  
 DATE: 2/22/2012

PROJECT: ROAD TRAILER  
 TITLE: ENCLOSURE / WAVEGUIDE PLACEMENT / CONNECTION DETAILS  
 SHEET NO.: 10 OF 12  
 DRAWING NO.: RCLX23

ITEM	P/N	DESCRIPTION	LENGTH	WIDTH
1	24524-01	1/2" X 1/2" X 1/2" ISOLATOR PAD		
2	24524-02	1/2" X 1/2" X 1/2" ISOLATOR PAD		
3	24524-03	1/2" X 1/2" X 1/2" ISOLATOR PAD		
4	24524-04	1/2" X 1/2" X 1/2" ISOLATOR PAD		
5	24524-05	1/2" X 1/2" X 1/2" ISOLATOR PAD		
6	24524-06	1/2" X 1/2" X 1/2" ISOLATOR PAD		
7	24524-07	1/2" X 1/2" X 1/2" ISOLATOR PAD		
8	24524-08	1/2" X 1/2" X 1/2" ISOLATOR PAD		
9	24524-09	1/2" X 1/2" X 1/2" ISOLATOR PAD		
10	24524-10	1/2" X 1/2" X 1/2" ISOLATOR PAD		

- NOTES:  
 1. ALTERNATE WAVEGUIDE POSITION MUST BE APPROVED PRIOR TO INSTALLATION.  
 2. ENCLOSURES MUST BE PLACED ON 1/8" THICK RUBBER ISOLATOR PADS.

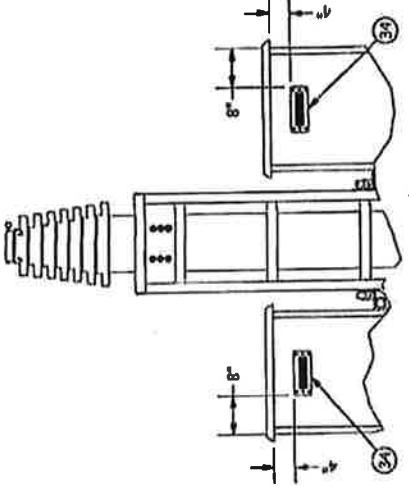

EQUIPMENT ENCLOSURE CONNECTION DETAIL  
 SCALE 1:2

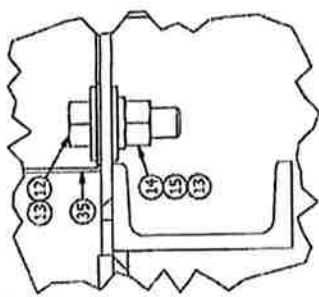

SECTION K-K  
 SCALE 1:24

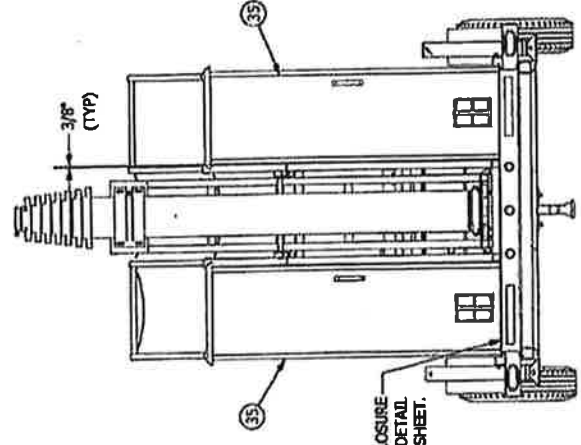

BACK VIEW  
 SCALE 1:32

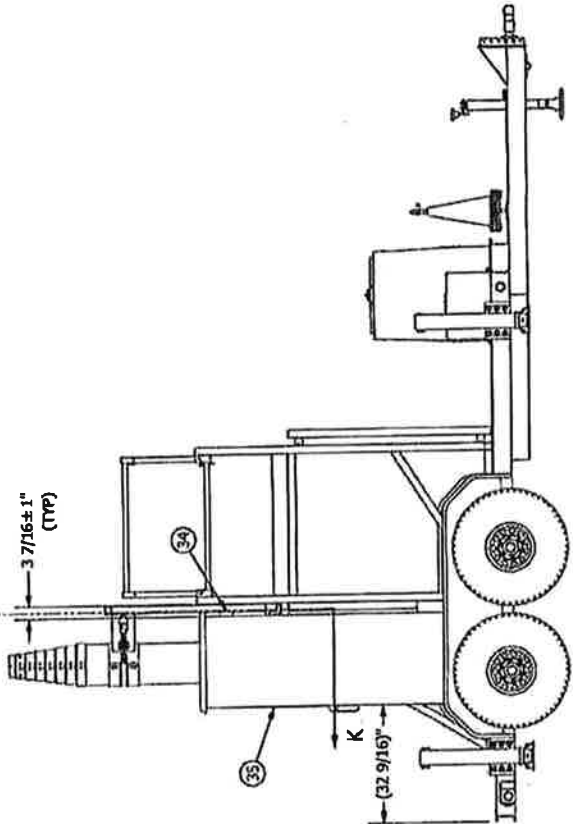

RIGHT SIDE VIEW  
 SCALE 1:32

SEE EQUIPMENT ENCLOSURE CONNECTION DETAIL THIS SHEET.

SUB - PART LIST				
ITEM	P/N	DESCRIPTION	LENGTH	WIDTH
1	50020	COVER PANEL FOR 200A, 200B, 200C, 200D	27.125"	
2	50021	COVER PANEL FOR 200E, 200F, 200G, 200H	27.125"	
3	50022	COVER PANEL FOR 200I, 200J, 200K, 200L	27.125"	

USE SAME CONNECTION DETAIL AS EQUIPMENT ENCLASURES. SEE (SHEET 10)

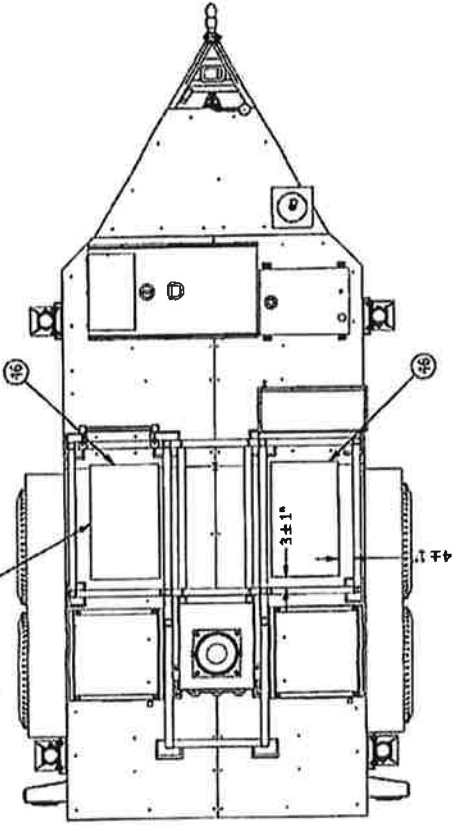

SECTION L-L  
SCALE 1:32

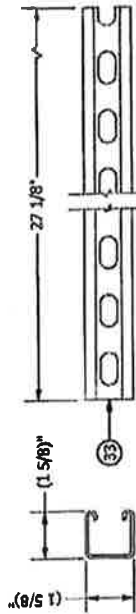

FRONT VIEW  
SCALE 1:4

LEFT PROFILE VIEW  
SCALE 1:4

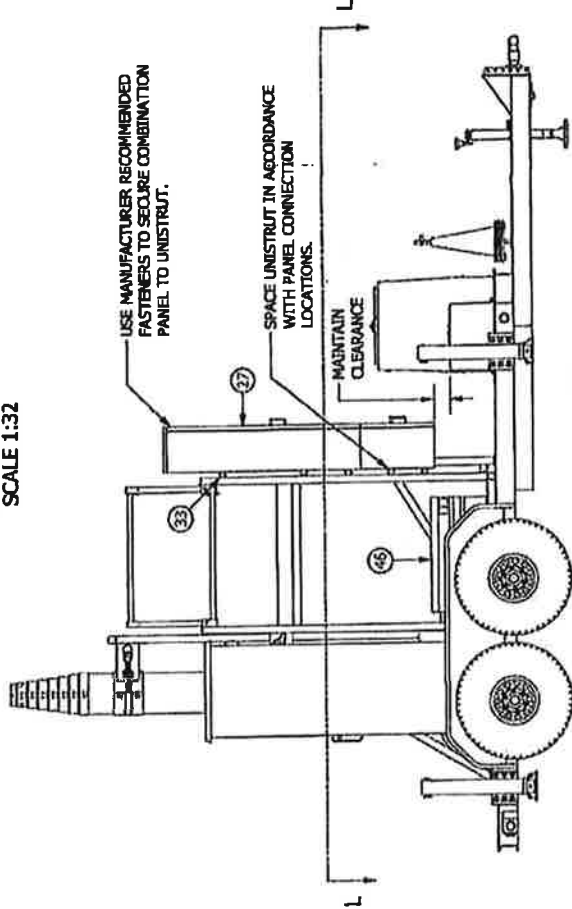

RIGHT SIDE VIEW  
SCALE 1:32

ENGINEER SEAL

THIS DRAWING IS THE CONFIDENTIAL PROPERTY AND CONTAINS THE TRADE SECRETS OF CELLXION. NO REPRODUCTION OR DISSEMINATION OF THIS INFORMATION IS PERMITTED WITHOUT THE WRITTEN PERMISSION OF CELLXION. ANY REPRODUCTION OR DISSEMINATION OF THIS INFORMATION TO ANY OTHER PARTY IS EXPRESSLY PROHIBITED. THIS DRAWING HAS BEEN DISTRIBUTED WITH THE UNDERSTANDING THAT ANYONE RECEIVING OR OTHERWISE OBTAINING POSSESSION OF IT WILL BE DEEMED TO HAVE ACCEPTED ITS CONFIDENTIAL NATURE.

**Cellxion**  
A Division of Sabre Industries, Inc.  
5031 Hazel Jones Road  
Bossier City, LA 71111  
Voice: 318-213-2900  
Fax: 318-213-2919  
www.cellxion.com

CUSTOMER

PROJECT:  
RCLX23  
TOWER TRAILER  
SITE BOX / COMBO PANEL  
PLACEMENT / CONN DETAILS

RELEASE	DATE
REVISED BY	2/22/2012
DESIGNED BY	2/22/2012
CHECKED BY	2/22/2012
ENGINEERED BY	2/22/2012
APPROVED BY	2/22/2012

SHEET NO.:  
11 OF 12  
DRAWING NO.:  
RCLX23

ENGINEER SEAL

THIS DRAWING IS THE CONFIDENTIAL PROPERTY AND CONTAINS TRADE SECRETS OF CELLXION, LLC. ANY USE OF THESE DRAWINGS FOR ANY PURPOSES OTHER THAN AS EXPRESSLY AUTHORIZED BY CELLXION, LLC IS STRICTLY PROHIBITED. THE INFORMATION IS TO BE SHARED ONLY WITH THE PERSONS WHOSE NAMES ARE SPECIFICALLY LISTED ON THIS DRAWING. ANY DISCLOSURE OF THIS INFORMATION TO ANY OTHER PERSON WITHOUT THE EXPRESS WRITTEN PERMISSION OF CELLXION, LLC IS EXPRESSLY PROHIBITED. IT SHALL BE CONSIDERED CONFIDENTIAL AND NOT BE REPRODUCED OR TRANSMITTED IN ANY FORM OR BY ANY MEANS, ELECTRONIC OR MECHANICAL, INCLUDING PHOTOCOPYING, RECORDING, OR BY ANY INFORMATION STORAGE AND RETRIEVAL SYSTEM.

**Cellxion**  
A Division of Sabre Industries, Inc.  
5031 Hazel Jones Road  
Bossier City, LA 71111  
Voice: 318-213-2900  
Fax: 318-213-2919  
www.cellxion.com

CUSTOMER:

PROJECT:  
RCL223  
TOWER TOWER  
SAFETY CHAIN  
ATTACHMENT DETAIL

FILENAME	DATE
RCL223.dwg	2/25/2017
DESIGNER	C.L.H.
CHECKED	C.L.H.
DATE	2/25/2017
APPROVED BY	J. COLLIER
DATE	2/25/2017

SHEET NO.	12 OF 12
DRAWING NO.	RCL223
REV.	

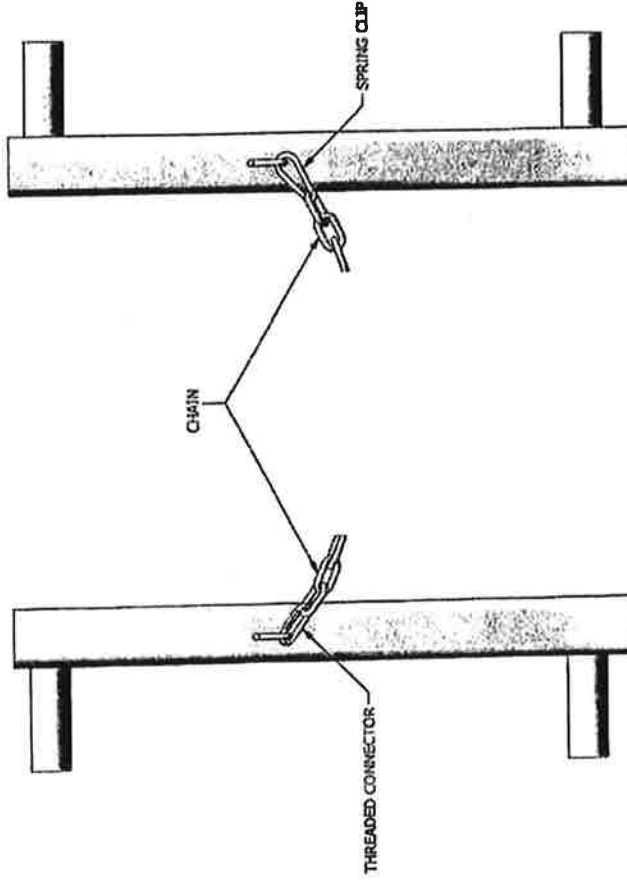

TYPICAL CHAIN ATTACHMENT DETAIL

# **ATTACHMENT 4**

General Power Density

Site Name: CROMWELL TPC CROW CT  
 Cumulative Power Density

Operator	Operating Frequency (MHz)	Number of Trans.	ERP Per Trans. (watts)	Total ERP (watts)	Distance to Target (feet)	Calculated Power Density (mW/cm <sup>2</sup> )	Maximum Permissible Exposure* (mW/cm <sup>2</sup> )	Fraction of MPE (%)
VZW 700	746	1	273	273	30	0.1092	0.4973	21.96%
VZW Cellular	869	1	296	296	30	0.1182	0.5793	20.40%
VZW PCS	1970	1	521	521	30	0.2080	1.0000	20.80%
<b>Total Percentage of Maximum Permissible Exposure</b>								<b>63.15%</b>

\*Guidelines adopted by the FCC on August 1, 1996, 47 CFR Part 1 based on NCRP Report 86, 1986 and generally on ANSI/IEEE C95.1-1992

MHz = Megahertz  
 mW/cm<sup>2</sup> = milliwatts per square centimeter  
 ERP = Effective Radiated Power

Absolute worst case maximum values used.

# **ATTACHMENT 5**

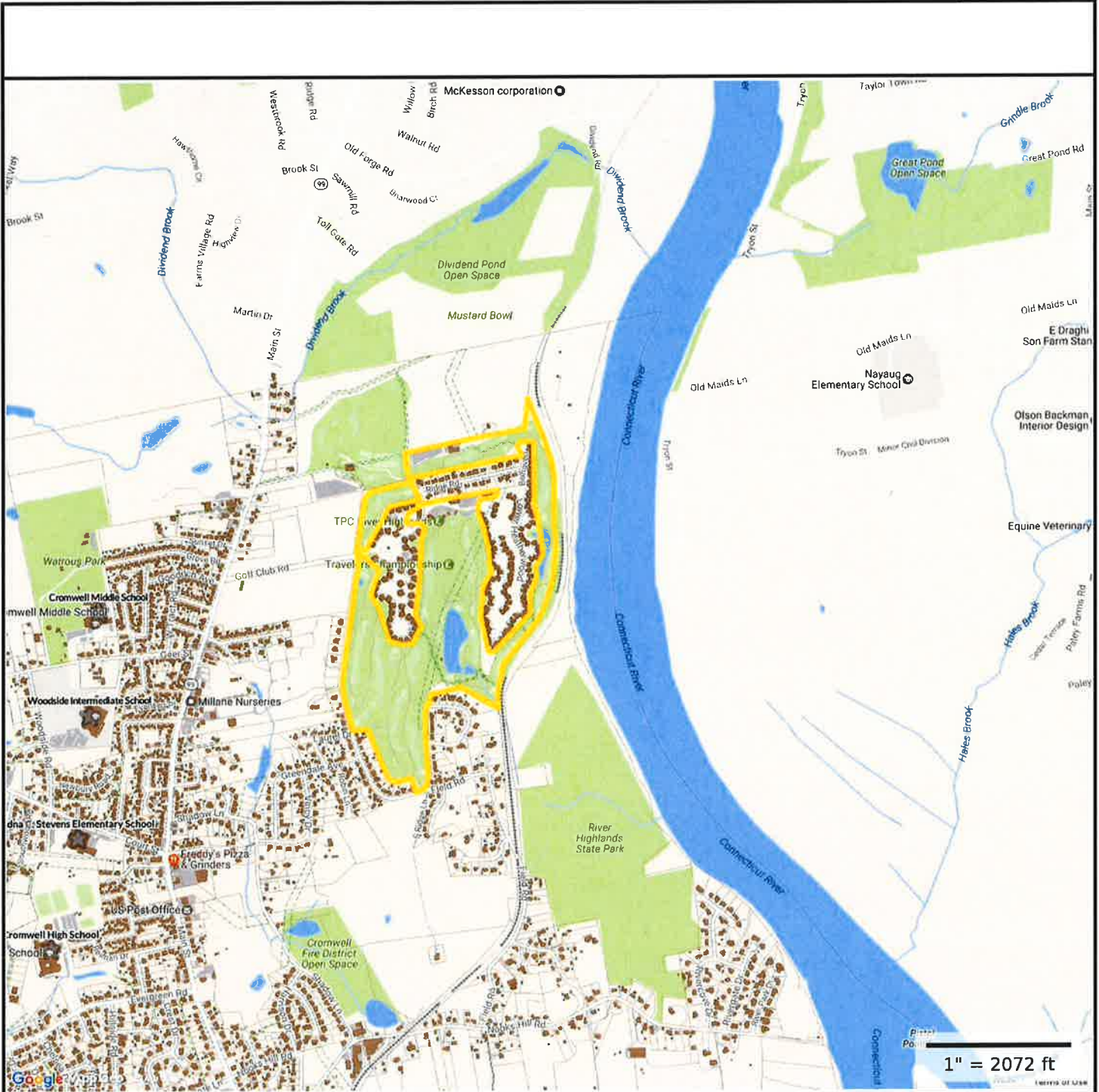

**Property Information**

**Property ID** 00457800  
**Location** 100 GOLF CLUB ROAD  
**Owner** TOURNAMENT PLAYERS CLUB OF CT INC



**MAP FOR REFERENCE ONLY  
NOT A LEGAL DOCUMENT**

Town of Cromwell, CT makes no claims and no warranties, expressed or implied, concerning the validity or accuracy of the GIS data presented on this map.

Parcels updated 10/1/2016  
Properties updated daily