



Northeast Site Solutions
Victoria Masse
420 Main St Unit 1 Box 2
Sturbridge, MA 01566
victoria@northeastsitesolutions.com

February 9, 2022

Members of the Siting Council
Connecticut Siting Council
Ten Franklin Square
New Britain, CT 06051

RE: Notice of Exempt Modification
751 Higgins Road, Cheshire CT 06410
Latitude: 41.487600
Longitude: -72.92920
T-Mobile Site#: CT11220A _NHP

Dear Ms. Bachman:

T-Mobile currently has six (6) antennas at the 212-foot level of the existing 250-foot self-support tower. The property and tower is owned by AT&T. T-Mobile now intends to add a 48Kw generator on a new concrete pad within a fenced compound.

Planned Modifications:

Ground work only-Install New:

- (1) GENERAC RD 48KW AC DIESEL GENERATOR – 229-gallon double walled self-contained tank with fuel sensor. Requires two
- (2) 12-minute run cycles bi-weekly.
- (1) 4'-6" X 10'-6"

This facility was approved by the Town of Cheshire –on July 10, 1967. The approval did not come with conditions. Please see attached original approval.

Please accept this letter as notification pursuant to Regulations of Connecticut State Agencies § 16-50j-73, for construction that constitutes an exempt modification pursuant to R.C.S.A. § 16-50j-72(b)(2). In accordance with R.S.C.A. § 16-50j-73, a copy of this letter is being sent to Sean Kimball, Town Manager, and Michael Glidden, Town Planner for the Town of Cheshire, as well as the property owner and the tower owner.

The planned modifications to the facility fall squarely within those activities explicitly provided for in R.C.S.A. § 16-50j-72(b)(2).

1. The proposed modifications will not result in an increase in the height of the existing structure.
2. The proposed modifications will not require the extension of the site boundary.
3. The proposed modifications will not increase noise levels at the facility by six decibels or more, or to levels that exceed state and local criteria.
4. The operation of the replacement antennas will not increase radio frequency emissions at the facility to a level at or above the Federal Communications Commission safety standard.
5. The proposed modifications will not cause a change or alteration in the physical or environmental characteristics of the site.
6. The existing structure and its foundation can support the proposed loading.

For the foregoing reasons, T-Mobile respectfully submits that the proposed modifications to the above referenced telecommunications facility constitute an exempt modification under R.C.S.A. § 16-50j-72(b)(2).

Sincerely,

Victoria Masse
Mobile: 860-306-2326
Fax: 413-521-0558
Office: 420 Main Street, Unit 2, Sturbridge MA 01566
Email: victoria@northeastitesolutions.com

Attachments

cc: Sean Kimball, Cheshire Town Manager
Town of Cheshire Town Hall
84 South Main Street,
Cheshire, CT 06410

Michael Glidden, Town Planner
Town of Cheshire Town Hall
84 South Main Street,
Cheshire, CT 06410

AT&T, property and tower owner
PO Box 7207
Bedminster, NJ 07921

Exhibit A

American Telephone & Telegraph Corp.
Higgins Road
Cheshire, Connecticut

July 10, 1967

Granted permission to erect a 250 foot J type radio transmission tower in R-2 Zone on top of underground building on Higgins Road Extension at location 169 feet from the nearest property line, with limitations.

1. Construction must be completed within 18 months.
2. Tower to be operated so as not to constitute a public nuisance.
3. Tower shall be as described at the public hearing.

Reasons for granting Tower was mention at the time the original structure was approved following public hearing. Tower is necessary for purpose of building.

Voting in Favor Beck, Byrne, Denton, Fritz, Hearing recorded between 270 & 756 of tape 1967 -,2, Side 2. (Shaw did not participate in this discussion.)

Exhibit B



Property Information

Property Location	751 HIGGINS RD
Mailing Address	P O BOX 7207 BEDMINSTER NJ 07921
Land Use	Light Industrial
Zoning Code	R-40
Neighborhood	I-1C

Owner	AMER TEL & TEL CO
Co-Owner	AT&T PROPERTY TAX UNIT
Book / Page	0148/0566
Land Class	Industrial
Census Tract	3434
Acreage	19.8

Valuation Summary

(Assessed value = 70% of Appraised Value)

Item	Appraised	Assessed
Buildings	2594709	1816300
Outbuildings	29640	20750
Land	429316	300520
Total	3053665	2137570

Utility Information

Electric	No
Gas	No
Sewer	No
Public Water	No
Well	No

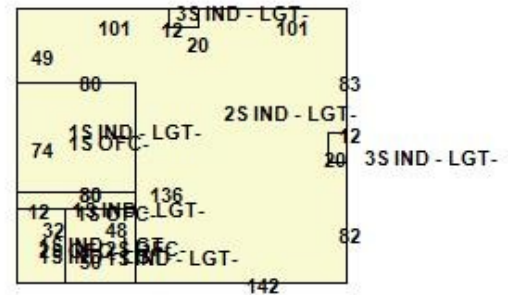

Primary Construction Details

Year Built	1968
Building Desc.	Commercial
Building Style	
Stories	2.00
Exterior Walls	Pre-Cast Concrete
Exterior Walls 2	B. V. Solid
Interior Walls	
Interior Walls 2	
Interior Floors 1	Composite
Interior Floors 2	

Heating Fuel	
Heating Type	
AC Type	Central
Bedrooms	0
Full Bathrooms	0
Half Bathrooms	0
Extra Fixtures	0
Total Rooms	0
Bath Style	NA
Kitchen Style	
Occupancy	0

Building Use	Light Industrial
Building Condition	Average
Frame Type	Average
Fireplaces	0
Bsmt Gar	0
Fin Bsmt Area	
Fin Bsmt Quality	
Building Grade	-50
Roof Style	HIP
Roof Cover	Asphalt



Town of Cheshire, CT

Property Listing Report

Map Block Lot **69 53**

Building # **1**

Unique Identifier

00712600

Detached Outbuildings

Type	Description	Area (sq ft)	Condition	Year Built
Fencing	Fencing	2400	Average	1968
Paving	Paving	43000	Average	1968
Fencing	Fencing	1560	Average	1968
Fencing	Fencing	600	Average	1968

Attached Extra Features

Type	Description	Area (sq ft)	Condition	Year Built

Sales History

Owner of Record	Book/ Page	Sale Date	Sale Price

Town of Cheshire, Connecticut - Assessment Parcel Map



Parcel: 00712600

Location: 751 HIGGINS RD

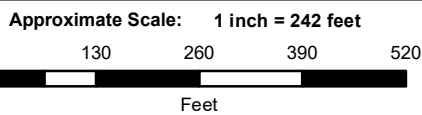
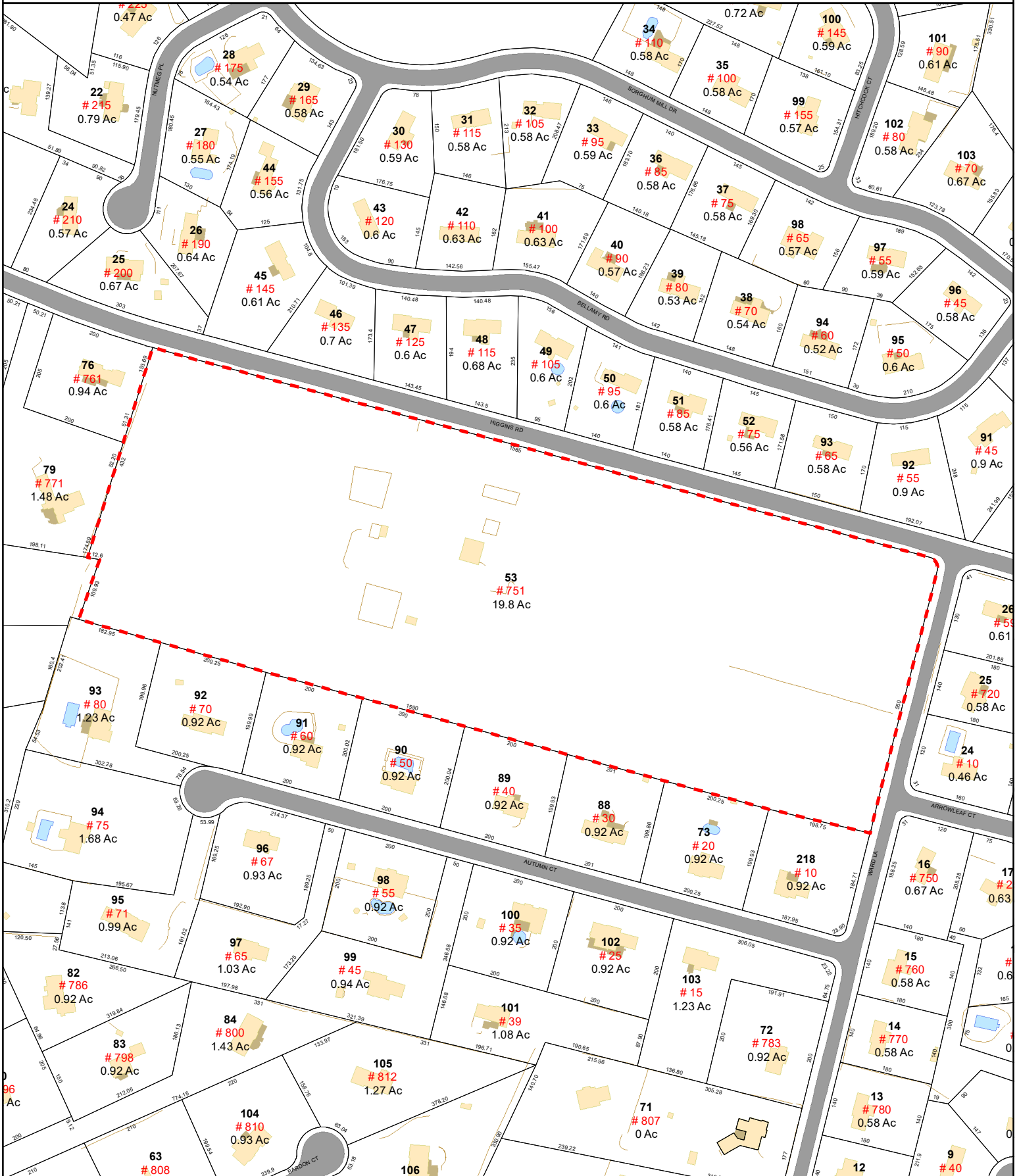

Map Produced: September 2020

Disclaimer: This map is for informational purposes only. All information is subject to verification by any user. The Town of Cheshire and its mapping contractors assume no legal responsibility for the information contained herein.

Exhibit C

MODIFICATION OF EXISTING WIRELESS FACILITY BY



T-MOBILE NORTHEAST LLC

PROJECT TITLE: NATIONAL HARDENING

SITE NUMBER: CT11220A

SITE NAME: CHESHIRE/ RT-10

SITE ADDRESS: 751 HIGGINS ROAD

CHESHIRE, CT 06410

APPLICANT:

T-Mobile
T-MOBILE NORTHEAST LLC

35 GRIFFIN ROAD SOUTH
BLOOMFIELD, CT 06002
860-692-7100

PROJECT MANAGER



420 MAIN STREET, BLDG 4
STURBRIDGE, MA 01566
203-275-6669

CONSULTANT:



462 WALNUT STREET, SUITE 1
NEWTON, MA 02460
617-212-3123

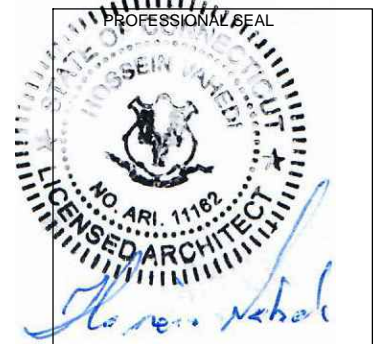

THIS DOCUMENT IS THE DESIGN PROPERTY AND COPYRIGHT OF FORESITE, LLC. AND FOR THE EXCLUSIVE USE BY THE TITLE CLIENT. DUPLICATION OR USE WITHOUT THE EXPRESS WRITTEN CONSENT OF THE CREATOR IS STRICTLY PROHIBITED. DRAWING SCALES ARE INTENDED FOR 11"x17" SIZE PRINTED MEDIA ONLY. ALL OTHER PRINTED SIZES ARE DEEMED "NOT TO SCALE".

PROJECT NOTES:

- THIS IS AN UNMANNED TELECOMMUNICATION FACILITY AND NOT FOR HUMAN HABITATION: HANDICAPPED ACCESS IS NOT REQUIRED. POTABLE WATER OR SANITARY SERVICE IS NOT REQUIRED. NO OUTDOOR STORAGE OR ANY SOLID WASTE RECEPTACLES REQUIRED.
- DEVELOPMENT AND USE OF THE SITE WILL CONFORM TO ALL APPLICABLE CODES, ORDINANCES AND SPECIFICATIONS.

CODE COMPLIANCE:

ALL WORK SHALL COMPLY WITH THE CURRENT NATIONAL AND CONNECTICUT STATE BUILDING AND LIFE SAFETY CODES, SUPPLEMENTS AND AMENDMENTS INCLUDING BUT NOT LIMITED TO THE LATEST EDITION OF:

- CONNECTICUT STATE BUILDING CODE (CSBC).
- ANSI/TIA-222-G STRUCTURAL STANDARD FOR ANTENNA SUPPORTING STRUCTURES AND ANTENNAS.
- NATIONAL ELECTRICAL CODE (NEC) FOR POWER AND GROUNDING REQUIREMENTS.
- OCCUPATIONAL SAFETY AND HEALTH ACT (OSHA).
- NFPA - NATIONAL FIRE PROTECTION ASSOCIATION.



Advance Notice:
Minimum of 2 working days in advance, no more than 30 days in advance

CONTRACTOR'S NOTES:

CONTRACTOR SHALL VERIFY ALL PLANS, EXISTING DIMENSIONS, AND CONDITIONS ON THE JOB SITE. CONTRACTOR SHALL IMMEDIATELY NOTIFY THE ARCHITECT/ENGINEER IN WRITING OF ANY DISCREPANCIES BEFORE PROCEEDING WITH THE WORK. FAILURE TO NOTIFY THE ARCHITECT/ENGINEER PLACES THE RESPONSIBILITY ON THE CONTRACTOR TO CORRECT THE DISCREPANCIES AT THE CONTRACTOR'S EXPENSE.

APPROVALS:

FSA CM	DATE
RF ENGINEER	DATE
FOPS	DATE
T-MOBILE ENGINEERING AND DEVELOPMENT	DATE
	DATE
	DATE

SITE IMAGE:



SITE VICINITY :



PROJECT SCOPE:

THE PROPOSED PROJECT SCOPE CONSISTS OF INSTALLATION OF A NEW GENERAC RD 48 KW AC DIESEL GENERATOR AND TANK FOR AN EXISTING TELECOM BASE STATION. NO SIGNIFICANT GRADING IS REQUIRED AND ALL PROPOSED CONSTRUCTION WILL BE CONTAINED IN CLOSE PROXIMITY OF THE EXISTING TOWER SITE LEASE AREA.

PROJECT INFORMATION:

ADDRESS: 751 HIGGINS ROAD
CHESHIRE, CT 06410

ZONING DISTRICT: R-40
PARCEL ID: 69-53
LAND USE: LIGHT INDUSTRIAL
COORDINATES: 41° 29' 14.84" N 72° 55' 45.41" W
GROUND ELEV: 280± (AMSL)

PROJECT TEAM:

APPLICANT: T-MOBILE NORTHEAST, LLC.
35 GRIFFIN ROAD SOUTH
BLOOMFIELD, CT 06002
860-692-7100

PROPERTY OWNER: AMER TEL & TEL CO
AT&T PROPERTY TAX UNIT
P O BOX 7207
BEDMINSTER NJ, 07921

PROJECT MANAGER: NORTHEAST SITE SOLUTIONS
420 MAIN STREET, BLDG 4
STURBRIDGE, MA 01566
SHELDON FREINCKLE
SHELDON@NORTHEASTSITESOLUTIONS.COM
201-776-8521

ENGINEERING CONSULTANTS: FORESITE LLC
462 WALNUT ST
NEWTON, MA 02460
SAEED MOSSAVAT
SMOSSAVAT@FORESITELLC.COM
617-212-3123

SHEET INDEX:

- T-1: TITLE SHEET
- N-1: GENERAL NOTES
- A-1: SITE LOCATION PLAN
- A-2: SITE PLAN
- A-3: GENERATOR SPECIFICATIONS
- A-4: GENERATOR SPECIFICATIONS
- A-5: AUTOMATIC TRANSFER SWITCH SPECIFICATIONS
- A-6: CONCRETE PAD AND UNDERGROUND UTILITY DETAILS
- E-1: ELECTRICAL DETAILS
- G-1: GROUNDING DETAILS

REV	DESCRIPTION	DATE
A	PRELIMINARY	12/27/21
0	FINAL ISSUED	02/07/22

SITE NUMBER: CT11220A
SITE NAME: CHESHIRE/ RT-10
SITE ADDRESS: 751 HIGGINS ROAD
CHESHIRE, CT 06410

SHEET TITLE:
T-1: TITLE SHEET

Copyright © 2020 Foresite LLC. All rights reserved. The details, templates, drawing formats or any portion of this document generated by Foresite LLC may not be duplicated, traced or used otherwise for any profit-driven enterprise.

Copyright © 2020 Foresite LLC all rights reserved. The details, templates, drawing formats or any portion of this document generated by Foresite LLC may not be duplicated, traced or used otherwise for any profit-driven enterprise.

GENERAL NOTES:

1. THE CONTRACTOR SHALL GIVE ALL NOTICES AND COMPLY WITH ALL LAWS, ORDINANCES, RULES, REGULATIONS AND LAWFUL ORDERS OF ANY PUBLIC AUTHORITY, MUNICIPAL AND UTILITY COMPANY SPECIFICATIONS, AND LOCAL AND STATE JURISDICTIONAL CODES BEARING ON THE PERFORMANCE OF THE WORK. THE WORK PERFORMED ON THE PROJECT AND THE MATERIALS INSTALLED SHALL BE IN STRICT ACCORDANCE WITH ALL APPLICABLE CODES, REGULATIONS, AND ORDINANCES.
2. THE ARCHITECT/ENGINEER HAS MADE EVERY EFFORT TO SET FORTH IN THE CONSTRUCTION AND CONTRACT DOCUMENTS THE COMPLETE SCOPE OF WORK. THE CONTRACTOR BIDDING THE JOB IS NEVERTHELESS CAUTIONED THAT MINOR OMISSIONS OR ERRORS IN THE DRAWINGS AND OR SPECIFICATIONS SHALL NOT EXCUSE SAID CONTRACTOR FROM COMPLETING THE PROJECT AND IMPROVEMENTS IN ACCORDANCE WITH THE INTENT OF THESE DOCUMENTS.
3. THE CONTRACTOR OR BIDDER SHALL BEAR THE RESPONSIBILITY OF NOTIFYING (IN WRITING) THE CLIENT'S REPRESENTATIVE OF ANY CONFLICTS, ERRORS, OR OMISSIONS PRIOR TO THE SUBMISSION OF CONTRACTOR'S PROPOSAL OR PERFORMANCE OF WORK.
5. THE CONTRACTOR SHALL VISIT THE JOB SITE PRIOR TO THE SUBMISSION OF BIDS OR PERFORMING WORK TO FAMILIARIZE HIMSELF WITH THE FIELD CONDITIONS AND TO VERIFY THAT THE PROJECT CAN BE CONSTRUCTED IN ACCORDANCE WITH THE CONSTRUCTION DOCUMENTS.
6. THE CONTRACTOR SHALL INSTALL ALL EQUIPMENT AND MATERIALS ACCORDING TO THE MANUFACTURER'S / VENDOR'S SPECIFICATIONS UNLESS NOTED OTHERWISE OR WHERE LOCAL CODES OR ORDINANCES TAKE PRECEDENCE.
7. THE CONTRACTOR SHALL MAKE NECESSARY PROVISIONS TO PROTECT EXISTING IMPROVEMENTS DURING CONSTRUCTION.
8. THE CONTRACTOR SHALL COMPLY WITH ALL PERTINENT SECTIONS OF THE BASIC STATE BUILDING CODE, LATEST EDITION, AND ALL OSHA REQUIREMENTS AS THEY APPLY TO THIS PROJEC
9. THE CONTRACTOR SHALL NOTIFY THE CLIENT'S REPRESENTATIVE IN WRITING WHERE A CONFLICT OCCURS ON ANY OF THE CONTRACT DOCUMENTS. THE CONTRACTOR IS NOT TO ORDER MATERIAL OR CONSTRUCT ANY PORTION OF THE WORK THAT IS IN CONFLICT UNTIL CONFLICT IS RESOLVED BY THE CLIENT'S REPRESENTATIVE.
10. THE WORK SHALL CONFORM TO THE CODES AND STANDARDS OF THE FOLLOWING AGENCIES AS FURTHER CITED HEREIN:
 - A. ASTM: AMERICAN SOCIETY FOR TESTING AND MATERIALS, AS PUBLISHED IN "COMPILATION OF ASTM STANDARDS BUILDING CODES" OR LATEST EDITION.
 - B. AWS: AMERICAN WELDING SOCIETY INC. AS PUBLISHED IN "STANDARD D1.1-08, STRUCTURAL WELDING CODE" OR LATEST EDITION.
 - C. AISC: AMERICAN INSTITUTE FOR STEEL CONSTRUCTION AS PUBLISHED IN "CODE FOR STANDARD PRACTICE FOR STEEL BUILDINGS AND BRIDGES"; "SPECIFICATIONS FOR THE DESIGN, FABRICATION AND ERECTION OF STRUCTURAL STEEL FOR BUILDINGS" (LATEST EDITION).
11. BOLTING:
 - A. BOLTS SHALL BE CONFORMING TO ASTM A325 HIGH STRENGTH, HOT DIP GALVANIZED WITH ASTM A153 HEAVY HEX TYPE NUTS.
 - B. BOLTS SHALL BE 3/4"Ø MINIMUM (UNLESS OTHERWISE NOTED)
 - C. ALL CONNECTIONS SHALL BE 2 BOLTS MINIMUM.
12. FABRICATION:
 - A. FABRICATION OF STEEL SHALL CONFORM TO THE AISC AND AWS STANDARDS AND CODES (LATEST EDITION).
 - B. ALL STRUCTURAL STEEL SHALL BE HOT-DIP GALVANIZED AFTER FABRICATION IN ACCORDANCE WITH ASTM A123 (LATEST EDITION), UNLESS OTHERWISE NOTED.
13. ERECTION OF STEEL:
 - A. PROVIDE ALL ERECTION EQUIPMENT, BRACING, PLANKING, FIELD BOLTS, NUTS, WASHERS, DRIFT PINS, AND SIMILAR MATERIALS WHICH DO NOT FORM A PART OF THE COMPLETED CONSTRUCTION BUT ARE NECESSARY FOR ITS PROPER ERECTION.
 - B. ERECT AND ANCHOR ALL STRUCTURAL STEEL IN ACCORDANCE WITH AISC REFERENCE STANDARDS. ALL WORK SHALL BE ACCURATELY SET TO ESTABLISHED LINES AND ELEVATIONS AND RIGIDLY FASTENED IN PLACE WITH SUITABLE ATTACHMENTS TO THE CONSTRUCTION OF THE BUILDING.
 - C. TEMPORARY BRACING, GUYING AND SUPPORT SHALL BE PROVIDED TO KEEP THE STRUCTURE SAFE AND ALIGNED AT ALL TIMES DURING CONSTRUCTION, AND TO PREVENT DANGER TO PERSONS AND PROPERTY. CHECK ALL TEMPORARY LOADS AND STAY WITHIN SAFE CAPACITY OF ALL BUILDING COMPONENTS.
14. RELATED WORK, FURNISH THE FOLLOWING WORK AS SPECIFIED UNDER CONSTRUCTION DOCUMENTS, BUT COORDINATE WITH OTHER TRADES PRIOR TO BID:
 - A. FLASHING OF OPENING INTO OUTSIDE WALLS

- B. SEALING AND CAULKING ALL OPENINGS
- C. PAINTING
- D. CUTTING AND PATCHING
15. REQUIREMENTS OF REGULATORY AGENCIES:
 - A. FURNISH U.L. LISTED EQUIPMENT WHERE SUCH LABEL IS AVAILABLE. INSTALL IN CONFORMANCE WITH U.L. STANDARDS WHERE APPLICABLE.
 - B. INSTALL ANTENNA, ANTENNA CABLES, GROUNDING SYSTEM IN ACCORDANCE WITH DRAWINGS AND SPECIFICATION IN EFFECT AT PROJECT LOCATION AND RECOMMENDATIONS OF STATE AND LOCAL BUILDING CODES, AND SPECIAL CODES HAVING JURISDICTION OVER SPECIFIC PORTIONS OF WORK. THIS WORK INCLUDES BUT IS NOT LIMITED TO THE FOLLOWING:
 - C. TIA-EIA - 222 (LATEST EDITION). STRUCTURAL STANDARDS FOR STEEL ANTENNA TOWERS AND ANTENNA SUPPORTING STRUCTURES.
 - D. FAA - FEDERAL AVIATION ADMINISTRATION ADVISORY CIRCULAR AC 70/7460-IH, OBSTRUCTION MARKING AND LIGHTING.
 - E. FCC - FEDERAL COMMUNICATIONS COMMISSION RULES AND REGULATIONS FORM 715, OBSTRUCTION MARKING AND LIGHTING SPECIFICATION FOR ANTENNA STRUCTURES AND FORM 715A, HIGH INTENSITY OBSTRUCTION LIGHTING SPECIFICATIONS FOR ANTENNA STRUCTURES.
 - F. AISC - AMERICAN INSTITUTE OF STEEL CONSTRUCTION SPECIFICATION FOR STRUCTURAL JOINTS USING ASTM A325 BOLTS (LATEST EDITION).
 - G. NEC - NATIONAL ELECTRICAL CODE - ON TOWER LIGHTING KITS.
 - H. UL - UNDERWRITER'S LABORATORIES APPROVED ELECTRICAL PRODUCTS.
 - I. IN ALL CASES, PART 77 OF THE FAA RULES AND PARTS 17 AND 22 OF THE FCC RULES ARE APPLICABLE AND IN THE EVENT OF CONFLICT, SUPERSEDE ANY OTHER STANDARDS OR SPECIFICATIONS.
 - J. 2018 LIFE SAFETY CODE NFPA - 101.

APPLICANT:

T-MOBILE NORTHEAST LLC
 35 GRIFFIN ROAD SOUTH
 BLOOMFIELD, CT 06002
 860-692-7100

PROJECT MANAGER

 420 MAIN STREET, BLDG 4
 STURBRIDGE, MA 01566
 203-275-6669

CONSULTANT:

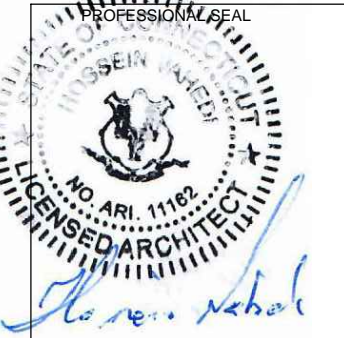
 Architects . Engineers . Surveyors
 462 WALNUT STREET, SUITE 1
 NEWTON, MA 02460
 617-212-3123



THIS DOCUMENT IS THE DESIGN PROPERTY AND COPYRIGHT OF FORESITE, LLC. AND FOR THE EXCLUSIVE USE BY THE TITLE CLIENT. DUPLICATION OR USE WITHOUT THE EXPRESS WRITTEN CONSENT OF THE CREATOR IS STRICTLY PROHIBITED. DRAWING SCALES ARE INTENDED FOR 11"x17" SIZE PRINTED MEDIA ONLY. ALL OTHER PRINTED SIZES ARE DEEMED "NOT TO SCALE".

REV	DESCRIPTION	DATE
A	PRELIMINARY	12/27/21
0	FINAL ISSUED	02/07/22

SITE NUMBER: CT11220A
 SITE NAME: CHESHIRE/ RT-10
 SITE ADDRESS: 751 HIGGINS ROAD
 CHESHIRE, CT 06410

SHEET TITLE:
N-1: NOTES AND DISCLAIMERS

Copyright © 2020 Foresite LLC all rights reserved. The details, templates, drawing formats or any portion of this document generated by Foresite LLC may not be duplicated, traced or used otherwise for any profit-driven enterprise.



SITE LOCATION PLAN 1
SCALE: 1"=100' A-1

APPLICANT:
T-Mobile
T-MOBILE NORTHEAST LLC
 35 GRIFFIN ROAD SOUTH
 BLOOMFIELD, CT 06002
 860-692-7100

PROJECT MANAGER

NORTHEAST SITE SOLUTIONS
Turnkey Wireless Development
 420 MAIN STREET, BLDG 4
 STURBRIDGE, MA 01566
 203-275-6669

CONSULTANT:
FORESITE LLC
Architects . Engineers . Surveyors
 462 WALNUT STREET, SUITE 1
 NEWTON, MA 02460
 617-212-3123

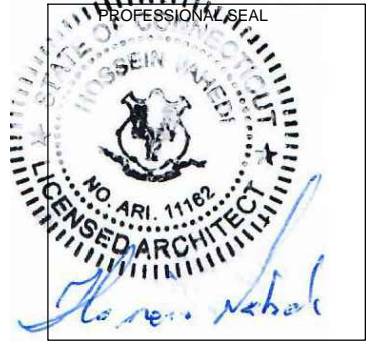

THIS DOCUMENT IS THE DESIGN PROPERTY AND COPYRIGHT OF FORESITE, LLC, AND FOR THE EXCLUSIVE USE BY THE TITLE CLIENT. DUPLICATION OR USE WITHOUT THE EXPRESS WRITTEN CONSENT OF THE CREATOR IS STRICTLY PROHIBITED. DRAWING SCALES ARE INTENDED FOR 11"x17" SIZE PRINTED MEDIA ONLY. ALL OTHER PRINTED SIZES ARE DEEMED "NOT TO SCALE".

REV	DESCRIPTION	DATE
A	PRELIMINARY	12/27/21
0	FINAL ISSUED	02/07/22

SITE NUMBER: CT11220A
SITE NAME: CHESHIRE/ RT-10
SITE ADDRESS: 751 HIGGINS ROAD
CHESHIRE, CT 06410

SHEET TITLE:
A-1: SITE LOCATION PLAN

Copyright © 2020 Foresite LLC all rights reserved. The details, templates, drawing formats or any portion of this document generated by Foresite LLC may not be duplicated, traced or used otherwise for any profit-driven enterprise.

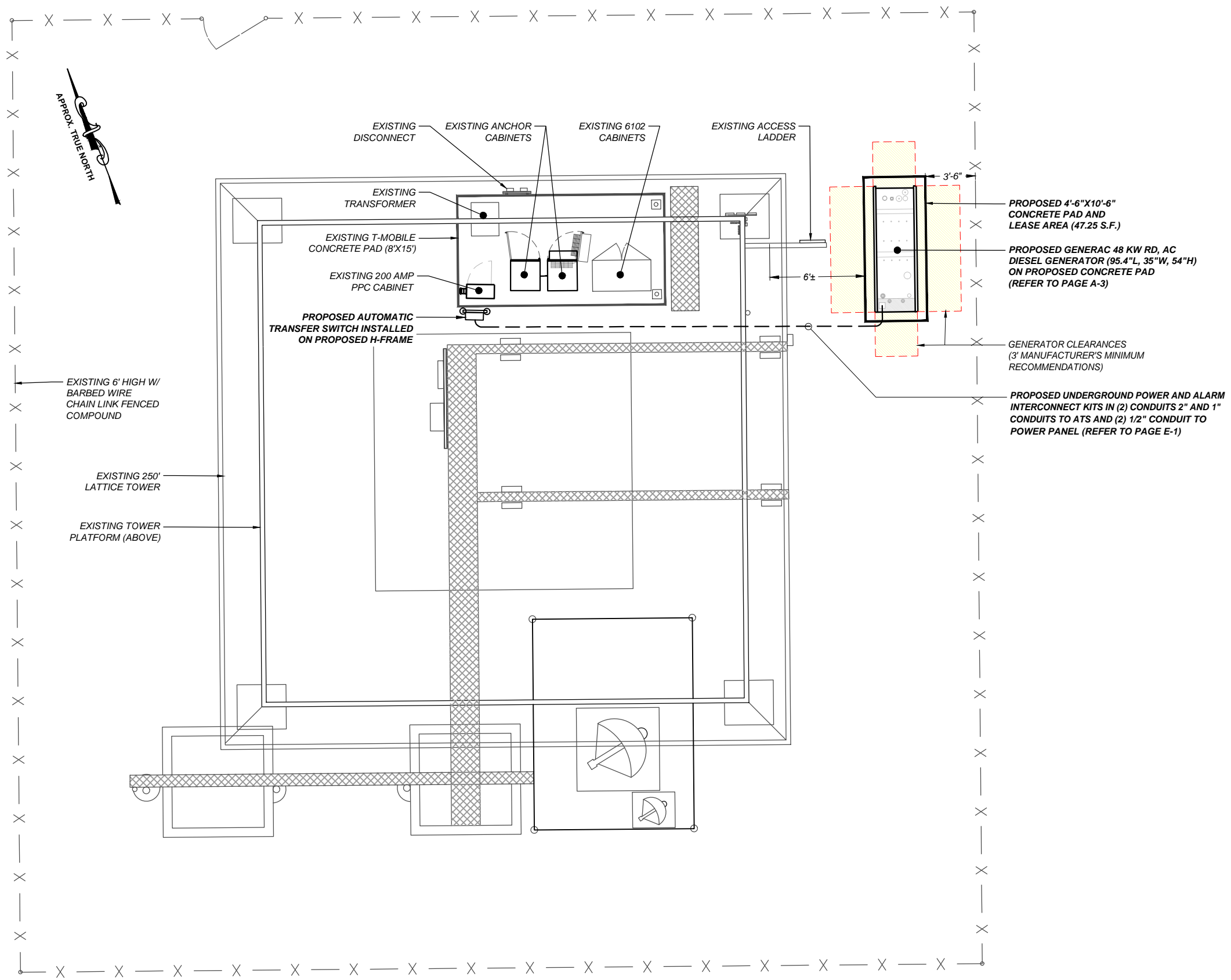

SITE PLAN
SCALE: 1/8" = 1'-0"
 1
 A-2

APPLICANT:
T-Mobile
T-MOBILE NORTHEAST LLC
 35 GRIFFIN ROAD SOUTH
 BLOOMFIELD, CT 06002
 860-692-7100

PROJECT MANAGER

 420 MAIN STREET, BLDG 4
 STURBRIDGE, MA 01566
 203-275-6669

CONSULTANT:
FORESITE LLC
 Architects . Engineers . Surveyors
 462 WALNUT STREET, SUITE 1
 NEWTON, MA 02460
 617-212-3123

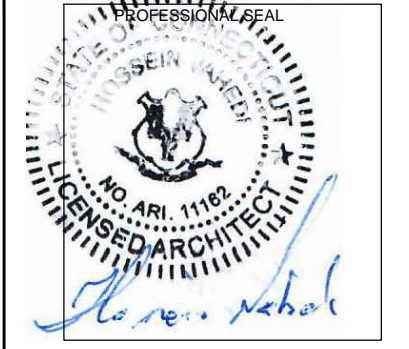

THIS DOCUMENT IS THE DESIGN PROPERTY AND COPYRIGHT OF FORESITE, LLC. AND FOR THE EXCLUSIVE USE BY THE TITLE CLIENT. DUPLICATION OR USE WITHOUT THE EXPRESS WRITTEN CONSENT OF THE CREATOR IS STRICTLY PROHIBITED. DRAWING SCALES ARE INTENDED FOR 11"x17" SIZE PRINTED MEDIA ONLY. ALL OTHER PRINTED SIZES ARE DEEMED "NOT TO SCALE".

REV	DESCRIPTION	DATE
A	PRELIMINARY	12/27/21
0	FINAL ISSUED	02/07/22

SITE NUMBER: CT11220A
SITE NAME: CHESHIRE/ RT-10
 SITE ADDRESS: 751 HIGGINS ROAD
 CHESHIRE, CT 06410

SHEET TITLE:
A-2: SITE PLAN

Copyright © 2020 Foresite LLC all rights reserved. The details, templates, drawing formats or any portion of this document generated by Foresite LLC may not be duplicated, traced or used otherwise for any profit-driven enterprise.

GENERAC RD 48 KW AC DIESEL GENERATOR AND TANK

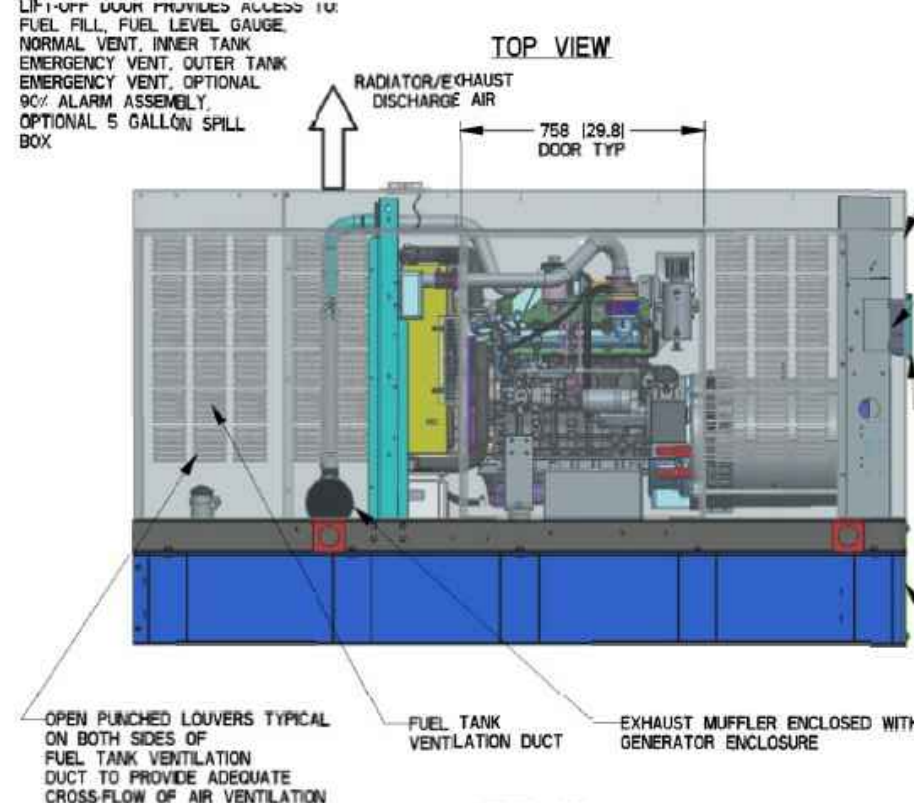
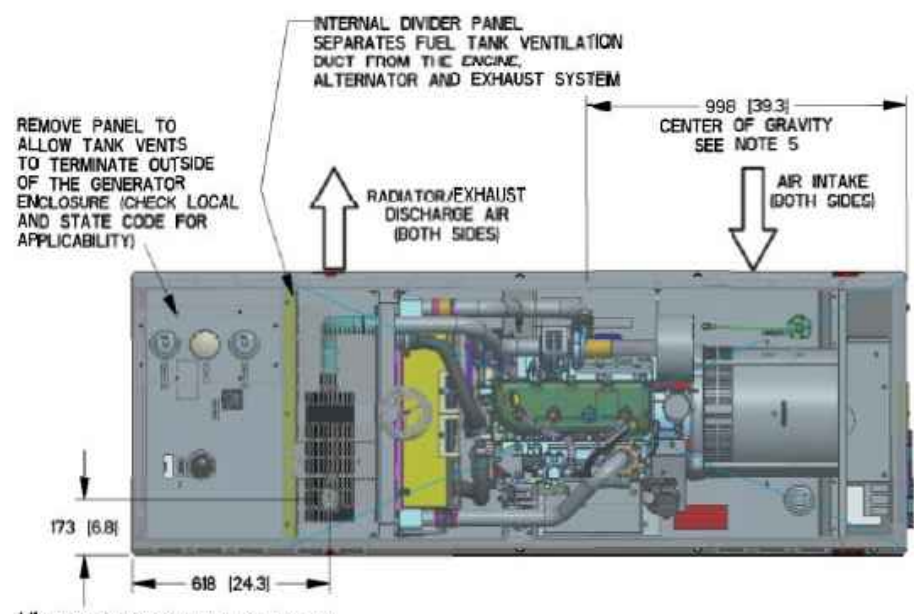

SERVICE ITEM	3-4L
OIL FILL CAP	RIGHT SIDE
OIL DIP STICK	RIGHT SIDE
OIL FILTER	RIGHT SIDE
OIL DRAIN HOSE	RIGHT SIDE
RADIATOR DRAIN HOSE	LEFT SIDE
AIR CLEANER ELEMENT	RIGHT SIDE
MUFFLER	FRONT
FAN BELT	EITHER SIDE
BATTERY	LEFT SIDE

WEIGHT DATA WITH EMPTY BASE TANK (SEE NOTE 5)	
GENERATOR AS SHOWN (STEEL ENCL)	997 [2197]
WITH WOODEN SHIPPING SKID	1042 [2297]

REFERENCE OWNERS MANUAL FOR PERIODIC REPLACEMENT PART LISTINGS.

- NOTES:**
- MINIMUM RECOMMENDED CONCRETE PAD SIZE: 194 (47) WIDE X 2718 (107) LONG. REFERENCE INSTALLATION GUIDE SUPPLIED WITH UNIT FOR CONCRETE PAD GUIDELINES.
 - ALLOW SUFFICIENT ROOM ON ALL SIDES OF THE GENERATOR FOR MAINTENANCE AND SERVICING. THIS UNIT MUST BE INSTALLED IN ACCORDANCE WITH CURRENT APPLICABLE NFPA 37 AND NFPA 70 STANDARDS AS WELL AS ANY OTHER FEDERAL, STATE AND LOCAL CODES.
 - CONTROL PANEL / CIRCUIT BREAKER INFORMATION:
 - SEE SPECIFICATION SHEET OR OWNERS MANUAL
 - ACCESSIBLE THROUGH CUSTOMER ACCESS ASSEMBLY DOOR ON REAR OF GENERATOR
 - REMOVE THE REAR TANK AND REAR ENCLOSURE COVER PANEL TO ACCESS THE STUB-UP AREAS AS FOLLOWS:
 - HIGH VOLTAGE CONNECTION INCLUDING AC LOAD LEAD CONDUIT CONNECTION NEUTRAL CONNECTION, BATTERY CHARGER 120 VOLT AC (0.5 AMP MAX) CONNECTION.
 - LOW VOLTAGE CONNECTIONS INCLUDING TRANSFER SWITCH CONTROL WIRES
 - CENTER OF GRAVITY AND WEIGHT MAY CHANGE DUE TO UNIT OPTIONS.
 - ENGINE SERVICE CONNECTIONS
 - OIL DRAIN: 3/8" NPT
 - EXHAUST OUTLET: 2" O.D.
 - BOTTOM OF GENERATOR SET MUST BE ENCLOSED TO PREVENT PEST INTRUSION AND RECIRCULATION OF DISCHARGE AIR AND/OR IMPROPER COOLING AIR FLOW.
 - EXHAUST SYSTEM MAXIMUM BACK PRESSURE: 35 INCHES H₂O.
 - REFERENCE OWNERS MANUAL FOR LIFTING WARNINGS.
 - MOUNTING BOLTS OR STUDS TO CONCRETE PAD SHALL BE 5/8"-11 GRADE 5 (USE STANDARD SAE TORQUE SPECS)

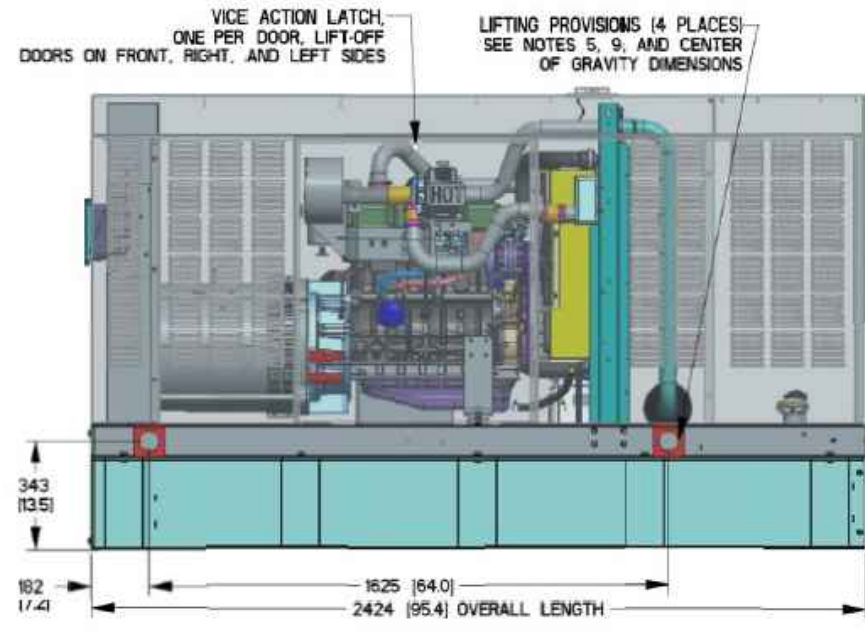
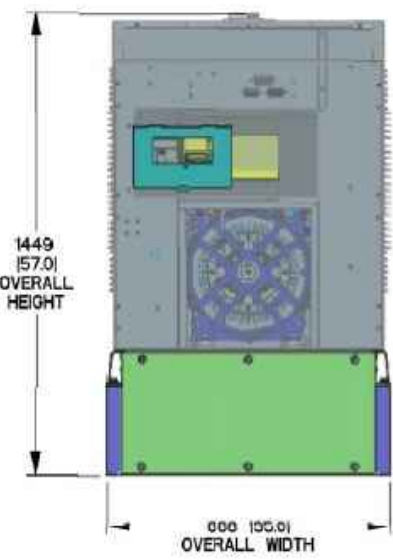

LEFT SIDE VIEW

REAR VIEW

RIGHT SIDE VIEW

GENERATOR SPECIFICATIONS

APPLICANT:
T-Mobile
T-MOBILE NORTHEAST LLC
 35 GRIFFIN ROAD SOUTH
 BLOOMFIELD, CT 06002
 860-692-7100

PROJECT MANAGER

 420 MAIN STREET, BLDG 4
 STURBRIDGE, MA 01566
 203-275-6669

CONSULTANT:
FORESITE LLC
 Architects · Engineers · Surveyors
 462 WALNUT STREET, SUITE 1
 NEWTON, MA 02460
 617-212-3123

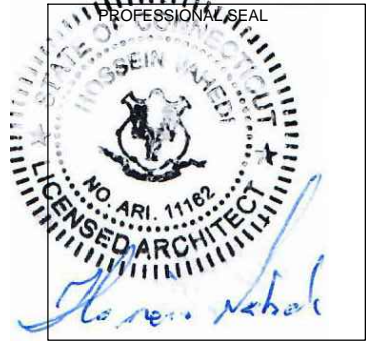

THIS DOCUMENT IS THE DESIGN PROPERTY AND COPYRIGHT OF FORESITE, LLC, AND FOR THE EXCLUSIVE USE BY THE TITLE CLIENT. DUPLICATION OR USE WITHOUT THE EXPRESS WRITTEN CONSENT OF THE CREATOR IS STRICTLY PROHIBITED. DRAWING SCALES ARE INTENDED FOR 11"x17" SIZE PRINTED MEDIA ONLY. ALL OTHER PRINTED SIZES ARE DEEMED "NOT TO SCALE".

REV	DESCRIPTION	DATE
A	PRELIMINARY	12/27/21
0	FINAL ISSUED	02/07/22

SITE NUMBER: CT11220A
SITE NAME: CHESHIRE/ RT-10
 SITE ADDRESS: 751 HIGGINS ROAD
 CHESHIRE, CT 06410

SHEET TITLE:
A-3: GENERATOR SPECIFICATIONS

Copyright © 2020 Foresite LLC. All rights reserved. The details, templates, drawing formats or any portion of this document generated by Foresite LLC may not be duplicated, traced or used otherwise for any profit-driven enterprise.

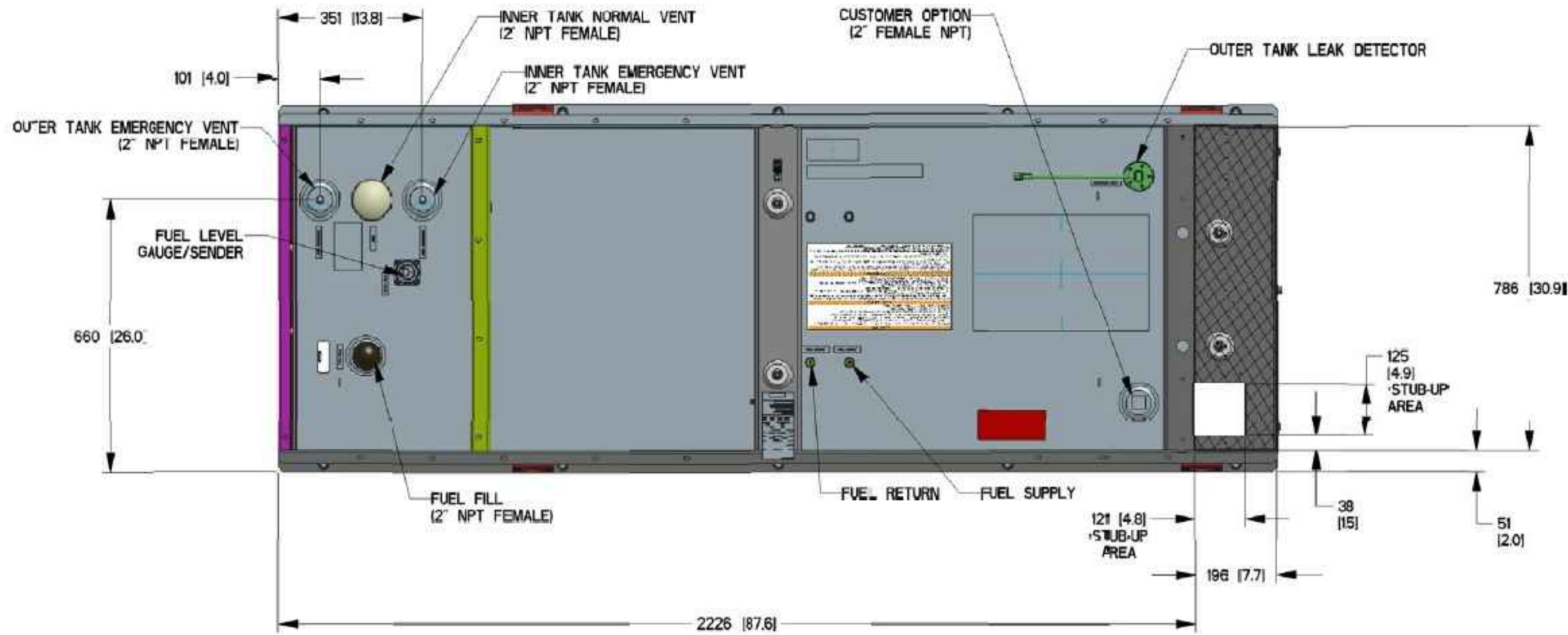

FUEL TANK	
TOTAL CAPACITY	233 [61]
USABLE CAPACITY	209 [55]

CAPACITY: LITER (GALLONS)
 DIMENSIONS: MM (INCH)
 THIS TANK IS LISTED TO UL142 AND ULC5601

NOTE - STUB-UP AREA FOR HIGH AND LOW VOLTAGE CONNECTIONS, CIRCUIT BREAKER, NEUTRAL AND CUSTOMER CONNECTION OPENING.

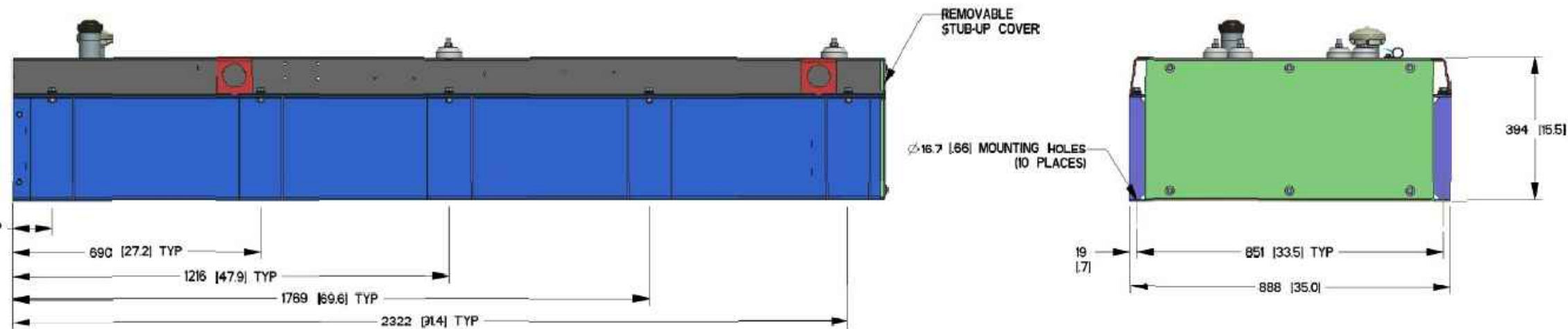

APPLICANT:
T-Mobile
T-MOBILE NORTHEAST LLC
 35 GRIFFIN ROAD SOUTH
 BLOOMFIELD, CT 06002
 860-692-7100

PROJECT MANAGER

 420 MAIN STREET, BLDG 4
 STURBRIDGE, MA 01566
 203-275-6669

CONSULTANT:
FORESITE LLC
 Architects . Engineers . Surveyors
 462 WALNUT STREET, SUITE 1
 NEWTON, MA 02460
 617-212-3123

THIS DOCUMENT IS THE DESIGN PROPERTY AND COPYRIGHT OF FORESITE, LLC. AND FOR THE EXCLUSIVE USE BY THE TITLE CLIENT. DUPLICATION OR USE WITHOUT THE EXPRESS WRITTEN CONSENT OF THE CREATOR IS STRICTLY PROHIBITED. DRAWING SCALES ARE INTENDED FOR 11"x17" SIZE PRINTED MEDIA ONLY. ALL OTHER PRINTED SIZES ARE DEEMED "NOT TO SCALE".

REV	DESCRIPTION	DATE
A	PRELIMINARY	12/27/21
0	FINAL ISSUED	02/07/22

SITE NUMBER: CT11220A
SITE NAME: CHESHIRE/ RT-10
 SITE ADDRESS: 751 HIGGINS ROAD
 CHESHIRE, CT 06410

SHEET TITLE:
A-4: GENERATOR SPECIFICATIONS

Copyright © 2020 Foresite LLC all rights reserved. The details, templates, drawing formats or any portion of this document generated by Foresite LLC may not be duplicated, traced or used otherwise for any profit-driven enterprise.

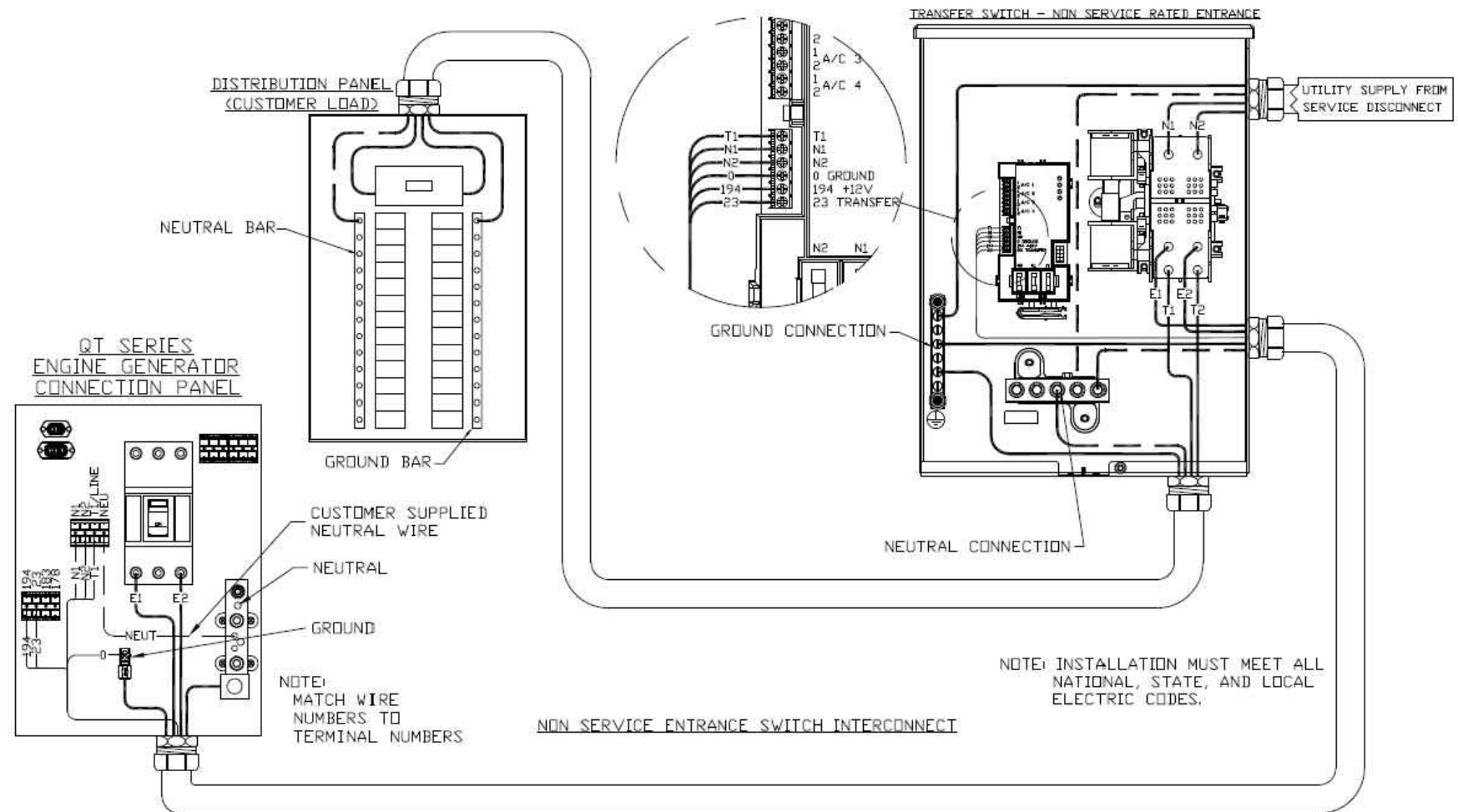
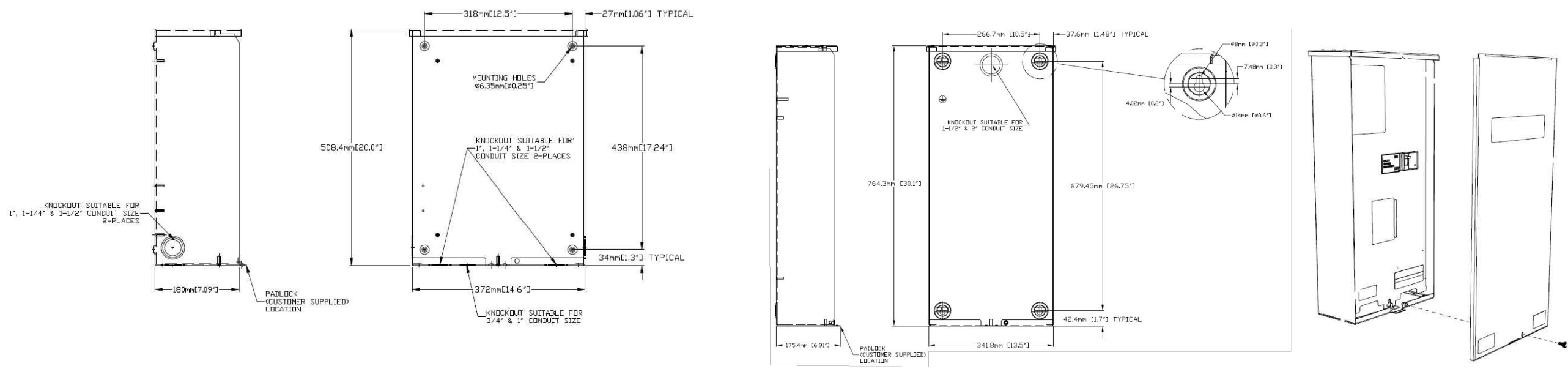

AUTOMATIC TRANSFER SWITCH DETAILS
 SCALE: N.T.S. 1
A-5

APPLICANT:
T-Mobile
T-MOBILE NORTHEAST LLC
 35 GRIFFIN ROAD SOUTH
 BLOOMFIELD, CT 06002
 860-692-7100

PROJECT MANAGER
NORTHEAST SITE SOLUTIONS
Turnkey Wireless Development
 420 MAIN STREET, BLDG 4
 STURBRIDGE, MA 01566
 203-275-6669

CONSULTANT:
FORESITE LLC
Architects • Engineers • Surveyors
 462 WALNUT STREET, SUITE 1
 NEWTON, MA 02460
 617-212-3123

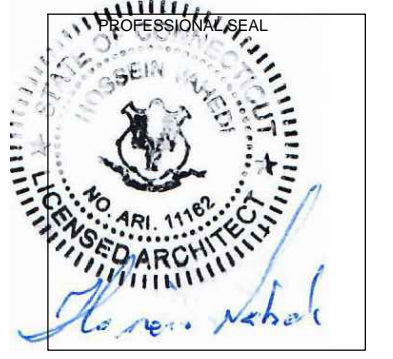

THIS DOCUMENT IS THE DESIGN PROPERTY AND COPYRIGHT OF FORESITE, LLC. AND FOR THE EXCLUSIVE USE BY THE TITLE CLIENT. DUPLICATION OR USE WITHOUT THE EXPRESS WRITTEN CONSENT OF THE CREATOR IS STRICTLY PROHIBITED. DRAWING SCALES ARE INTENDED FOR 11"x17" SIZE PRINTED MEDIA ONLY. ALL OTHER PRINTED SIZES ARE DEEMED "NOT TO SCALE".

REV	DESCRIPTION	DATE
A	PRELIMINARY	12/27/21
0	FINAL ISSUED	02/07/22

SITE NUMBER: CT11220A
 SITE NAME: CHESHIRE/ RT-10
 SITE ADDRESS: 751 HIGGINS ROAD
 CHESHIRE, CT 06410

SHEET TITLE:
A-5: AUTOMATIC TRANSFER SWITCH DETAILS

Copyright © 2020 Foresite LLC all rights reserved. The details, templates, drawing formats or any portion of this document generated by Foresite LLC may not be duplicated, traced or used otherwise for any profit-driven enterprise.

CONSTRUCTION NOTES:
 - (HAND-DUG UTILITY TRENCH EXCAVATION REQUIRED):
 - EXISTING UNDERGROUND UTILITY LOCATIONS ARE UNKNOWN. GENERAL CONTRACTOR SHALL HAND-EXCAVATE TO REQUIRED SUB-GRADE DEPTH, SUFFICIENT TEST HOLES.
 ALL PROPOSED UNDERGROUND UTILITY TRENCHES SHALL BE HAND-EXCAVATE AS REQUIRED.
 - GENERAL CONTRACTOR IS RESPONSIBLE FOR ANY REQUIRED SPECIAL TEMPORARY PROTECTION OF, PHYSICAL DAMAGE TO, OR REPAIR OF EXISTING UNDERGROUND CONDUIT INCLUDING RESTORATION OF SERVICE.

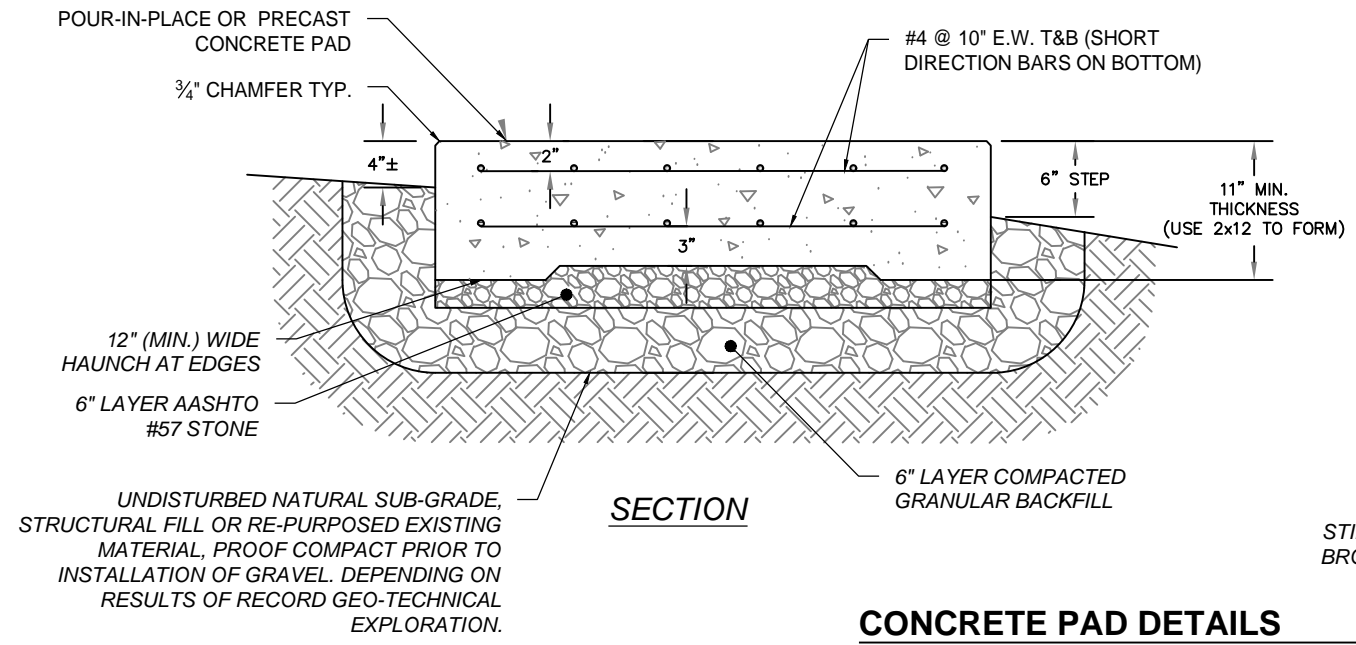

CONCRETE PAD DETAILS
 SCALE: N.T.S.

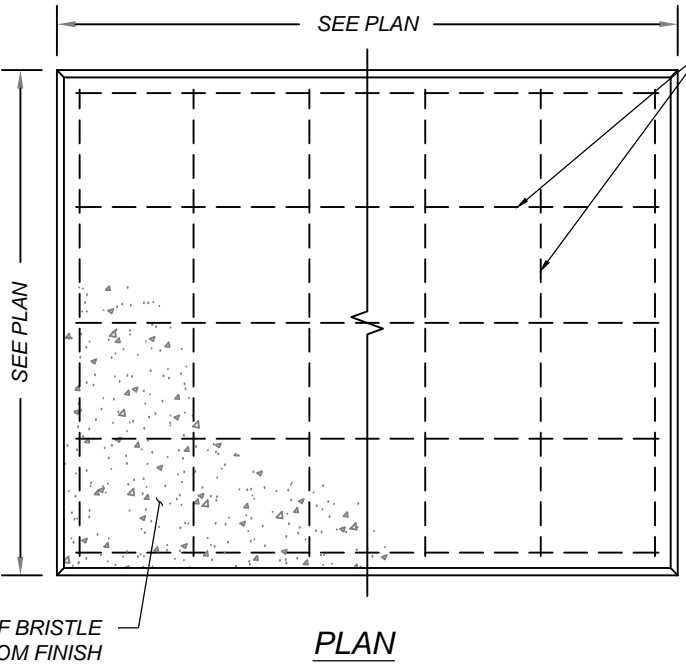

#4 @ 10" E.W. T&B (SHORT DIRECTION BARS ON BOTTOM)

NOTES:
 1. BEARING STRATA MEDIUM TO DENSE INSET GRANULAR MATERIAL OR COMPACTED FILL. 95% COMPACTION.
 2. SUBGRADE AND FILL SHALL CONSIST OF CLEAN SOIL. NO DELETERIOUS MATERIALS OR ORGANICS TO BE USED.
 3. CONCRETE FORM WORK SHALL BE CONSTRUCTED USING MINIMUM 2"x8" NOMINAL SIZE LUMBER. STRIP AND REMOVE UPON COMPLETION.
 4. CONCRETE SHALL HAVE 4000PSI 28-DAY COMPRESSIVE STRENGTH WITH 5(±1)% AIR ENTRAINMENT, 4(±1)" SLUMP AND BRISTLE BROOM FINISH.

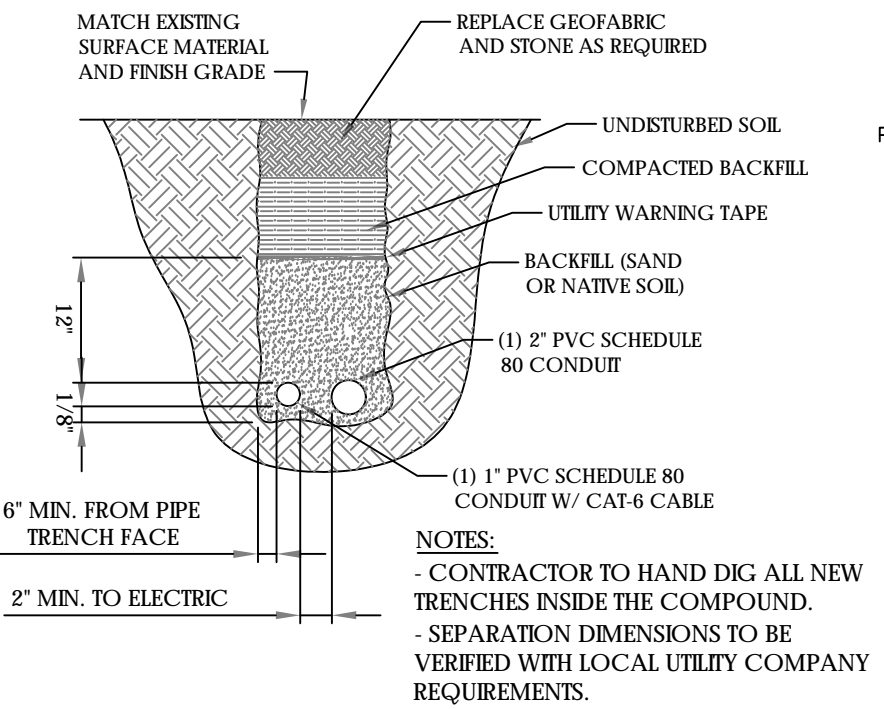

TRENCH DETAIL
 SCALE: N.T.S.

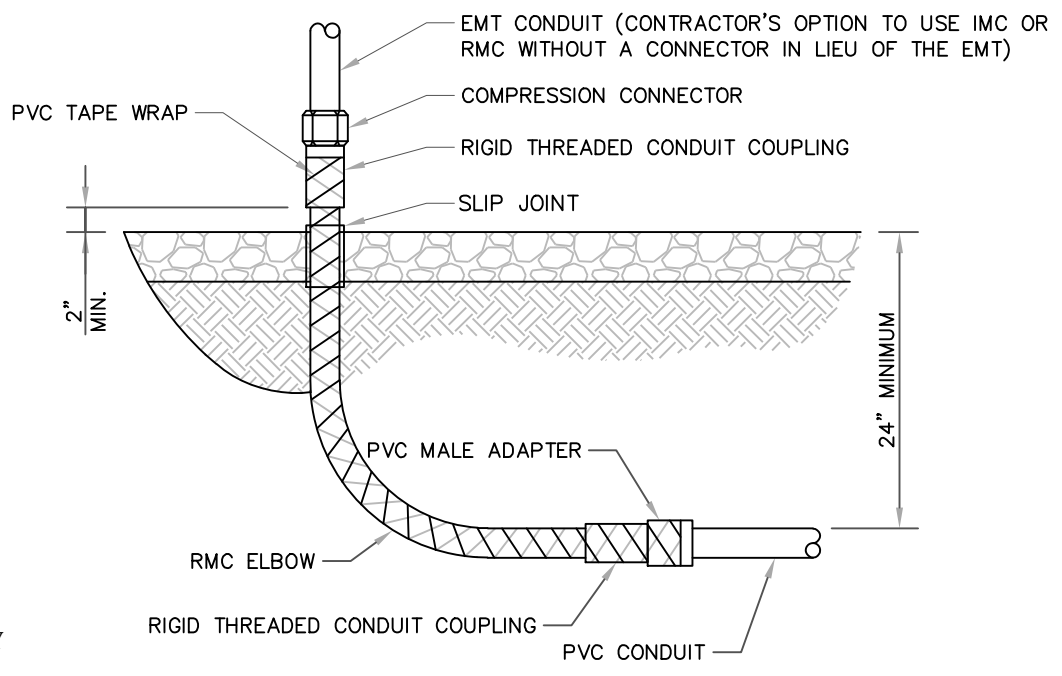

UNDERGROUND CONDUIT STUB UP
 SCALE: N.T.S.

ALL METAL CONDUIT INSTALLED IN DIRECT CONTACT WITH THE EARTH SHALL BE CONSIDERED TO BE INSTALLED IN A SEVERELY CORROSIVE ENVIRONMENT AND IS REQUIRED TO HAVE SUPPLEMENTAL PROTECTION AGAINST CORROSION (NEC ARTICLE 342.10(B) & 344.10(B)(1)). THIS PROTECTION SHALL EITHER BE AN APPROVED MANUFACTURER INSTALLED PROTECTIVE COATING ON THE CONDUIT OR SHALL BE (2) LAYERS OF 10 MIL PVC PIPE WRAP TAPE INSTALLED USING OPPOSING SPIRAL WRAPS. ON VERTICAL PIPE THE OUTSIDE LAYER OF TAPE SHALL BE WRAPPED SO AS TO PROVIDE SHEDDING OF WATER (i.e. TAPE SHOULD WRAP IN AN UPWARD DIRECTION WITH LOWER WRAP BEING BENEATH THE WRAP ABOVE). SPIRAL WRAPS SHALL HAVE A MINIMUM OF 1/4" OVERLAP WITH THE PRECEDING TAPE WRAP. ANY OTHER METHODS OF CORROSION PROTECTION SHALL REQUIRE APPROVAL BY THE ENGINEER OF RECORD PRIOR TO BEING USED.

APPLICANT:
T-Mobile
T-MOBILE NORTHEAST LLC
 35 GRIFFIN ROAD SOUTH
 BLOOMFIELD, CT 06002
 860-692-7100

PROJECT MANAGER
 NORTHEAST SITE SOLUTIONS
 Turnkey Wireless Development
 420 MAIN STREET, BLDG 4
 STURBRIDGE, MA 01566
 203-275-6669

CONSULTANT:
FORESITE LLC
 Architects · Engineers · Surveyors
 462 WALNUT STREET, SUITE 1
 NEWTON, MA 02460
 617-212-3123

THIS DOCUMENT IS THE DESIGN PROPERTY AND COPYRIGHT OF FORESITE, LLC. AND FOR THE EXCLUSIVE USE BY THE TITLE CLIENT. DUPLICATION OR USE WITHOUT THE EXPRESS WRITTEN CONSENT OF THE CREATOR IS STRICTLY PROHIBITED. DRAWING SCALES ARE INTENDED FOR 11"x17" SIZE PRINTED MEDIA ONLY. ALL OTHER PRINTED SIZES ARE DEEMED "NOT TO SCALE".

REV	DESCRIPTION	DATE
A	PRELIMINARY	12/27/21
0	FINAL ISSUED	02/07/22

SITE NUMBER: CT11220A
 SITE NAME: CHESHIRE/ RT-10
 SITE ADDRESS: 751 HIGGINS ROAD
 CHESHIRE, CT 06410

SHEET TITLE:
A-6: CONCRETE PAD AND UNDERGROUND CONDUIT DETAILS

Copyright © 2020 Foresite LLC all rights reserved. The details, templates, drawing formats or any portion of this document generated by Foresite LLC may not be duplicated, traced or used otherwise for any profit-driven enterprise.

GENERAL ELECTRICAL NOTES

1. ALL ELECTRICAL WORK SHALL CONFORM TO THE REQUIREMENTS OF THE NATIONAL ELECTRICAL CODE (NEC) AS WELL AS APPLICABLE STATE AND LOCAL CODES INCLUDING LATEST EDITIONS OF:

- NFPA - NATIONAL FIRE PROTECTION ASSOCIATION
- UL - UNDERWRITERS LABORATORIES
- NEC - 2017 NATIONAL ELECTRICAL CODE NEMA - NATIONAL ELECTRIC MANUFACTURERS ASSOCIATION
- OSHA - OCCUPATIONAL SAFETY AND HEALTH ACT
- IBC - 2015 INTERNATIONAL BUILDING CODE

2. ALL ELECTRICAL ITEMS SHALL BE U.L. APPROVED OR LISTED AND PRODUCED PER SPECIFICATION REQUIREMENTS.

3. THE ELECTRICAL WORK INCLUDES ALL LABOR AND MATERIAL DESCRIBED BY DRAWINGS AND SPECIFICATION INCLUDING INCIDENTAL WORK TO PROVIDE COMPLETE OPERATING AND APPROVED ELECTRICAL SYSTEM.

4. GENERAL CONTRACTOR SHALL PAY FEES FOR PERMITS, AND RESPONSIBLE FOR OBTAINING SAID PERMITS AND COORDINATION OF INSPECTIONS.

5. ELECTRICAL AND TELCO WIRING OUTSIDE A BUILDING AND EXPOSED TO WEATHER SHALL BE IN WATER TIGHT GALVANIZED RIGID STEEL CONDUITS OR SCHEDULE 80 PVC (AS PERMITTED BY CODE) AND WHERE REQUIRED IN LIQUID TIGHT FLEXIBLE METAL OR NONMETALLIC CONDUITS.

6. RIGID STEEL CONDUITS SHALL BE GROUNDED AT BOTH ENDS.

7. ELECTRICAL WIRING SHALL BE COPPER WITH TYPE XHHW, THWN, OR THIN INSULATION.

8. ALL EQUIPMENT LOCATED OUTSIDE SHALL HAVE NAME 3R ENCLOSURE.

9. GROUNDING SHALL COMPLY WITH NEC ART. 250.

10. GROUNDING COAX CABLE SHIELDS MINIMUM AT BOTH ENDS USING MANUFACTURERS COAX CABLE GROUNDING KITS SUPPLIED BY PROJECT OWNER.

11. USE #6 COPPER STRANDED WIRE WITH GREEN COLOR INSTALLATION FOR ABOVE GRADE GROUNDING (UNLESS OTHERWISE SPECIFIED) AND #2 SOLID TINNED BARE COPPER WIRE FOR BELOW GRADE GROUNDING AS INDICATED ON THE GROUND.

12. ALL GROUND CONNECTION TO BE BURNDY HYGROUND COMPRESSION TYPE CONNECTORS OR CADWELD EXOTHERMIC WELD. DO NOT ALLOW BARE COPPER WIRE TO BE IN CONTACT WITH GALVANIZED STEEL.

13. ROUTE GROUNDING CONDUCTORS ALONG THE SHORTEST AND STRAIGHTEST PATH POSSIBLE, EXCEPT AS OTHERWISE INDICATED. GROUNDING LEADS SHOULD NEVER BE BENT AS RIGHT ANGLE. ALWAYS MAKE AT LEAST 12" RADIUS BENDS. #6 WIRE CAN BE BENT AT 6" RADIUS WHEN NECESSARY BOND ANY METER OBJECTS WITHIN 7 FEET OF PROPOSED EQUIPMENT OR CABINET TO MASTER GROUND BAR.

14. CONNECTIONS TO MGB SHALL BE ARRANGED IN THREE MAIN GROUPS: SURGE PROCEDURES (COAXIAL CABLE GROUND KITS, TELCO AND POWER PANEL GROUND); (GROUNDING ELECTRODE RING OR BUILDING STEEL); NON-SURGING OBJECTS (EGB GROUND IN RBS UNIT).

15. CONNECTIONS TO GROUND BARS SHALL BE MADE WITH TWO HOLE COMPRESSION TYPE COPPER LUGS. APPLY OXIDE INHIBITING COMPOUND TO ALL LOCATIONS.

16. APPLY OXIDE INHIBITING COMPOUND TO ALL COMPRESSION TYPE GROUND CONNECTION.

17. TEST COMPLETED GROUND SYSTEM AND RECORD RESULTS FOR PROJECT CLOSE-OUT DOCUMENTATION.

18. BOND ANY METAL OBJECTS WITHIN 7 FEET OF PROPOSED EQUIPMENT OR CABINET TO MASTER GROUND BAR.

19. VERIFY PROPOSED SERVICE UPGRADE WITH LOCAL UTILITY COMPANY PRIOR TO CONSTRUCTION.

20. EXISTING UNDERGROUND UTILITY LOCATIONS ARE UNKNOWN. GENERAL CONTRACTOR SHALL HAND-EXCAVATE TO REQUIRED SUB-GRADE DEPTH, SUFFICIENT TEST HOLES OR AS DIRECTED / REQUIRED BY CONSTRUCTION MANAGER. ALL PROPOSED UNDERGROUND UTILITY TRENCHES SHALL BE HAND-EXCAVATE AS REQUIRED. GENERAL CONTRACTOR IS RESPONSIBLE FOR ANY REQUIRED SPECIAL TEMPORARY PROTECTION OF, PHYSICAL DAMAGE TO, OR REPAIR OF EXISTING UNDERGROUND CONDUIT INCLUDING RESTORATION OF SERVICE.

21. PROVIDE SLIP JOINS WHERE CONDUITS TRANSITION FROM UNDERGROUND TO ABOVE GROUND.

NOTES:

DIAGRAM AS SHOWN, IS A GENERIC ROUTING SCHEMATIC BASED ON AVAILABLE INFORMATION AND MAY NOT REPRESENT ACTUAL FIELD CONDITIONS. CONTRACTOR SHOULD INSTALL THE GENERATOR, EQUIPMENT AND CONNECTIONS BASED ON VERIFIED ELECTRICAL AUDITS AND PER MANUFACTURER'S INSTALLATION GUIDELINES AS WELL AS ALL APPLICABLE LOCAL AND NATIONAL CODES AND REQUIREMENTS.

GROUNDING NOTES:

1. GROUNDING SHALL COMPLY WITH NEC ART. 250 AND MANUFACTURER'S RECOMMENDATIONS. TIE INTO THE EXISTING GROUNDING SYSTEM.
2. CONTRACTOR SHALL INSTALL GROUND RODS ON ALL UNDERGROUND GROUNDING RUNS LONGER THAN 10'. GROUND RODS WILL BE INSTALLED ON 20' CENTERS MAXIMUM.
3. ALL DOWN CONDUCTORS MUST GO DOWN PER NFPA 780.
4. CONTRACTOR SHALL NOTIFY THE CONSTRUCTION MANAGER WHEN THE GROUNDING SYSTEM IS COMPLETE. THE CONSTRUCTION MANAGER SHALL INSPECT THE GROUNDING SYSTEM PRIOR TO BACKFILLING.
5. CONTRACTOR MY USE EXISTING CONDUITS AND CONDUCTORS PROVIDED THEY ARE IN GOOD CONDITION AND ARE SUFFICIENTLY RATED.

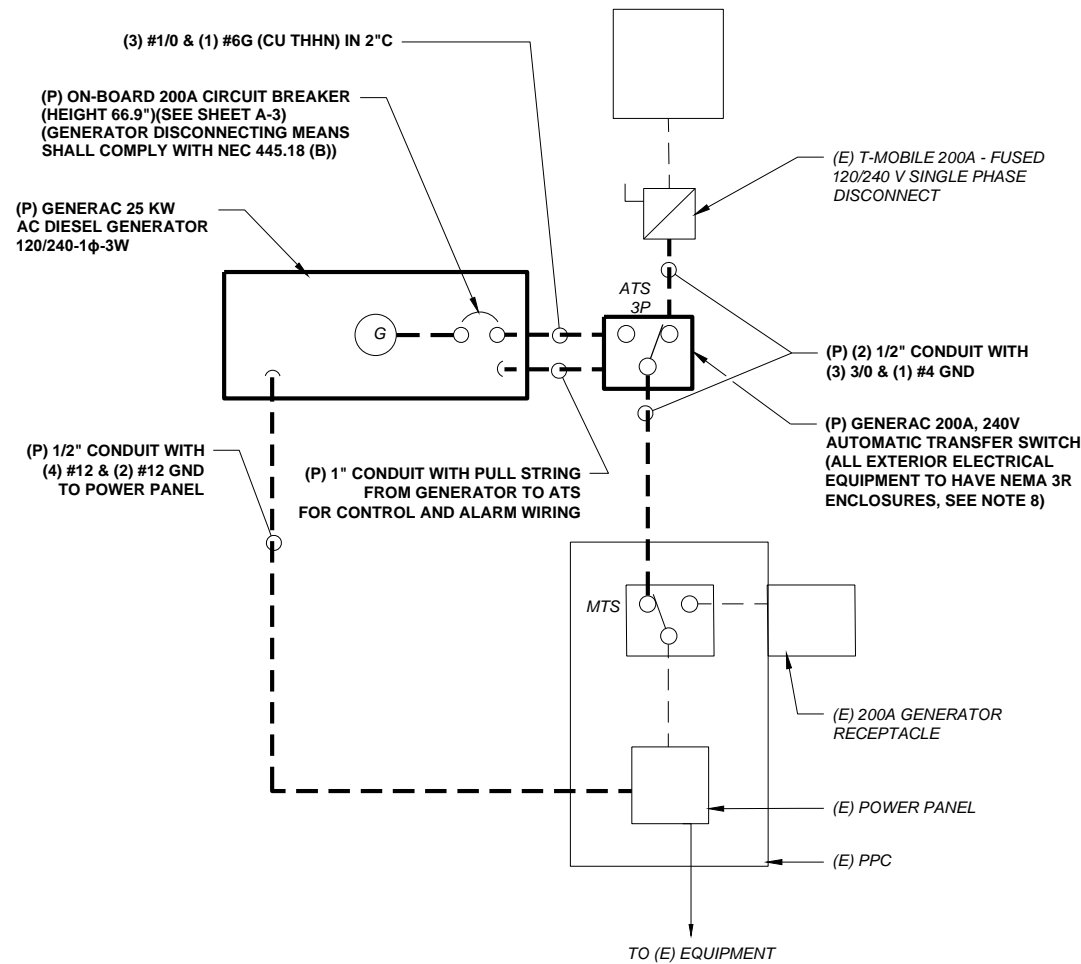

TYP. ONE LINE DIAGRAM
FIELD VERIFY

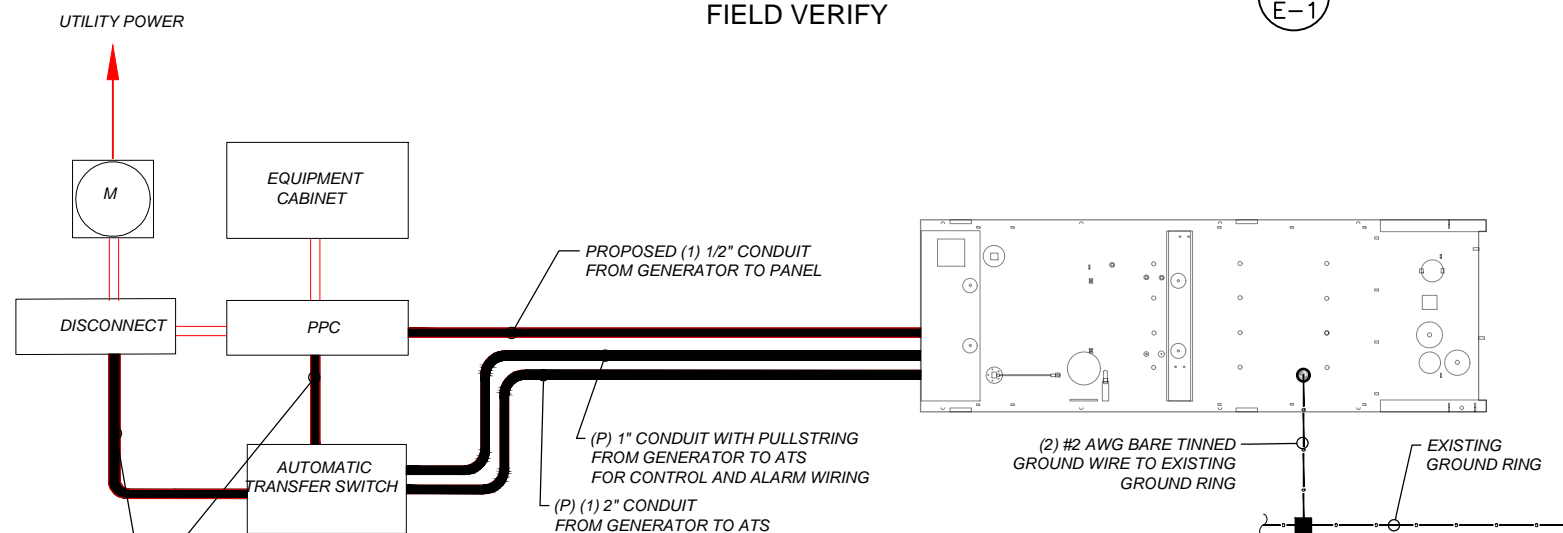

ELECTRICAL ROUTING DIAGRAM
SCALE: N.T.S

APPLICANT:
T-Mobile
T-MOBILE NORTHEAST LLC
35 GRIFFIN ROAD SOUTH
BLOOMFIELD, CT 06002
860-692-7100

PROJECT MANAGER
NORTHEAST SITE SOLUTIONS
Tertiary Wireless Development
420 MAIN STREET, BLDG 4
STURBRIDGE, MA 01566
203-275-6669

CONSULTANT:
FORESITE LLC
Architects . Engineers . Surveyors
462 WALNUT STREET, SUITE 1
NEWTON, MA 02460
617-212-3123

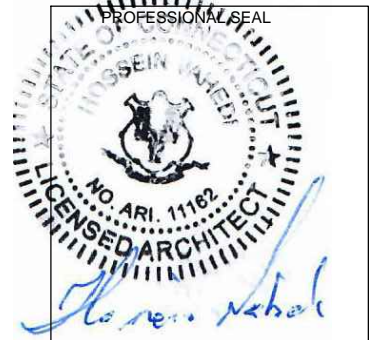

THIS DOCUMENT IS THE DESIGN PROPERTY AND COPYRIGHT OF FORESITE, LLC. AND FOR THE EXCLUSIVE USE BY THE TITLE CLIENT. DUPLICATION OR USE WITHOUT THE EXPRESS WRITTEN CONSENT OF THE CREATOR IS STRICTLY PROHIBITED. DRAWING SCALES ARE INTENDED FOR 11"x17" SIZE PRINTED MEDIA ONLY. ALL OTHER PRINTED SIZES ARE DEEMED "NOT TO SCALE".

REV	DESCRIPTION	DATE
A	PRELIMINARY	12/27/21
0	FINAL ISSUED	02/07/22

SITE NUMBER: CT11220A
SITE NAME: CHESHIRE/ RT-10
SITE ADDRESS: 751 HIGGINS ROAD
CHESHIRE, CT 06410

SHEET TITLE:
E-1: ELECTRICAL DETAILS

Copyright © 2020 Foresite LLC all rights reserved. The details, templates, drawing formats or any portion of this document generated by Foresite LLC may not be duplicated, traced or used otherwise for any profit-driven enterprise.

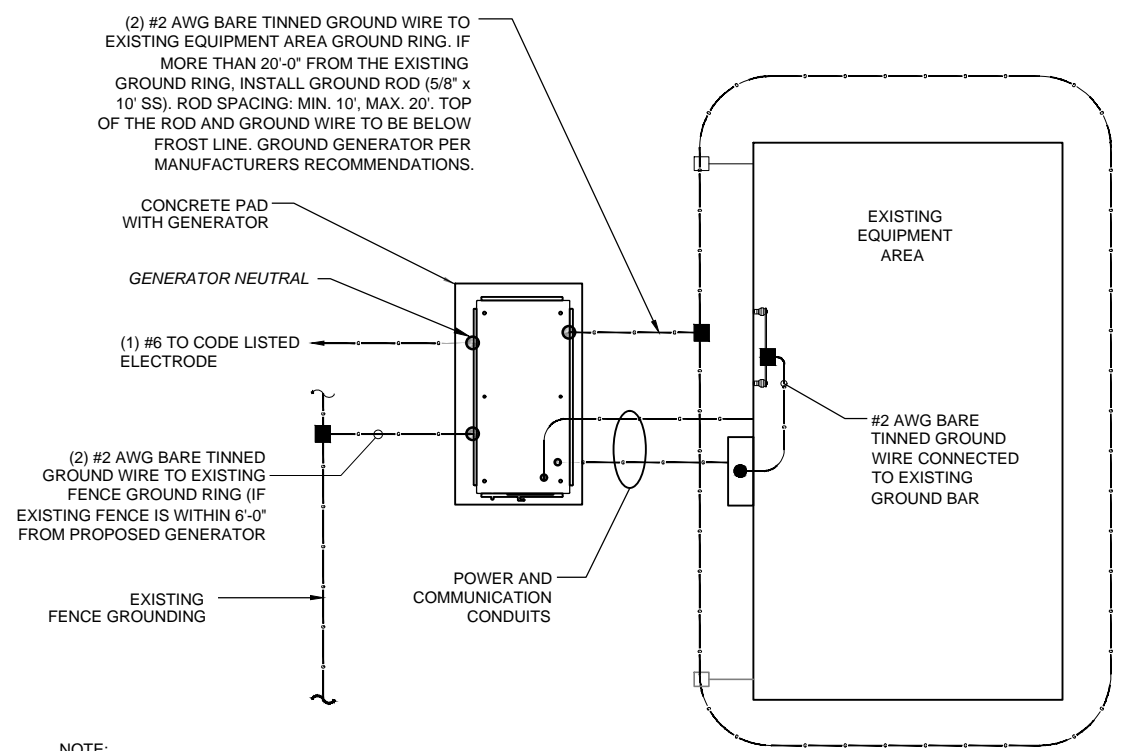

NOTE:
 1- PROVIDE GENERATOR NEUTRAL GROUND AS A SEPARATELY- DERIVED SYSTEM PER NEC / NFPA 70 - 250.30A.
 2- FOR ACTUAL ORIENTATION OF GENERATOR, PAD, FENCE, TOWER & UNDER GROUND POWER/TELCO SEE PAGE A-1.

GROUND PLAN 1
 NTS G-1

NOTES:

1. CONNECTION SHALL BE COVERED BY NO LESS THAN 2" OF CONCRETE.
2. ATTEMPT TO MAKE CONNECTION TO A 6'-0" RUN OF REBAR OR GREATER.
3. APPLY HEAT SHRINK OR ELECTRICAL TAPE AROUND THE CONDUCTOR TO AVOID CORROSION.

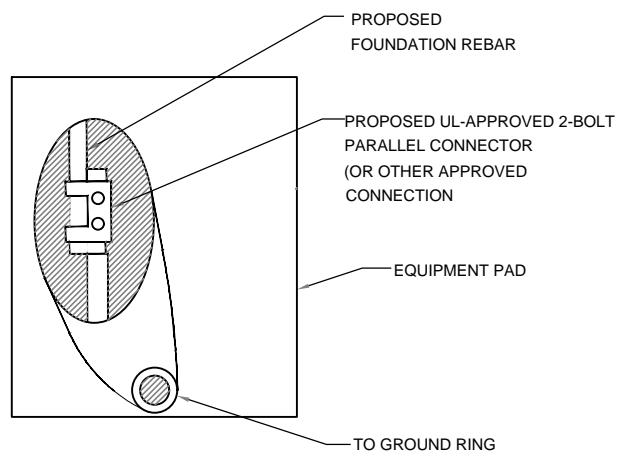

EQUIPMENT PAD GROUNDING 2
 NTS G-1

NOTE:
 CONTRACTOR TO USE CLEAR OR GRAY SILICONE AS NECESSARY TO SEAL LIQUID TIGHT FLEXIBLE NON-METALLIC CONDUIT.

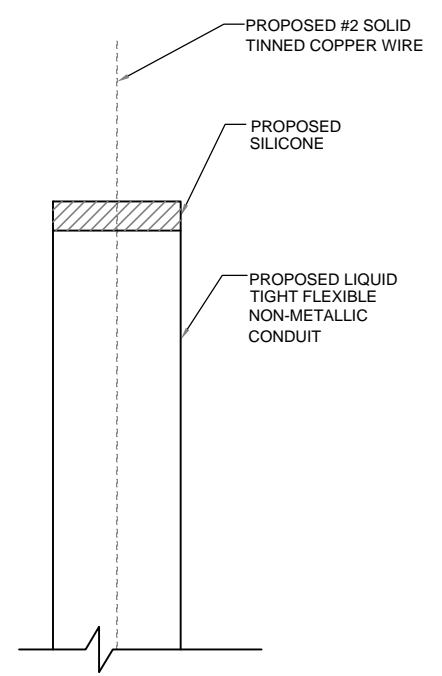

GROUND WIRE WEATHERPROOFING 3
 NTS G-1

APPLICANT:
T-Mobile
T-MOBILE NORTHEAST LLC
 35 GRIFFIN ROAD SOUTH
 BLOOMFIELD, CT 06002
 860-692-7100

PROJECT MANAGER

 420 MAIN STREET, BLDG 4
 STURBRIDGE, MA 01566
 203-275-6669

CONSULTANT:
FORESITE LLC
 Architects . Engineers . Surveyors
 462 WALNUT STREET, SUITE 1
 NEWTON, MA 02460
 617-212-3123



THIS DOCUMENT IS THE DESIGN PROPERTY AND COPYRIGHT OF FORESITE, LLC. AND FOR THE EXCLUSIVE USE BY THE TITLE CLIENT. DUPLICATION OR USE WITHOUT THE EXPRESS WRITTEN CONSENT OF THE CREATOR IS STRICTLY PROHIBITED. DRAWING SCALES ARE INTENDED FOR 11"x17" SIZE PRINTED MEDIA ONLY. ALL OTHER PRINTED SIZES ARE DEEMED "NOT TO SCALE".

REV	DESCRIPTION	DATE
A	PRELIMINARY	12/27/21
0	FINAL ISSUED	02/07/22

SITE NUMBER: CT11220A
 SITE NAME: CHESHIRE/ RT-10
 SITE ADDRESS: 751 HIGGINS ROAD
 CHESHIRE, CT 06410

SHEET TITLE:
 G-1: GROUNDING DETAILS

Exhibit D

RD048 | 3.4L | 48 kW

INDUSTRIAL DIESEL GENERATOR SET

EPA Certified Stationary Emergency

Standby Power Rating

48 kW, 60 kVA, 60 Hz



Image used for illustration purposes only



Codes and Standards

Not all codes and standards apply to all configurations.
Contact factory for details.

 UL2200, UL508, UL489, UL142

 CSA 22.2

 BS5514 and DIN 6271

 SAE J1349

 NFPA 37, 70, 99

 ISO 3046, 8528, 9001

 NEMA ICS1, ICS10, MG1, 250, ICS6, AB1

 ANSI/IEEE C62.41

Powering Ahead

For over 50 years, Generac has led the industry with innovative design and superior manufacturing.

Generac ensures superior quality by designing and manufacturing most of its generator components, including alternators, enclosures and base tanks, control systems and communications software.

Generac's gensets utilize a wide variety of options, configurations and arrangements, allowing us to meet the standby power needs of practically every application.

Generac searched globally to ensure the most reliable engines power our generators. We choose only engines that have already been proven in heavy-duty industrial application under adverse conditions.

Generac is committed to ensuring our customers' service support continues after their generator purchase.

Standard Features

ENGINE SYSTEM

- Cold Weather Kit
- Oil Drain Extension
- Fan Guard
- Stainless Steel Flexible Exhaust Connection
- Factory Filled Oil & Coolant

Fuel System

- Primary Fuel Filter

Cooling System

- Closed Coolant Recovery System
- Factory-Installed Radiator
- 50/50 Ethylene Glycol Antifreeze
- Radiator Drain Extension
- Can Operate at up to 122°F (50°C) Ambient Temperature

Electrical System

- Battery Charging Alternator
- Battery Cables
- Battery Tray
- Rubber-Booted Engine Electrical Connections
- Solenoid Activated Starter Motor
- Smart Battery Charger

ALTERNATOR SYSTEM

- Class H Insulation Material
- 2/3 Pitch
- Skewed Stator
- Sealed Bearings
- Low Temperature Rise (<120°C)
- Low THD (<5%)

GENERATOR SET

- Sound Attenuated Aluminum Enclosure
- Internal Genset Vibration Isolation
- Separation of Circuits - High/Low Voltage
- Wrapped Exhaust Piping
- Standard Factory Testing
- 5 Year Limited Warranty
- Ready to Accept Full Load in <10 Seconds
- E-Stop

TANKS

- 48 Hour Run Time Tank
- UL 142 Listed Tank

CONTROL SYSTEM



Evolution™ Controller

- Two-Line Plain Text LCD Display
- Programmable Start Delay Between 10-30 seconds
- 10 second Engine Start Sequence
- 5 second Engine Warm Up
- 1 minute Engine Cool-Down
- Starter Lock-Out
- Smart Battery Charger
- Automatic Voltage Regulation with Over and Under Protection
- Automatic Low Oil Pressure Shutdown
- Overspeed Shutdown
- High Temperature Shutdown
- Overcrank Protection
- Safety Fused
- Failure to Transfer Protection
- Low Battery Protection
- 50 Even Run Log
- Future Set Capable Exerciser
- Incorrect Wiring Protection
- Internal Fault Protection
- Common External Fault Capability
- Governor Failure Protection

Optional Shipped Loose and Field Install Kits

GENERATOR SET

- Paint Kit
- Scheduled Maintenance Kit

CONTROL SYSTEM

- Mobile Link™ and Adapter Kit

TANKS

- Spill Box
- 90% Fuel Alarm
- Tank Risers
- Spill Box Drainback Kit
- Vent Extension Support Kit
- 5 Day Run Time Tank
- Overfill Prevention Valve
- Fuel Fill Drop Tube
- Lockable Fuel Cap

RD048 | 3.4L | 48 kW

INDUSTRIAL DIESEL GENERATOR SET

EPA Certified Stationary Emergency

APPLICATION AND ENGINEERING DATA

ENGINE SPECIFICATIONS

General

Make	Generac
Cylinder #	4
Type	In-Line
Displacement - in ³ (L)	3.4 (207.48)
Bore - in (mm)	3.86 (98)
Stroke - in (mm)	4.45 (113)
Compression Ratio	18.5:1
Intake Air Method	Turbocharged/Aftercooled
Cylinder Head	Cast Iron OHV
Piston Type	Aluminum

Engine Governing

Governor	Electronic
Frequency Regulation (Steady State)	±0.25%

Lubrication System

Oil Pump Type	Gear
Oil Filter Type	Full Flow Spin-On Canister
Crankcase Capacity with Filters- qt (L)	7.4 (7.0)

Cooling System

Cooling System Type	Closed Recovery
Fan Type	Pusher
Fan Speed- rpm	2,029
Fan Diameter - in (mm)	22 (559)

Fuel System

Fuel Type	Ultra Low Sulfur Diesel Fuel
Fuel Specification	ASTM
Fuel Pump Type	Mechanical Engine Driven Gear
Injector Type	Mechanical
Fuel Supply Lin (mm/in)	7.94/0.31 (ID)
Fuel Return Line (mm/in)	7.94/0.31 (ID)
Fuel Filtering (microns)	25

Engine Electrical System

System Voltage	12 VDC
Battery Charger Alternator	Standard
Battery Size	Group 27F
Battery Voltage	12 VDC
Ground Polarity	Negative

ALTERNATOR SPECIFICATIONS

Standard Model	Generac
Poles	4
Field Type	Rotating
Insulation Class - Rotor	H
Insulation Class - Stator	H
Total Harmonic Distortion	<5%
Telephone Interference Factor (TIF)	<50

Standard Excitation	Direct
Bearings	Single Sealed
Coupling	Flexible Disc
Prototype Short Circuit Test	Yes
Voltage Regulator Type	Full Digital
Number of Sensed Phases	2
Regulation Accuracy (Steady State)	±1.0%

RD048 | 3.4L | 48 kW
INDUSTRIAL DIESEL GENERATOR SET
 EPA Certified Stationary Emergency

OPERATING DATA

POWER RATINGS

		Standby
Single-Phase 120/480 VAC @0.1pf	48 kW	Amps: 200

MOTOR STARTING CAPABILITIES (sKVA)

sKVA vs. Voltage Dip at 30%

120/240 V, Single-Phase at 0.4pf	189
----------------------------------	-----

FUEL CONSUMPTION RATES*

Percent Load	Diesel gal/hr (L/hr)
25%	1.35 (5.11)
50%	2.15 (8.14)
75%	3.06 (11.58)
100%	3.98 (15.07)

* Fuel supply installation must accommodate fuel consumption rates at 100% load.

COOLING

		Standby
Air Flow (Radiator and Alternator)	ft ³ /min (m ³ /min)	2824 (80)
Coolant System Capacity	gal (L)	2.8 (10.6)
Heat Rejection to Coolant	BTU/hr (MJ/hr)	135,900 (143.4)
Temperature Deration	3% for every 5°C above 25°C or 1.7% for every 5°F over 77°F	
Altitude Deration	1% for every 100 m above 915 or 3% for every 1000 ft over 3000 ft	
Maximum Radiator Backpressure	in H ₂ O (kPa)	0.50 (0.12)

COMBUSTION AIR REQUIREMENTS

	Standby
Flow at Rated Power ft ³ /min (m ³ /min)	190 (5.38)

ENGINE

EXHAUST

ENGINE			EXHAUST		
		Standby			Standby
Rated Engine Speed	rpm	1,800	Exhaust Flow (Rated Output)	ft ³ /min (m ³ /min)	448 (12.7)
Horsepower at rated kW	HP	85	Exhaust Temp (Rated Output - Post Silencer)	°F (°C)	1120 (604.4)

Deration – Operational characteristics consider maximum ambient conditions. Derate factors may apply under atypical site conditions.
 Please consult a Generac Power Systems Industrial Dealer for additional details. All performance ratings in accordance with ISO3046, BS5514, ISO8528 and DIN6271 standards.
 Standby - See Bulletin 0187500SSB

DIMENSIONS AND WEIGHTS*

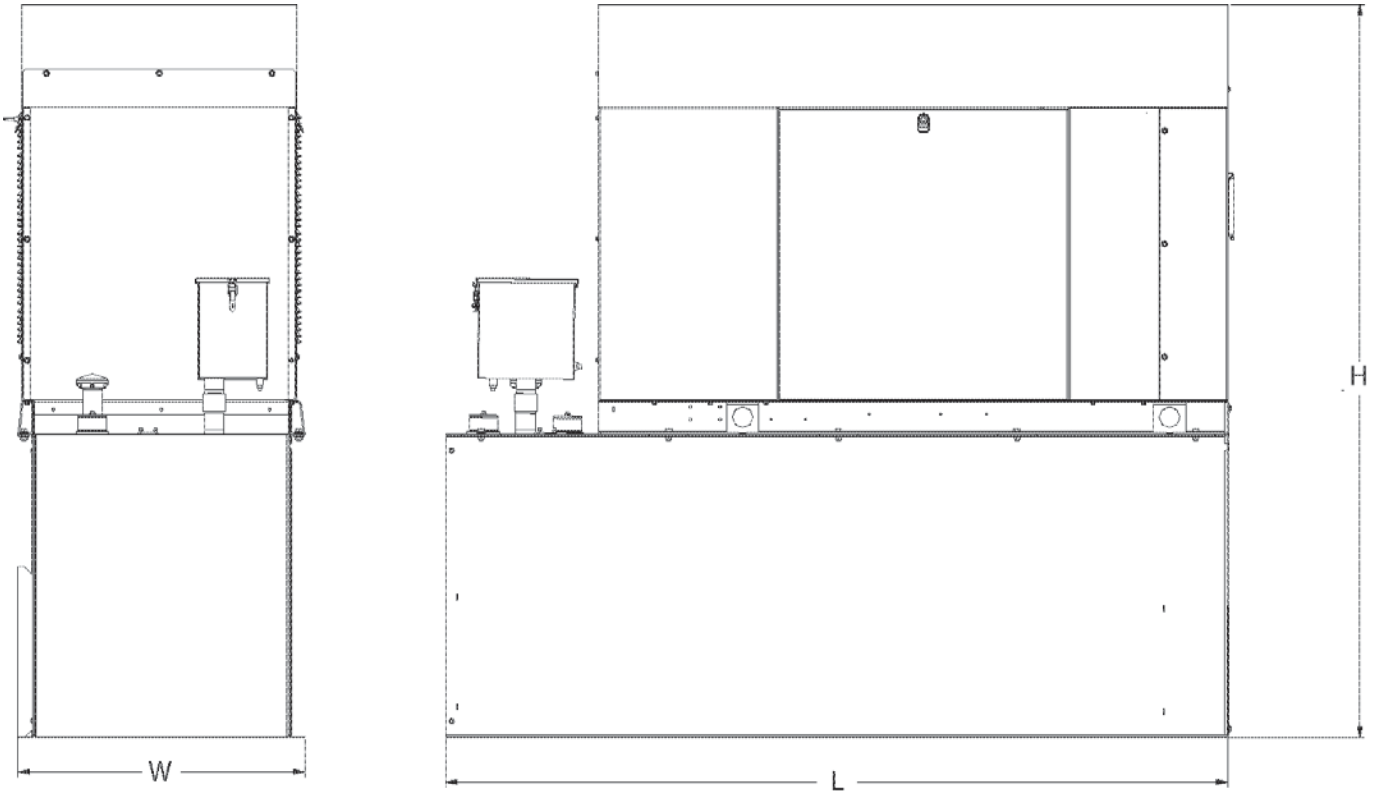

ENCLOSED UNIT with 48hour Tank

L x W x H in (mm)	95.4 (2,422) x 35.0 (880) x 89.3 (2,269)
Sound output in dB(A) at 23ft with generator operating at normal Load	65

* All measurements are approximate and for estimation purposes only.

YOUR FACTORY RECOGNIZED GENERAC INDUSTRIAL DEALER

Specification characteristics may change without notice. Dimensions and weights are for preliminary purposes only. Please consult a Generac Power Systems Industrial Dealer for detailed installation drawings.

Exhibit E



**UNITED STATES
POSTAL SERVICE®**

Click-N-Ship®

P

usps.com 9405 5036 9930 0162 8366 76 0089 5000 0010 6410
US POSTAGE
 Flat Rate Env
 02/10/2022

U.S. POSTAGE PAID
click-n-ship®

Mailed from 01566

PRIORITY MAIL 2-DAY™

Expected Delivery Date: 02/14/22
 Ref#: 11220-NHP
0006

C010

SHIP TO: SEAN KIMBALL
 TOWN MANAGER- TOWN OF CHESHIRE
 84 S MAIN ST
 CHESHIRE CT 06410-3108

USPS TRACKING #



9405 5036 9930 0162 8366 76

Electronic Rate Approved #038555749



Cut on dotted line.

Instructions

1. Each Click-N-Ship® label is unique. Labels are to be used as printed and used only once. DO NOT PHOTO COPY OR ALTER LABEL.
2. Place your label so it does not wrap around the edge of the package.
3. Adhere your label to the package. A self-adhesive label is recommended. If tape or glue is used, DO NOT TAPE OVER BARCODE. Be sure all edges are secure.
4. To mail your package with PC Postage®, you may schedule a Package Pickup online, hand to your letter carrier, take to a Post Office™, or drop in a USPS collection box.
5. Mail your package on the "Ship Date" you selected when creating this label.

Click-N-Ship® Label Record

USPS TRACKING # :
9405 5036 9930 0162 8366 76

Trans. #: 556298236	Priority Mail® Postage: \$8.95
Print Date: 02/10/2022	Total: \$8.95
Ship Date: 02/10/2022	
Expected Delivery Date: 02/14/2022	

From: DEBORAH CHASE Ref#: 11220-NHP
 NORTHEAST SITE SOLUTIONS
 420 MAIN ST
 STE 1
 STURBRIDGE MA 01566-1359

To: SEAN KIMBALL
 TOWN MANAGER- TOWN OF CHESHIRE
 84 S MAIN ST
 CHESHIRE CT 06410-3108

* Retail Pricing Priority Mail rates apply. There is no fee for USPS Tracking® service on Priority Mail service with use of this electronic rate shipping label. Refunds for unused postage paid labels can be requested online 30 days from the print date.



Thank you for shipping with the United States Postal Service!
 Check the status of your shipment on the USPS Tracking® page at usps.com

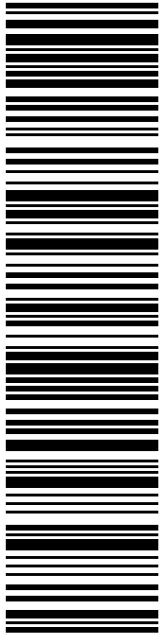

USPS TRACKING #

9405 5036 9930 0162 8366 83

Electronic Rate Approved #038555749

SHIP

TO: MICHAEL GLIDDEN
CHESHIRE TOWN PLANNER
84 S MAIN ST
CHESHIRE CT 06410-3108

SHIP

DEBORAH CHASE
NORTHEAST SITE SOLUTIONS
420 MAIN ST
STE 1
STURBRIDGE MA 01566-1359

C010

P

PRIORITY MAIL 2-DAY™

usps.com 9405 5036 9930 0162 8366 83 0089 5000 0010 6410

US POSTAGE \$8.95

Flat Rate Env

02/10/2022

Mailed from 01566



Expected Delivery Date: 02/14/22

Ref#: 11220A-NHP

0006

USPS TRACKING # :

9405 5036 9930 0162 8366 83

<p style="font-size: 0.8em; margin: 0;">Trans. #: 556298236</p> <p style="font-size: 0.8em; margin: 0;">Print Date: 02/10/2022</p> <p style="font-size: 0.8em; margin: 0;">Ship Date: 02/10/2022</p> <p style="font-size: 0.8em; margin: 0;">Expected Delivery Date: 02/14/2022</p>	<p style="font-size: 0.8em; margin: 0;">Priority Mail® Postage: \$8.95</p> <p style="font-size: 0.8em; margin: 0;">Total: \$8.95</p>
---	--

From: DEBORAH CHASE
NORTHEAST SITE SOLUTIONS
420 MAIN ST
STE 1
STURBRIDGE MA 01566-1359

To: MICHAEL GLIDDEN
CHESHIRE TOWN PLANNER
84 S MAIN ST
CHESHIRE CT 06410-3108

Ref#: 11220A-NHP



Cut on dotted line.

Instructions

1. Each Click-N-Ship® label is unique. Labels are to be used as printed and used only once. DO NOT PHOTO COPY OR ALTER LABEL.
2. Place your label so it does not wrap around the edge of the package.
3. Adhere your label to the package. A self-adhesive label is recommended. If tape or glue is used, DO NOT TAPE OVER BARCODE. Be sure all edges are secure.
4. To mail your package with PC Postage®, you may schedule a Package Pickup online, hand to your letter carrier, take to a Post Office™, or drop in a USPS collection box.
5. Mail your package on the "Ship Date" you selected when creating this label.

Click-N-Ship® Label Record

USPS TRACKING # :

9405 5036 9930 0162 8366 83

<p style="font-size: 0.8em; margin: 0;">Trans. #: 556298236</p> <p style="font-size: 0.8em; margin: 0;">Print Date: 02/10/2022</p> <p style="font-size: 0.8em; margin: 0;">Ship Date: 02/10/2022</p> <p style="font-size: 0.8em; margin: 0;">Expected Delivery Date: 02/14/2022</p>	<p style="font-size: 0.8em; margin: 0;">Priority Mail® Postage: \$8.95</p> <p style="font-size: 0.8em; margin: 0;">Total: \$8.95</p>
---	--

From: DEBORAH CHASE
NORTHEAST SITE SOLUTIONS
420 MAIN ST
STE 1
STURBRIDGE MA 01566-1359

To: MICHAEL GLIDDEN
CHESHIRE TOWN PLANNER
84 S MAIN ST
CHESHIRE CT 06410-3108

Ref#: 11220A-NHP

* Retail Pricing Priority Mail rates apply. There is no fee for USPS Tracking® service on Priority Mail service with use of this electronic rate shipping label. Refunds for unused postage paid labels can be requested online 30 days from the print date.



Thank you for shipping with the United States Postal Service!
Check the status of your shipment on the USPS Tracking® page at usps.com

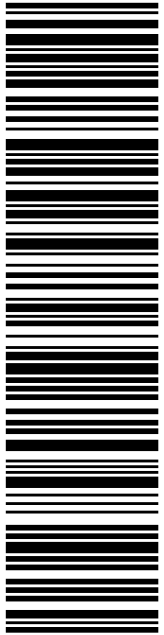

USPS TRACKING #

9405 5036 9930 0162 8366 90

Electronic Rate Approved #038555749

SHIP TO:

AT&T
PO BOX 7207
BEDMINSTER NJ 07921-7207

P

US POSTAGE
Flat Rate Env
\$8.95

U.S. POSTAGE PAID
Click-N-Ship®

Mailed from 01566

PRIORITY MAIL 2-DAY™

Expected Delivery Date: 02/14/22
Ref#: 11220A-NHP
0006

B011

DEBORAH CHASE
NORTHEAST SITE SOLUTIONS
420 MAIN ST
STE 1
STURBRIDGE MA 01566-1359

UNITED STATES POSTAL SERVICE®

Click-N-Ship®



Cut on dotted line.

Instructions

1. Each Click-N-Ship® label is unique. Labels are to be used as printed and used only once. DO NOT PHOTO COPY OR ALTER LABEL.
2. Place your label so it does not wrap around the edge of the package.
3. Adhere your label to the package. A self-adhesive label is recommended. If tape or glue is used, DO NOT TAPE OVER BARCODE. Be sure all edges are secure.
4. To mail your package with PC Postage®, you may schedule a Package Pickup online, hand to your letter carrier, take to a Post Office™, or drop in a USPS collection box.
5. Mail your package on the "Ship Date" you selected when creating this label.

Click-N-Ship® Label Record

USPS TRACKING # :
9405 5036 9930 0162 8366 90

Trans. #: 556298236	Priority Mail® Postage: \$8.95
Print Date: 02/10/2022	Total: \$8.95
Ship Date: 02/10/2022	
Expected Delivery Date: 02/14/2022	

From: DEBORAH CHASE
NORTHEAST SITE SOLUTIONS
420 MAIN ST
STE 1
STURBRIDGE MA 01566-1359

Ref#: 11220A-NHP

To: AT&T
PO BOX 7207
BEDMINSTER NJ 07921-7207

* Retail Pricing Priority Mail rates apply. There is no fee for USPS Tracking® service on Priority Mail service with use of this electronic rate shipping label. Refunds for unused postage paid labels can be requested online 30 days from the print date.



Thank you for shipping with the United States Postal Service!
Check the status of your shipment on the USPS Tracking® page at usps.com

ET112201A



FARMINGTON
210 MAIN ST
FARMINGTON, CT 06032-9998
(800)275-8777

02/11/2022

08:35 AM

Product	Qty	Unit Price	Price
Prepaid Mail Bedminster, NJ 07921 Weight: 0 lb 3.80 oz Acceptance Date: Fri 02/11/2022 Tracking #: 9405 5036 9930 0162 8366 90	1		\$0.00
Prepaid Mail Cheshire, CT 06410 Weight: 0 lb 3.80 oz Acceptance Date: Fri 02/11/2022 Tracking #: 9405 5036 9930 0162 8366 76	1		\$0.00
Prepaid Mail Cheshire, CT 06410 Weight: 0 lb 3.80 oz Acceptance Date: Fri 02/11/2022 Tracking #: 9405 5036 9930 0162 8366 83	1		\$0.00
Grand Total:			\$0.00

USPS is experiencing unprecedented volume increases and limited employee availability due to the impacts of COVID-19. We appreciate your patience.

Preview your Mail
Track your Packages
Sign up for FREE @
<https://informeddelivery.usps.com>

All sales final on stamps and postage.
Refunds for guaranteed services only.
Thank you for your business.

Tell us about your experience.
Go to: <https://postalexperience.com/Pos>
or scan this code with your mobile device.



or call 1-800-410-7420.