

280 Trumbull Street
Hartford, CT 06103-3597
Main (860) 275-8200
Fax (860) 275-8299
kbaldwin@rc.com
Direct (860) 275-8345

July 26, 2012

Linda Roberts
Executive Director
Connecticut Siting Council
10 Franklin Square
New Britain, CT 06051



Re: **Notice of Exempt Modification – Back-Up Generator Fuel Tank Upgrade
Carmen Hill Road, Brookfield, Connecticut**

Dear Ms. Roberts:

Cellco Partnership d/b/a Verizon Wireless (“Cellco”) currently maintains a wireless telecommunications facility at the above-referenced address. Cellco’s facility consists of antennas on an existing 80-foot self-supporting lattice tower; an equipment shelter; a pad-mounted propane-fueled generator; and a 500 gallon propane tank.

In an effort to improve the reliability of the back-up power supply and further enhance overall network reliability, Cellco intends to modify this facility by replacing the existing 500 gallon propane tank with a new 1,000 gallon propane tank in the northeast corner of the fenced compound. (See Compound Plan Sheet C-1, attached).

Please accept this letter as notification pursuant to R.C.S.A. § 16-50j-73, for construction that constitutes an exempt modification pursuant to R.C.S.A. § 16-50j-72(b)(2). In accordance with R.C.S.A. § 16-50j-73, a copy of this letter is being sent to William R. Davidson, First Selectman of the Town of Brookfield. The Town of Brookfield is the owner of the property on which the existing telecommunications facility is located.

The planned modifications to the Cellco facility fall squarely within those activities explicitly provided for in R.C.S.A. § 16-50j-72(b)(2).

1. The proposed modifications will not result in an increase in the height of the existing tower.



Law Offices

BOSTON

PROVIDENCE

HARTFORD

NEW LONDON

STAMFORD

WHITE PLAINS

NEW YORK CITY

ALBANY

SARASOTA

www.rc.com

11788706-v1

ROBINSON & COLE_{LLP}

Linda Roberts
July 26, 2012
Page 2

2. The 1,000 gallon propane tank will be located within the limits of the existing fenced compound. The modifications, therefore, will not require the extension of the site boundary.

3. The proposed modifications will not increase noise levels at the facility by six decibels or more.

4. The installation of a new 1,000 gallon propane tank will not change, in any way, radio frequency (RF) emissions at the facility.

For the foregoing reasons, Cellco respectfully submits that the proposed modifications to the above-referenced telecommunications facility constitutes an exempt modification under R.C.S.A. § 16-50j-72(b)(2).

Sincerely,



Kenneth C. Baldwin

Enclosures

Copy to:

William R. Davidson, Brookfield First Selectman
Sandy M. Carter



Cellco Partnership

d.b.a. **verizon**wireless

WIRELESS COMMUNICATIONS FACILITY

BROOKFIELD, CT

33 CARMEN HILL ROAD

BROOKFIELD, CT 06804

SITE DIRECTIONS

FROM: 99 EAST RIVER DRIVE
EAST HARTFORD, CONNECTICUT TO: 33 CARMEN HILL ROAD,
BROOKFIELD, CT 06804

1. Head east on E River Dr toward Darlin St 0.3 mi
2. Continue onto Ash St 0.2 mi
3. Turn left onto Connecticut Blvd 0.3 mi
4. Turn left to merge onto I-84 W toward Hartford/I-91 51.2 mi
5. Take exit 9 for CT-25 toward Brookfield 0.3 mi
6. Turn right onto CT-25 N/Hawleyville Rd, Continue to follow CT-25 N 5.2 mi
7. At 6 Nicoles Street Brookfiel, Conn 06804, continue onto Station Rd 0.2 mi
8. Turn right onto Laurel Hill Rd 0.2 mi
9. Slight left onto N Mountain Rd 0.8 mi
10. Take the 1st right onto Carmen Hill Rd 0.5 mi

PROJECT SCOPE

1. THE PROPOSED SCOPE OF WORK GENERALLY INCLUDES THE INSTALLATION OF A OF CELLCO PARTNERSHIP 1000 GAL. PROPANE TANK ON A 5'x18' CONC. PAD WITHIN EXISTING CELLCO PARTNERSHIP LEASE AREA AND REMOVAL OF EXISTING CELLCO PARTNERSHIP'S 500 GAS PROPANE TANK AND ASSOCIATED CONCRETE PAD.

VICINITY MAP

SCALE: 1" = 1000'

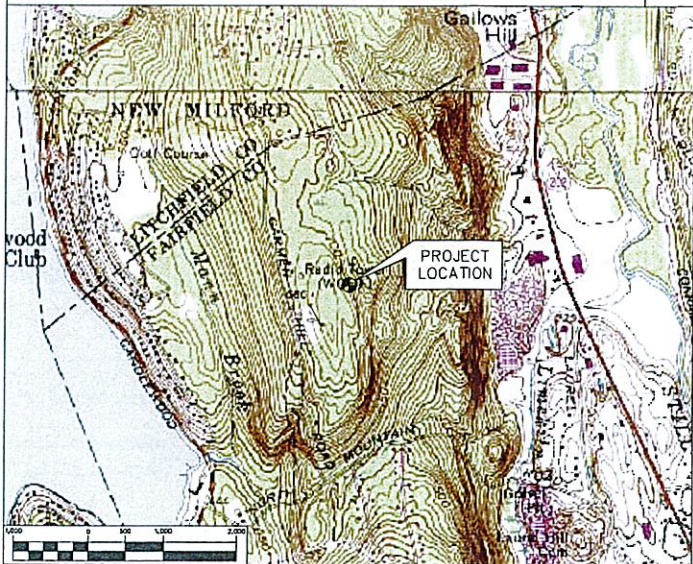

PROJECT SUMMARY

SITE NAME: BROOKFIELD, CT

SITE ADDRESS: 33 CARMEN HILL ROAD
BROOKFIELD, CT 06804

LESSEE/CELLCO PARTNERSHIP: CELLCO PARTNERSHIP
d.b.a. VERIZON WIRELESS
99 EAST RIVER DRIVE
EAST HARTFORD, CT 06108

CONTACT PERSON: SANDY CARTER
CELLCO PARTNERSHIP
d.b.a. VERIZON WIRELESS
99 EAST RIVER DRIVE
EAST HARTFORD, CT 06108

ENGINEER: CENTEK ENGINEERING, INC.
63-2 NORTH BRANFORD ROAD
BRANFORD, CT 06405
(203) 488-0580

TOWER COORDINATES: LATITUDE 41°-29'-34.56"
LONGITUDE 73°-25'-38.3"
GROUND ELEVATION: 700'± A.M.S.L.

COORDINATES ARE REFERENCED FROM CONNECTICUT SITING COUNCIL DATABASE AND GROUND ELEVATION BASED ON TOPO MAP.

SHEET INDEX

SHT. NO.	DESCRIPTION	REV. NO.
T-1	TITLE SHEET	0
C-1	COMPOUND PLAN	0

DESIGNED BY: FLO	CHK'D BY: CFC	ISSUED FOR CSC-CLIENT REVIEW
DRAWN BY: DMD	CHK'D BY: CFC	ISSUED FOR CSC-CLIENT REVIEW
REV. DATE	CLT	DESCRIPTION
0 07/24/12		

Cellco Partnership
d.b.a. **verizon**wireless

CENTEK ENGINEERING
Certified Solutions
(203) 488-0580
(203) 488-8387 Fax
63-2 North Branford Road
Branford, CT 06405
www.CentekEng.com

Cellco Partnership d/b/a Verizon Wireless
WIRELESS COMMUNICATIONS FACILITY
BROOKFIELD, CT
33 CARMEN HILL ROAD,
BROOKFIELD, CT

DATE: 07/24/12
SCALE: AS NOTED
JOB NO. 12010.C09

TITLE SHEET

T-1

Sheet No. 1 of 2

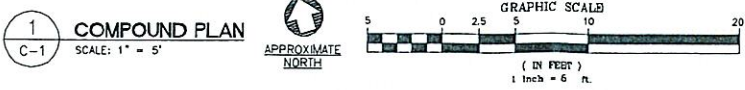
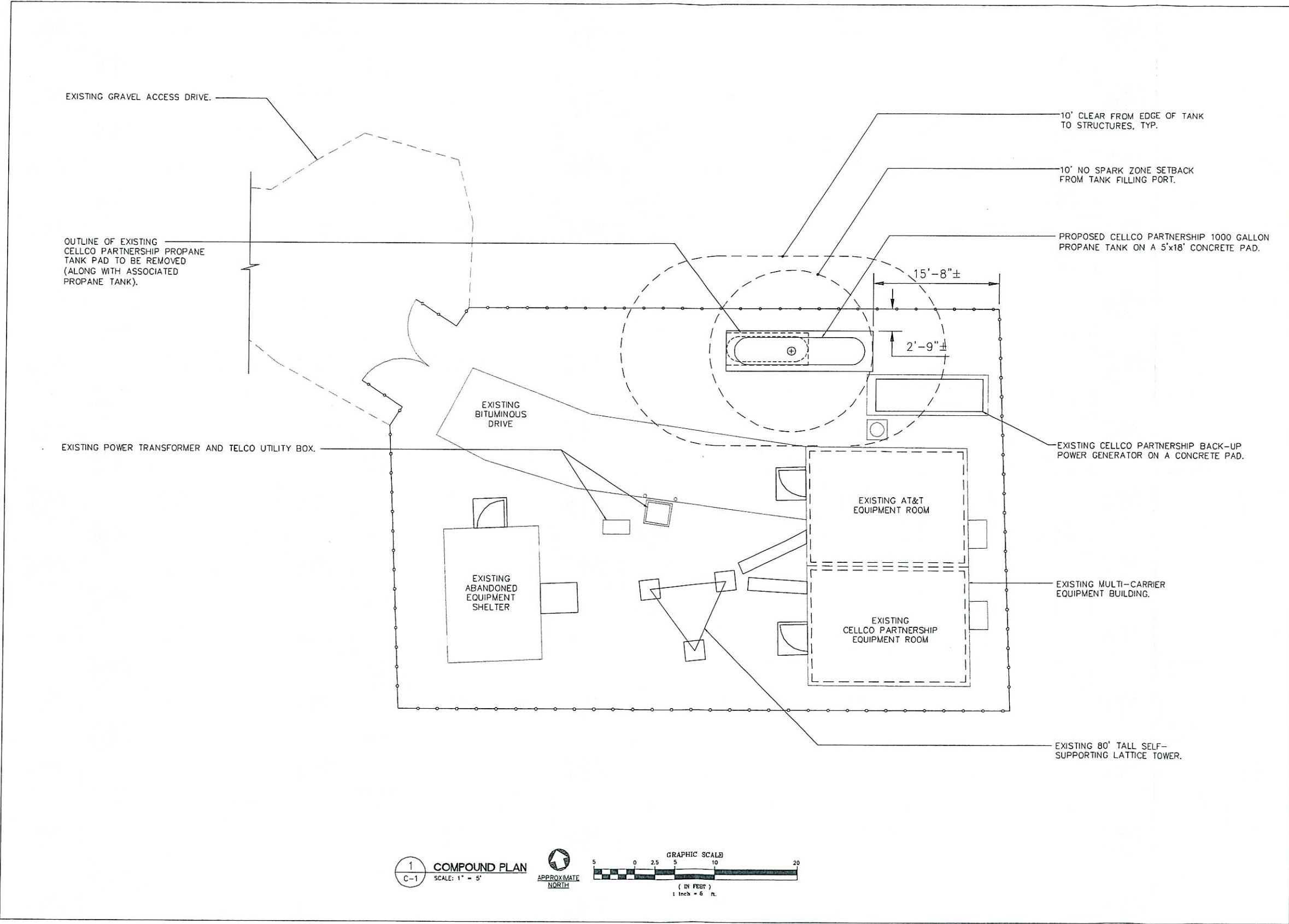

DESIGNED BY: FLO	
DRAWN BY: DMD	
CHK'D BY: CFC	
	ISSUED FOR CSC-CLIENT REVIEW
	DMD
	CLT
0	07/24/12
REV	DATE
Cellco Partnership d.b.a. Verizon Wireless	
C=NT=K engineering Certified on Solutions® (203) 488-0390 (203) 488-8337 Fax 652 North Branford Road Branford, CT 06405 www.cntek.com	
Cellco Partnership d/b/a Verizon Wireless WIRELESS COMMUNICATIONS FACILITY BROOKFIELD, CT 33 CARMEN HILL ROAD, BROOKFIELD, CT	
DATE: 07/24/12	
SCALE: AS NOTED	
JOB NO. 12010.C09	
COMPOUND PLAN	
C-1	
Sheet No. 2 of 2	