

**ORIGINAL**

**METROPCS MASSACHUSETTS, LLC NOTICE OF INTENT TO MODIFY  
AN EXISTING TELECOMMUNICATIONS FACILITY AT  
260 BECKLEY RD BERLIN, CONNECTICUT**

Pursuant to the Public Utility Environmental Standards Act, Connecticut General Statutes § 16-50g et. Seq. ("PUESA"), and Sections 16-50j-72(b) and 16-50j-73 of the Regulations of Connecticut State Agencies ("R.C.S.A") adopted pursuant to the PUESA, Metro PCS, Inc., by and through its agent MetroPCS Massachusetts, LLC ("MetroPCS") and as successor in interest to Pocket Communications hereby notifies the Connecticut Siting Council of its intent to modify an existing facility located at 260 Beckley Rd Berlin, Connecticut. The telecommunications facility is owned by American Tower Corporation ("ATC") and leased to MetroPCS.

**MetroPCS' Proposed Wireless Modifications**

MetroPCS as successor in interest to Pocket Communications achieved an initial exempt modification approval from the Siting Council to install antennas and related ground equipment on October 28, 2008. The facility consists of a one hundred and fifty (150) foot high self support monopole telecommunications tower (the "Tower") within a fenced compound. MetroPCS now intends to modify the facility as shown on the enclosed plans prepared by Chappell Engineering Associates, LLC and annexed hereto as Exhibit 1. The modifications will consist of ground work only and entails expanding the existing MetroPCS lease area from 6'x6' to 10'x9', removing the one (1) existing radio cabinet and replacing with one (1) proposed radio cabinet and one (1) proposed battery cabinet. The existing ppc cabinet will remain resulting in a final ground configuration of one (1) radio cabinet, one (1) battery cabinet and one (1) ppc cabinet all within a 10'x9' lease area. MetroPCS will not be modifying the existing antennas and related equipment installed on the tower at this time and therefore; will not affect the structural capacity of the existing tower.

In accordance with R.C.S.A Section 16-50j-73, a copy of this submission is being sent to Town of Berlin. A copy of this submission is also being sent to John C Jr. & Elaine Matolis the property owner on which the tower is located.

**MetroPCS' Proposed Wireless Modifications Constitutes An "Exempt Modification"**

The proposed modification to the Beckley Road Facility constitutes an exempt modification of an existing facility provided for in R.C.S.A Section 16-50j-72(b)(2) and Council regulations promulgated pursuant thereto.

- 1) The proposed modifications are restricted to ground equipment only and will not result in an increase in the height of the existing tower.
- 2) The proposed modifications will not require expansion of the site boundaries.
- 3) The proposed modifications will not increase noise levels at the facility by six decibels or more.

RECEIVED  
DEC 26 2012  
CONNECTICUT  
SITING COUNCIL

- 4) MetroPCS' proposed facility will not increase the cumulative radio frequency electromagnetic radiation power density at the Tower site's boundary to or above the standard adopted by the Connecticut Department of Environmental Protection as set forth in Section 22a-162 of the Connecticut General Statutes and MPE limits established by the Federal Communications Commission. A cumulative General Power Density table for MetroPCS' proposed modified facility is included as Exhibit 2.

For all the foregoing reasons, MetroPCS' respectfully submits that the proposed modifications to the above-referenced telecommunications facility constitutes an exempt modification under R.C.S.A Section 16-50j-72(b)(2)

Respectfully submitted,

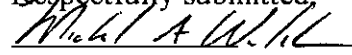

Michael Walsh 339-832-0622

On behalf of MetroPCS Massachusetts, LLC

cc: Town of Berlin  
John C Jr. & Elaine Matolis

MetroPCS Massachusetts ID: HFC0039A

Document ID: Exempt Modification Request — 260 Beckley Berlin, CT

## Exhibit 1

### Site Plan

metroPCS
Unlimit Yourself.

HFC0039A
BECKLEY ROAD

260 BECKLEY ROAD
BERLIN, CT 06037
HARTFORD COUNTY

SITE TYPE: EQUIPMENT UPGRADE - MONOPOLE

SITE INFORMATION:

PROPERTY OWNER: JOHN C. JR & ELAINE MATOLIS
260 BECKLEY ROAD
BERLIN, CT 06037

TOWER OWNER: AMERICAN TOWER CORPORATION

TOWER OWNER SITE ID: 302483

APPLICANT: METROPCS MASSACHUSETTS, LLC.
285 BILLERICA ROAD
CHELMSFORD, MA 01824
(978) 244-7200

SITE ADDRESS: 260 BECKLEY ROAD
BERLIN, CT 06037

COUNTY: HARTFORD COUNTY
LATITUDE: N 41° 37' 54.2"
LONGITUDE: W 72° 43' 47.7"

ZONING CLASSIFICATION: R-21
ZONING JURISDICTION: TOWN OF BERLIN
TAX ID PARCEL NUMBER: 11-1-132-7-387-7

ARCHITECT / ENGINEER: ENGINEER: MATT TILDEN
DEWBERRY ENGINEERS INC.
280 SUMMER STREET
BOSTON, MA 02210
(617) 695-3400

POWER COMPANY: CL&P
(860) 947-2121

TELEPHONE COMPANY: AT&T
(888) 727-8368

SITE ACQUISITION MANAGER: KELLIE DUNN
(978) 244-7200

CONSTRUCTION MANAGER: DAVE BEAN
(978) 244-7200

OPERATIONS MANAGER: MIKE WILBANKS
(978) 244-7280

VICINITY MAP

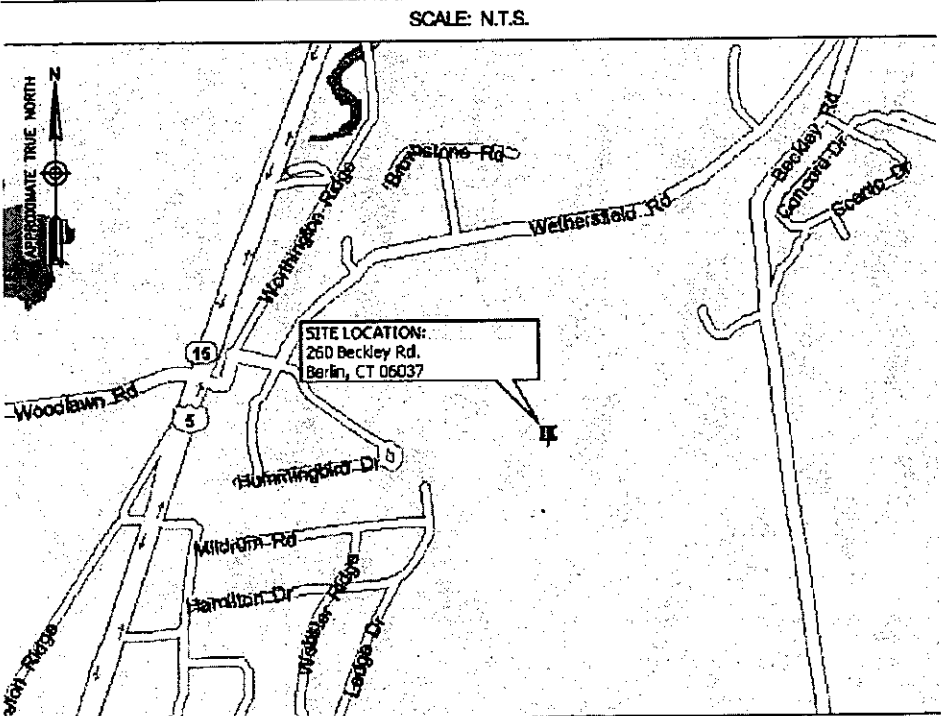

DRIVING DIRECTIONS

TAKE I-485 S. TAKE EXIT 25B FOR INTERSTATE 290 W TOWARD WORCESTER. MERGE ONTO I-290 W. TAKE EXIT 7 FOR I-90/MASS. PIKE. TAKE EXIT 9 TO MERGE ONTO I-84 W TOWARD US-20/HARTFORD/NEW YORK CITY. TAKE CT-15 S/U.S. ROUTE 5 S. TURN LEFT ONTO CT-180 E/DEMING RD. TURN RIGHT ONTO BACON LN. TURN RIGHT ONTO WETHERSFIELD RD. SLIGHT LEFT ONTO BECKLEY RD. THE ACCESS ROAD WILL BE ON THE RIGHT.

THIS DOCUMENT WAS DEVELOPED TO REFLECT A SPECIFIC SITE AND ITS SITE CONDITIONS AND IS NOT TO BE USED FOR ANOTHER SITE OR WHEN OTHER CONDITIONS PERTAIN. REUSE OF THIS DOCUMENT IS AT THE SOLE RISK OF THE USER.

A.D.A. COMPLIANCE:
FACILITY IS UNMANNED AND NOT FOR HUMAN HABITATION.

APPROVALS

LANDLORD:
FIELD CONST. MGR:
RF ENGINEER:
SITE ACQUISITION AGENT:
ARCHITECT/ENGINEER:

SHEET INDEX

Table with 3 columns: DWG., DESCRIPTION, REV. Rows include T-1 (TITLE SHEET), G-1 (GENERAL NOTES), C-1 (SITE PLAN & ELEVATION), C-2 (CONSTRUCTION DETAILS), C-3 (EQUIPMENT PAD DETAILS), E-1 (RISER DIAGRAMS & NOTES), and E-2 (GROUNDING SCHEMATIC & DETAILS).

DO NOT SCALE DRAWINGS

CONTRACTOR SHALL VERIFY ALL PLANS AND EXISTING DIMENSIONS AND CONDITIONS ON THE JOB SITE AND SHALL IMMEDIATELY NOTIFY THE PROJECT OWNER'S REPRESENTATIVE IN WRITING OF DISCREPANCIES BEFORE PROCEEDING WITH THE WORK OR BE RESPONSIBLE FOR SAME.

PROJECT DESCRIPTION

- 1. THIS IS AN UNMANNED AND RESTRICTED ACCESS EQUIPMENT FACILITY AND WILL BE USED FOR THE TRANSMISSION OF RADIO SIGNAL FOR THE PURPOSE OF PROVIDING PUBLIC CELLULAR SERVICE.
- 2. THIS FACILITY WILL CONSUME NO UNRECOVERABLE ENERGY.
- 3. NO POTABLE WATER SUPPLY IS TO BE PROVIDED AT THIS LOCATION.
- 4. NO WASTE WATER WILL BE GENERATED AT THIS LOCATION.
- 5. NO SOLID WASTE WILL BE GENERATED AT THIS LOCATION.
- 6. METROPCS MAINTENANCE CREW (TYPICALLY ONE PERSON) WILL MAKE AN AVERAGE OF ONE TRIP PER MONTH AT ONE HOUR PER VISIT.

metroPCS
Unlimit Yourself.
285 BILLERICA ROAD
THIRD FLOOR
CHELMSFORD, MA 01824
TEL (978) 244-7200
FAX (978) 244-7240

ERICSSON
6300 LEGACY DRIVE
PLANO, TX 75024

Dewberry
Dewberry Engineers Inc.
280 SUMMER ST.
10TH FLOOR
BOSTON, MA 02210
(617) 695-3400
Professional Engineer Seal for Patrick P. Barry, License No. 28959, dated 12-13-12.

Table with 3 columns: REV. #, DATE, DESCRIPTION. Row 0: 12/13/12 ISSUED FOR CONSTRUCTION. Includes a small table for project details: PROJECT NO. 50056838, JOB NO. 50056870, DESIGNED BY: OAS, DRAWN BY: MR, CHECKED BY: MFT, SCALE: AS SHOWN.

SITE NAME:
HFC0039A
BECKLEY ROAD

SITE ADDRESS:
260 BECKLEY ROAD
BERLIN, CT 06037

DRAWING TITLE:
TITLE SHEET

DRAWING NO:
T-1

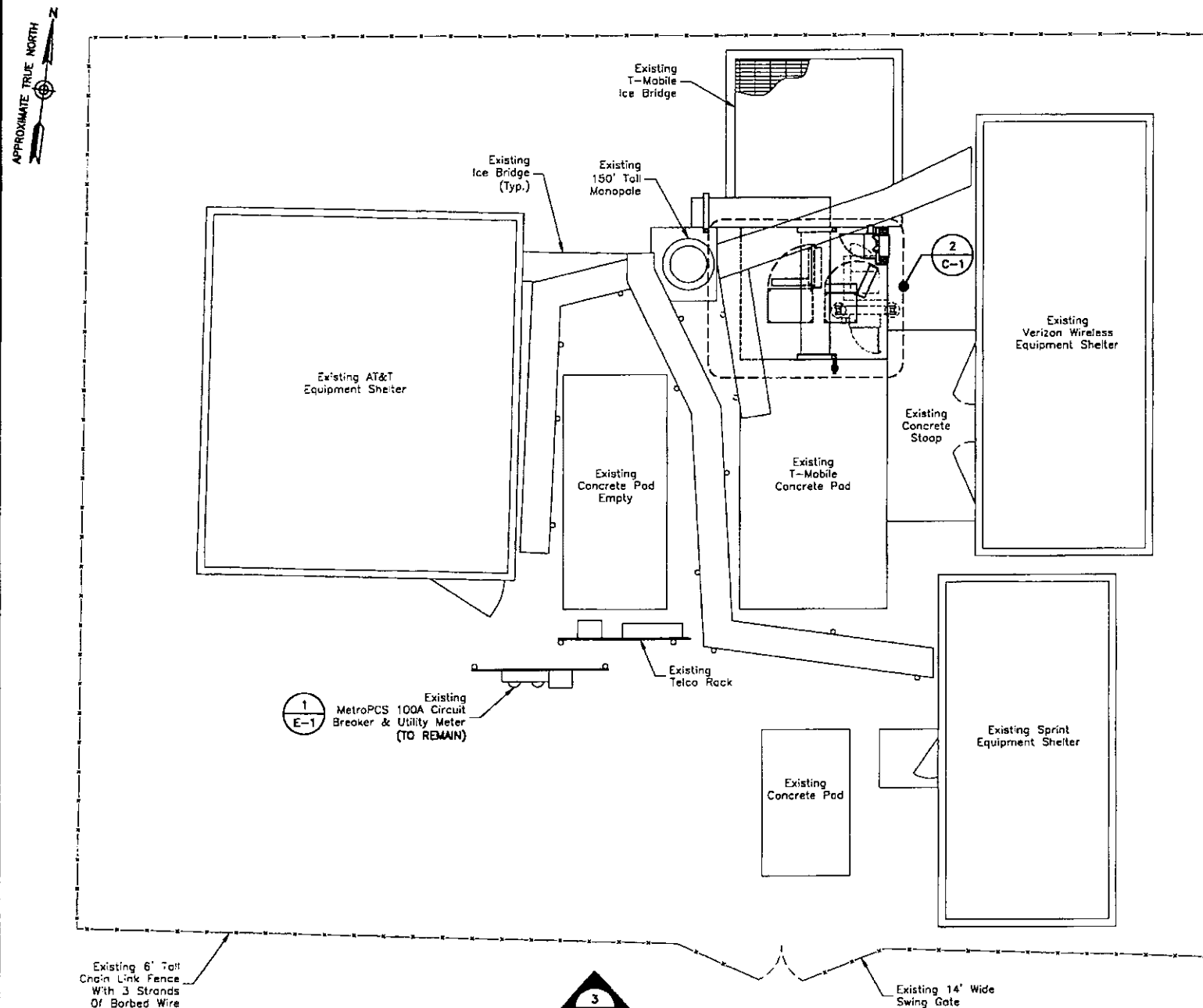

**SITE PLAN**  
SCALE: 1"=10' FOR 11'x17"  
1"=5' FOR 22'x34"

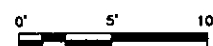

**NOTES:**

1. NORTH ARROW SHOWN AS APPROXIMATE.
2. SOME ITEMS NOT SHOWN FOR CLARITY.
3. NO ANTENNA OR ONE WORK IF PROPOSED ON THE EXISTING TOWER.

**SCOPE OF WORK/CONSTRUCTION NOTES:**

1. EXPAND EXISTING 6'x6' LEASE AREA TO 9'x10' LEASE AREA.
2. RELOCATE EXISTING POCKET BTS CABINETS AS REQUIRED TO INSTALL NEW CONCRETE PAD. REMOVE CABINET WHEN NEW BTS IS CUT OVER.
3. REMOVE EXISTING POCKET ICE BRIDGE AS REQUIRED TO INSTALL NEW CONCRETE PAD. RE-USE EXISTING AS APPLICABLE.
4. INSTALL NEW JUMPERS FROM END OF HARDLINE TO HARDLINE BTS 6201. (INSTALL GROUND KITS, POLYPHASE & GROUND BAR AS REQUIRED).
5. EXISTING 100A ELECTRICAL SERVICE TO REMAIN AND BE-RECONNECTED TO PPC. REUSE EXISTING ELECTRICAL CONDUIT, JUNCTION BOX AND FEEDERS AS REQUIRED FOR NEW PPC PLACEMENT.
6. EXISTING TELCO CONDUIT TO REMAIN. INSTALL NEW 25 PAIR, 24 GAUGE ICKY-PIC CABLE, AS DIRECTED BY METROPCS.
7. INSTALL NEW LIGHT FIXTURE AND TIMER SWITCH.

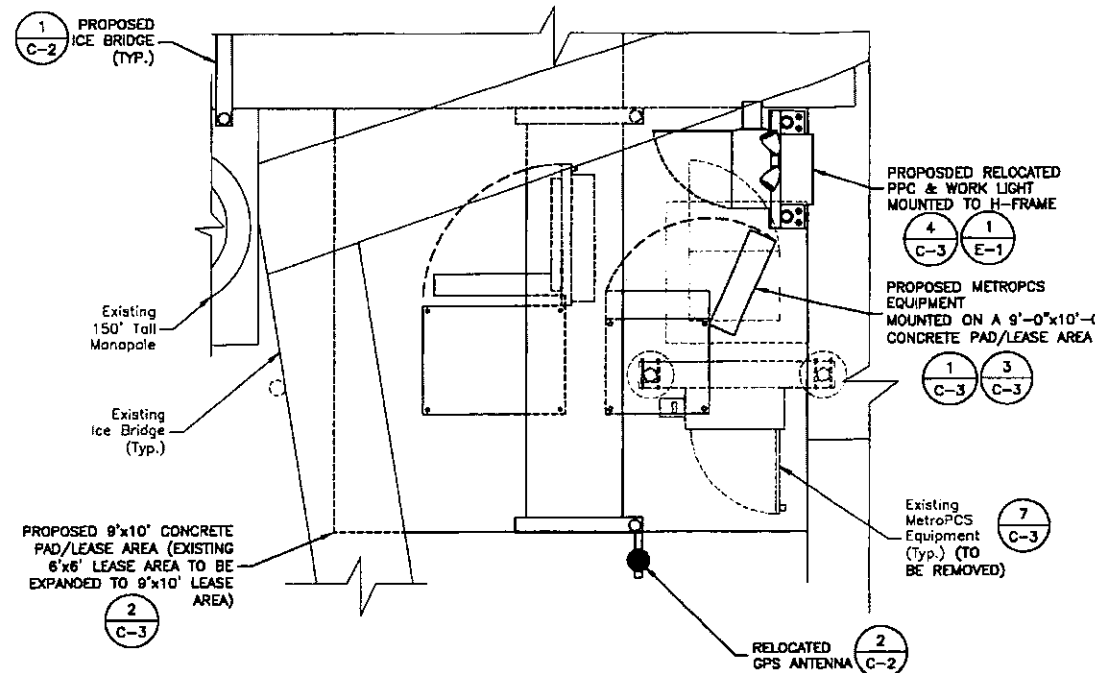

**DETAILED EQUIPMENT PLAN**

SCALE: 1/4"=1' FOR 11'x17"  
1/2"=1' FOR 22'x34"

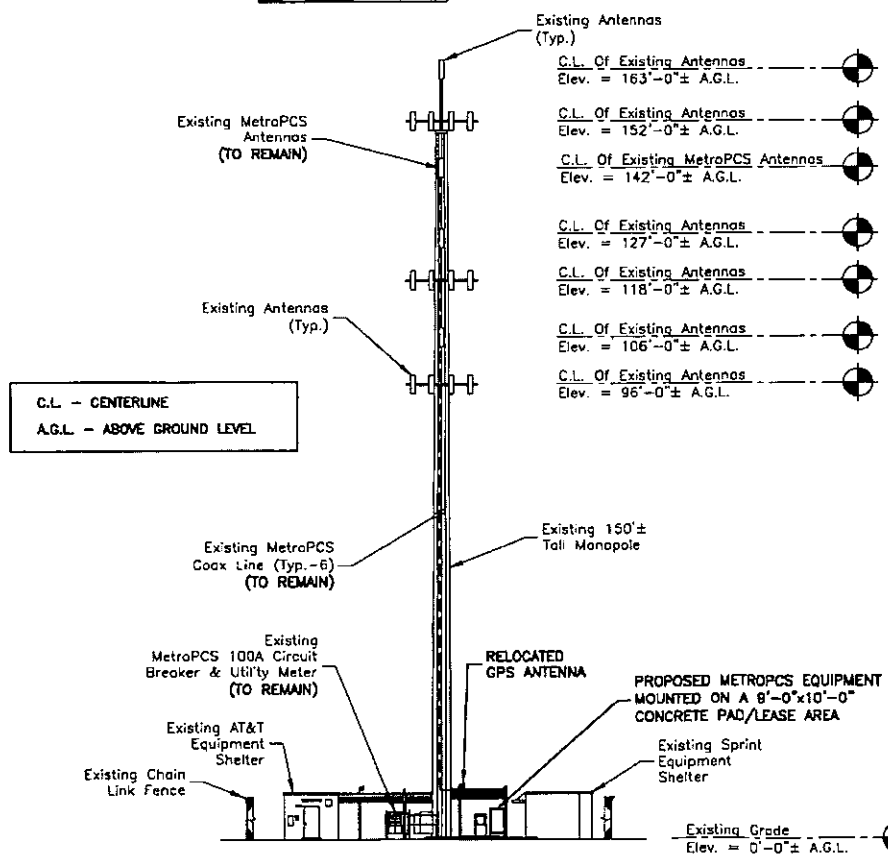
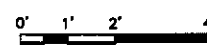

**ELEVATION**

SCALE: 1"=40' FOR 11'x17"  
1"=20' FOR 22'x34"

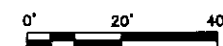

**metroPCS.**

Unlimit Yourself.

285 BILLERICA ROAD  
THIRD FLOOR  
CHELMSFORD, MA 01824  
TEL (978) 244-7200  
FAX (978) 244-7240



6300 LEGACY DRIVE  
PLANO, TX 75024

**Dewberry**

Dewberry Engineers Inc.

280 SUMMER ST.  
10TH FLOOR  
BOSTON, MA 02210  
PHONE: 617.266.3400  
FAX: 617.266.3310

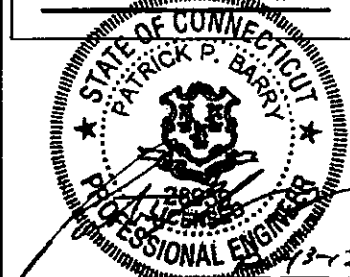

ENGINEER/LAND SURVEYOR DATE

IT IS A VIOLATION OF LAW FOR ANY PERSON, UNLESS THEY ARE ACTING UNDER THE DIRECTION OF A LICENSED PROFESSIONAL ENGINEER, TO ALTER THIS DOCUMENT.

**REVISIONS**

REV. #	DATE	DESCRIPTION
0	12/13/12	ISSUED FOR CONSTRUCTION

PROJECT NO. 50056838	DESIGNED BY: OAS	SCALE: AS SHOWN
JOB NO. 50056870	DRAWN BY: MR	CHECKED BY: MFT

SITE NAME:

**HFC0039A  
BECKLEY ROAD**

SITE ADDRESS:

**260 BECKLEY ROAD  
BERLIN, CT 06037**

DRAWING TITLE:

**SITE PLAN  
& ELEVATION**

DRAWING NO:

**C-1**

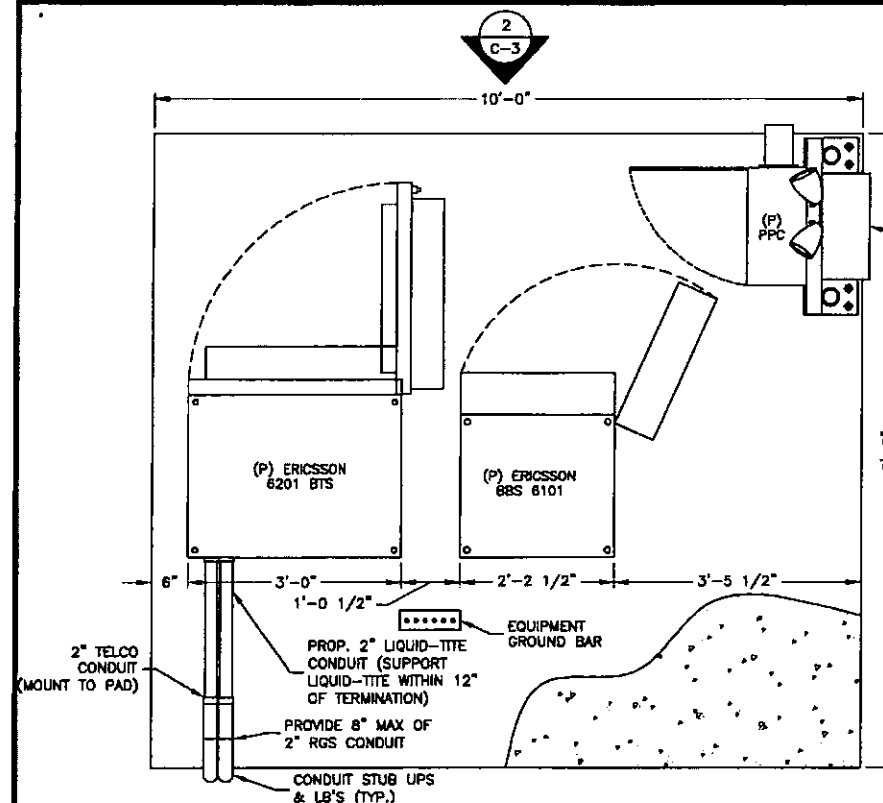

#### PLAN EQUIPMENT PAD NOTE:

- POUR CONCRETE LEVEL TO EXISTING CONCRETE PADS AND TOWER FOUNDATION. DO NOT DOWEL TO EXISTING FOUNDATION.

#### PLAN AT EQUIPMENT PAD

SCALE: 3/8"=1' FOR 11"x17"  
3/4"=1' FOR 22"x34"

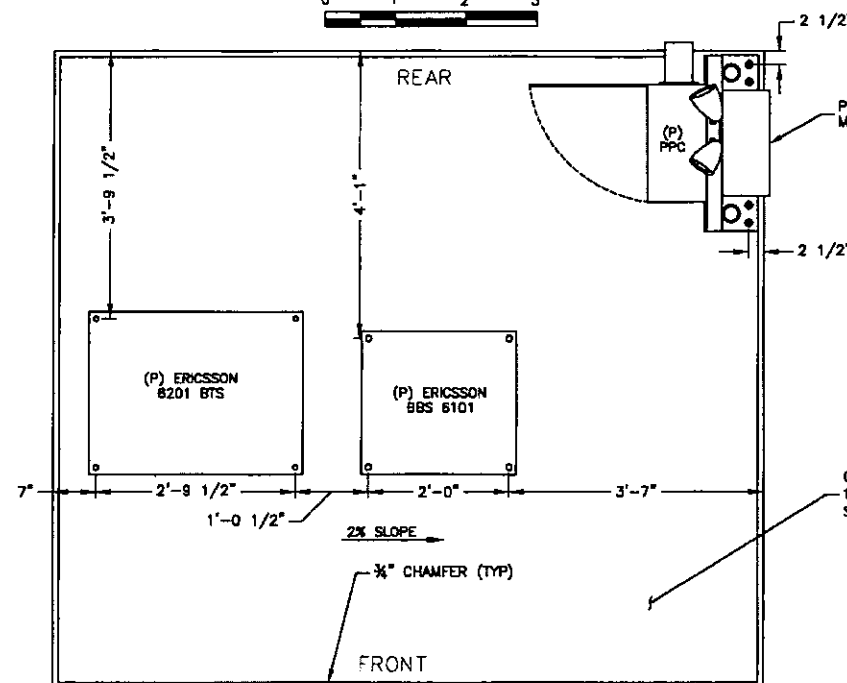

#### ANCHORING FOOTPRINT DETAIL

SCALE: 3/8"=1' FOR 11"x17"  
3/4"=1' FOR 22"x34"



#### ANCHORING FOOTPRINT NOTES:

- MOUNT CABINETS TO CONCRETE PAD PER MANUFACTURER'S REQUIREMENTS.
- PROVIDE 3'-0" MIN SERVICE ACCESS IN FRONT AND REAR OF ALL CABINETS.
- INSTALL NEW CONDUIT/CABLING ON EXISTING ICE BRIDGE OR CABLE RACK. DO NOT CREATE ANY TRIP HAZARDS.

#### H-FRAME

SCALE: N.T.S.

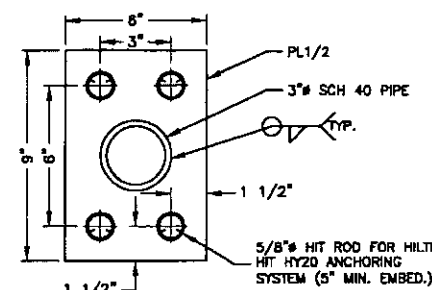

#### H-FRAME BASE PLATE

SCALE: 1 1/2"=1' FOR 11"x17"  
3"=1' FOR 22"x34"

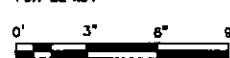

#### CONCRETE PAD SECTION NOTES:

- GRAVEL SHALL BE NATURAL OR CRUSHED GRAVEL WITH 100% PASSING 1 INCH. SIEVE
- GRADE SHALL SLOPE AWAY FROM THE CONCRETE PAD TO ALLOW FOR PROPER WATER RUN OFF.
- CONTRACTOR TO VERIFY STUBUP & UNDERGROUND CONDUIT LOCATIONS FOR THE POWER AND TELCO PRIOR TO POURING CONCRETE.
- BEARING STRATA MEDIUM TO DENSE INSET GRANULAR MATERIAL OR COMPACTED GRAVEL FILL. 95% COMPACTION.
- SUBGRADE & FILL SHALL CONSIST OF CLEAN SOIL. NO DELETERIOUS MATERIALS OR ORGANICS.

#### CONCRETE PAD SECTION

SCALE: 1/4"=1' FOR 11"x17"  
1/2"=1' FOR 22"x34"

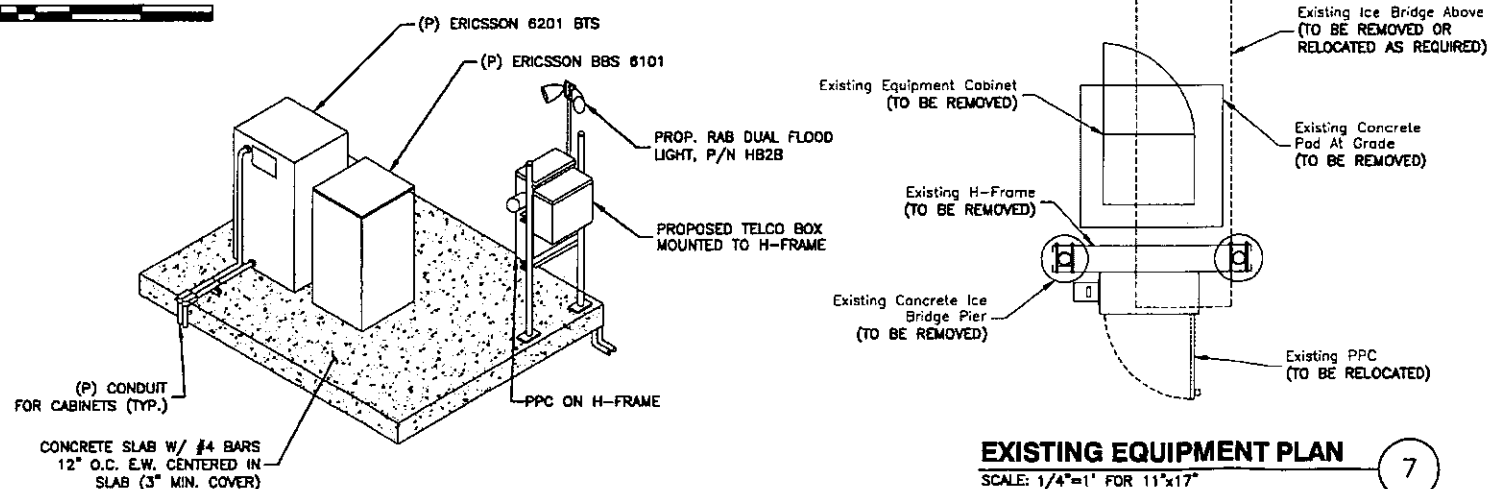
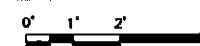

#### EQUIPMENT LAYOUT ISOMETRIC

SCALE: N.T.S.

#### EXISTING EQUIPMENT PLAN

SCALE: 1/4"=1' FOR 11"x17"  
1/2"=1' FOR 22"x34"

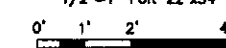

**metroPCS**

Unlimit Yourself.

285 BILLERICA ROAD  
THIRD FLOOR  
CHELMSFORD, MA 01824  
TEL (978) 244-7200  
FAX (978) 244-7240



6300 LEGACY DRIVE  
PLANO, TX 75024

**Dewberry**

Dewberry Engineers Inc.

280 SUMMER ST.  
FLOOR 10  
NEWTON, MA 02459  
TEL (617) 552-3400  
FAX (617) 552-3400

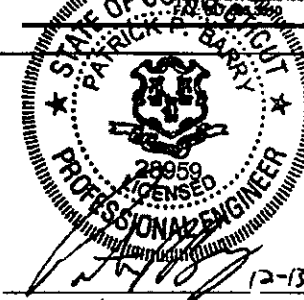

ENGINEER/LAND SURVEYOR DATE

IT IS A VIOLATION OF LAW FOR ANY PERSON, UNLESS THEY ARE ACTING UNDER THE DIRECTION OF A LICENSED PROFESSIONAL ENGINEER, TO ALTER THIS DOCUMENT.

#### REVISIONS

REV. #	DATE	DESCRIPTION
0	12/13/12	ISSUED FOR CONSTRUCTION

PROJECT NO. 50056838	DESIGNED BY: DAS	SCALE: AS SHOWN
JOB NO. 50056870	DRAWN BY: SC	CHECKED BY: MFT

#### SITE NAME:

HFC0039A  
BECKLEY ROAD

#### SITE ADDRESS:

260 BEKLEY ROAD  
BERLIN, CT 06037

#### DRAWING TITLE:

EQUIPMENT PAD DETAILS

#### DRAWING NO:

**C-3**

MetroPCS Massachusetts ID: HFC0039A

Document ID: Exempt Modification Request — 260 Beckley Berlin, CT

## Exhibit 2

### Power Density Calculation

Power Density Calculations

Control Number	Site	Carrier	#Channels	ERP/Ch	Ant Ht	Power Density (mW/cm2)	MHz	S	%MPE	Site Total
EM-CING-007-120427A	Berlin - 260 Beckley Road	AT&T UMTS	2	565	152	0.0176	880	0.5867	3.00%	
EM-CING-007-120427A	Berlin - 260 Beckley Road	AT&T UMTS	2	875	152	0.0272	1900	1.0000	2.72%	
EM-CING-007-120427A	Berlin - 260 Beckley Road	AT&T GSM	1	283	152	0.0044	880	0.5867	0.75%	
EM-CING-007-120427A	Berlin - 260 Beckley Road	AT&T GSM	4	525	152	0.0327	1900	1.0000	3.27%	
EM-CING-007-120427A	Berlin - 260 Beckley Road	AT&T LTE	1	1313	152	0.0204	734	0.4893	4.18%	
EM-Pocket-007-081008	Berlin - 260 Beckley Road	metroPCS CDMA	3	727	142	0.0389	2135	1.0000	3.89%	
EM-Spectra-007-021011	Berlin - 260 Beckley Road	Berlin FD	1	25.12	94.5	0.0010	953.55	0.6357	0.16%	
EM-VER-007-121018	Berlin - 260 Beckley Road	Verizon cellular	9	262	116	0.0630	869	0.5793	10.86%	
EM-VER-007-121018	Berlin - 260 Beckley Road	Verizon PCS	11	258	116	0.0758	1970	1.0000	7.58%	
EM-VER-007-121018	Berlin - 260 Beckley Road	Verizon AWS	1	627	116	0.0168	2145	1.0000	1.68%	
EM-VER-007-121018	Berlin - 260 Beckley Road	Verizon LTE	1	857	116	0.0229	698	0.4653	4.92%	
EM-T-Mobile-007-090406	Berlin - 260 Beckley Road	T-Mobile GSM	8	171	162	0.0187	1945	1.0000	1.87%	
EM-T-Mobile-007-090406	Berlin - 260 Beckley Road	T-Mobile UMTS	2	683	162	0.0187	2100	1.0000	1.87%	
Sprint EM 10/28/97	Berlin - 260 Beckley Road	Sprint	11	122	125	0.0309	1962.5	1.0000	3.09%	
EM-Nextel-007-050422	Berlin - 260 Beckley Road	Nextel	12	100	90	0.0533	851	0.5673	9.39%	59.24%
	Berlin - 260 Beckley Road	metroPCS LTE	1	1200	142	0.0214	2130	1.0000	2.14%	61.38%