



CRAIG CODY

16 Chestnut Street, Suite 220  
Foxboro, MA 02035  
Tel (781) 831-1281  
Fax (774) 215-5423

Melanie Bachman  
Executive Director  
Connecticut Siting Counsel  
10 Franklin Square  
New Britain, CT 06051

Re: **Notice of Exempt Modification - Shared Emergency Backup Generator  
104 Bunker Hill Road, Andover, CT 06232**

Dear Ms. Bachman:

American Tower Corporation (“ATC”) currently maintains a wireless telecommunications facility at the above referenced address. ATC’s tower and ground facilities are host to multiple tenants which are existing within a lease area maintained by ATC. ATC does not currently maintain a generator at this cell site.

In an effort to further enhance multiple tenant’s network reliability, ATC intends to modify its facility by installing a new diesel-fueled generator outside in a designated 8’x14’-4” ground space. The generator incorporates a built-in fuel tank as part of the unit. The diesel fuel tanks are double walled for added safety and will be filled by a licensed fuel filling company. (See Facility Compound Plan attached).

Please accept this letter as notification pursuant to R.C.S.A Section 16-50j-73, for construction that constitutes modification pursuant to R.C.S.A Section 16-50j-72(b)(2). In accordance with R.C.S.A Section 16-50j-73, a copy of this submission is being sent to the Town of Andover. A copy of this submission is also being sent to Leon and Benjamin Price, the property owner on which the tower is located.

**ATCs’ Proposed Wireless Modifications Constitutes An “Exempt Modification”**

The proposed modification to the above mentioned Facility constitutes an exempt modification of an existing facility provided for in R.C.S.A Section 16-50j-72(b)(2) and Council regulations promulgated pursuant thereto.

- 1) The proposed modification will not result in an increase in the height of the existing tower.
- 2) The generator and attached fuel tank will remain entirely within the limits of the leased area. The modifications therefor, will not require the extension of the boundary.

- 3) The proposed modification does not increase the noise levels at the boundary by six(6) decibels or more under normal conditions. Proposed modification is only used during emergency power failure.
- 4) The installation of a new generator and attached fuel tank will not change, in any way, radio frequency (RF) emissions at the facility.
- 5) The facility has received all municipal zoning approvals and building permits. (Regs., Conn. State Agencies Section 16-50j-72))

For all the foregoing reasons, American Tower Corporation respectfully submits that the proposed modifications to the above-referenced telecommunications facility constitutes an exempt modification under R.C.S.A Section 16-50j-72(b)(2)

Respectfully submitted,

---

**Craig Cody 781.831.1281**

On behalf of American Tower Corporation  
c/o Tower Resource Management, Inc.  
16 Chestnut Street, Suite 220  
Foxboro, MA 02035

cc: **Town of Andover, CT**  
**Leon and Benjamin Price**

Exhibit 1

Site Plan

ELECTRICAL CONTRACTOR SHALL MAINTAIN FACTORY RECOMMENDED CLEARANCES FOR GENERATOR, OR 48" CLEAR ON EACH SIDE OF H-FRAME. CLEARANCES MAY OVERLAP.

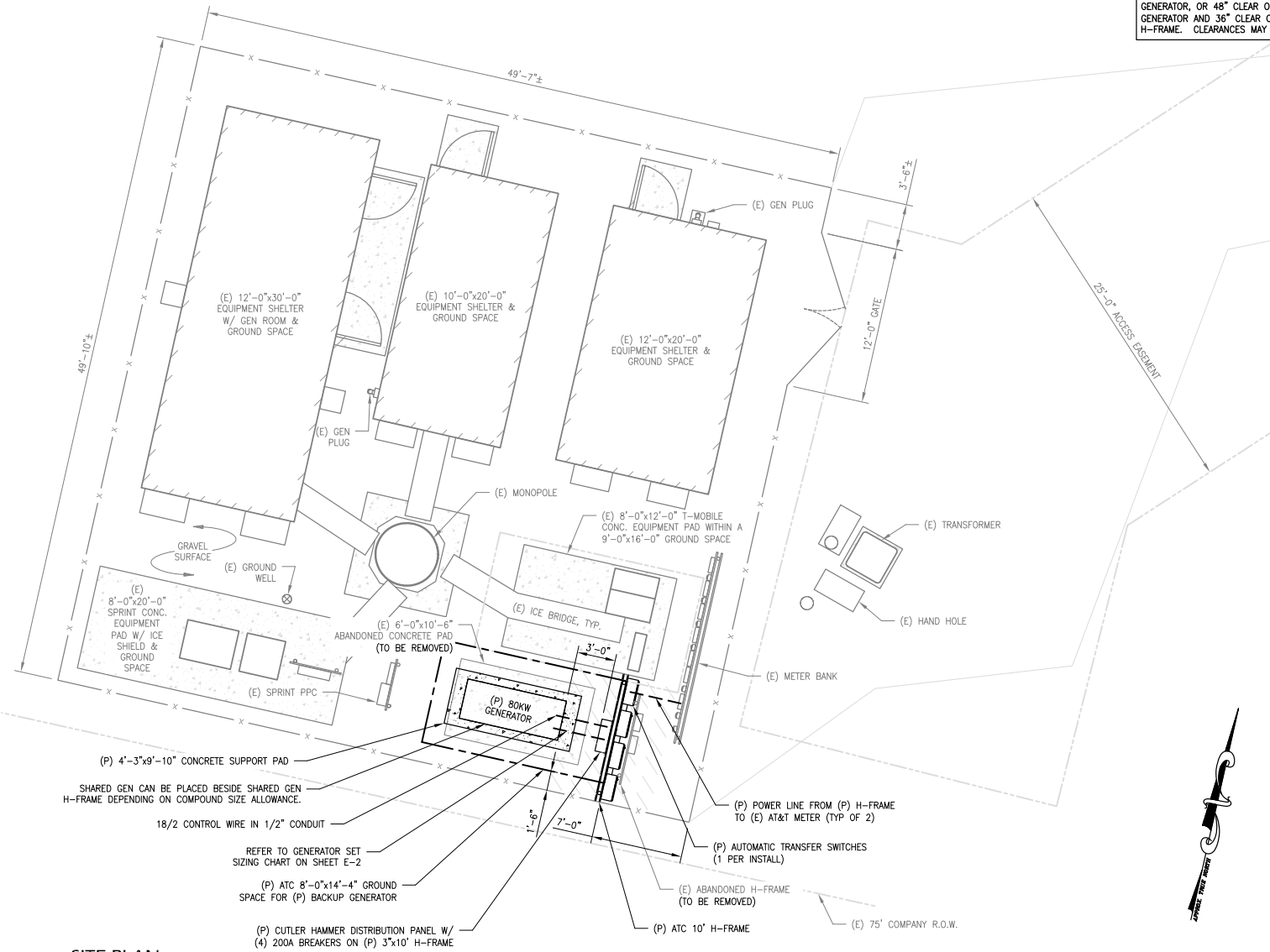

- (E) 12'-0" x 30'-0" EQUIPMENT SHELTER W/ GEN ROOM & GROUND SPACE
- (E) 10'-0" x 20'-0" EQUIPMENT SHELTER & GROUND SPACE
- (E) 12'-0" x 20'-0" EQUIPMENT SHELTER & GROUND SPACE
- (E) GEN PLUG
- (E) MONOPOLE
- (E) 8'-0" x 12'-0" T-MOBILE CONC. EQUIPMENT PAD WITHIN A 9'-0" x 16'-0" GROUND SPACE
- (E) TRANSFORMER
- (E) ICE BRIDGE, TYP.
- (E) HAND HOLE
- (E) METER BANK
- (E) SPRINT PPC
- (E) 6'-0" x 10'-6" ABANDONED CONCRETE PAD (TO BE REMOVED)
- (E) SPRINT CONC. EQUIPMENT PAD W/ ICE SHIELD & GROUND SPACE
- (E) GROUND WELL
- (E) GEN PLUG
- (E) 4'-3" x 9'-10" CONCRETE SUPPORT PAD
- (P) 80KW GENERATOR
- (P) POWER LINE FROM (P) H-FRAME TO (E) AT&T METER (TYP OF 2)
- (P) AUTOMATIC TRANSFER SWITCHES (1 PER INSTALL)
- (E) ABANDONED H-FRAME (TO BE REMOVED)
- (E) 75' COMPANY R.O.W.
- (P) CUTLER HAMMER DISTRIBUTION PANEL W/ (4) 200A BREAKERS ON (P) 3"x10" H-FRAME
- (E) 8'-0" x 14'-4" GROUND SPACE FOR (P) BACKUP GENERATOR
- (P) AT&T 8'-0" x 14'-4" GROUND SPACE FOR (P) BACKUP GENERATOR
- REFER TO GENERATOR SET SIZING CHART ON SHEET E-2
- 18/2 CONTROL WIRE IN 1/2" CONDUIT
- SHARED GEN CAN BE PLACED BESIDE SHARED GEN H-FRAME DEPENDING ON COMPOUND SIZE ALLOWANCE.

**1 SITE PLAN**  
SCALE: 1/8" = 1'-0"

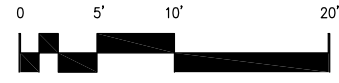

**ADVANCED**  
ENGINEERING GROUP, P.C.  
Civil Engineering - Site Development  
Surveying - Telecommunications  
500 NORTH BROADWAY  
EAST PROVIDENCE, RI 02914  
PH: 401-354-2403 FAX:  
401-633-6354

**TRM**  
Convergent Network Solutions  
TOWER RESOURCE MANAGEMENT  
15 CHESTNUT STREET, SUITE 228  
FOXBORO, MA 02035  
WWW.TRMCOM.COM

**AMERICAN TOWER**  
ATC TOWER SERVICES, INC.  
8505 FREEPORT PARKWAY  
SUITE 135  
IRVING, TX 75063  
PHONE: (972) 999-8900  
FAX: (972) 999-8940  
NYSE AMT

ATC SITE NUMBER:  
**302472**  
ATC SITE NAME:  
ANDOVER-BUNKER HILL  
ROAD  
SITE ADDRESS:  
104 BUNKER HILL ROAD  
ANDOVER, CT 06232

THESE DRAWINGS AND/OR THE ACCOMPANYING SPECIFICATION AS INSTRUMENTS OF SERVICE ARE THE EXCLUSIVE PROPERTY OF ATC TOWER SERVICES, INC. THEIR USE AND PUBLICATION SHALL BE RESTRICTED TO THE ORIGINAL SITE FOR WHICH THEY ARE PREPARED. ANY USE OR DISCLOSURE OTHER THAN THAT WHICH RELATES TO ATC TOWER SERVICES, INC OR THE SPECIFIC PROJECT IS STRICTLY PROHIBITED. THESE DOCUMENTS SHALL REMAIN THE PROPRIETARY PROPERTY OF ATC TOWER SERVICES, INC WHETHER OR NOT THE PROJECT IS EXECUTED. NEITHER THE ARCHITECT NOR THE ENGINEER WILL BE PROVIDING ON-SITE CONSTRUCTION REVIEW OF THIS CONSTRUCTION. MUST VERIFY ALL DIMENSIONS AND ADVISE PROJECT. ATC TOWER SERVICES, INC OF ANY DISCREPANCIES. ANY PRIOR ISSUANCE OF THIS DRAWING IS SUPERSEDED BY THE LATEST VERSION ON FILE WITH ATC TOWER SERVICES, INC.

STATE OF CONNECTICUT  
MARC R. CHRETIEN  
No. 28307  
LICENSED PROFESSIONAL ENGINEER

*Marc R. Chretien*

DRAWN BY:	CJG
CHECKED BY:	SNA
DATE DRAWN:	03-25-2014
JOB NO:	302472
SHEET TITLE:	SITE PLAN

SHEET NUMBER:	REV. #
A-1	0