

December 7, 2009

VIA HAND DELIVERY

Mr. S. Derek Phelps
Executive Director
Connecticut Siting Council
10 Franklin Square
New Britain, CT 06051

Re: Montville Power LLC, Petition No. 907

Dear Mr. Phelps:

I write on behalf of NRG Energy, Inc. ("NRG") and Montville Power LLC ("Montville Power") to provide the Connecticut Siting Council (the "Council") with a report on Montville Power's evaluation of the feasibility of relocating the fuel receiving area for the proposed Montville Biomass project.

As you may recall, as part of an agreement with the Town of Montville (the "Town"), as more fully described in a joint letter from Montville Power and the Town, dated October 16, 2009 (the Joint Letter"), Montville Power agreed to evaluate the feasibility of relocating the fuel receiving area to address comments from neighbors and the Town. Specifically, in Item 3 of the Joint Letter, Montville Power made the following commitment:

Montville Power will pursue the suggestion by neighbors to move the current planned location of the fuel receiving area, to provide a greater distance between the facility and the closest neighbors' house. Relocating this portion of the Project will go a long way in addressing noise and property value concerns. We recognize that Montville Power must first complete an engineering study of the revised location to determine whether this option is doable from engineering and economic perspectives.

Montville Power has completed its evaluation and has determined that it is feasible to relocate the fuel receiving area to address the expressed concerns. Specifically, as shown on the attached Facility Diagram, the fuel handling activities can be moved to a new location, which is approximately 1,000 feet from Lathrop Road. The revised design will allow all of the fuel handling equipment to be located east of the railroad tracks that bisect the site and very close to the existing generation buildings and fuel storage tanks. The redesigned layout will reduce the noise associated with fuel deliveries and will address concerns regarding the aesthetics of the original design.

Murtha Cullina LLP | Attorneys at Law

Mr. S. Derek Phelps
December 7, 2009
Page 2

Montville Power has shared the revised layout with the Mayor of Montville. Montville Power anticipates that the Mayor will communicate acceptance of the redesign to the Council shortly.

Based on the foregoing, Montville Power requests that the Council incorporate the revised layout of the fuel handling facilities as part of any approval of Petition No. 907.

If you have any questions or require additional information, please contact me.

Sincerely,

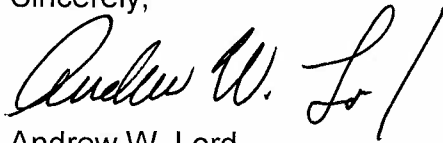
A handwritten signature in cursive script that reads "Andrew W. Lord". The signature is written in black ink and is positioned above the printed name.

Andrew W. Lord

Enclosures

cc: Jonathan Baylor, NRG
Julie L. Friedberg, Esq., NRG
Service List

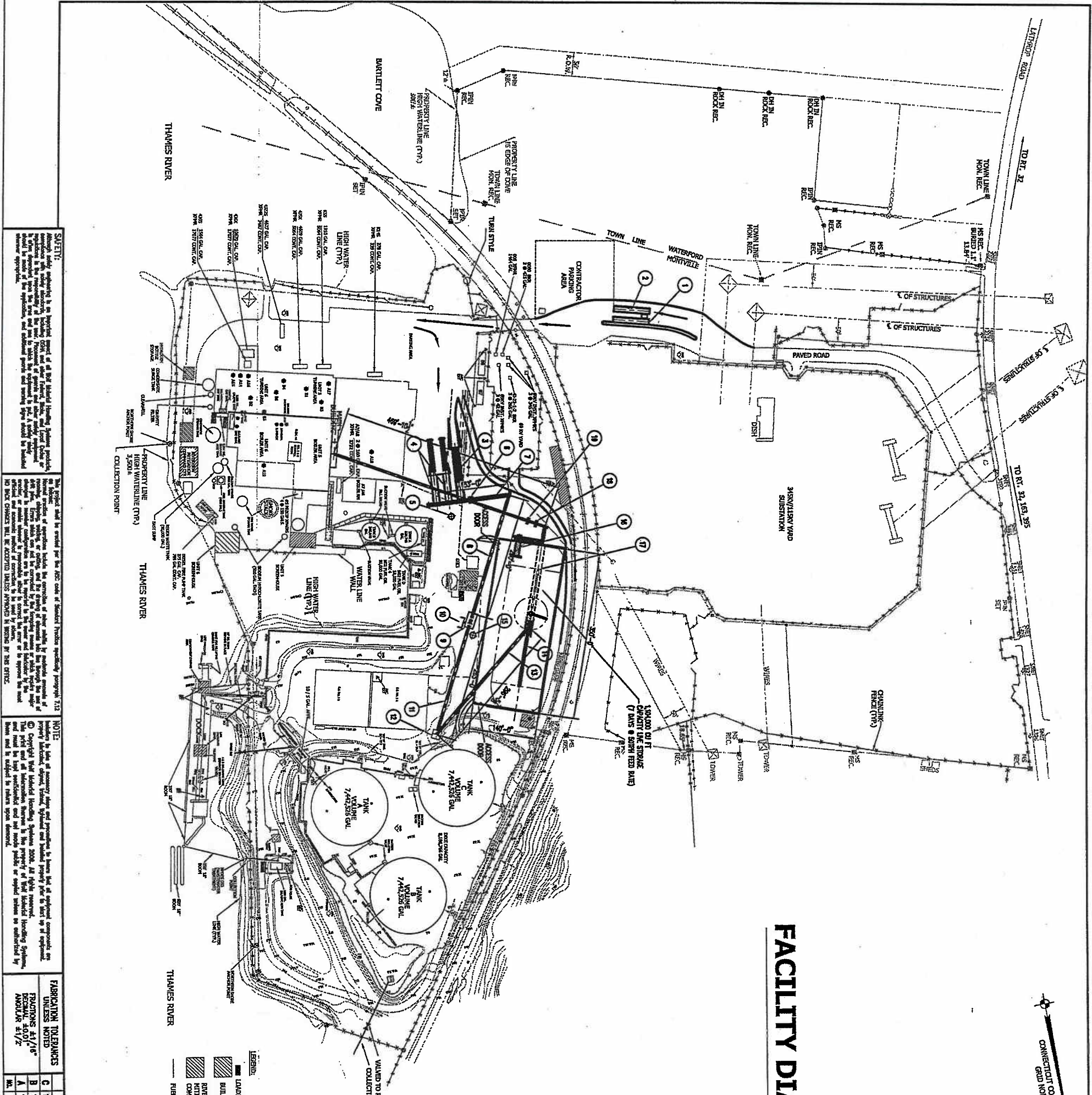

FACILITY DIAGRAM

- ① OUTGOING SCALE
- ② INCOMING SCALE
- ③ HYDRAULIC TRUCK DUMPER AND HOPPER
- ④ SELF-UNLOADING RECEIVING HOPPERS
- ⑤ #12'-0" DUST COLLECTOR
- ⑥ SELF-CLEANING MAGNET
- ⑦ 48" WIDE RECEIVING CONVEYOR (250 TPH)
- ⑧ 48" WIDE TRANSFER CONVEYOR (250 TPH)
- ⑨ HOG/SCREEN TOWER
- ⑩ ABORT PILE
- ⑪ 48" WIDE OUTFEED CONVEYOR (250 TPH)
- ⑫ TRANSFER TOWER
- ⑬ 48" WIDE TRANSFER CONVEYOR (250 TPH)
- ⑭ 48" SHUTTLE CONVEYOR
- ⑮ #10'-0" DUST COLLECTOR
- ⑯ AUXILIARY RECLAIMER
- ⑰ MAGNETIC SEPARATOR
- ⑱ 30" WIDE TRANSFER CONVEYOR (75 TPH)

SAFETY:
 Attention is hereby directed to the fact that this diagram is intended for use as a guide only and is not to be construed as a contract. The user of this diagram is responsible for its use and for any damage or injury resulting therefrom. The user is advised that the use of this diagram is subject to the terms and conditions of the license agreement which is attached hereto and which is incorporated herein by reference.

NOTES:
 1. This diagram is intended for use as a guide only and is not to be construed as a contract. The user of this diagram is responsible for its use and for any damage or injury resulting therefrom. The user is advised that the use of this diagram is subject to the terms and conditions of the license agreement which is attached hereto and which is incorporated herein by reference.

LEGEND:
 [Symbol] LOADING/UNLOADING AREA
 [Symbol] BUILDINGS
 [Symbol] ROBINNET/ROTATION COMMAND CRT
 [Symbol] FUEL OIL PIPING

FABRICATION TOLERANCES UNLESS NOTED	
C 12/2/00	REVISED LAYOUT
B 12/1/00	REVISED LAYOUT
A 11/17/00	ISSUED FOR REVIEW AND COMMENT
DATE	REVISION

BY	DESIGNED BY	DATE	SCALE
GT	ARUN WOLF	11/17/00	N/A
BY	CHECKED BY	DATE	SCALE
GT	GREG WYCKE	11/17/00	AS SHOWN
BY	APPROVED BY	DATE	SCALE
GT	ARUN WOLF	11/17/00	AS SHOWN

WOLF
 Material Handling Systems
 1734 S. 10th St. Ste. 100
 Tulsa, OK 74106
 (918) 574-6400
 FAX: (918) 574-6070

CUSTOMER:
 MRG ENERGY INC.
 ANNAPOLIS, MD

USER:
 MRG WYCKE POWER LLC
 WYCKEVILLE, CT 06892

DESCRIPTION:
 LAYOUT FILE: HANDLING SYSTEM (ALTERNATIVE)



LIST OF PARTIES AND INTERVENORS
SERVICE LIST

Status Granted	Document Service	Status Holder (name, address & phone number)	Representative (name, address & phone number)
Applicant	<input checked="" type="checkbox"/> U.S. Mail	Montville Power LLC	Andrew W. Lord, Esq. Murtha Cullina LLP CityPlace I, 29 th Floor 185 Asylum Street Hartford, CT 06103 (860) 240-6180 (860) 240-6150 alord@murthalaw.com
	<input checked="" type="checkbox"/> U.S. Mail		Julie L. Friedberg, Esq. Senior Counsel NRG Energy, Inc. 211 Carnegie Center Princeton, NJ 08540 (609) 524-5232 (609) 524-4941
	<input checked="" type="checkbox"/> U.S. Mail		Judith Lagano Director – Asset Management NRG Energy, Inc. c/o Montville Power LLC 74 Lathrop Road Uncasville, CT 06382 (203) 854-3625 (203) 854-3658
	<input checked="" type="checkbox"/> U.S. Mail		Jonathan Baylor Senior Analyst, Development & Asset Management NRG Energy, Inc. 211 Carnegie Center Princeton, NJ 08540 (609) 524-4958 (609) 524-4941
Party (granted on 9/16/09)	<input checked="" type="checkbox"/> U.S. Mail	The Connecticut Light and Power Company	John R. Morissette Manager – Transmission Siting & Permitting Northeast Utilities Service Company P.O. Box 270 Hartford, CT 06141-0270 (860) 665-6774 morisjr@nu.com

LIST OF PARTIES AND INTERVENORS
SERVICE LIST

Status Granted	Document Service	Status Holder (name, address & phone number)	Representative (name, address & phone number)
<p style="text-align: center;">Party (granted on 9/16/09)</p>	<input checked="" type="checkbox"/> U.S. Mail	<p>The Connecticut Light and Power Company continued....</p>	<p>Jeffery D. Cochran, Esq. Senior Counsel Northeast Utilities Service Company P.O. Box 270 Hartford, CT 06141-0270 (860) 665-3548 (860) 665-5504 fax cochrjd@nu.com</p>
	<input checked="" type="checkbox"/> U.S. Mail		<p>Robert S. Golden, Jr., Esq. Carmody & Torrance LLP P.O. Box 1110 50 Leavenworth Street Waterbury, CT 06721-1110 (203) 573-1200 (203) 575-2600 rgolden@carmodylaw.com</p>
	<input checked="" type="checkbox"/> U.S. Mail		<p>Anthony M. Fitzgerald, Esq. Carmody & Torrance LLP P.O. Box 1950 195 Church St., 18th Floor New Haven, CT 06509-1950 (203) 777-5501 afitzgerald@carmodylaw.com</p>