

GENERAL NOTES

1. EXISTING TOPOGRAPHIC INFORMATION OBTAINED FROM A PLAN ENTITLED "UNITED TOPOGRAPHIC SURVEY, STAMFORD POWER PLANT, STAMFORD, CT", PREPARED BY LANGAN ENGINEERING, DATED 4/10/01.
2. EXISTING BOUNDARY INFORMATION OBTAINED FROM A PLAN ENTITLED "TOPOGRAPHIC SURVEY, 17 AMELIA PLACE, STAMFORD, CT", PREPARED BY CONKLIN & SOROKA, DATED 4/15/02.
3. ACCORDING TO A WETLANDS REPORT PREPARED BY ENVIRONMENTAL PLANNING SERVICES, THERE ARE NO WETLANDS ON-SITE. NO ACTIVITIES ARE PROPOSED WITHIN THE REGULATED AREA.

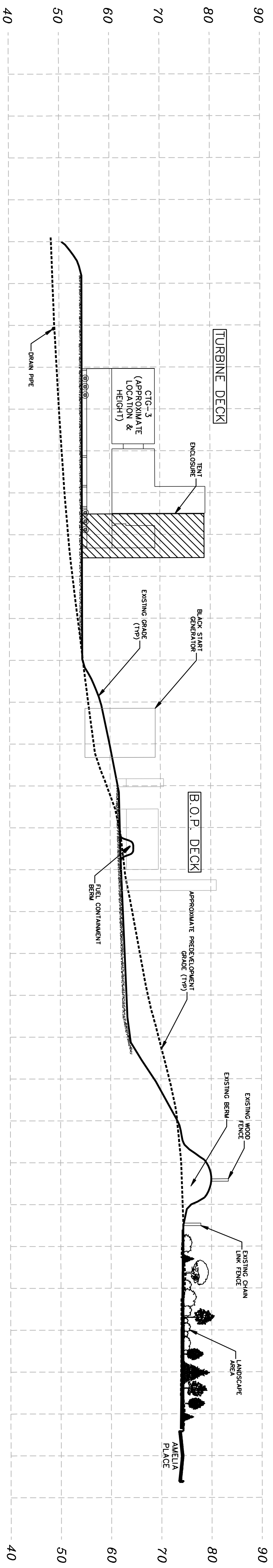

PROFILE

SCALE: 1" = 40' (HORIZONTAL)
1:3 (VERTICAL)

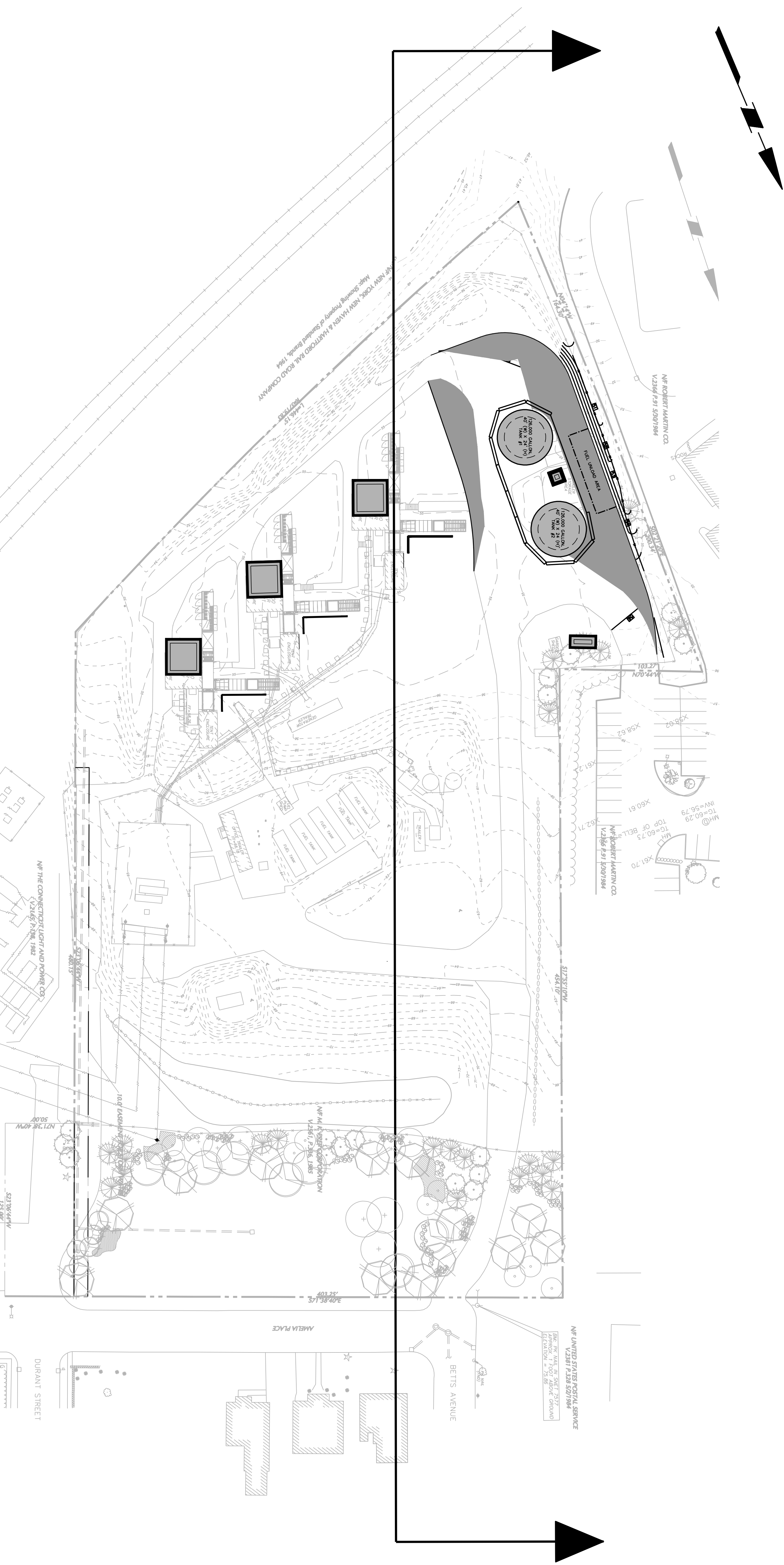

10/26/07	REVISED FOR ZBA SUBMISSION	6
3/29/06	REVISED FOR ZBA SUBMISSION	5
4/26/04	REVISED FOR ZBA SUBMISSION	4
3/25/04	REVISED FOR ZBA SUBMISSION	3
5/13/03	MISCELLANEOUS REVISIONS	2
10/29/02	UPDATED PER AS-BUILT CONDITIONS	1
Date	Description	No.
Revisions		

LANGAN

ENGINEERING & ENVIRONMENTAL SERVICES

855 LONG WHARF DRIVE
NEW HAVEN, CT 06511-4107
PHONE: (203) 668-5771
FAX: (203) 798-6142
WWW.LANGAN.COM

• DUNSMITH, PA
• EDWARDS PARK, NJ
• HARTFORD, CT
• NEW YORK, NY
• PHILADELPHIA, PA
• TRENTON, NJ

Project

WATERSIDE POWER PROJECT

17 AMELIA PLACE

STAMFORD CONNECTICUT

Job No.

7610900

Drawing No.

Date

4/25/02

Scale

1" = 40'

Drawn By

BPJ

Checked By

RAF

27.01

Filename: R:\06103\7610900\Code Date - 7610900\Lang\7610902\201.dwg Date: 11/6/2007 Time: 16:19 User: tondario Style Table: Langan.stb Layout: 27.01