



PHOTO

8A

DESCRIPTION

ACCESS ROAD LOOKING SOUTHEAST



**LEGEND**

- PROPERTY LINE — SUBJECT PARCEL
- - - ABUTTERS PROPERTY LINE
- - - EASEMENT LINE
- IRON ROD/PIPE FOUND
- BOUND FOUND
- △ CALCULATED POINT
- N/F NOW OR FORMERLY
- 10-6/067 ASSESSOR'S ID
- ⊙ TOWER CONTROL POINT

**SITE SPECIFIC NOTES:**

1. FIELD SURVEY DATE: 10/15/2021
2. HORIZONTAL DATUM: NORTH AMERICAN DATUM OF 1983 (NAD83)
3. VERTICAL DATUM: NORTH AMERICAN VERTICAL DATUM OF 1988 (NAVD88)
4. OWNER: CITY OF MIDDLETOWN  
245 DEKOVEN DRIVE  
MIDDLETOWN, CT 06457
5. SITE NAME: MIDDLETOWN\_MILE LANE
6. SITE ADDRESS: 499 MILE LANE  
MIDDLETOWN, CT 06457  
MIDDLESEX COUNTY
7. APPLICANT: AT&T
8. TAX ID: 10-0030
9. DEED REFERENCE: DEED BOOK 1771 PAGE 194
10. PLAN REFERENCE: PLAN 20 OF 20019  
PLAN 80 OF 2014  
PLAN #2243
11. ZONING DISTRICT: R-15
12. THE HORIZONTAL DATUM AND VERTICAL DATUM WERE DERIVED FROM A DUAL FREQUENCY GPS SURVEY.
13. ALL UNDERGROUND UTILITY INFORMATION PRESENTED HEREON WAS DETERMINED FROM SURFACE EVIDENCE AND PLANS OF RECORD. ALL UNDERGROUND UTILITIES SHOULD BE LOCATED IN THE FIELD PRIOR TO COMMENCEMENT OF ALL SITE WORK. CALL DIGSAFE 1-800-322-4844 A MINIMUM OF 72 HOURS PRIOR TO PLANNED ACTIVITY.
14. ACCORDING TO FEDERAL EMERGENCY MANAGEMENT AGENCY MAPS, THE PROPOSED IMPROVEMENTS ON THIS PROPERTY ARE LOCATED IN AN AREA DESIGNATED AS ZONE X (UNSHADED), AREA OF MINIMAL FLOOD HAZARD. MAP NO. 09007C 0108 G EFFECTIVE DATE: 8/28/2008
15. FIELD SURVEY BY EDM TOTAL STATION & RTK GPS.
16. WETLAND DELINEATION WAS PERFORMED AND LOCATED BY ALL-POINTS TECHNOLOGY CORP.

THIS SURVEY HAS BEEN PREPARED PURSUANT TO THE REGULATIONS OF CONNECTICUT STATE AGENCIES SECTIONS 20-300B-1 THROUGH 20-300B-20 AND THE "STANDARDS FOR SURVEYS AND MAPS IN THE STATE OF CONNECTICUT" AS ADOPTED BY THE CONNECTICUT ASSOCIATION OF LAND SURVEYORS INC. ON SEPTEMBER 26, 1997.

TYPE OF SURVEY: IMPROVEMENT LOCATION SURVEY  
 BOUNDARY SURVEY CATEGORY: DEPENDENT RESURVEY  
 CLASS OF ACCURACY: HORIZONTAL CLASS D  
 VERTICAL CLASS V-2  
 TOPOGRAPHIC CLASS T-2  
 PURPOSE OF SURVEY: PROPOSED CELLULAR UTILITIES

THIS DOCUMENT AND COPIES THEREOF ARE VALID ONLY IF THEY BEAR THE LIVE SIGNATURE AND EMBOSSED SEAL OF THE DESIGNATED PROFESSIONAL. UNAUTHORIZED ALTERATIONS RENDER ANY DECLARATION NULL AND VOID.

TO THE BEST OF MY KNOWLEDGE AND BELIEF, THIS MAP IS SUBSTANTIALLY CORRECT AS NOTED HEREON.

*Charles G. Gidman*  
 CHARLES G. GIDMAN, P.L.S. #70103

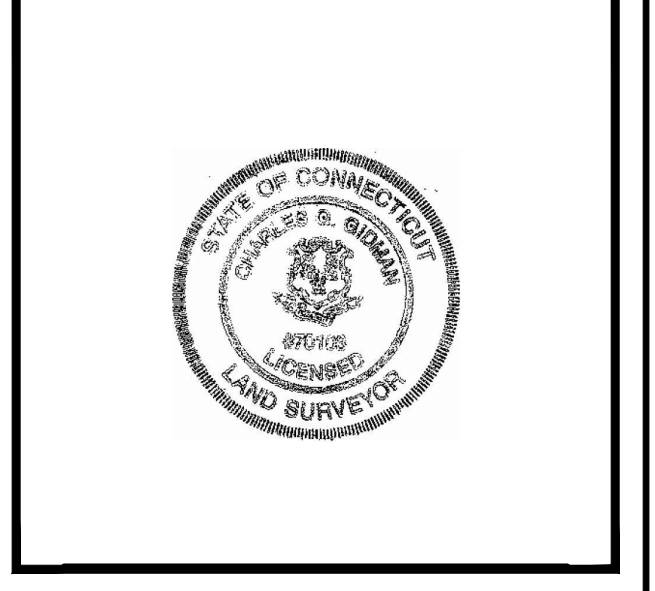
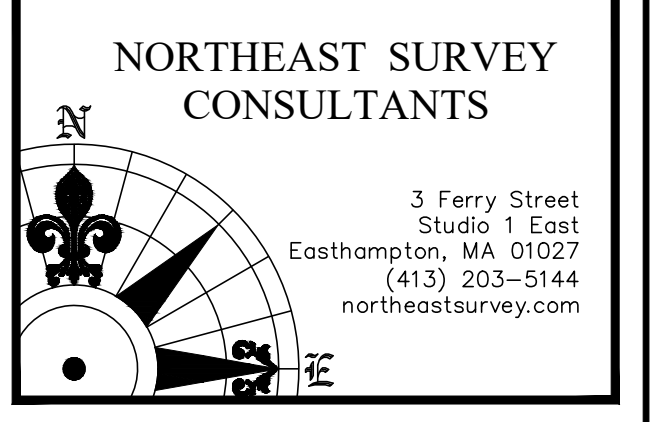

CHECKED BY: BCF

APPROVED BY: CCG

SUBMITTALS			
REV.	DATE	DESCRIPTION	BY
0	11/23/2021	ISSUED FOR REVIEW	JDG

SITE NUMBER:  
CT3470A  
 SITE NAME:  
MIDDLETOWN\_MILE LANE  
 SITE ADDRESS:  
499 MILE LANE  
MIDDLETOWN, CT 06457  
MIDDLESEX COUNTY

SHEET TITLE  
 ABUTTERS PLAN

SHEET NUMBER  
**C-1**

NOTE:  
REFER TO THE FINAL RF DATA SHEET  
FOR FINAL ANTENNA SETTINGS.

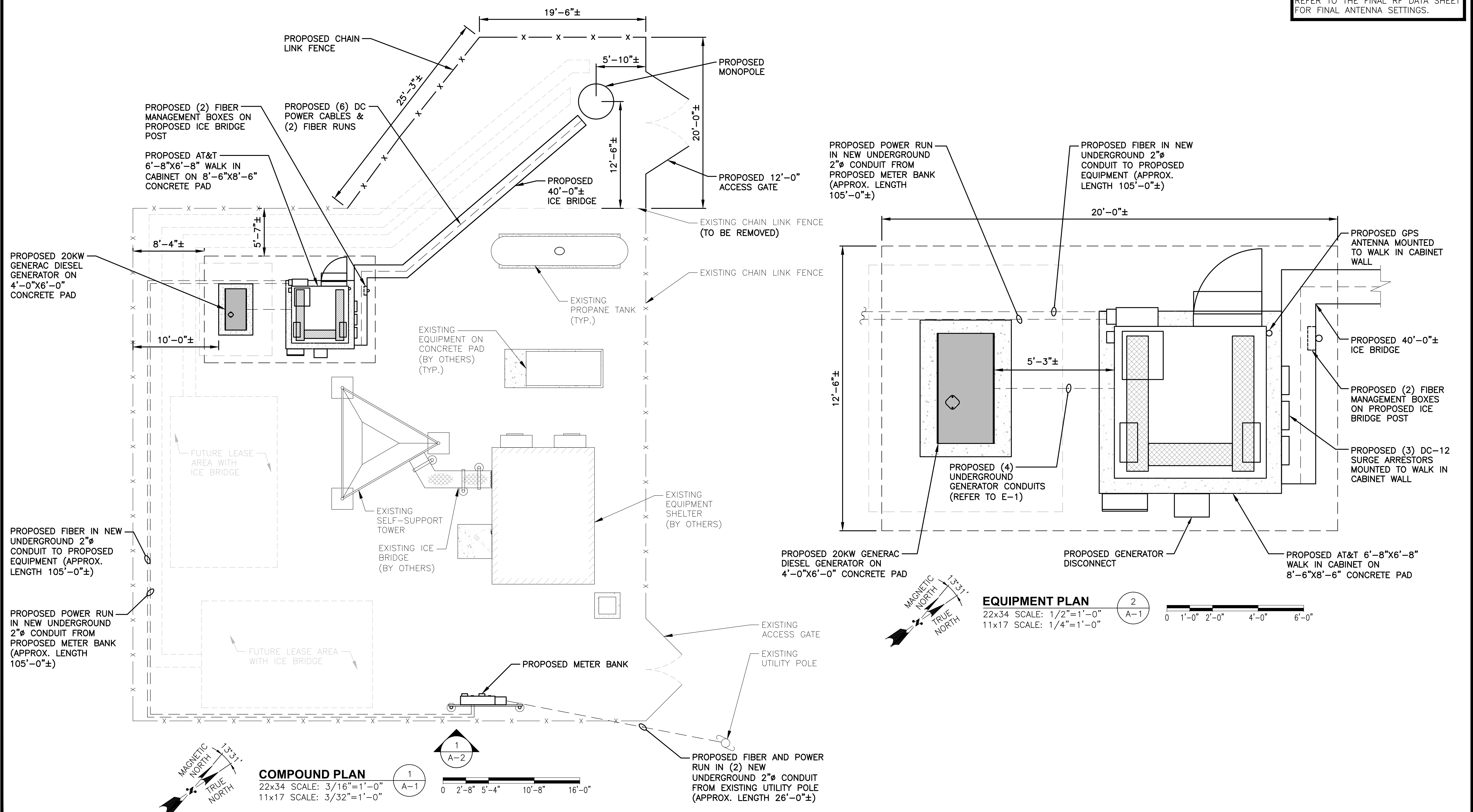

**COMPOUND PLAN**

22x34 SCALE: 3/16"=1'-0"  
11x17 SCALE: 3/32"=1'-0"

1  
A-1



**EQUIPMENT PLAN**

22x34 SCALE: 1/2"=1'-0"  
11x17 SCALE: 1/4"=1'-0"

2  
A-1



45 BEECHWOOD DRIVE  
NORTH ANDOVER, MA 01845  
TEL: (978) 557-5553  
FAX: (978) 336-5586



1997 ANNAPOLIS EXCHANGE PKWY  
SUITE 200  
ANNAPOLIS, MD 21401

**SITE NUMBER: CT3470A**  
**SITE NAME: MIDDLETOWN\_MILE LANE**

499 MILE LANE  
MIDDLETOWN, CT 06457  
MIDDLESEX COUNTY



550 COCHITUATE ROAD  
FRAMINGHAM, MA 01701

4	12/10/21	ISSUED FOR REVIEW	CC	JC	DPH
3	11/22/21	ISSUED FOR REVIEW	CC	JC	DPH
2	11/16/21	ISSUED FOR REVIEW	AR	JC	DPH
1	09/22/21	ISSUED FOR REVIEW	AR	JC	DPH
0	04/07/21	ISSUED FOR REVIEW	VP	JC	DPH
NO.	DATE	REVISIONS	BY	CHK	APP'D
SCALE: AS SHOWN		DESIGNED BY: JC	DRAWN BY: CC/VP		

**AT&T**  
**COMPOUND & EQUIPMENT PLAN**  
**(NSB)**

SITE NUMBER	DRAWING NUMBER	REV
CT3470A	A-1	4

TOP OF EXISTING TOWER  
ELEV. = 180'-0"± A.G.L

EXISTING TOWER

TOP OF PROPOSED MONOPOLE & C OF PROPOSED AT&T ANTENNAS  
ELEV. = 150'-0"± A.G.L

PROPOSED AT&T 6'-8"X6'-8" WALK IN CABINET ON 8'-6"X8'-6" CONCRETE PAD

PROPOSED 20KW GENERAC DIESEL GENERATOR ON 4'-0"X6'-0" CONCRETE PAD

GROUND LEVEL  
ELEV. = 0'-0"± A.G.L

**ELEVATION**

22x34 SCALE: 3/32"=1'-0"  
11x17 SCALE: 3/64"=1'-0"

1  
A-2

0 5'-4" 10'-8" 21'-4" 32'-0"

PROPOSED SURGE ARRESTOR (TOTAL OF 3)

PROPOSED AT&T ANTENNAS (TYP. OF 3 PER SECTOR, TOTAL OF 9)

PROPOSED AT&T RRH'S (TYP. OF 4 PER SECTOR, TOTAL OF 12)

FUTURE AT&T RRH'S (TYP. OF 1 PER SECTOR, TOTAL OF 3)

PROPOSED MONOPOLE

PROPOSED 40'-0"± ICE BRIDGE

EXISTING EQUIPMENT SHELTER (BY OTHERS)

PROPOSED METER BANK

EXISTING PROPANE TANK (BY OTHERS)

EXISTING CHAIN LINK FENCE

PROPOSED AT&T RRH'S (TYP. OF 4 PER SECTOR, TOTAL OF 12)

PROPOSED 3" STD. (3.5" O.D.) 6'-0" LONG PIPE MAST (TYP. OF 1 PER SECTOR, TOTAL OF 3)

PROPOSED 2' STAND-OFF VALMONT PART# MM02 (TOTAL OF 2 PER SECTOR, TOTAL OF 6)

PROPOSED MONOPOLE

PROPOSED AT&T ANTENNAS (TYP. OF 3 PER SECTOR, TOTAL OF 9)

PROPOSED SECTOR FRAME VALMONT PART# VFA12-WLL-30120 (TYP. OF 1 PER SECTOR, TOTAL OF 3)

FUTURE AT&T RRH'S (BELOW) (TYP. OF 1 PER SECTOR, TOTAL OF 3)

PROPOSED COLLAR MOUNT VALMONT PART# LWRM (TOTAL OF 2)

PROPOSED SURGE ARRESTOR (TYP. OF 1 PER SECTOR, TOTAL OF 3)

NOTE:  
REFER TO THE FINAL RF DATA SHEET FOR FINAL ANTENNA SETTINGS.

NOTE:  
HDG RECOMMENDS THE PROPOSED ANTENNA MOUNT BE MAPPED IN ITS ENTIRETY & A STRUCTURAL ANALYSIS BE PERFORMED PRIOR TO THE ANTENNA INSTALLATION.

NOTE:  
AN ANALYSIS FOR THE CAPACITY OF THE PROPOSED STRUCTURES TO SUPPORT THE PROPOSED EQUIPMENT SHALL BE DETERMINED PRIOR TO CONSTRUCTION.

SECTOR C  
220°

SECTOR A  
15°

SECTOR B  
110°

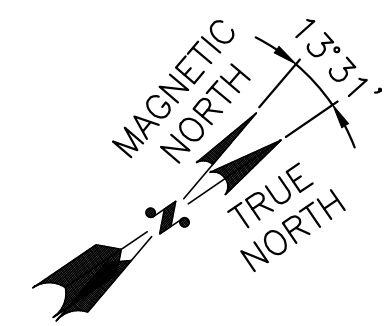

**PROPOSED ANTENNA LAYOUT DESIGN**

SCALE: N.T.S

2  
A-2



45 BEECHWOOD DRIVE  
NORTH ANDOVER, MA 01845  
TEL: (978) 557-5553  
FAX: (978) 336-5586



1997 ANNAPOLIS EXCHANGE PKWY  
SUITE 200  
ANNAPOLIS, MD 21401

SITE NUMBER: CT3470A  
SITE NAME: MIDDLETOWN\_MILE LANE

499 MILE LANE  
MIDDLETOWN, CT 06457  
MIDDLESEX COUNTY



550 COCHITUATE ROAD  
FRAMINGHAM, MA 01701

4	12/10/21	ISSUED FOR REVIEW	CC	JC	DPH
3	11/22/21	ISSUED FOR REVIEW	CC	JC	DPH
2	11/16/21	ISSUED FOR REVIEW	AR	JC	DPH
1	09/22/21	ISSUED FOR REVIEW	AR	JC	DPH
0	04/07/21	ISSUED FOR REVIEW	VP	JC	DPH
NO.	DATE	REVISIONS	BY	CHK	APP'D
SCALE: AS SHOWN		DESIGNED BY: JC	DRAWN BY: CC/VP		

AT&T		
ELEVATION AND ANTENNA PLAN (NSB)		
SITE NUMBER	DRAWING NUMBER	REV
CT3470A	A-2	4