

ADJACENT PROPERTY OWNERS

SITE NAME: WOLCOTT SOUTH

OWNER NAME: PAL PROPERTIES LLC

PROPERTY ADDRESS: CHESTNUT HILL ROAD, WOLCOTT, CT

MAP: 104 BLOCK: 1 LOT: 5B

THE FOLLOWING INFORMATION WAS COLLECTED FROM THE TOWN'S ONLINE GIS AND TAX ASSESSOR'S RECORDS ON JULY 10, 2020.

THE PARCEL IS ZONED INDUSTRIAL- I AND R-40 (RESIDENTIAL)

| | <u>Property Address</u> | <u>Owner and Mailing Address</u> |
|----|--------------------------------|---|
| 1. | 90 Chestnut Hill Road | Paul R. and Beverly Devino 90 Chestnut Hill Road Wolcott, CT 06716 |
| 2. | Chestnut Hill Road | Michael R. Van Geons 67 Oakville Avenue Waterbury, CT 06708 |
| 3. | Grilley Road | Executive Hill LLC 67 Oakville Avenue Waterbury, CT 06708 |
| 4. | 6 Grilley Road | Alma Hock Smith and Timothy C. Smith 6 Grilley Road Wolcott, CT 06716 |
| 5. | 110 Chestnut Hill Road | Stuart D. Stolfi 110 Chestnut Hill Road Wolcott, CT 06716 |
| 6. | 97 Chestnut Hill Road | Jessica M. Tynan and Charles M. Lynch 97 Chestnut Hill Road Wolcott, CT 06716 |

CERTIFICATION OF SERVICE

I hereby certify that a copy of the foregoing letter was sent by certified mail, return receipt requested, to each of the parties on the attached list of abutting landowners.

August 27, 2020

Date

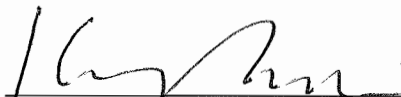

Kenneth C. Baldwin, Esq.
Robinson & Cole LLP
280 Trumbull Street
Hartford, CT 06103

Attorneys for Cellco Partnership d/b/a Verizon
Wireless

KENNETH C. BALDWIN

280 Trumbull Street
Hartford, CT 06103-3597
Main (860) 275-8200
Fax (860) 275-8299
kbaldwin@rc.com
Direct (860) 275-8345

Also admitted in Massachusetts
and New York

August 27, 2020

Via Certified Mail, Return Receipt Requested

«Name_and_Address»

**Re: Cellco Partnership d/b/a Verizon Wireless – Proposed Telecommunications Facility
off Chestnut Hill Road, Wolcott, Connecticut**

Dear «Salutation»:

Cellco Partnership d/b/a Verizon Wireless (“Cellco”) will be submitting an application to the Connecticut Siting Council (“Council”) on or about September 2, 2020, for the construction of a new telecommunications facility in the Town of Wolcott, Connecticut.

The proposed facility would consist of a new 120-foot monopole tower in the northern portion of a 10.17-acre parcel south of Chestnut Hill Road in Wolcott (the “Property”). The tower, radio equipment, backup generator and propane fuel tank will be installed within a 50’ x 50’ fenced facility compound. Access to the facility would extend from Chestnut Hill Road along a new gravel access driveway. Site plan drawings showing the Property and the proposed facility improvements are attached for your review. The location and other features of the proposed facility, including tower height, are subject to change under the provisions of Connecticut General Statutes § 16-50g et seq. and 47 U.S.C. § 1455e.

State law provides that owners of record of property which abuts a parcel on which a facility is proposed to be located must receive notice of the submission of this application. This notice is directed to you either because you may be an abutting land owner or as a courtesy notice.

August __, 2020
Page 2

If you have any questions concerning the application, please direct them to either the Connecticut Siting Council or me. My address and telephone number are listed above. The Siting Council may be reached at its New Britain, Connecticut office at (860) 827-2935.

Very truly yours,

A handwritten signature in black ink, appearing to read "Kenneth C. Baldwin". The signature is fluid and cursive, with a long horizontal stroke at the end.

Kenneth C. Baldwin

KCB/kmd
Attachment



CELCO PARTNERSHIP 96 1/2 VERIZON WIRELESS
20 ALEXANDER DRIVE, 2ND FLOOR
WALLINGFORD, CT 06492

SITE NAME:
WOLCOTT_SOUTH_CT
LOCATION CODE:
469936
SITE ADDRESS:
**CHESTNUT HILL ROAD
WOLCOTT, CT 06716**



Know what's below.
Call before you dig.

SITE INFORMATION

SITE NAME: WOLCOTT_SOUTH_CT
LOCATION CODE: 469936
SITE ADDRESS: CHESTNUT HILL ROAD
WOLCOTT, CT 06716
COUNTY: NEW HAVEN COUNTY
LATITUDE: 41° 35' 24.03" N (NAD83)
LONGITUDE: 73° 00' 31.02" W (NAD83)
GROUND LEVEL: 786' A.M.S.L. (NAD83)
PROPERTY OWNER: PAL PROPERTIES, LLC
1141 WOLCOTT HILL ROAD
WOLCOTT, CT 06716
STRUCTURE TYPE: 120'-0"± MONOPOLE
HIGHEST APURTEANCE: 125'-0"± LIGHTNING ROD

VICINITY MAP

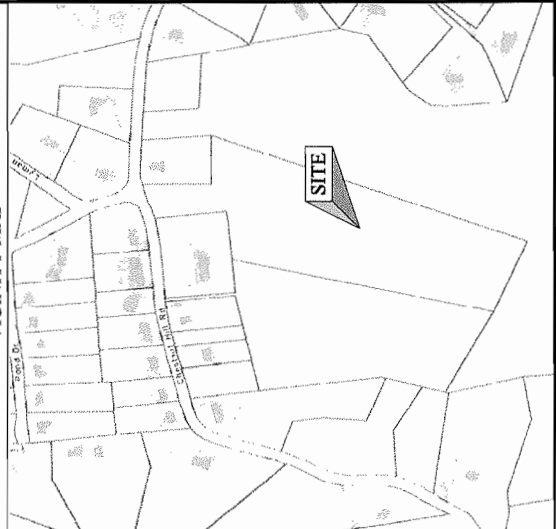

GENERAL NOTES AND APPLICABLE CODES

- THIS IS AN UNSTAFFED TELECOMMUNICATION FACILITY AND NOT FOR HUMAN HABITATION.
 - HANDICAPPED ACCESS IS NOT REQUIRED.
 - POTABLE WATER OR SANITARY SERVICE IS NOT REQUIRED.
 - NO OUTDOOR STORAGE OR ANY SOLID WASTE RECEPACLES REQUIRED.
- CONTRACTOR SHALL VERIFY ALL PLANS, EXISTING DIMENSIONS, AND CONDITIONS ON THE JOB SITE. CONTRACTOR SHALL IMMEDIATELY NOTIFY THE ARCHITECT/ENGINEER IN WRITING OF ANY DISCREPANCIES BEFORE PROCEEDING WITH THE WORK. FAILURE TO NOTIFY THE ARCHITECT/ENGINEER WILL BE CONSIDERED AS CONSENT ON THE CONTRACTOR TO CORRECT THE DISCREPANCIES AT THE CONTRACTOR'S EXPENSE.
- DEVELOPMENT AND USE OF THIS SITE WILL CONFORM TO ALL APPLICABLE CODES, ORDINANCES AND SPECIFICATIONS.
 - BUILDING CODE: 2018 CONNECTICUT STATE BUILDING CODE (IBC 2015)
 - ELECTRICAL CODE: NATIONAL ELECTRIC CODE 2017
 SUBCONTRACTOR'S WORK SHALL COMPLY WITH THE LATEST EDITION OF THE FOLLOWING STANDARDS:
 - AMERICAN CONCRETE INSTITUTE (ACI) 318, BUILDING CODE REQUIREMENTS FOR STRUCTURAL CONCRETE
 - AMERICAN INSTITUTE OF STEEL CONSTRUCTION (AISC), MANUAL OF STEEL CONSTRUCTION.
 - TELECOMMUNICATIONS INDUSTRY ASSOCIATION (TIA), STEEL ANTENNA SUPPORTING STRUCTURES AND ANTENNAS WITH ADDENDUM.
 - TIA 807, GENERIC TELECOMMUNICATIONS BONDING AND GROUNDING (GAPFILING) FOR CUSTOMER PREMISES.
 - AND EARTH SURFACE POTENTIALS OF A GROUNDING SYSTEM.
 - IEEE 81, GUIDE FOR MEASURING EARTH RESISTIVITY, GROUND IMPEDANCE, AND EARTH SURFACE POTENTIALS OF A GROUNDING SYSTEM.
 - IEEE 100, (GOOD) RECOMMENDED PRACTICE FOR POWERING AND GROUNDING OF TELECOMMUNICATIONS EQUIPMENT.
 - IEEE C92.41.1, RECOMMENDED PRACTICES ON CHARACTERIZATION OF SURGES IN LOW VOLTAGE (1000V OR LESS) AC POWER CIRCUITS.
 - TELECOMMUNICATIONS INDUSTRY ASSOCIATION (TIA), TIA-609, TELECOMMUNICATIONS - DC POWER SYSTEMS - TELECOMMUNICATIONS ENVIRONMENT PROTECTION.
 - FOR ANY CONFLICTS BETWEEN SECTIONS OF LISTED CODES AND STANDARDS REGARDING MATERIAL, METHODS OF CONSTRUCTION, OR OTHER REQUIREMENTS, THE MOST RESTRICTIVE MATERIAL, METHOD OF CONSTRUCTION, OR OTHER REQUIREMENT SHALL GOVERN. AND A SPECIFIC REQUIREMENT, THE SPECIFIC REQUIREMENT SHALL GOVERN.

SHEET INDEX

| SHEET NUMBER | SHEET DESCRIPTION |
|--------------|--|
| T-1 | TITLE SHEET |
| C-1 | ABUTTERS PLAN |
| C-2 | EXISTING CONDITIONS |
| Z-1 | COMPOUND ELEVATION, ENLARGED SITE PLAN & SEDIMENTATION NOTES |
| OS-1 | OVERALL SITE PLAN |
| SP-1 | PARTIAL SITE PLAN |
| SP-2 | SITE DETAILS |
| SP-3 | SITE DETAILS |

APPROVALS

THE FOLLOWING PARTIES HEREBY APPROVE AND ACCEPT THESE DOCUMENTS AND AUTHORIZE THE CONTRACTOR TO PROCEED WITH THE WORK. THESE DOCUMENTS ARE SUBJECT TO REVIEW BY THE LOCAL BUILDING DEPARTMENT AND MAY IMPOSE CHANGES OR MODIFICATIONS.

LEASING/SITE ACQUISITION: _____ DATE: _____
 LANDLORD: _____ DATE: _____
 VERIZON WIRELESS CM: _____ DATE: _____
 VERIZON WIRELESS RF: _____ DATE: _____

PREPARED BY:

nexius
PROVIDE YOUR BUSINESS VERIZON WIRELESS

ARE OFFICE:
 300 APOLLO DRIVE, SUITE 7
 CHESTNUT HILL, CT 06716
 1 (978) 925-7989

APPLICANT:

CELCO PARTNERSHIP db/a
verizon
 20 ALEXANDER DRIVE, 2ND FLOOR
 WALLINGFORD, CT 06492

PROFESSIONAL STAMP



THIS DOCUMENT IS THE PROPERTY OF NEXIUS AND IS NOT TO BE REPRODUCED OR TRANSMITTED IN ANY FORM OR BY ANY MEANS, ELECTRONIC OR MECHANICAL, INCLUDING PHOTOCOPYING, RECORDING, OR BY ANY INFORMATION STORAGE AND RETRIEVAL SYSTEM, WITHOUT THE WRITTEN PERMISSION OF NEXIUS. THE USER OF THIS DOCUMENT IS STRICTLY PROHIBITED FROM REPRODUCING OR TRANSMITTING THIS DOCUMENT IN ANY FORM OR BY ANY MEANS, ELECTRONIC OR MECHANICAL, INCLUDING PHOTOCOPYING, RECORDING, OR BY ANY INFORMATION STORAGE AND RETRIEVAL SYSTEM, WITHOUT THE WRITTEN PERMISSION OF NEXIUS.

SUBMITTALS

| REV | DATE | DESCRIPTION | BY |
|-----|----------|-------------|----|
| 0 | 04/28/20 | FOR REVIEW | MD |
| 1 | 05/06/20 | FOR CEC | MD |

SITE INFO:

SITE NAME:
WOLCOTT_SOUTH_CT
LOCATION CODE:
469936

SITE ADDRESS:
**CHESTNUT HILL ROAD
WOLCOTT, CT 06716
NEW HAVEN COUNTY**

SHEET TITLE:

TITLE SHEET

NEXIUS PROJ. NO. **VZ11509**

CHECKED BY: **RSJ/AM/JH**

CHECKED BY DATE: **05/06/20**

T-1

SHEET NUMBER:

PREPARED BY:
nexius
THEORY YOUR SUBJECT. INSIDE THE BOX.
300 APOLLO DRIVE, SUITE 7
CHELSEA, MA 01824
1 (978) 933-7385

APPPLICANT:
CELCO PARTNERSHIP db/a
verizon
20 ALEXANDER DRIVE, 3RD FLOOR
WALLINGFORD, CT 06492

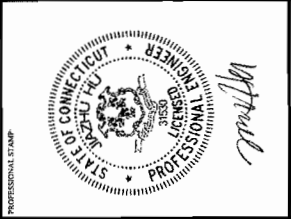

THIS PLAN AND ALL INFORMATION CONTAINED HEREON IS THE PROPERTY OF NEXIUS AND IS TO BE USED ONLY FOR THE PROJECT AND SITE IDENTIFIED HEREON. ANY REUSE OR MODIFICATION OF THIS PLAN WITHOUT THE WRITTEN PERMISSION OF NEXIUS IS STRICTLY PROHIBITED. DRAWING SCALES ARE INTENDED FOR A11" X 17" SIZE PRINTED AND NOT TO SCALE.

| REV | DATE | DESCRIPTION | BY |
|-----|----------|-------------|----|
| 0 | 01/28/20 | FOR REVIEW | MB |
| 1 | 05/06/20 | FOR CSC | MB |

DATE: 05/06/20
TIME: 10:00 AM

SITE NAME:
WOLCOTT_SOUTH_CT
LOCATION CODE:
489336
SITE ADDRESS:
**CHESTNUT HILL ROAD
WOLCOTT, CT 06716
NEW HAVEN COUNTY**

SHEET TITLE:
CONSTRUCTION EROSION & SEDIMENTATION NOTES

SHEET NUMBER:
Z-1

CHECKED BY:
MB/JAN/JH

CHECKED BY DATE:
05/06/20

- ### EROSION & SEDIMENTATION CONTROL NOTES
1. ALL EARTH DISTURBANCE ACTIVITIES INCLUDING CLEARING AND GRUBBING AS WELL AS DIRT AND FILL SHALL BE DONE DURING THE WETTER MONTHS OF THE YEAR. ALL EROSION CONTROL MEASURES SHALL BE INSTALLED PRIOR TO THE START OF ANY EARTH DISTURBANCE ACTIVITY. EROSION CONTROL MEASURES SHALL BE MAINTAINED THROUGHOUT THE CONSTRUCTION PERIOD. THE EROSION CONTROL PLAN SHALL BE REVIEWED AND APPROVED BY THE LOCAL CONSERVATION DISTRICT PRIOR TO THE START OF ANY EARTH DISTURBANCE ACTIVITY.
 2. AT LEAST 7 DAYS PRIOR TO STARTING ANY EARTH DISTURBANCE ACTIVITIES, INCLUDING CLEARING AND GRUBBING, THE OPERATOR SHALL NOTIFY THE LOCAL CONSERVATION DISTRICT BY TELEPHONE AND BY MAIL OF THE EARTH DISTURBANCE ACTIVITIES TO BE PERFORMED. THE LOCAL CONSERVATION DISTRICT SHALL BE NOTIFIED BY MAIL AT LEAST 7 DAYS PRIOR TO THE START OF ANY EARTH DISTURBANCE ACTIVITY.
 3. ALL EARTH DISTURBANCE ACTIVITIES SHALL PROCEED IN ACCORDANCE WITH THE SEQUENCE PROVIDED ON THE CONSTRUCTION DISTRICT OR BY THE DEPARTMENT ORDER TO STOP WORK.
 4. AREAS TO BE CLEARED OR TO BE GRUBBED SHALL BE STRIPPED OF TOPSOIL TO REMOVE TREES, STUMPED, AND STOCKPILED IN AN AREA APPROVED BY THE LOCAL CONSERVATION DISTRICT.
 5. CLEARING, GRUBBING, AND TOPSOIL STRIPPING SHALL BE LIMITED TO THOSE AREAS DESCRIBED IN EACH STAGE OF THE CONSTRUCTION SEQUENCE. GENERAL SITE CLEARING, GRUBBING AND TOPSOIL STRIPPING MAY NOT BE PERFORMED IN ANY OTHER AREAS OF THE SITE UNLESS APPROVED BY THE LOCAL CONSERVATION DISTRICT.
 6. AT NO TIME SHALL CONSTRUCTION VEHICLES BE ALLOWED TO ENTER AREAS OUTSIDE THE LIMIT OF DISTURBANCE BOUNDARIES SHOWN ON THE PLAN MAPS. THESE AREAS MUST BE CLEARLY MARKED AND FENCED OFF BEFORE CLEARING AND GRUBBING OPERATIONS BEGIN.
 7. THE LOCAL CONSERVATION DISTRICT SHALL BE NOTIFIED AT THE COMMENCEMENT OF ANY EARTH DISTURBANCE ACTIVITY. THE OPERATOR SHALL BE RESPONSIBLE FOR NOTIFYING THE LOCAL CONSERVATION DISTRICT OF ANY CHANGES TO THE EROSION CONTROL PLAN. THE OPERATOR SHALL NOTIFY THE LOCAL CONSERVATION DISTRICT OF ANY CHANGES TO THE EROSION CONTROL PLAN.
 8. IMMEDIATELY UPON DISCOVERING UNEXPECTED CIRCUMSTANCES POSING THE POTENTIAL FOR ACCELERATED EROSION AND/OR SEDIMENT POLLUTION, THE OPERATOR SHALL IMPLEMENT APPROPRIATE BEST MANAGEMENT PRACTICES TO PREVENT FURTHER POLLUTION. THE OPERATOR SHALL NOTIFY THE LOCAL CONSERVATION DISTRICT AND/OR THE DEPARTMENT OF THE DISCOVERY.
 9. ALL BUILDING MATERIALS AND WASTES SHALL BE REMOVED FROM THE SITE AND RECYCLED OR DISPOSED OF IN ACCORDANCE WITH THE DEPARTMENT'S SOLID WASTE MANAGEMENT REGULATIONS AT 26 PA CODE 260-1 ET SEQ. BURNED, BURIED, CUMULATED, OR DISCHARGED AT THE SITE.
 10. ALL OFF-SITE WASTE AND BORROW AREAS MUST HAVE AN EAS PLAN APPROVED BY THE LOCAL CONSERVATION DISTRICT OR THE DEPARTMENT FULLY IMPLEMENTED PRIOR TO BEING ACTIVATED.
 11. THE CONTRACTOR IS RESPONSIBLE FOR ENSURING THAT ANY MATERIAL BROUGHT ON SITE IS CLEAN FILL FROM A SOURCE APPROVED BY THE DEPARTMENT. THE CONTRACTOR SHALL MAINTAIN RECORDS OF ALL MATERIALS BROUGHT ON SITE AND RELEASE OF A REGULATED SUBSTANCE BUT QUALIFYING AS CLEAN FILL DUE TO ANALYTICAL TESTING.
 12. THIS PLAN, OVER UNDISTURBED VEGETATED AREAS.
 13. UNTIL THE SITE IS STABILIZED, ALL EROSION AND SEDIMENT BMPs SHALL BE MAINTAINED PROPERLY. THE CONTRACTOR SHALL BE RESPONSIBLE FOR MAINTAINING ALL EROSION AND SEDIMENT BMPs. THE CONTRACTOR SHALL MAINTAIN RECORDS OF ALL EROSION AND SEDIMENT BMPs. THE CONTRACTOR SHALL NOTIFY THE LOCAL CONSERVATION DISTRICT OF ANY CHANGES TO THE EROSION CONTROL PLAN.
 14. A LOG SHOWING DATES THAT EAS BMPs WERE INSPECTED AS WELL AS ANY DEFICIENCIES FOUND AND THE DATE CORRECTIVE MEASURES WERE TAKEN SHALL BE MAINTAINED ON THE SITE AND BE MADE AVAILABLE TO REGULATORY AGENCIES AT THE TIME OF INSPECTION.
 15. SEDIMENT TRACKED ONTO ANY PUBLIC ROADWAY OR SIDEWALK SHALL BE RETURNED TO THE CONSTRUCTION SITE BY THE END OF EACH WORK DAY AND DISPOSED IN THE MANNER DESCRIBED IN THIS PLAN. IN NO CASE SHALL WATER BE RELEASED INTO ANY PUBLIC WATERWAY, OR EMPTIED INTO ANY DRAINAGE DITCH, OR OTHER WATERWAY.
 16. ALL SEDIMENT REMOVED FROM BMPs SHALL BE DISPOSED OF IN THE MANNER DESCRIBED ON THE PLAN.
 17. AREAS WHICH ARE TO BE TOPSOILED SHALL BE SOURED TO A MINIMUM DEPTH OF 3 TO 4 INCHES AND TO A MINIMUM OF 2 INCHES OF TOPSOIL. IN PLACE PRIOR TO SEEDING AND MULCHING, FILL OUTCROPPED SHALL HAVE A MINIMUM OF 2 INCHES OF TOPSOIL.
 18. OTHER USES AND REGULATIONS SHALL BE MAINTAINED TO PROTECT EROSION, SEDIMENTATION, AND SUBSIDENCE AS COMPATIBLE WITH LOCAL REQUIREMENTS OR CODES.
 19. ALL EARTHEN FILLS SHALL BE PLACED IN COMPACTED LAYERS NOT TO EXCEED 9 INCHES IN THICKNESS.
 20. FILL MATERIALS SHALL BE FREE OF FROZEN PARTICLES, BRUSH, ROOTS, STD, OR OTHER FOREIGN OR OBSTRUCTIVE MATERIALS THAT WOULD INTERFERE WITH OR PRESENT OBSTACLES TO SATISFACTORY FILLS.
 21. FROZEN MATERIALS OR SOFT, MUCKY, OR HIGHLY COMPRESSIBLE MATERIALS SHALL NOT BE INCORPORATED INTO FILLS.
 22. FILL SHALL NOT BE PLACED ON SATURATED OR FROZEN SURFACES.
 23. STABILIZATION OF ALL EROSION AND SEDIMENT CONTROL MEASURES SHALL BE IN ACCORDANCE WITH THE STANDARDS OF THIS PLAN.
 24. ALL ORDER AREAS SHALL BE PERMANENTLY STABILIZED IMMEDIATELY UPON REACHING FINISHED GRADE. CUT SLOPES IN COMPETENT BEDROCK AND ROCK FILLS NEED NOT BE VEGETATED. SEEDING AREAS WITHIN 50 FEET OF THE STANDARDS OF THIS PLAN.
 25. IMMEDIATELY AFTER EARTH DISTURBANCE ACTIVITIES CEASE IN ANY AREA OR SUBAREA OF THE PROJECT, THE OPERATOR SHALL STABILIZE ALL DISTURBED AREAS DURING NON-GERMINATING MONTHS, WHICH OR PREVIOUSLY REACTIVATED WITHIN 1 YEAR, MAY BE STABILIZED IN ACCORDANCE WITH THE EROSION CONTROL PLAN. STABILIZATION SHALL BE PERFORMED WITHIN 1 YEAR SHALL BE STABILIZED IN ACCORDANCE WITH THE PERMANENT STABILIZATION REQUIREMENTS.
 26. PERMANENT STABILIZATION IS DEFINED AS A MINIMUM UNIFORM PERENNIAL 70% VEGETATIVE COVER OR OTHER PERMANENT NON-VEGETATIVE COVER WITH A DENSITY SUFFICIENT TO PREVENT ACCELERATED EROSION, CUT AND FILL SLOPES SHALL BE CAPABLE OF RESISTING FAILURE DUE TO THERMAL, WIND, OR HYDRAULIC EROSION.
 27. STABILIZED OR UNTIL THEY ARE REPLACED BY ANOTHER BMP APPROVED BY THE LOCAL CONSERVATION DISTRICT OR THE DEPARTMENT.
 28. UPON COMPLETION OF ALL EARTH DISTURBANCE ACTIVITIES AND PERMANENT STABILIZATION OF ALL DISTURBED AREAS, THE OPERATOR SHALL NOTIFY THE LOCAL CONSERVATION DISTRICT FOR AN INSPECTION PRIOR TO REMOVAL/CONVERSION OF THE EAS BMPs.
 29. AFTER FINAL SITE STABILIZATION HAS BEEN ACHIEVED, TEMPORARY EROSION AND SEDIMENT BMPs MUST BE REMOVED OR CONVERTED TO PERMANENT EROSION AND SEDIMENTATION CONTROL MEASURES. AREAS TO BE REMOVED SHALL BE REMOVED IMMEDIATELY UPON COMPLETION OF PERMANENT STABILIZATION. AREAS TO BE ENHANCED RAPID REVEGETATION OF DISTURBED AREAS, SUCH REMOVAL/CONVERSION ARE TO BE DONE ONLY DURING THE GERMENATING SEASON.
 30. UPON COMPLETION OF ALL EARTH DISTURBANCE ACTIVITIES AND PERMANENT STABILIZATION OF ALL DISTURBED AREAS, THE OPERATOR SHALL CONTACT THE LOCAL CONSERVATION DISTRICT TO SCHEDULE A FINAL INSPECTION.
 31. CONSTRUCTION ACTIVITY WILL BE CONDUCTED IN ACCORDANCE WITH THE BASIC STABILIZATION STANDARDS OF MINE'S EROSION & SEDIMENTATION CONTROL, LW, 38 M.R.S.A. SECTION 420-C.
 32. THE CONSTRUCTION OF THIS FACILITY WILL HAVE NO EFFECT ON STORMWATER RUNOFF.

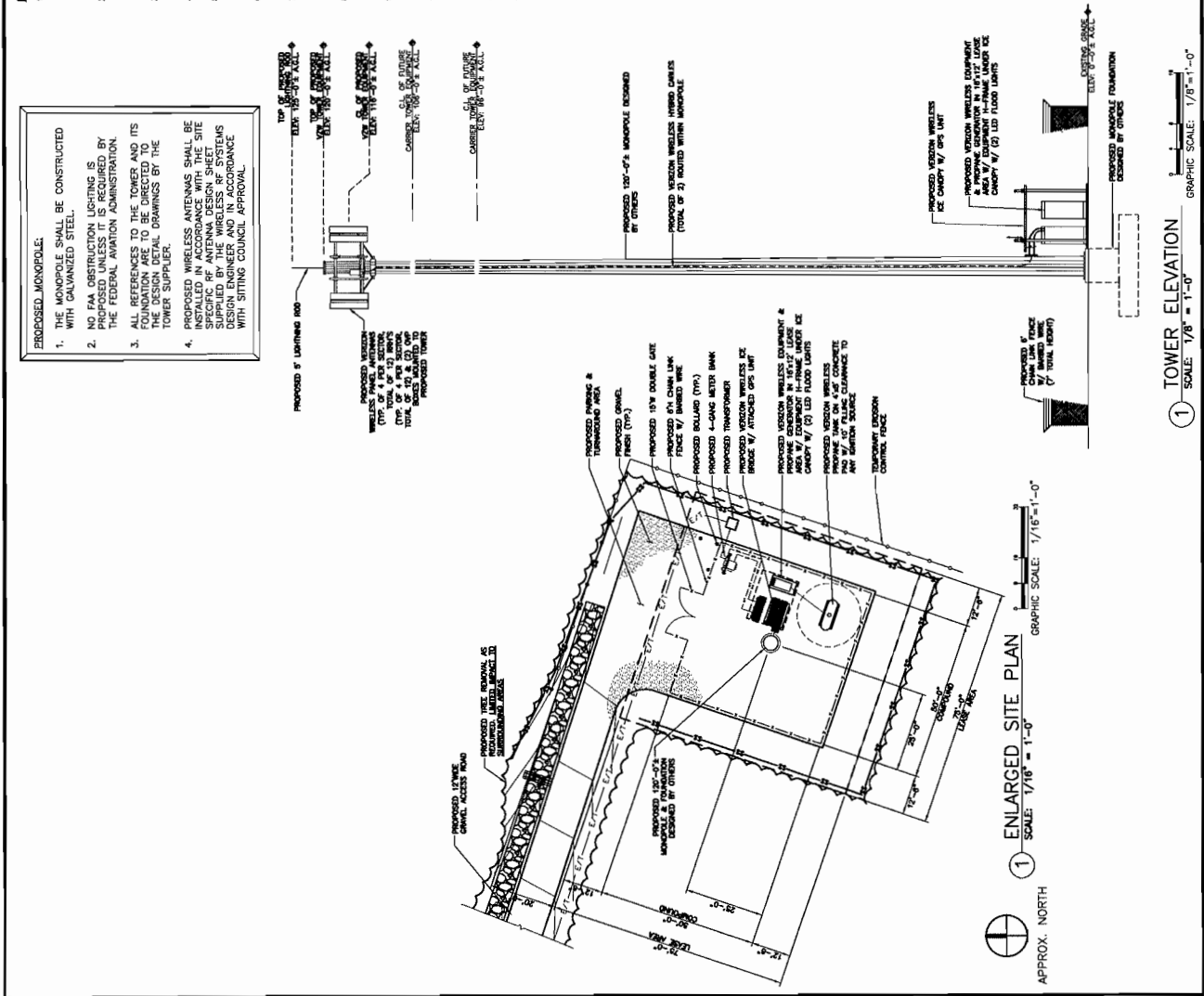

| PERMITTING DOCUMENTS | | |
|----------------------|----------|-------------------|
| NO. | DATE | REVISION |
| 0 | 05/24/20 | FOR REVIEW - S.P. |
| 1 | 05/26/20 | FOR CEC - S.P. |
| 2 | | |
| 3 | | |
| 4 | | |
| 5 | | |

| DESIGN PROFESSIONALS OF RECORD | |
|--------------------------------|--|
| PROF. SCOTT M. CHASSE P.E. | |
| 100 WOLCOTT SOUTH CT | |
| ADD: 80 WALDMAN STREET | |
| WATERBURY, CT 06705 | |

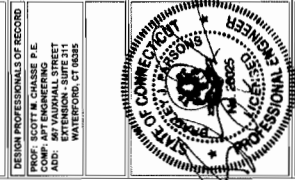

| VERIZON AT | |
|--------------------|-------------------|
| EST. NO. | WOLCOTT_SOUTH_CT |
| ADDRESS | WOLCOTT, CT 06716 |
| ART. FILING NUMBER | NY14180200 |
| DRAWN BY | CSH |
| CHECKED BY | BUP |
| DATE | 04/20/20 |

SHEET TITLE
OVERALL SITE PLAN

SHEET NUMBER
OS-1

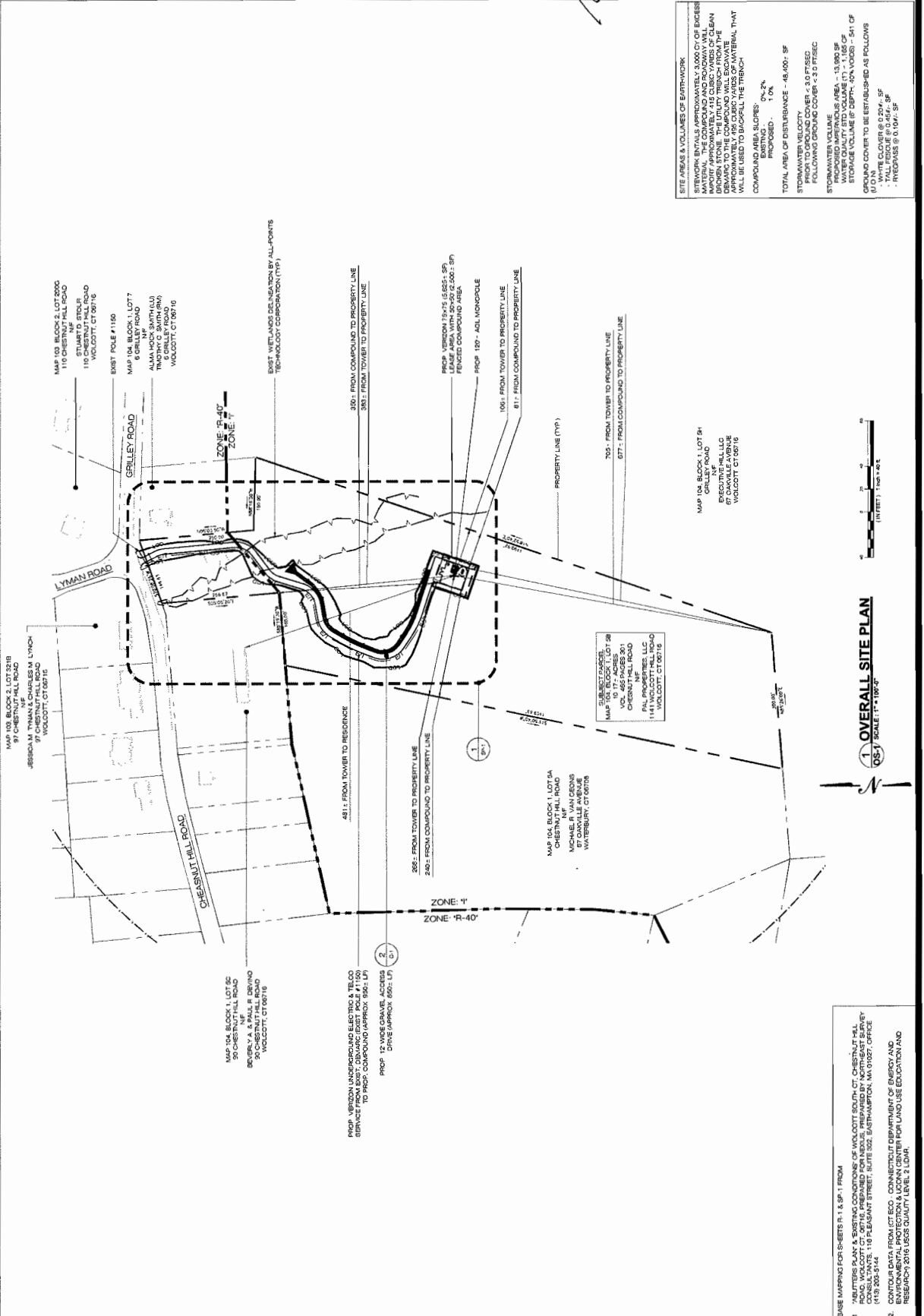

OVERALL SITE PLAN
 SCALE: 1" = 100'-0"



BASE MAPPING FOR SHEETS R-1 & SP-1 FROM
 1. "ADULTS PLAY & EXISTING CONDITIONS OF WOLCOTT SOUTH CT, CHESTNUT HILL ROAD, WOLCOTT, CT 06716" PROJECT BY SCOTT M. CHASSE, P.E., ALL-POINTS TECHNOLOGY CORPORATION, 40 NATIONAL STREET, SUITE 314, WALLINGFORD, CT 06495 (413) 200-5144
 2. CONTOUR DATA FROM CT ECO - CONNECTICUT DEPARTMENT OF ENERGY AND ENVIRONMENTAL SERVICES, 140 MAIN STREET, SUITE 100, HARTFORD, CT 06103
 RESEARCH DATA FROM WOLCOTT SOUTH CT, WOLCOTT, CT 06716

| PERMITTING DOCUMENTS | |
|----------------------|-------------------------------|
| NO | DATE / REVISION |
| 1 | ISSUED FOR REVIEW, S.P. |
| 2 | ISSUED FOR CONSTRUCTION, S.P. |
| 3 | |
| 4 | |
| 5 | |
| 6 | |

DESIGN PROFESSIONALS OF RECORD
 PROF. SCOTT M. CHASE, P.E.
 50 FARMHALL STREET
 SUITE 311
 MIDDLETOWN, CT 06455

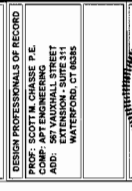

WOLCOTT SOUTH, CT
 CHEASNUT HILL ROAD
 ADDRESS: WOLCOTT, CT 06718
 APT. FILING NUMBER: NY14ND200
 DATE: 04/20/20
 DRAWN BY: CHS
 CHECKED BY: S.P.

SHEET TITLE:
PARTIAL SITE PLAN

SHEET NUMBER:
SP-1

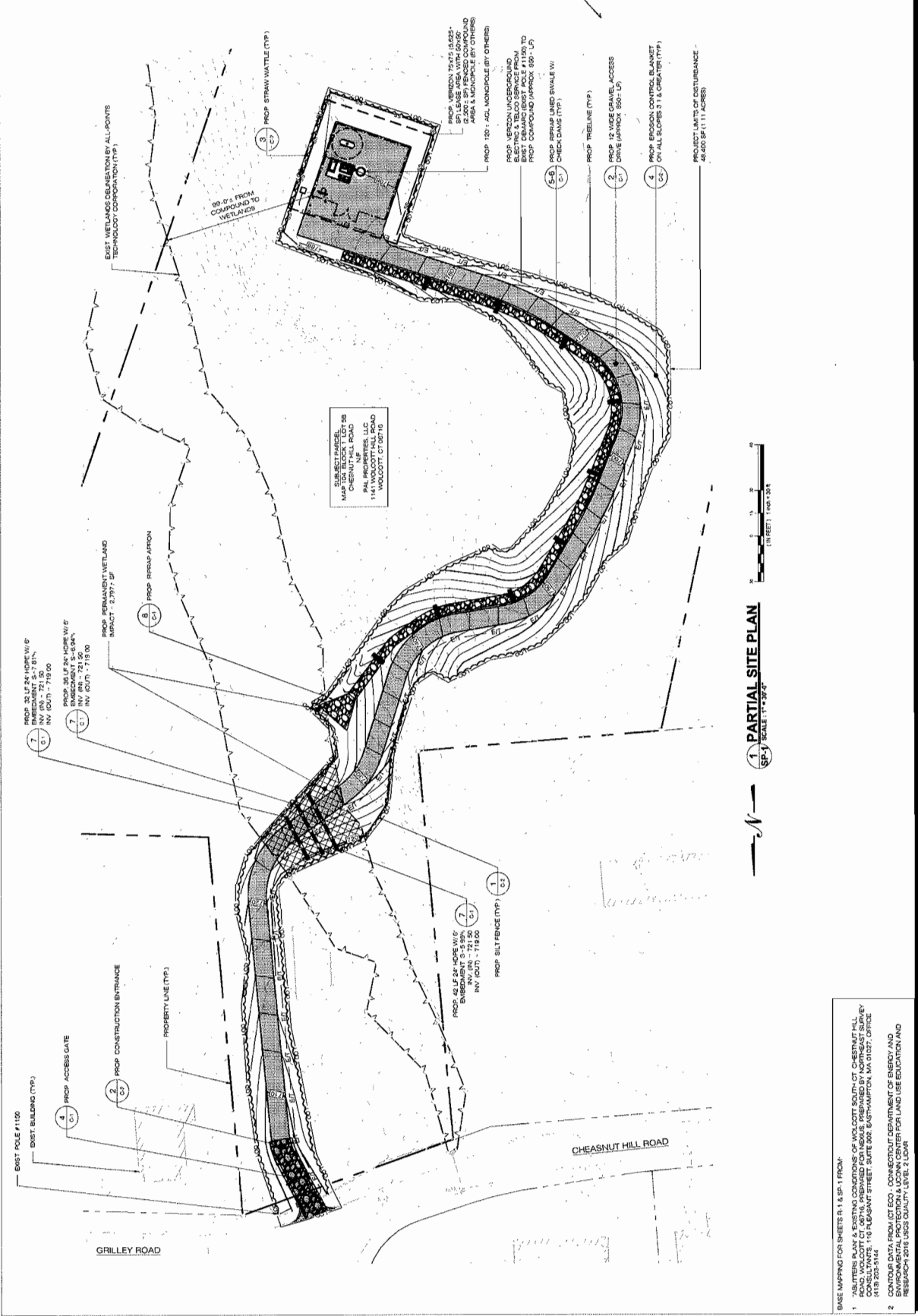

1 PARTIAL SITE PLAN
 SCALE: 1" = 30'

BASE MAPING FOR SHEETS R-1 & SP-1 FROM:
 1. 'AS-BUILT' PLAN & EXISTING CONDITIONS OF WOLCOTT SOUTH, CT CHEASNUT HILL ROAD, WOLCOTT, CT 06718, PREPARED BY ALL-POINTS TECHNOLOGY CORPORATION, CONSULTANTS TO PLANNING STREET, SUITE 300, EAST-WASHINGTON, MO. 01027, OFFICE #189-203-9144.
 2. CONTOUR DATA FROM CT EDC - CONNECTICUT DEPARTMENT OF ENERGY AND ENVIRONMENTAL SERVICES, STATE OF CONNECTICUT, CENTER FOR LAND USE EDUCATION AND RESEARCH, 2016 USGS QUALITY LEVEL 1 DATA.

PERMITTING DOCUMENTS

| NO | DATE | REVISION |
|----|----------|-----------------|
| 1 | 02/20/20 | FOR REVIEW B.P. |
| 2 | 02/20/20 | FOR CHECK B.P. |
| 3 | | |
| 4 | | |
| 5 | | |

DESIGN PROFESSIONALS OF RECORD

PROF. SCOTT K. CHASE P.E.
587 MAIN STREET
EXTENSION - SUITE 311
MIDDLETOWN, CT 06457

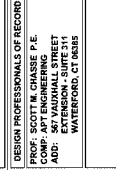

PROF. SCOTT K. CHASE P.E.
587 MAIN STREET
EXTENSION - SUITE 311
MIDDLETOWN, CT 06457

DATE: 02/20/20
DRAWN BY: CHJ
CHECKED BY: B.P.

WOLCOTT SOUTH, CT
SITE: CHESTNUT HILL ROAD
ADDRESS: WOLCOTT, CT 06710
APT FILING NUMBER: WY1917200

SHEET TITLE:
SITE DETAILS

SHEET NUMBER
SP-2

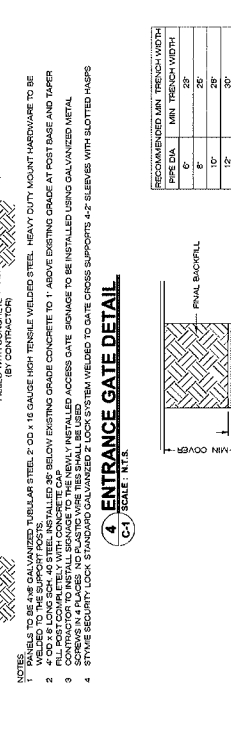
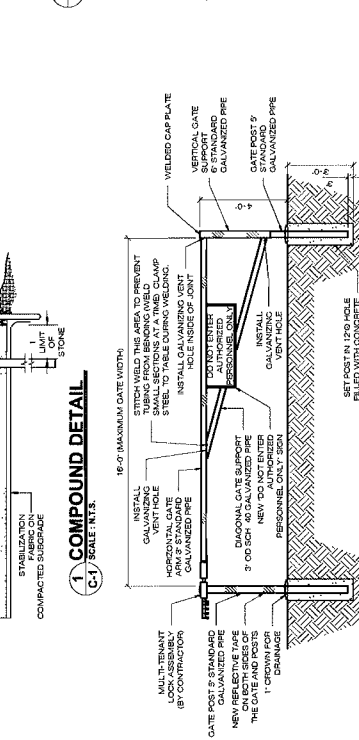
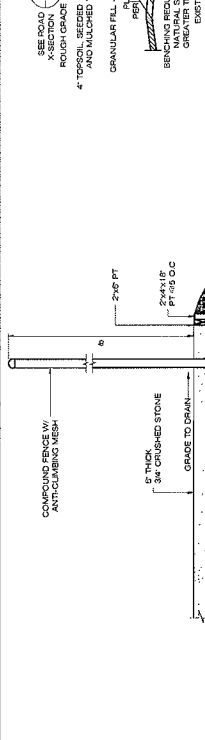
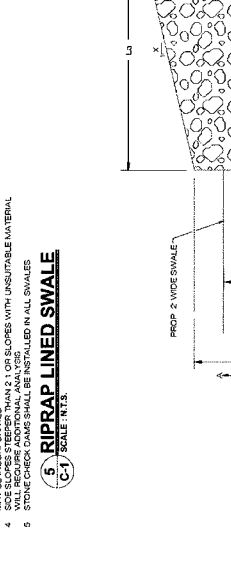
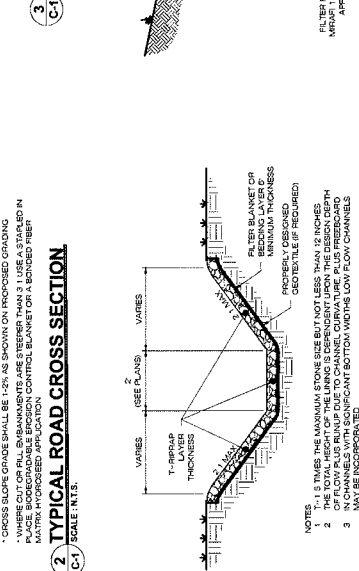
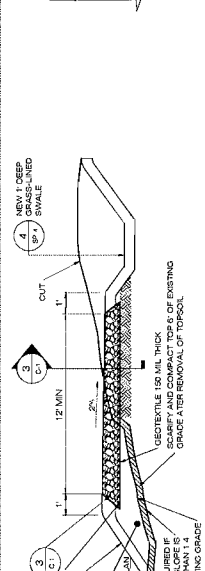
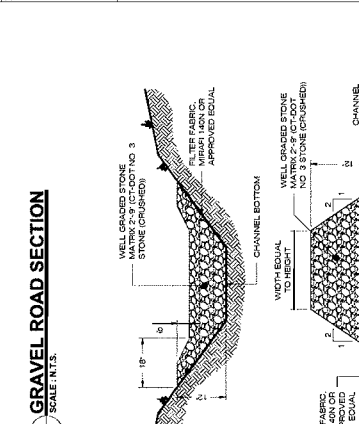
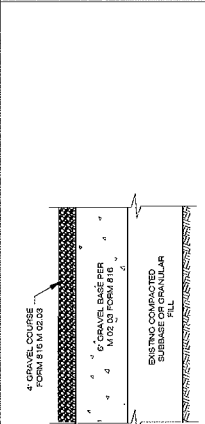

| PIPE DIA | MIN TRENCH WIDTH |
|----------|------------------|
| 6 | 24 |
| 8 | 28 |
| 10 | 32 |
| 12 | 36 |
| 14 | 40 |
| 16 | 44 |
| 18 | 48 |
| 20 | 52 |
| 24 | 60 |
| 30 | 72 |
| 36 | 84 |
| 42 | 96 |

NOTES:
1. USE RIPRAP SHALL BE INSTALLED IN ACCORDANCE WITH ASTM D 6658 - 15 STANDARD PRACTICE FOR UNDERGROUND INSTALLATION OF THERMOPLASTIC PIPE FOR SEWERS AND OTHER GRAVITY FLOW APPLICATIONS; LATEST ADDITION.
2. MATERIAL, WHEN REQUIRED, TO PREVENT CORROSION OF METAL PIPES INTO BACKFILL SHALL BE AS SPECIFIED BY THE ENGINEER AND REPLACE WITH SUITABLE MATERIAL AS SPECIFIED BY THE ENGINEER AS AN ALTERNATE AND AT THE DISCRETION OF THE MATERIAL.
3. THE RIPRAP SHALL BE CLASS 1 OR 2 (PER SECTION 405.02) UNLESS OTHERWISE NOTED.
4. DOCUMENTATION FOR MATERIAL SPECIFICATION TO ENGINEER, UNLESS OTHERWISE NOTED BY THE ENGINEER, MAXIMUM BEDDING THICKNESS SHALL BE 4" (100mm) FOR 4'-24" INITIAL BACKFILL, SUITABLE MATERIAL SHALL BE CLASS 1 OR 2 IN THE PIPE ZONE UNLESS OTHERWISE NOTED.
5. MATERIAL SHALL BE CLASS 1 OR 2 (PER SECTION 405.02) UNLESS OTHERWISE NOTED.
6. UNLESS OTHERWISE NOTED, THE RIPRAP SHALL BE CLASS 1 OR 2 (PER SECTION 405.02) UNLESS OTHERWISE NOTED.
7. UNLESS OTHERWISE NOTED, THE RIPRAP SHALL BE CLASS 1 OR 2 (PER SECTION 405.02) UNLESS OTHERWISE NOTED.
8. UNLESS OTHERWISE NOTED, THE RIPRAP SHALL BE CLASS 1 OR 2 (PER SECTION 405.02) UNLESS OTHERWISE NOTED.

| PERMITTING DOCUMENTS | | |
|----------------------|----------|-----------------|
| NO. | DATE | REVISION |
| 0 | 06/29/20 | FOR REVIEW B.P. |
| 1 | 08/20/20 | FOR CSET, B.P. |
| 2 | | |
| 3 | | |
| 4 | | |
| 5 | | |
| 6 | | |

DESIGN PROFESSIONALS OF RECORD
 PROF. SCOTT M. CHASE, P.E.
 561 MADRILL STREET
 WATERBURY, CT 06705

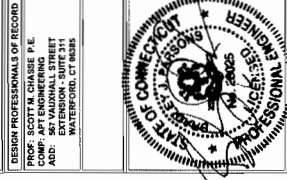

WOLCOTT SOUTH, CT
 SITE: CHEMIST HILL ROAD
 ADDRESS: WOLCOTT, CT 06718
 APT. FILING NUMBER: W114180200
 DRAWN BY: CHM
 DATE: 04/29/20
 CHECKED BY: B.P.

SHEET TITLE:
SITE DETAILS
 SHEET NUMBER:
SP-3

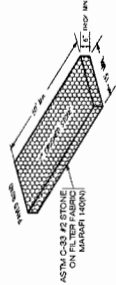

(CE) CONSTRUCTION ENTRANCE DETAIL
 2 SCALE: N.T.S.

- SEQUENCE OF CONSTRUCTION**
1. PREPARE SOIL BEFORE INSTALLING AND LOCATE EROSION CONTROL PRODUCTS (RECORDS), INCLUDING ANY NECESSARY ANCHORS.
 2. BEGIN AT THE TOP OF THE SLOPE BY ANCHORING THE RECORDS IN A 6" DEEP X 6" WIDE TRENCH WITH ANCHORS AT 12' APART IN THE TRENCH.
 3. STAKE RECORDS WITH A ROW OF STAKE STAKES APPROXIMATELY 12" APART IN THE BOTTOM OF THE TRENCH. BACKFILL AND SOFTEN THE TRENCH AFTER STAKING AND COVER WITH A ROW OF STAKE STAKES APPROXIMATELY 12" APART ACROSS THE WIDTH OF THE RECORDS.
 4. WITH A ROW OF STAKE STAKES SPACED APPROXIMATELY 12" APART ACROSS THE WIDTH OF THE RECORDS, STAKE RECORDS WITH A ROW OF STAKE STAKES APPROXIMATELY 12" APART ACROSS THE WIDTH OF THE RECORDS.
 5. STAKE RECORDS WITH A ROW OF STAKE STAKES APPROXIMATELY 12" APART ACROSS THE WIDTH OF THE RECORDS.
 6. STAKE RECORDS WITH A ROW OF STAKE STAKES APPROXIMATELY 12" APART ACROSS THE WIDTH OF THE RECORDS.
 7. STAKE RECORDS WITH A ROW OF STAKE STAKES APPROXIMATELY 12" APART ACROSS THE WIDTH OF THE RECORDS.
 8. STAKE RECORDS WITH A ROW OF STAKE STAKES APPROXIMATELY 12" APART ACROSS THE WIDTH OF THE RECORDS.
 9. STAKE RECORDS WITH A ROW OF STAKE STAKES APPROXIMATELY 12" APART ACROSS THE WIDTH OF THE RECORDS.
 10. STAKE RECORDS WITH A ROW OF STAKE STAKES APPROXIMATELY 12" APART ACROSS THE WIDTH OF THE RECORDS.

- NOTES**
1. BLANKET SHOULD NOT BE STRETCHED TIGHTER THAN RECOMMENDED STAPLING OVERLAP BLANKET OVERLAP THE DOWN-SLOPE BLANKET (PARALLEL TO THE SLOPE).
 2. THE BLANKET SHOULD NOT BE STRETCHED TIGHTER THAN RECOMMENDED STAPLING OVERLAP BLANKET OVERLAP THE DOWN-SLOPE BLANKET (PARALLEL TO THE SLOPE).
 3. THE BLANKET SHOULD NOT BE STRETCHED TIGHTER THAN RECOMMENDED STAPLING OVERLAP BLANKET OVERLAP THE DOWN-SLOPE BLANKET (PARALLEL TO THE SLOPE).
 4. THE BLANKET SHOULD NOT BE STRETCHED TIGHTER THAN RECOMMENDED STAPLING OVERLAP BLANKET OVERLAP THE DOWN-SLOPE BLANKET (PARALLEL TO THE SLOPE).
 5. THE BLANKET SHOULD NOT BE STRETCHED TIGHTER THAN RECOMMENDED STAPLING OVERLAP BLANKET OVERLAP THE DOWN-SLOPE BLANKET (PARALLEL TO THE SLOPE).
 6. THE BLANKET SHOULD NOT BE STRETCHED TIGHTER THAN RECOMMENDED STAPLING OVERLAP BLANKET OVERLAP THE DOWN-SLOPE BLANKET (PARALLEL TO THE SLOPE).
 7. THE BLANKET SHOULD NOT BE STRETCHED TIGHTER THAN RECOMMENDED STAPLING OVERLAP BLANKET OVERLAP THE DOWN-SLOPE BLANKET (PARALLEL TO THE SLOPE).
 8. THE BLANKET SHOULD NOT BE STRETCHED TIGHTER THAN RECOMMENDED STAPLING OVERLAP BLANKET OVERLAP THE DOWN-SLOPE BLANKET (PARALLEL TO THE SLOPE).
 9. THE BLANKET SHOULD NOT BE STRETCHED TIGHTER THAN RECOMMENDED STAPLING OVERLAP BLANKET OVERLAP THE DOWN-SLOPE BLANKET (PARALLEL TO THE SLOPE).
 10. THE BLANKET SHOULD NOT BE STRETCHED TIGHTER THAN RECOMMENDED STAPLING OVERLAP BLANKET OVERLAP THE DOWN-SLOPE BLANKET (PARALLEL TO THE SLOPE).

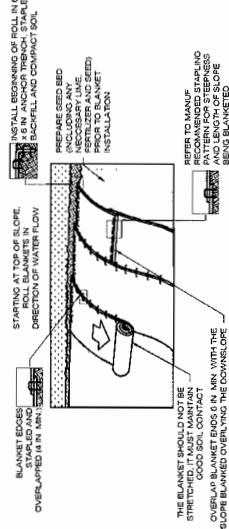

(4) EROSION CONTROL BLANKET STEEP SLOPES
 4 SCALE: N.T.S.

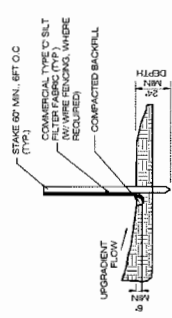

(1) GEOTEXTILE SILT FENCE DETAIL
 1 SCALE: N.T.S.

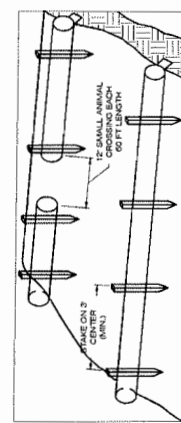

(3) COMPOST FILTER SOCK SEDIMENTATION CONTROL BARRIER
 3 SCALE: N.T.S.

- 1. SEDIMENTATION CONTROL BARRIER**
1. SEDIMENTATION CONTROL BARRIER
 2. SEDIMENTATION CONTROL BARRIER
 3. SEDIMENTATION CONTROL BARRIER
 4. SEDIMENTATION CONTROL BARRIER
 5. SEDIMENTATION CONTROL BARRIER
 6. SEDIMENTATION CONTROL BARRIER
 7. SEDIMENTATION CONTROL BARRIER
 8. SEDIMENTATION CONTROL BARRIER
 9. SEDIMENTATION CONTROL BARRIER
 10. SEDIMENTATION CONTROL BARRIER