



# STATE OF CONNECTICUT

## CONNECTICUT SITING COUNCIL

Ten Franklin Square, New Britain, CT 06051  
Phone: (860) 827-2935 Fax: (860) 827-2950  
E-Mail: [siting.council@ct.gov](mailto:siting.council@ct.gov)  
Web Site: [portal.ct.gov/csc](http://portal.ct.gov/csc)

### VIA ELECTRONIC MAIL

December 11, 2024

Bruce McDermott, Esq.  
Murtha Cullina LLP  
One Century Tower  
265 Church Street, 9<sup>th</sup> floor  
New Haven, CT 06510-1220  
[bmcdermott@murthalaw.com](mailto:bmcdermott@murthalaw.com)

RE: **DOCKET NO. 508** – The United Illuminating Company (UI) Certificate of Environmental Compatibility and Public Need for the Milvon to West River Railroad Transmission Line 115-kV Rebuild Project that consists of the relocation and rebuild of its existing 115- kilovolt (kV) electric transmission lines from the railroad catenary structures to new steel monopole structures and related modifications to facilitate interconnection of the rebuilt 115-kV electric transmission lines at UI's existing Milvon, Woodmont, Allings Crossing, Elmwest and West River substations along approximately 9.5 miles of the Connecticut Department of Transportation's Metro-North Railroad corridor traversing the municipalities of Milford, Orange, West Haven and New Haven, Connecticut. **Partial Development and Management (D&M) Plans – Segments 2, 3 and 4 Revisions.**

Dear Attorney McDermott:

The Connecticut Siting Council (Council) is in receipt of the correspondence dated December 9, 2024, regarding revisions to Partial Development and Management (D&M) Plans –Segments 2, 3 and 4 for the above-referenced facility that were approved by the Council on August 18, 2023, August 2, 2024 and May 13, 2024, respectively.

Pursuant to Regulations of Connecticut State Agencies (RCSA) §16-50j-62(b), the request to perform the following is hereby approved:

- a) Update access road notes on RD02;
- b) Update erosion and sedimentation control notes on ESC01, GD43, and GD45
- c) Include DN54 temporary mat bridge stream crossing design and notes; and
- d) Include additional mat bridge drainage crossings of O-WC1, O-WC2 and WH-WC4 per Drainage Crossing Schedule, DC13 and DC15.

This approval applies only to the Partial D&M Plans – Segments 2, 3 and 4 revisions in the correspondence dated December 9, 2024.

Please be advised that deviations from the Council's Decision and Order and D&M Plan approvals are enforceable under the provisions of Connecticut General Statutes § 16-50u. Furthermore, the Certificate Holder is responsible for reporting requirements pursuant to RCSA §16-50j-62.



December 9, 2024

Melanie A. Bachman, Esq.  
Executive Director/Staff Attorney  
Connecticut Siting Council  
10 Franklin Square  
New Britain, CT 06051

Re: Docket No. 508 - The United Illuminating Company Application for a Certificate of Environmental Compatibility and Public Need for the Milvon to West River Railroad Transmission Line 115-kV Rebuild Project – Request for Modification to Segments 2-4 Development and Management Plans

Dear Ms. Bachman:

Pursuant to the Regulations of Connecticut State Agencies Section 16-50j-62(b)(2) and Attachment M to the Segments 2-4 Development & Management (D&M) Plans, The United Illuminating Company (“UI”) is hereby requesting various modifications from the Connecticut Siting Council (the “Council”). The modifications are associated with details related to watercourse crossings, erosion and sedimentation controls, and exclusionary fencing.

UI has updated several drawings. These updates include modifications to existing details RD02, ESC01, GD45, GD43, ESC01.1, DN-54, the Drainage Crossing Schedule, and two new details identified as DC13 and DC15 (attached). The updated watercourse crossing design will reduce overall permitted impacts and is considered a value engineering change. Erosion and sedimentation controls, including seeding and mulching, will be implemented during and following construction as needed and in compliance with the Project’s Stormwater Pollution Control Plan (“SWPCP”) and D&M Plans. UI has provided updates to the USACE regarding the updated details to be utilized during construction.

The changes to be implemented will be within UI’s work pad and/or the CTDOT ROW, as denoted in the Development and Management Plans. Changes do not (i) include the placement of temporary structures or equipment; (ii) impact a wetland or a watercourse crossing; or (iii) use additional or eliminate mitigation measures.

Should the Council have any questions regarding this filing, please do not hesitate to contact me.

Respectfully submitted,

A handwritten signature in blue ink that reads 'Paul Kenline'.

Paul Kenline  
Project Manager, [pkenline@uinet.com](mailto:pkenline@uinet.com)

DATE	BY	SURVEYED	REVIEWED
NO. BOOK	NO. CHKD	ROW	CHKD
NO.			

**Westwood Surveying & Engineering**  
 1684 South Board Street, Suite #300  
 Landale, PA 19446  
 Phone: (952) 937-5150  
 Fax: (952) 937-8822  
 Toll Free: (888) 937-5150  
 www.pcc.com  
 Westwood Surveying and Engineering, P.C.

DATE	BY	SURVEYED	REVIEWED
NO. BOOK	NO. CHKD	ROW	CHKD
NO.			

ANSI D. CAD Drawing, DO NOT REVISE MANUALLY

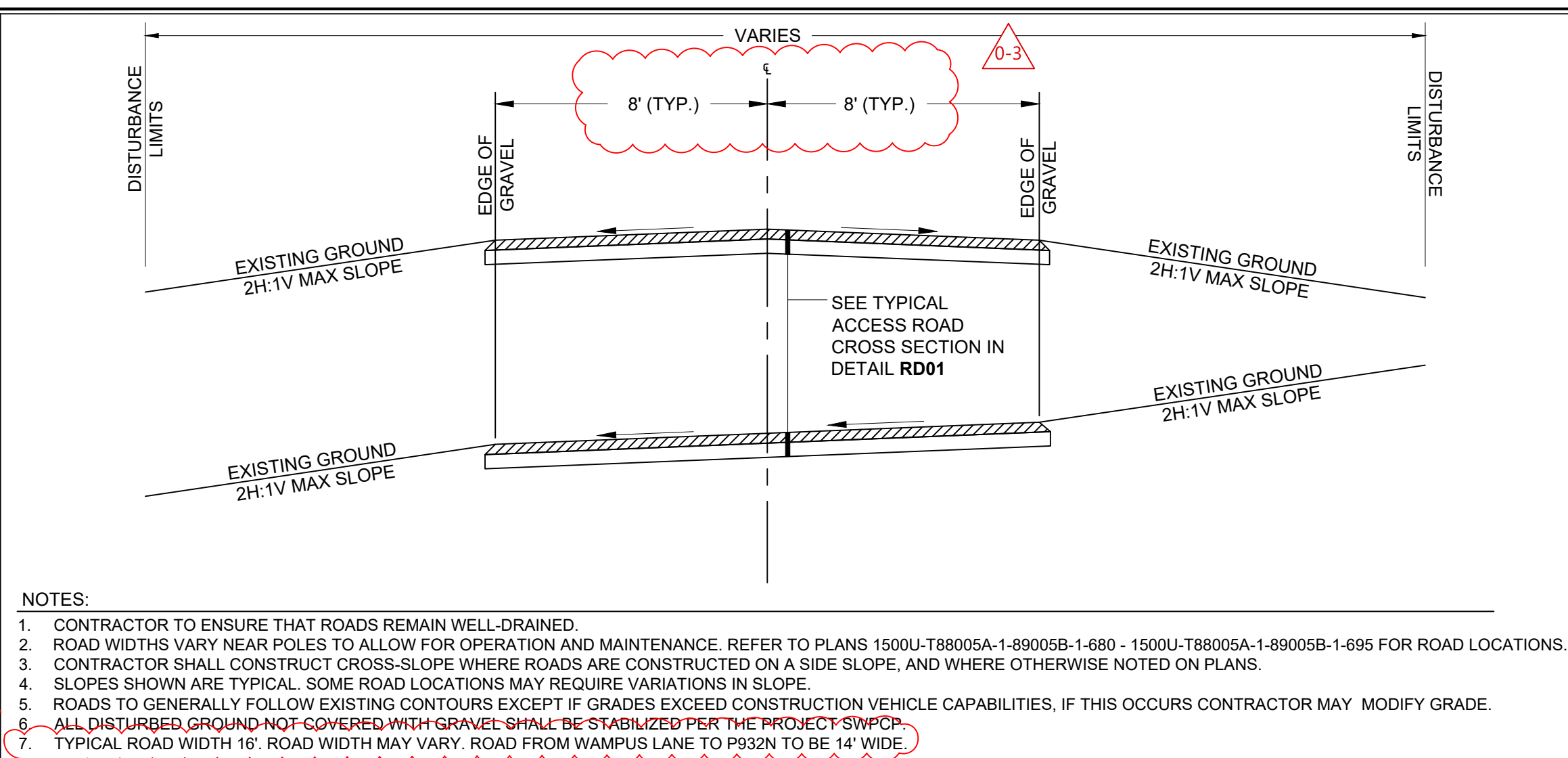

Westwood TYPICAL PERMANENT ACCESS ROAD TO REMAIN SECTION RD02 NOT TO SCALE

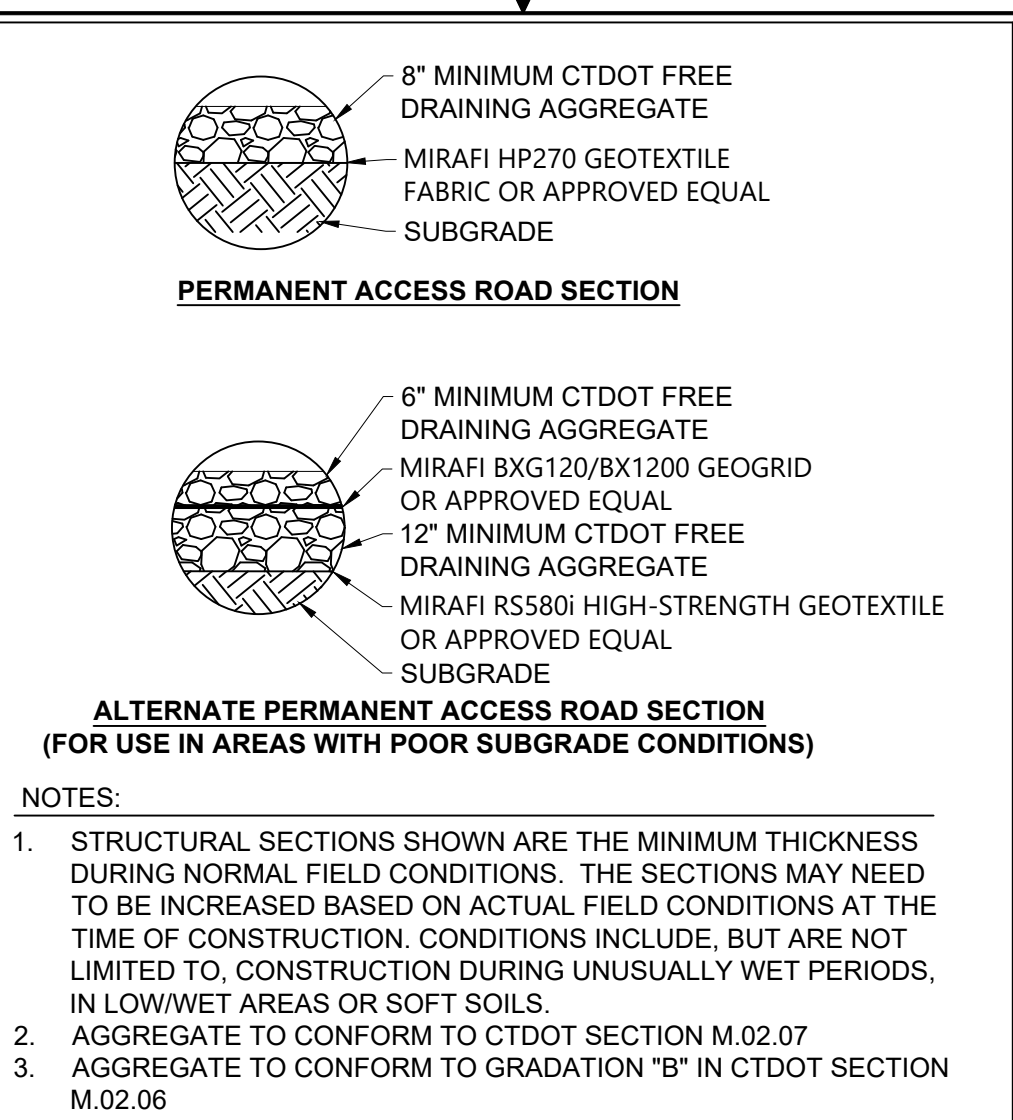

Westwood TYPICAL STRUCTURAL CROSS SECTIONS RD01

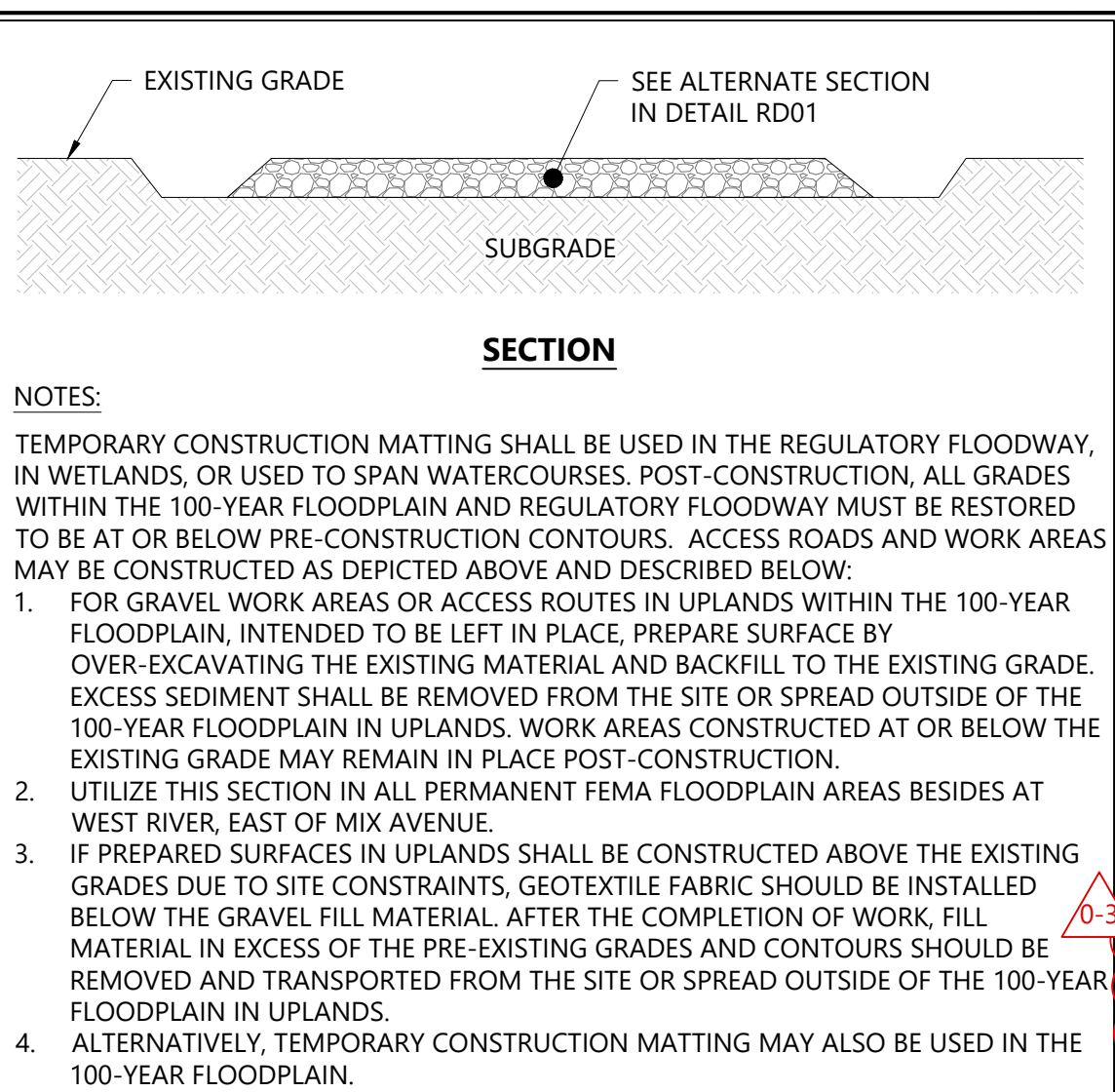

Westwood PERMANENT ACCESS OR WORK PAD CONSTRUCTION IN FLOODPLAINS RD-13 NOT TO SCALE

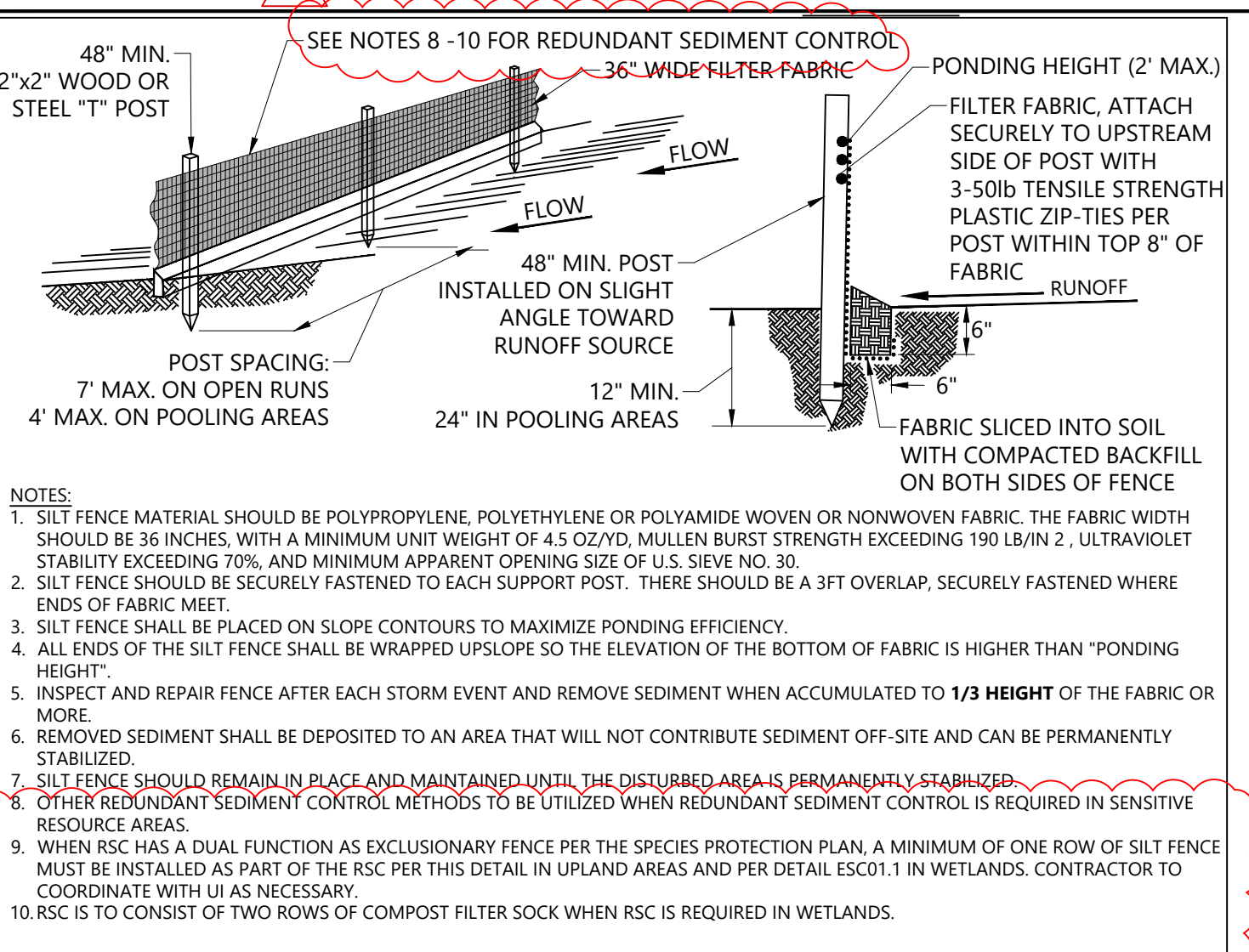

Westwood SILT FENCE AND REDUNDANT SEDIMENT CONTROL BARRIER ESC01 NOT TO SCALE

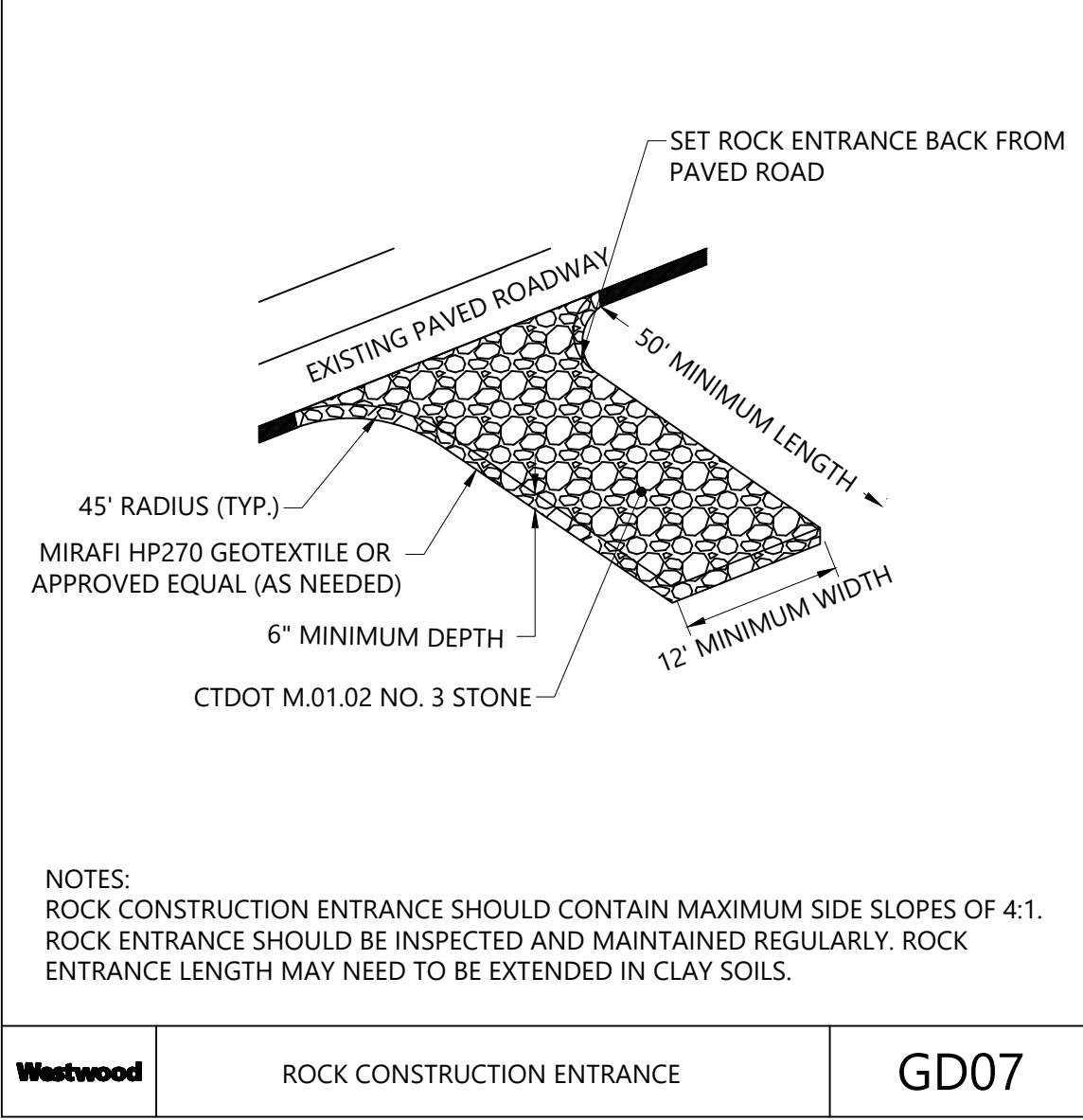

Westwood ROCK CONSTRUCTION ENTRANCE GD07

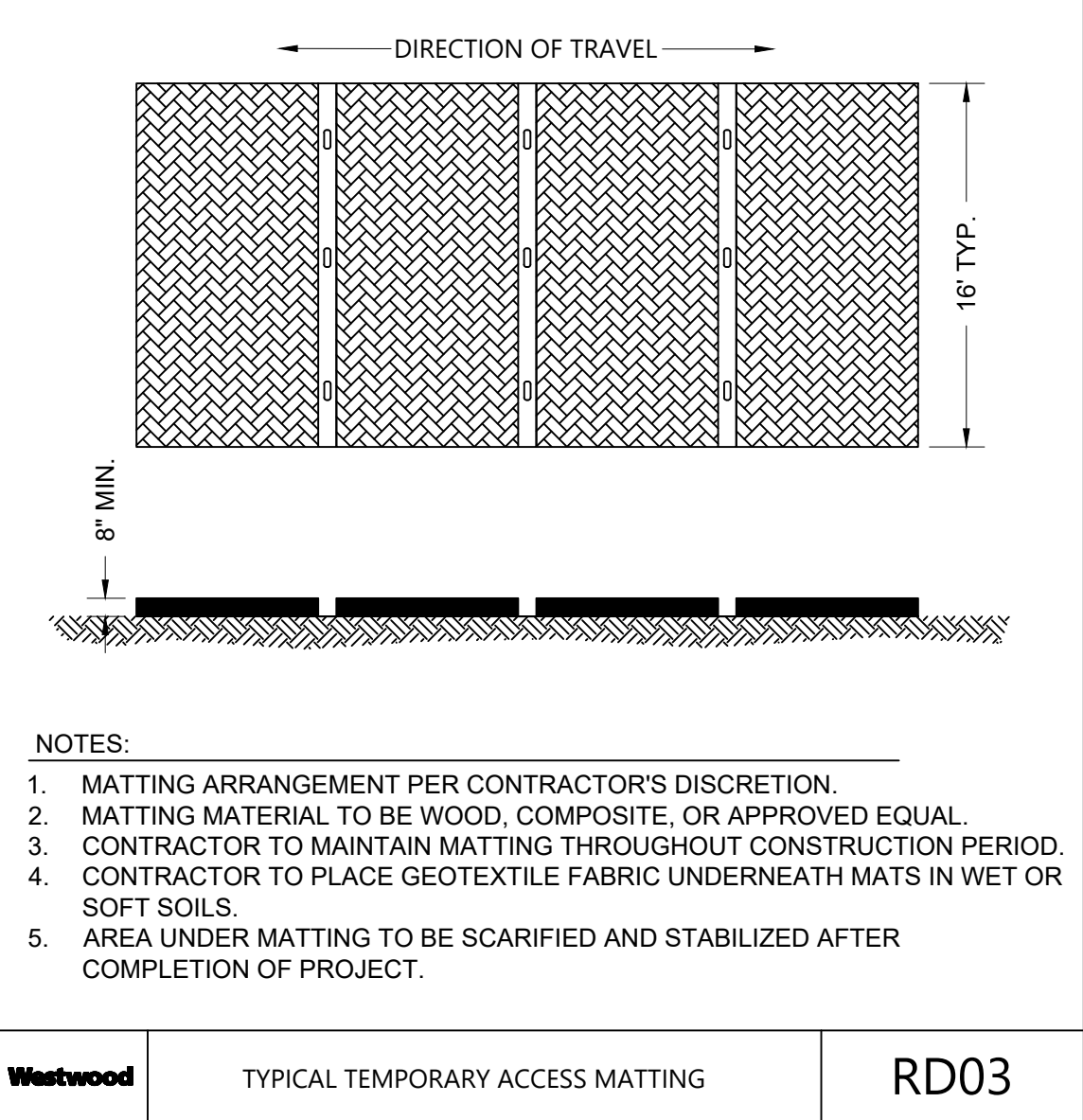

Westwood TYPICAL TEMPORARY ACCESS MATting RD03

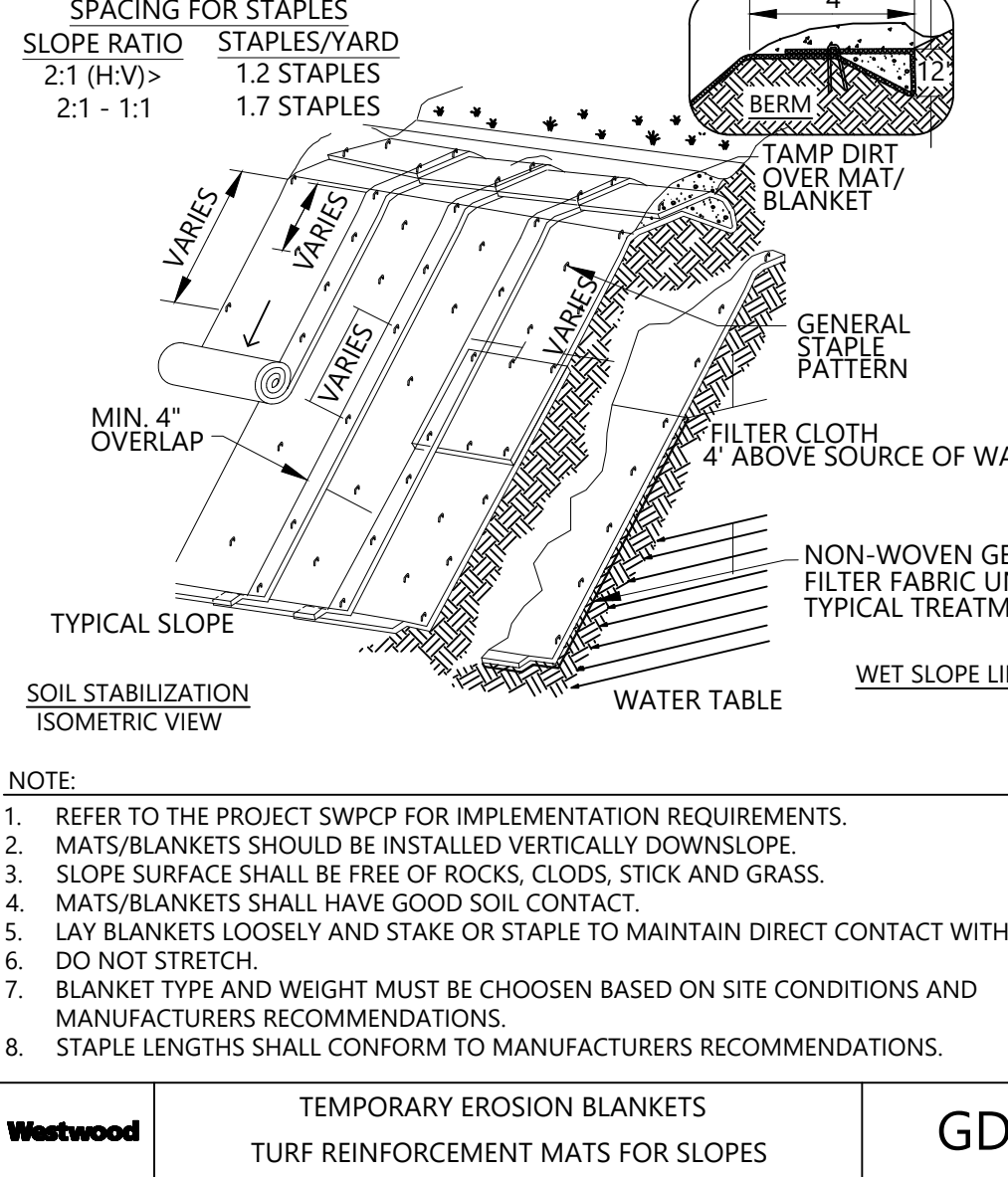

Westwood TEMPORARY EROSION BLANKETS TURF REINFORCEMENT MATS FOR SLOPES GD21

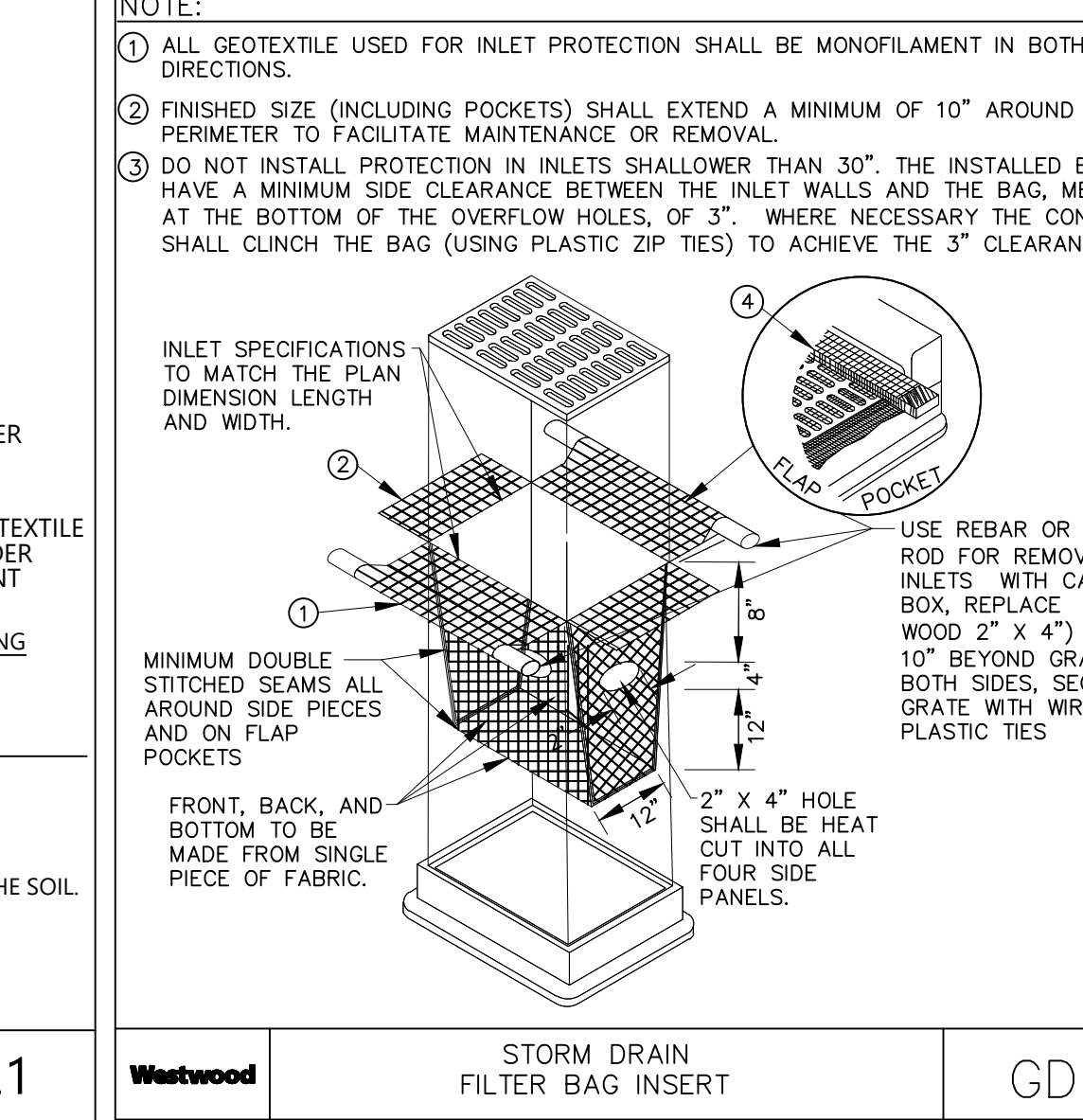

Westwood STORM DRAIN FILTER BAG INSERT GD10

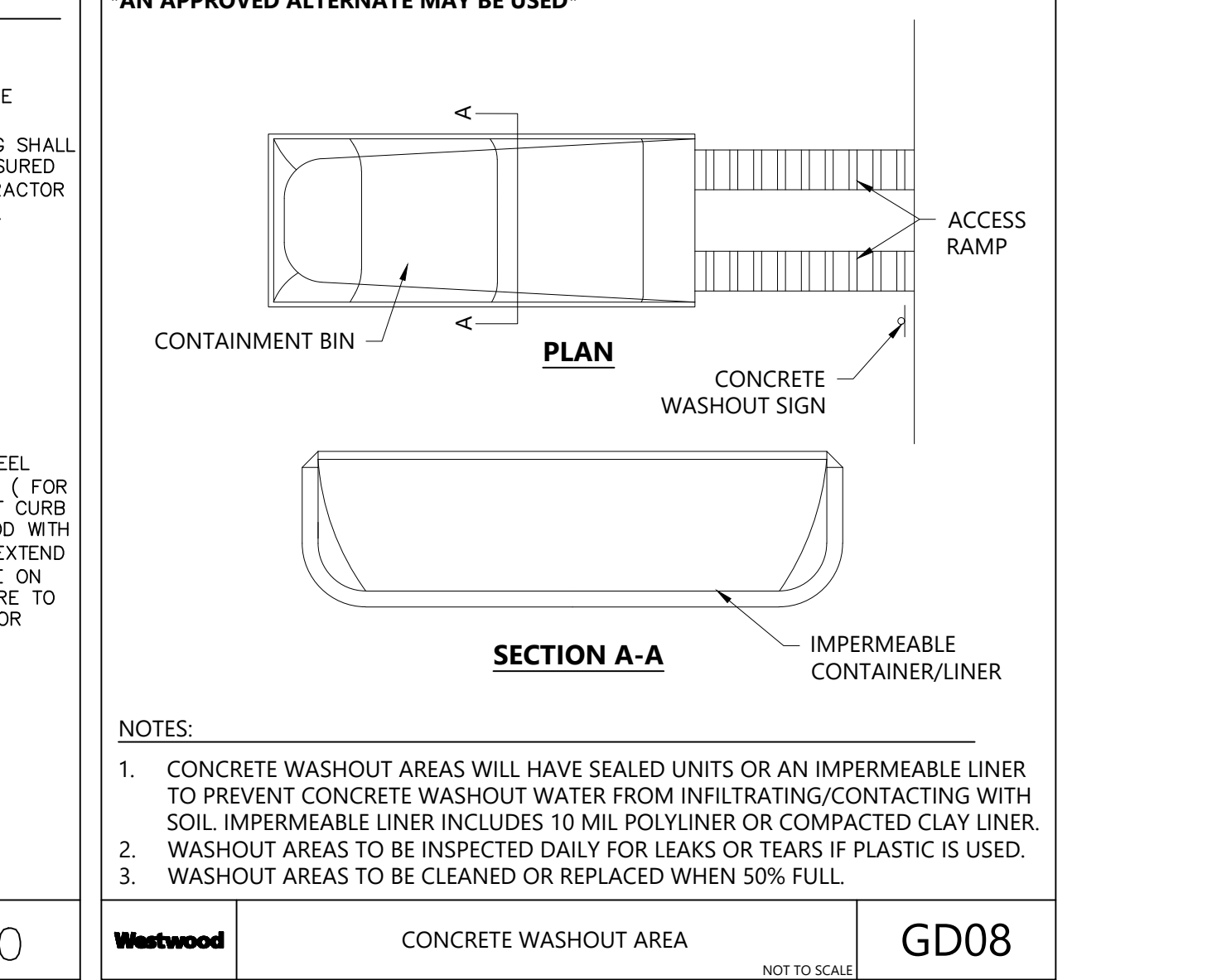

Westwood CONCRETE WASHOUT AREA GD08 NOT TO SCALE

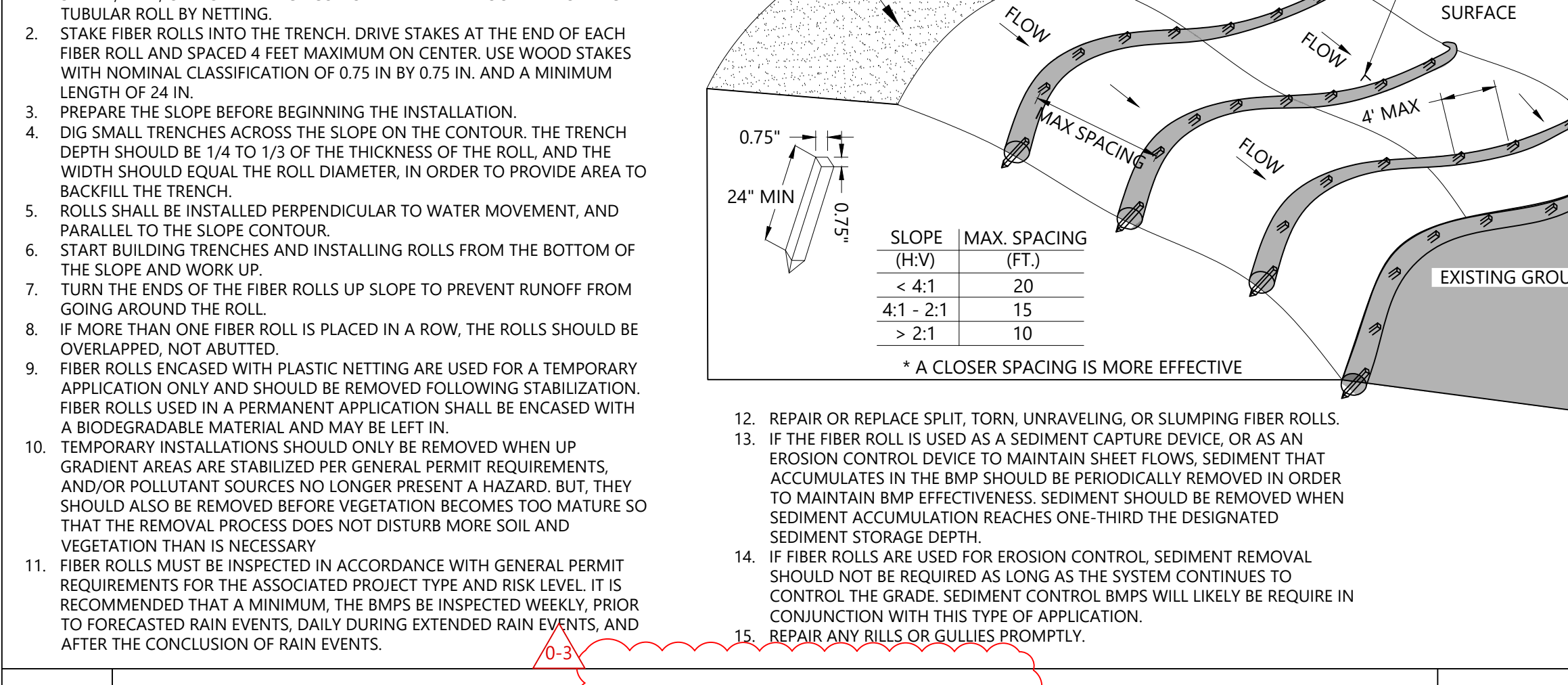

Westwood TYPICAL FIBER ROLLS/COMPOST FILTER SOCK GD45

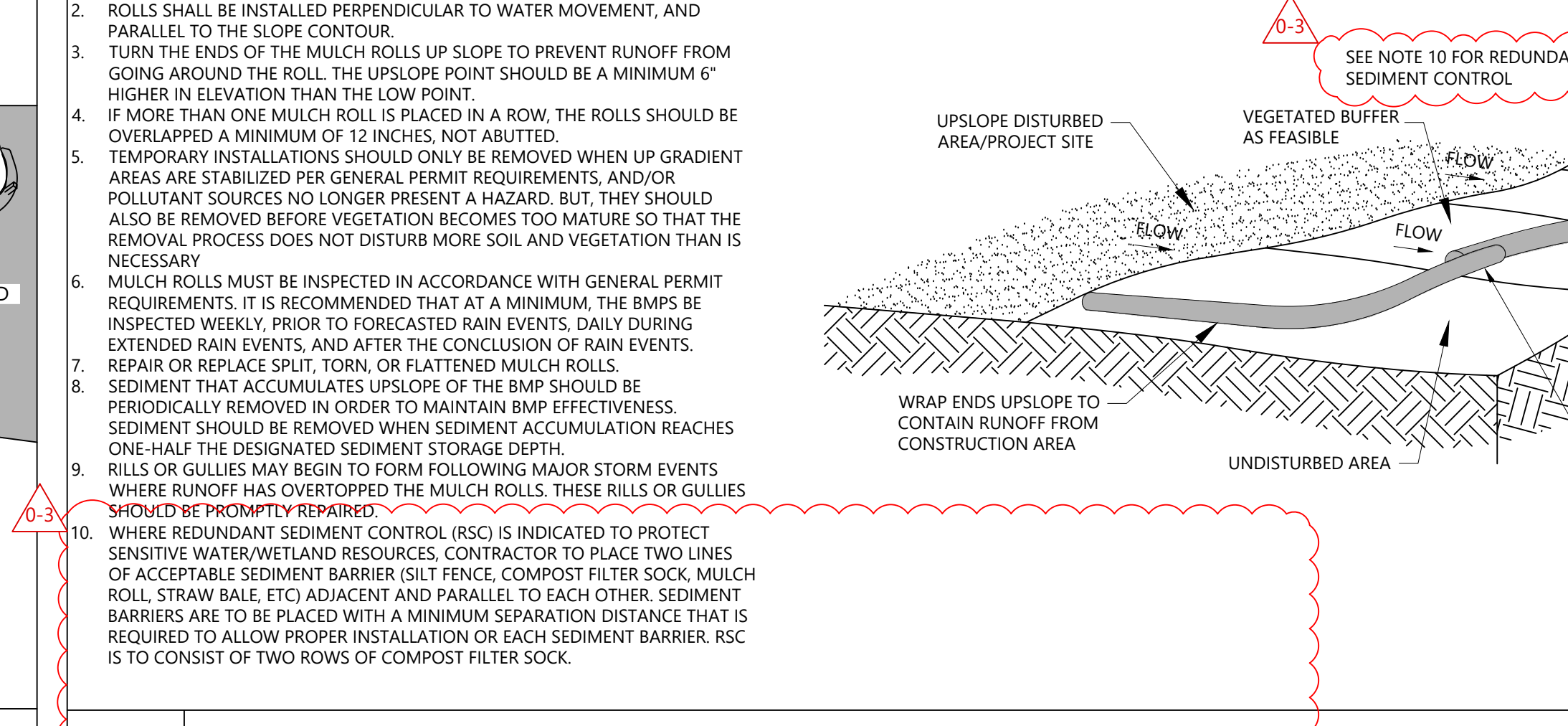

Westwood TYPICAL MULCH ROLLS/COMPOST FILTER SOCK FOR PERIMETER CONTROL OF CONSTRUCTION AREA LIMIT AND REDUNDANT SEDIMENT CONTROL BARRIER GD43

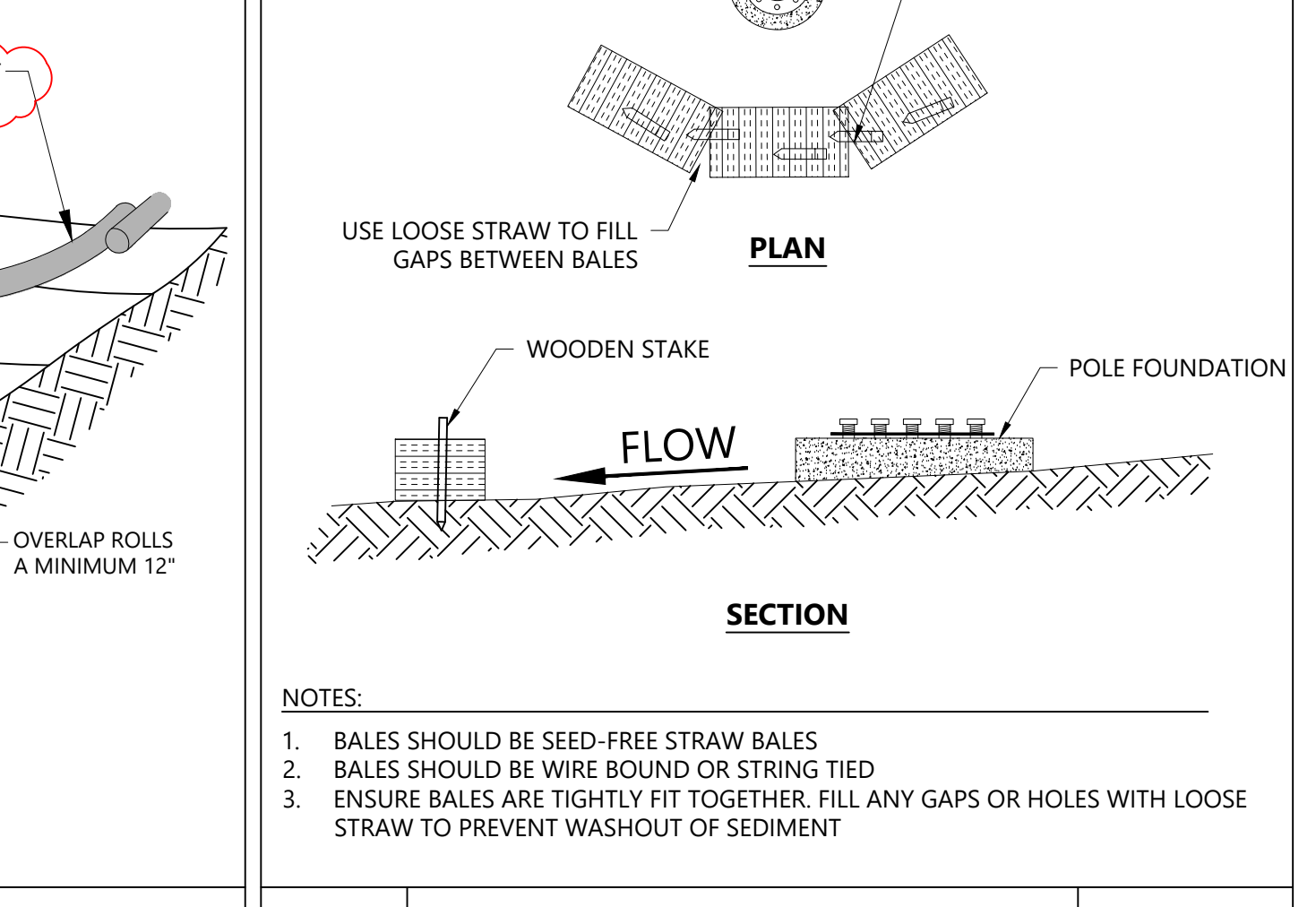

Westwood STRAW BALE SEDIMENT CONTROL GD61 NOT TO SCALE



REV.	DATE	BY	DESCRIPTION
0-3	09/04/2024	WESTWOOD	RE-ISSUE FOR CONSTRUCTION
0-2	12/06/2023	WESTWOOD	RE-ISSUE FOR CONSTRUCTION
0-1	4/28/2023	WESTWOOD	RE-ISSUE FOR CONSTRUCTION
0-0	3/10/2023	WESTWOOD	ISSUE FOR CONSTRUCTION

		<b>UI 115-kV RR PROJECT MILVON TO WEST RIVER DETAILS</b> 3 OF 73	
DR.	SFB	SCALE	AS SHOWN
CK.	JRD	FILE:	1500U-T88005A-1-89005B-1-602.dwg
APP.	MSP	NO.	1500U-T88005A-1-89005B-1-602
APP.	DATE:	REV.	0-3

PLAN	SURVEYED	BY	DATE
NOTEBOOK NO.	REVIEWED		
	ROW CHKD		

**Westwood Surveying & Engineering**  
 Phone (953) 937-5150 1684 South Road Street, Suite #300  
 Fax (953) 937-8822 Landale, PA 19446  
 Toll Free (888) 937-5150 www.wpe.com  
 Westwood Surveying and Engineering, P.C.

PROFILE	SURVEYED	BY	DATE
NOTEBOOK NO.	REVIEWED		
	NOTES REDUCED		

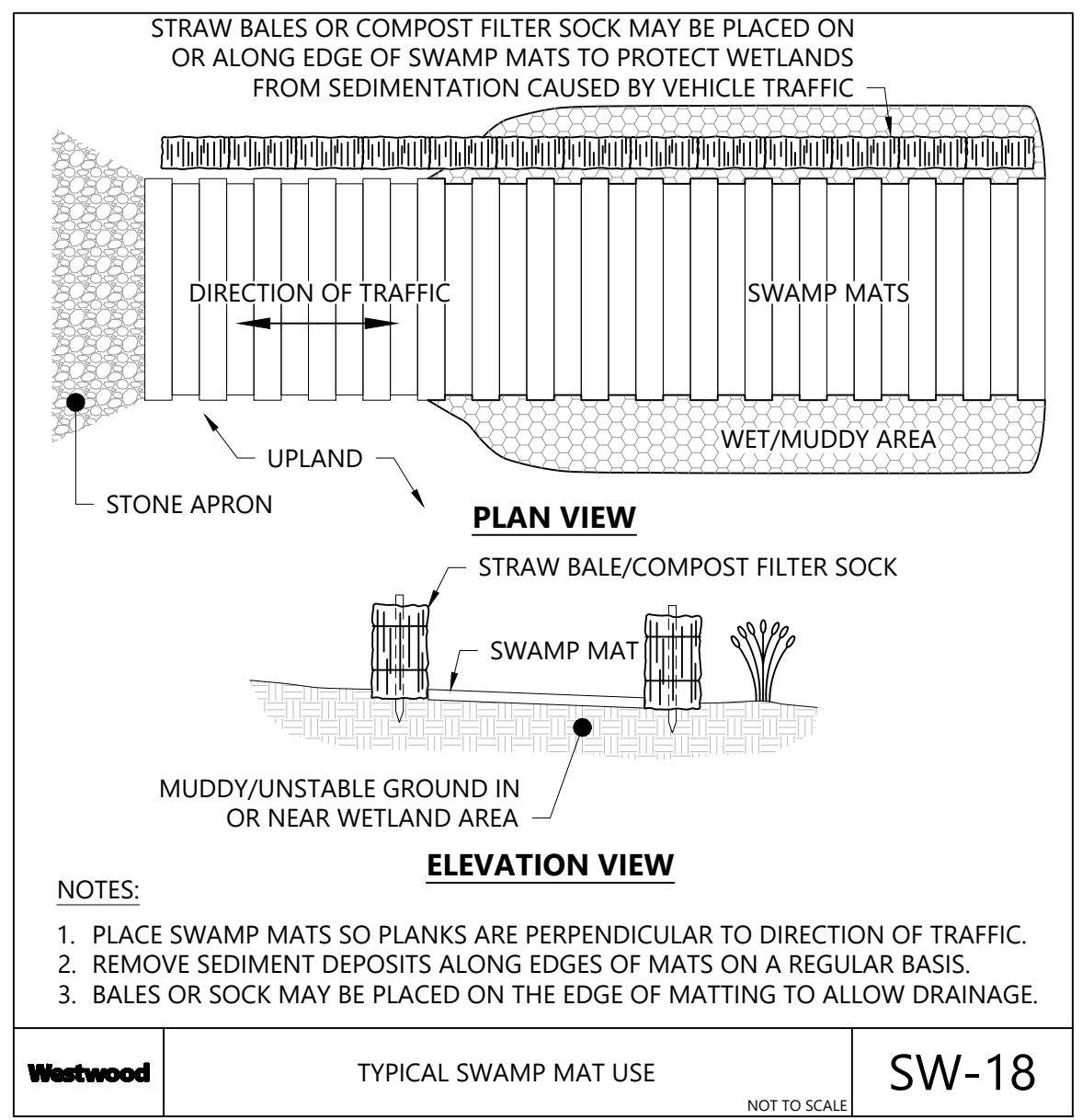
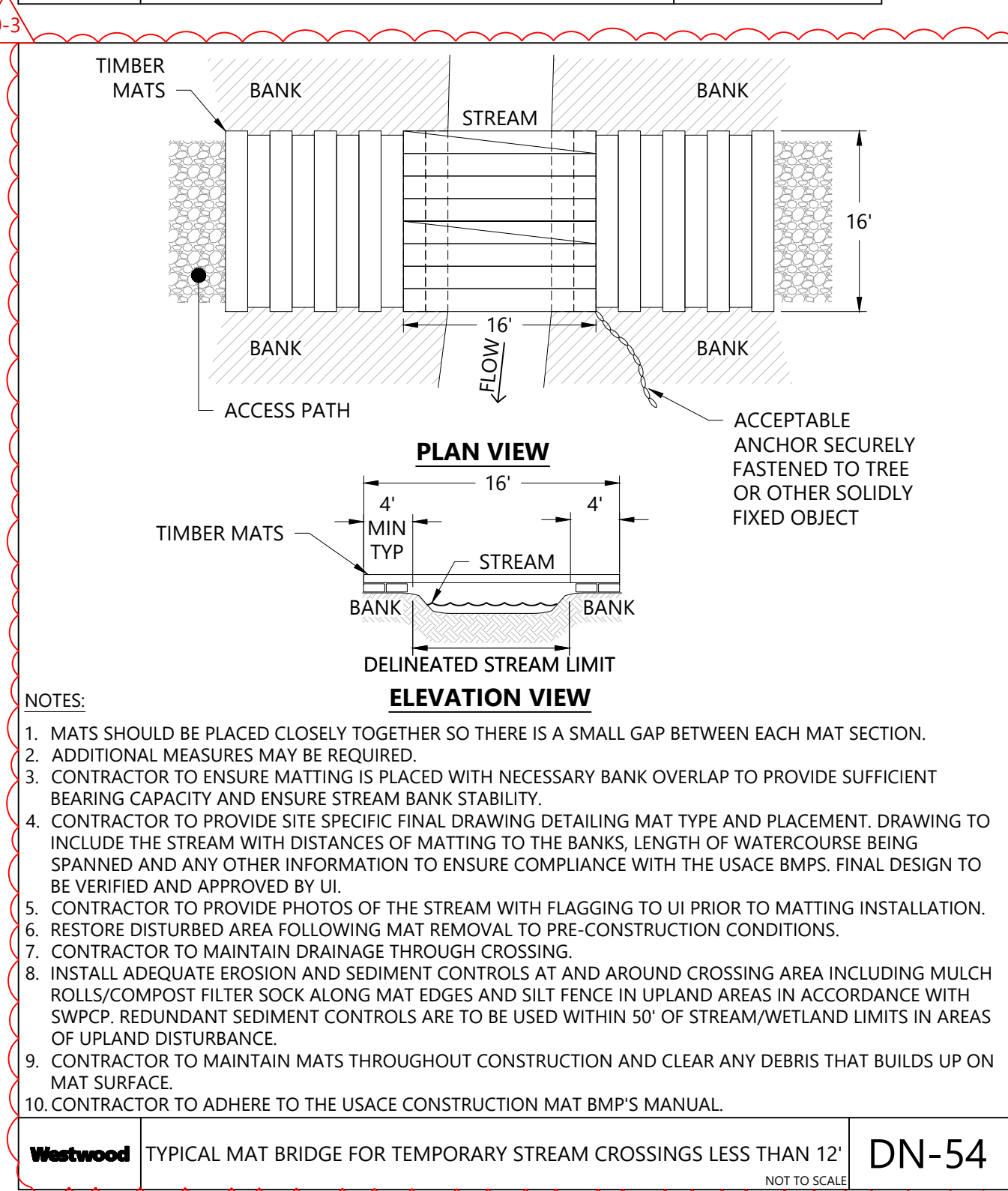
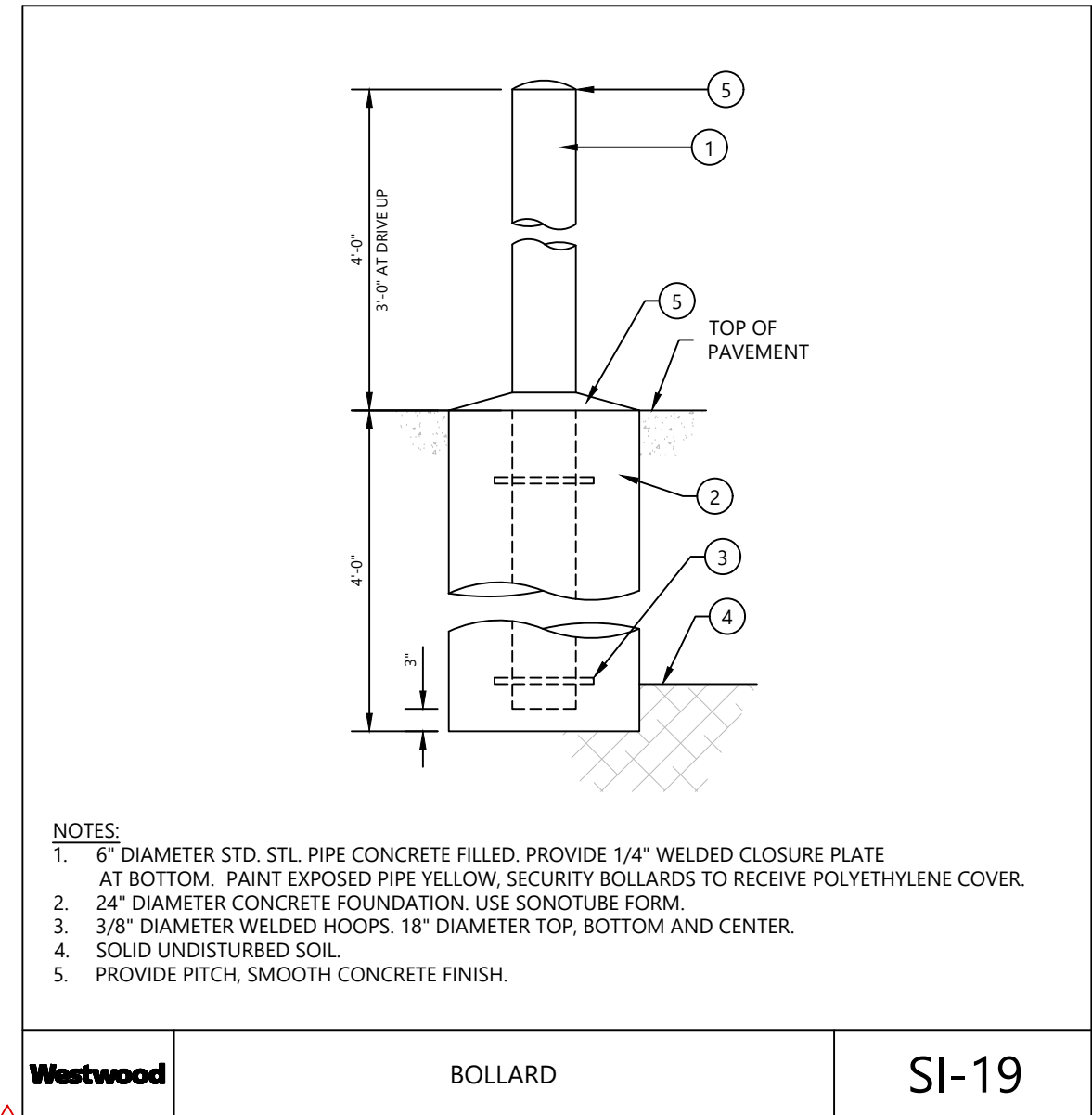
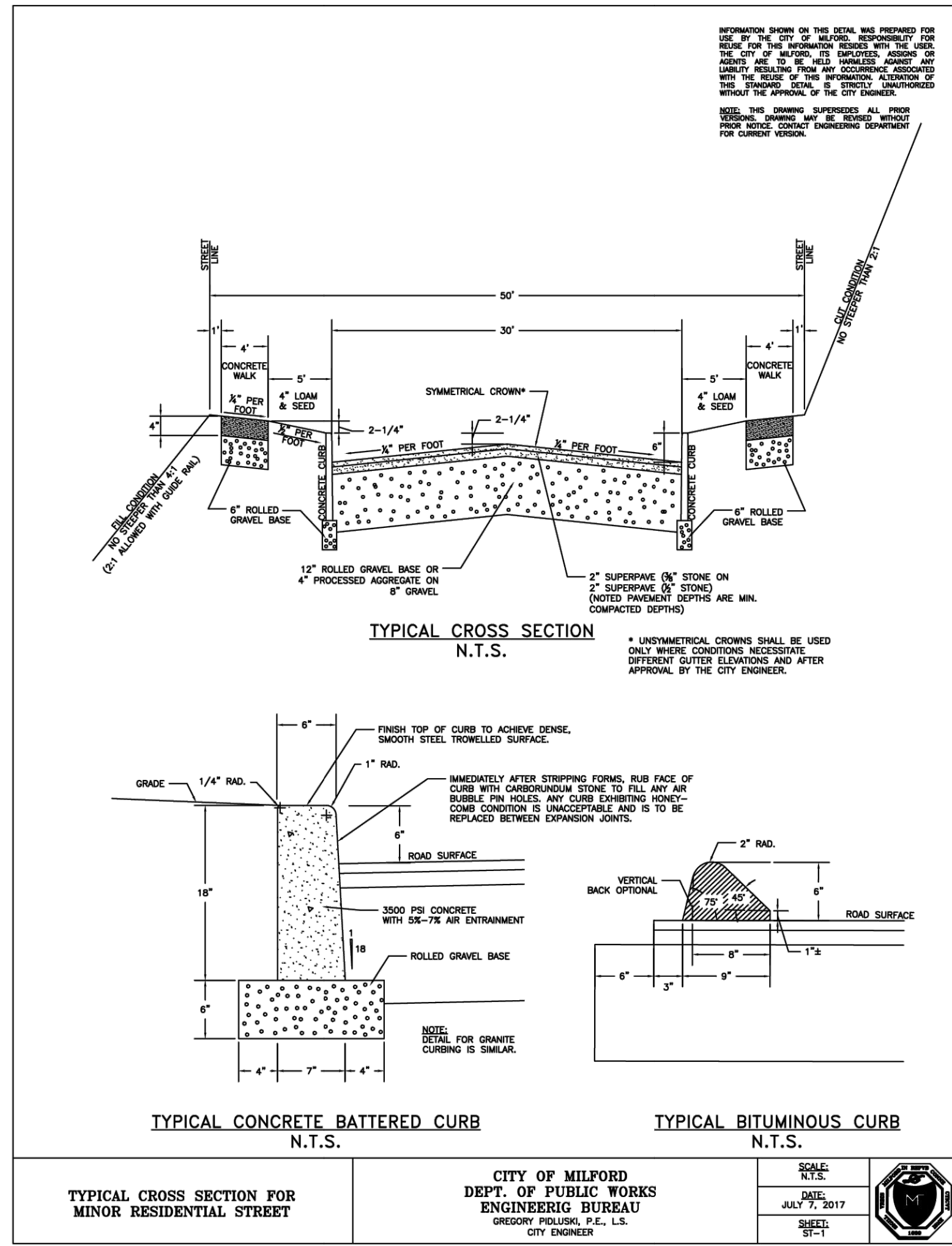

Drainage Crossing Schedule					
Drainage ID	Watercourse ID	Status	Crossing type/Culvert size	Closest Structure	Plan Detail
01	M-WC2	Temporary	Mat bridge	P892EN	DN-54
02	M-WC4	Temporary	Mat bridge	B947S	DN-54
03	M-WC4	Temporary	Mat bridge	B947S	DN-54
04	M-WC4	Temporary	Mat bridge	B948S	DN-54
05	M-WC4	Temporary	Mat bridge	B951S	DN-54
06	M-WC4	Temporary	Mat bridge	B951S	DN-54
07	M-WC5	Temporary	Mat bridge	P952N	DN-54
08	M-WC5	Temporary	Mat bridge	P952N	DN-54
09	M-WC6	Temporary	Mat bridge	P961N	DN-54
10	M-WC8	Temporary	Mat bridge > 12'	P968N	DN-56
11	M-WC8	Temporary	Mat bridge > 12'	P969N	DN-56
12	M-WC9	Temporary	Mat bridge	P973NN	DN-54
13	O-WC2	Temporary	Mat bridge	P982N	DN-54
14	O-WC2	Temporary	Mat bridge	P982N	DN-54
15	O-WC2	Temporary	Mat bridge	P983N	DN-54
16	WH-WC3	Temporary	Mat bridge	P987NN	DN-54
17	WH-WC6	Temporary	Mat bridge	P997N	DN-54
18	WH-WC9	Temporary	Mat bridge	P1007N	DN-54
19	WH-WC10	Temporary	Mat bridge	B1006S	DN-54
20	WH-WC14	Temporary	Mat bridge	TP1008	DN-54
21	WH-W13	Temporary	Mat bridge	B1044N	DN-54
22	WH-W13	Temporary	Mat bridge	P1045N	DN-54
23	WH-W13	Temporary	Mat bridge	B1046N	DN-54
24	WH-W13	Temporary	Mat bridge	P1047N	DN-54
25	O-WC1	Temporary	Mat bridge	P978N	DN-54
26	WH-WC4	Temporary	Mat bridge	P989N	DN-54

PE Stamp: [Professional Engineer Seal]

**AVANGRID ENGINEERING**  
CONFIDENTIAL, PROPRIETARY and TRADE SECRET INFORMATION  
Property of AVANGRID

**UI AVANGRID**

**UI 115-kV RR PROJECT MILVON TO WEST RIVER DETAILS**  
4 OF 73

REV.	DATE	BY	DESCRIPTION	APP.
0-3	10/21/2024	WESTWOOD	RE-ISSUE FOR CONSTRUCTION	SFB
0-2	9/19/2024	WESTWOOD	RE-ISSUE FOR CONSTRUCTION	SFB
0-1	4/28/2023	WESTWOOD	RE-ISSUE FOR CONSTRUCTION	SFB
0-0	3/10/2023	WESTWOOD	ISSUE FOR CONSTRUCTION	SFB

DR: SFB  
CK: JRD  
APP: MSP

SCALE: NO.  
FILE: 1500U-T88005A-1-89005B-1-603.dwg

1500U-T88005A-1-89005B-1-603

REV. 0-3

ANSI D CADD Drawing. DO NOT REVISE MANUALLY.

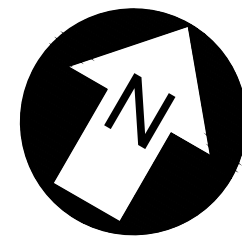

FILL BLOCKS WITH CTDOT NO. 3  
STONE OR APPROVED EQUAL

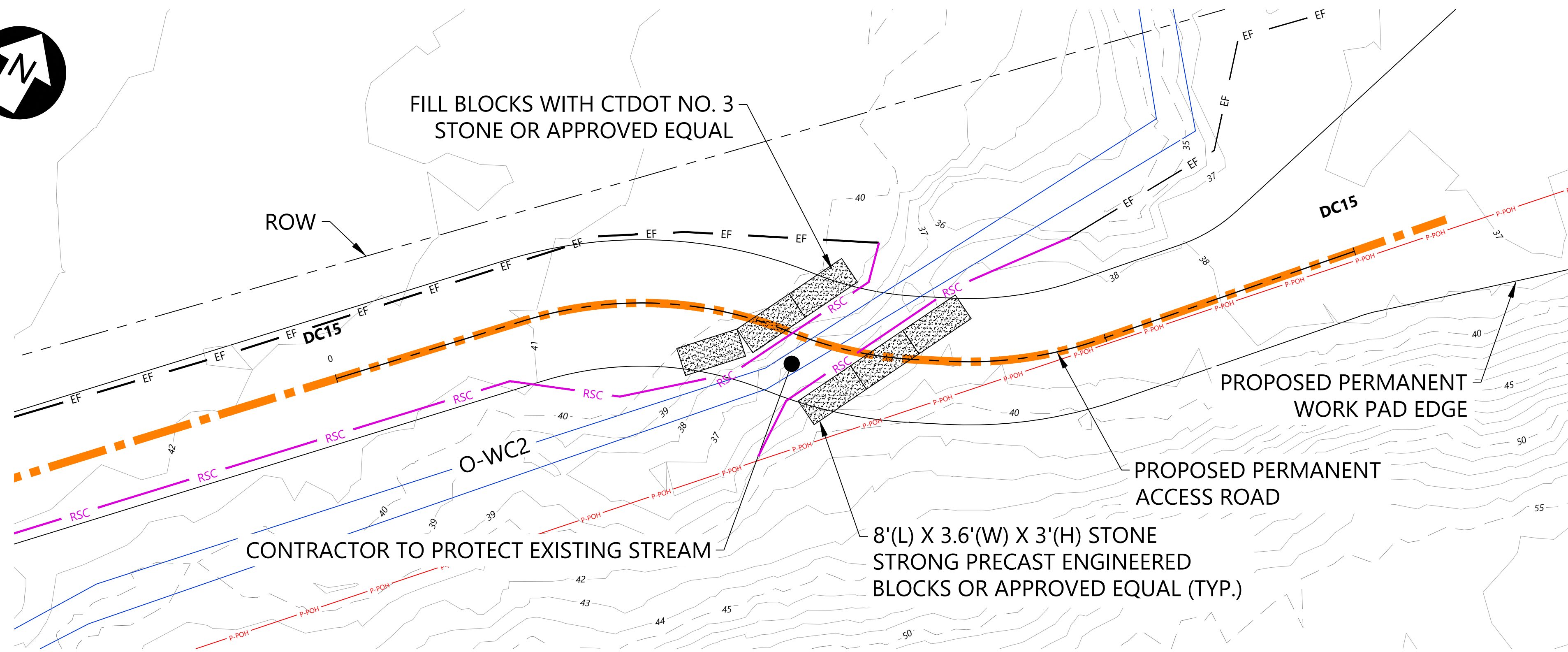

8'(L) X 3.6'(W) X 3'(H) STONE  
STRONG PRECAST ENGINEERED  
BLOCKS OR APPROVED EQUAL (TYP.)

**GENERAL NOTES**

1. CONTRACTOR TO PROVIDE SITE SPECIFIC FINAL DRAWING DETAILING BLOCK TYPE AND PLACEMENT. DRAWING TO INCLUDE THE STREAM WITH DISTANCES OF BLOCKS/PAD TO THE BANKS, LENGTH OF WATERCOURSE BEING SPANNED AND ANY OTHER INFORMATION TO ENSURE COMPLIANCE WITH THE USACE BMPS.
2. ENSURE COMPLIANCE WITH THE PROJECT SWPCP; APPENDIX G OF USACE CT GENERAL PERMIT STREAM CROSSING BMPS; AND REQUIREMENTS OF USACE/CT GP-6, DATED 12/15/2021. LOCATION OF REDUNDANT SEDIMENT CONTROL SUBJECT TO CHANGE BASED ON FIELD CONDITIONS.
3. FINAL DESIGN TO BE VERIFIED AND APPROVED BY UI.
4. BLOCKS TO BE INSTALLED PER MANUFACTURERS SPECIFICATIONS AND RECOMMENDATIONS.
5. CONTRACTOR TO PROTECT EXISTING WATERCOURSE DURING CONSTRUCTION AND RESTORE ANY DISTURBED AREA AROUND WATERCOURSE.

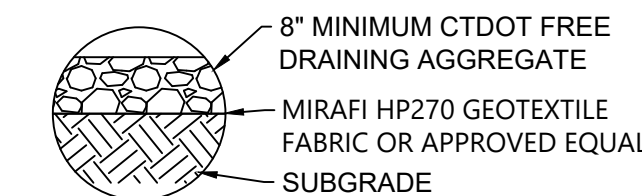

**PERMANENT ACCESS ROAD SECTION**

**DC15 - Sta. -0+00 to 1+20**

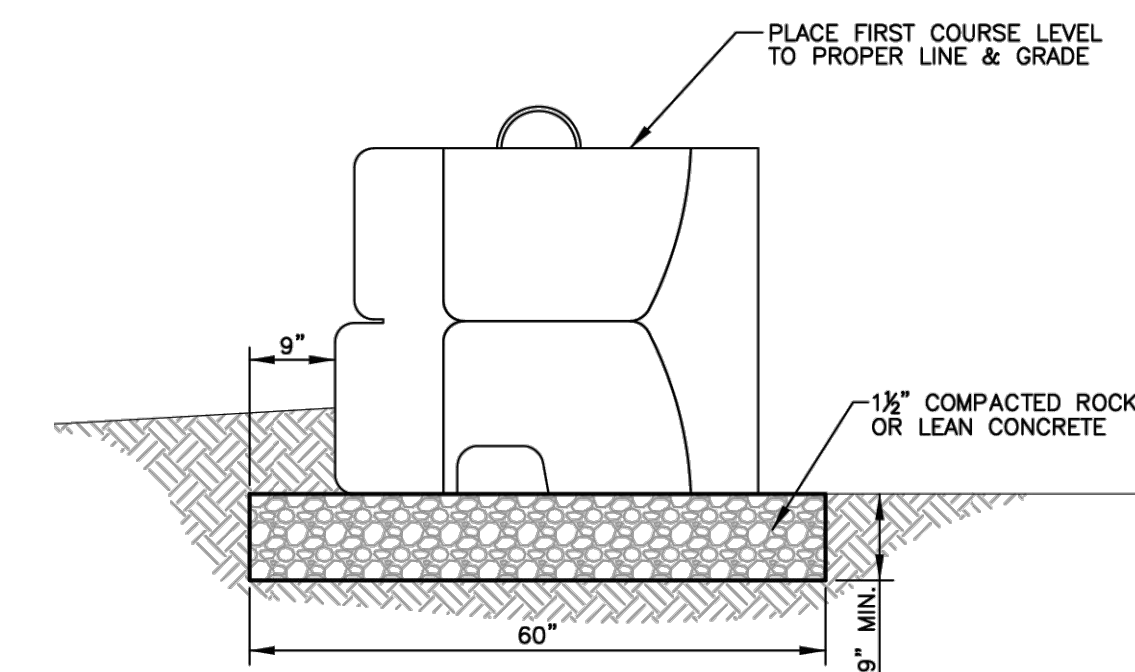
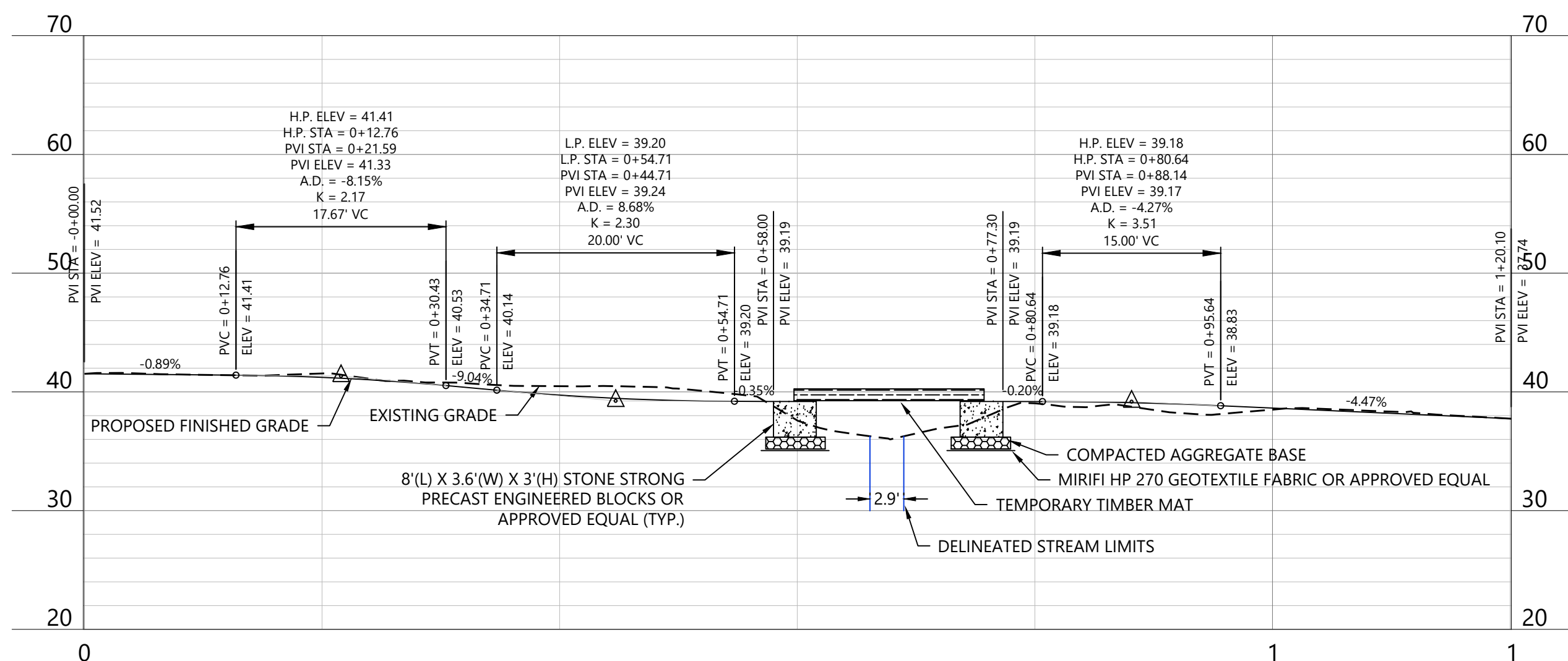

NOTE: BEARING CONDITIONS SHALL BE OBSERVED BY THE SITE GEOTECHNICAL ENGINEER. BASE DIMENSIONS MAY BE INCREASED TO ADDRESS DEFICIENT SOIL BEARING CONDITIONS.

\*FOR WALL HEIGHTS OF 6' OR LESS, BASE THICKNESS MAY BE REDUCED TO 6".

NOTE: WALL BASE SHALL NOT IMPACT STREAM OR STREAM BANKS

**24SF WALL BASE**  
NOT TO SCALE

**STONE STRONG BLOCK EXAMPLE**  
VIA STONESTRONG.COM

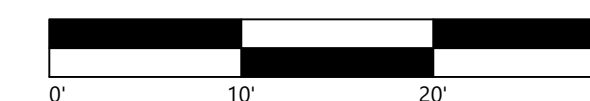

PLAN	DATE

**Westwood Surveying & Engineering**  
1684 South Road Street, Suite #300  
Landale, PA 19446  
Phone: (857) 937-5150  
Fax: (857) 937-8822  
Toll Free: (888) 937-5150  
www-pc.com  
Westwood Surveying and Engineering, P.C.

PROFILE	DATE

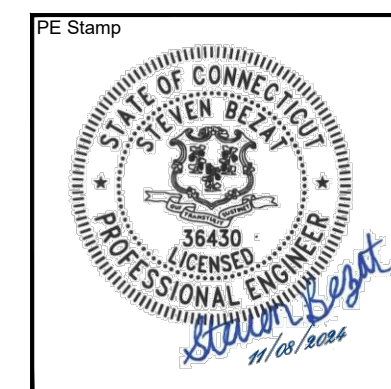

<b>AVANGRID ENGINEERING</b> CONFIDENTIAL, PROPRIETARY and TRADE SECRET INFORMATION Property of AVANGRID				
0-0 REV. DATE 11/08/2024 WESTWOOD	ISSUE FOR CONSTRUCTION DESCRIPTION	DR. SFB CK. JRD APP. MSP	SCALE AS SHOWN FILE: 1500U-T88005A-1-89005B-1-698.dwg NO. 1500U-T88005A-1-89005B-1-698	

<b>UI 115-kV RR PROJECT MILVON TO WEST RIVER</b> <b>DC15 DRAINAGE CROSSING</b> 75 OF 75	
DR. SFB CK. JRD APP. MSP	REV. 0-0

CADD Drawing, DO NOT REVISE MANUALLY.

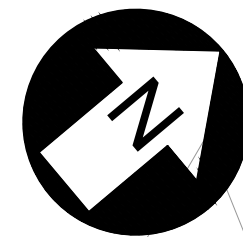

PLAN	SURVEYED	REVIEWED	ROW	CHKD
NOTEBOOK NO.				
BY	DATE			

**Westwood Surveying & Engineering**  
 Phone (951) 937-5150 1684 South Road Street, Suite #300  
 Fax (951) 937-5822 Landale, PA 19446  
 Toll Free (888) 937-5150 www.westwood.com  
 Westwood Surveying and Engineering, P.C.

PROFILE	SURVEYED	REVIEWED	NOTES REDUCED
NOTEBOOK NO.			
BY	DATE		

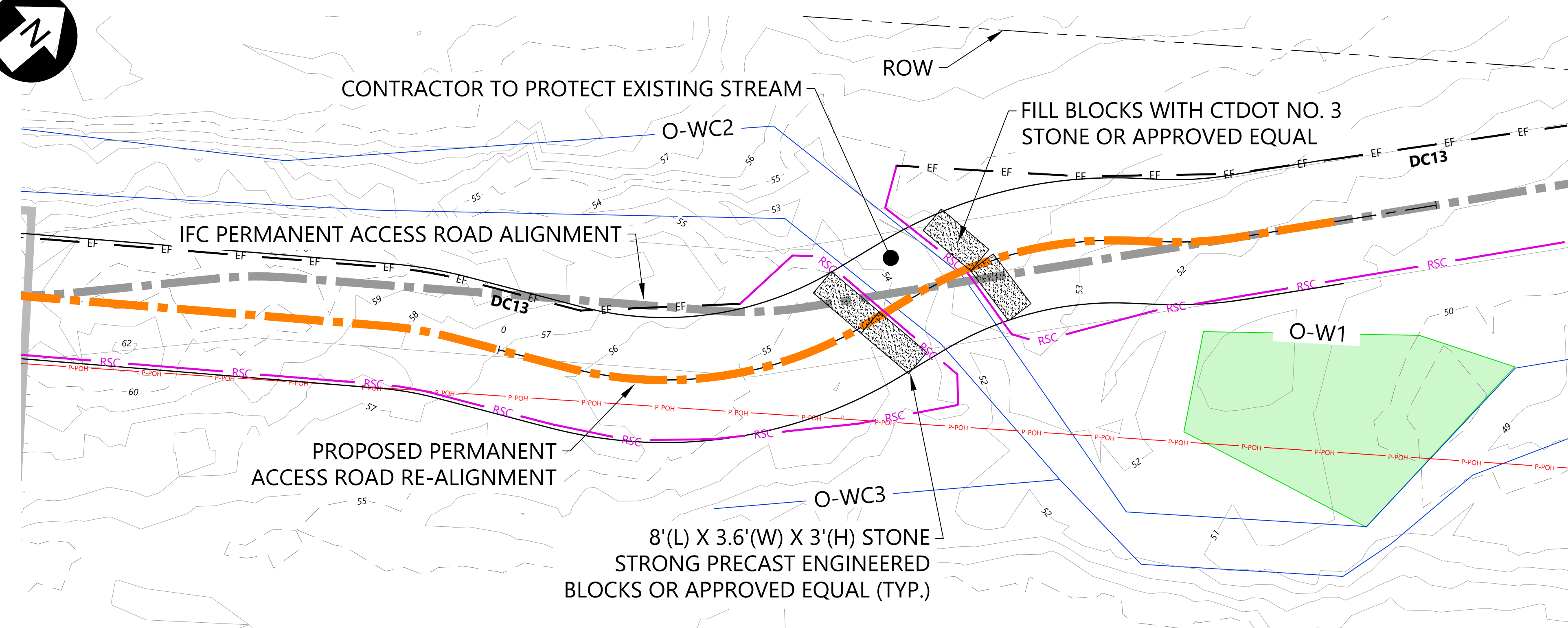

**GENERAL NOTES**

1. CONTRACTOR TO PROVIDE SITE SPECIFIC FINAL DRAWING DETAILING BLOCK TYPE AND PLACEMENT. DRAWING TO INCLUDE THE STREAM WITH DISTANCES OF BLOCKS/PAD TO THE BANKS, LENGTH OF WATERCOURSE BEING SPANNED AND ANY OTHER INFORMATION TO ENSURE COMPLIANCE WITH THE USACE BMPS.
2. ENSURE COMPLIANCE WITH THE PROJECT SWPCP; APPENDIX G OF USACE CT GENERAL PERMIT STREAM CROSSING BMPS; AND REQUIREMENTS OF USACE/CT GP-6, DATED 12/15/2021. LOCATION OF REDUNDANT SEDIMENT CONTROL SUBJECT TO CHANGE BASED ON FIELD CONDITIONS.
3. FINAL DESIGN TO BE VERIFIED AND APPROVED BY UI.
4. BLOCKS TO BE INSTALLED PER MANUFACTURERS SPECIFICATIONS AND RECOMMENDATIONS.
5. CONTRACTOR TO PROTECT EXISTING WATERCOURSE DURING CONSTRUCTION AND RESTORE ANY DISTURBED AREA AROUND WATERCOURSE.

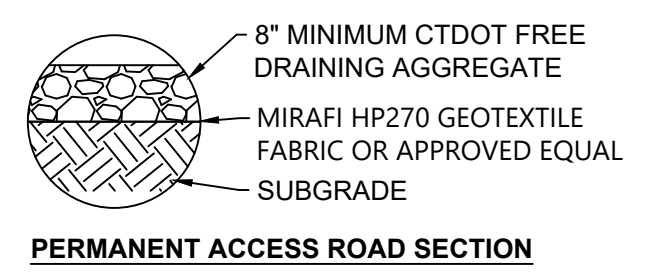

**DC13 - Sta. -0+00 to 1+30**

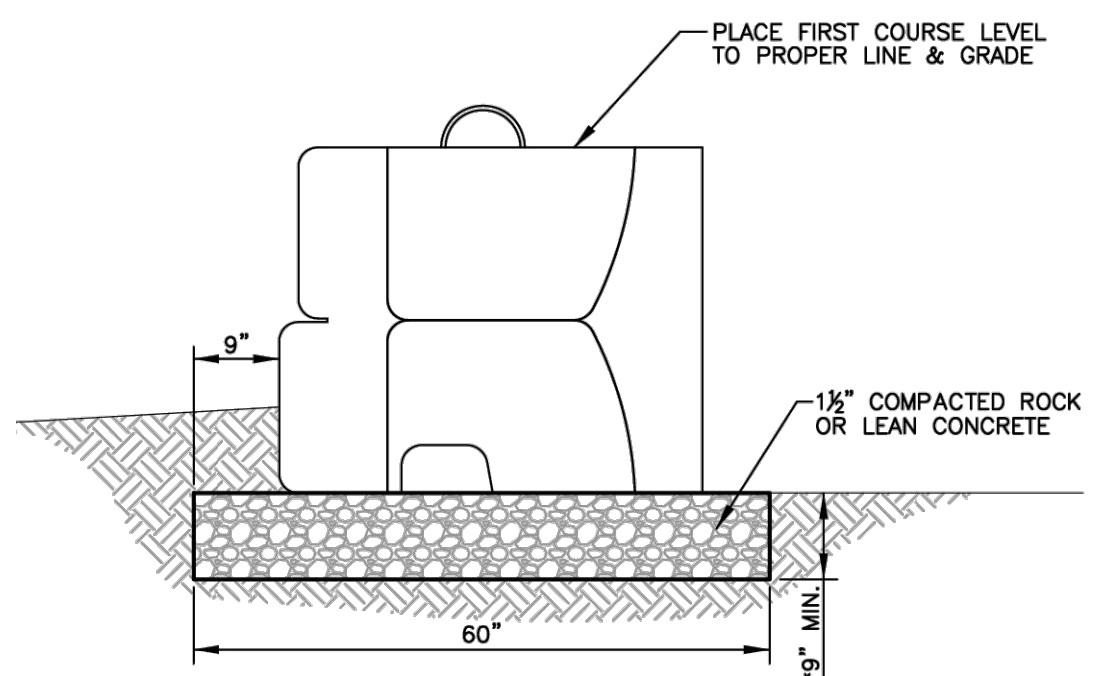
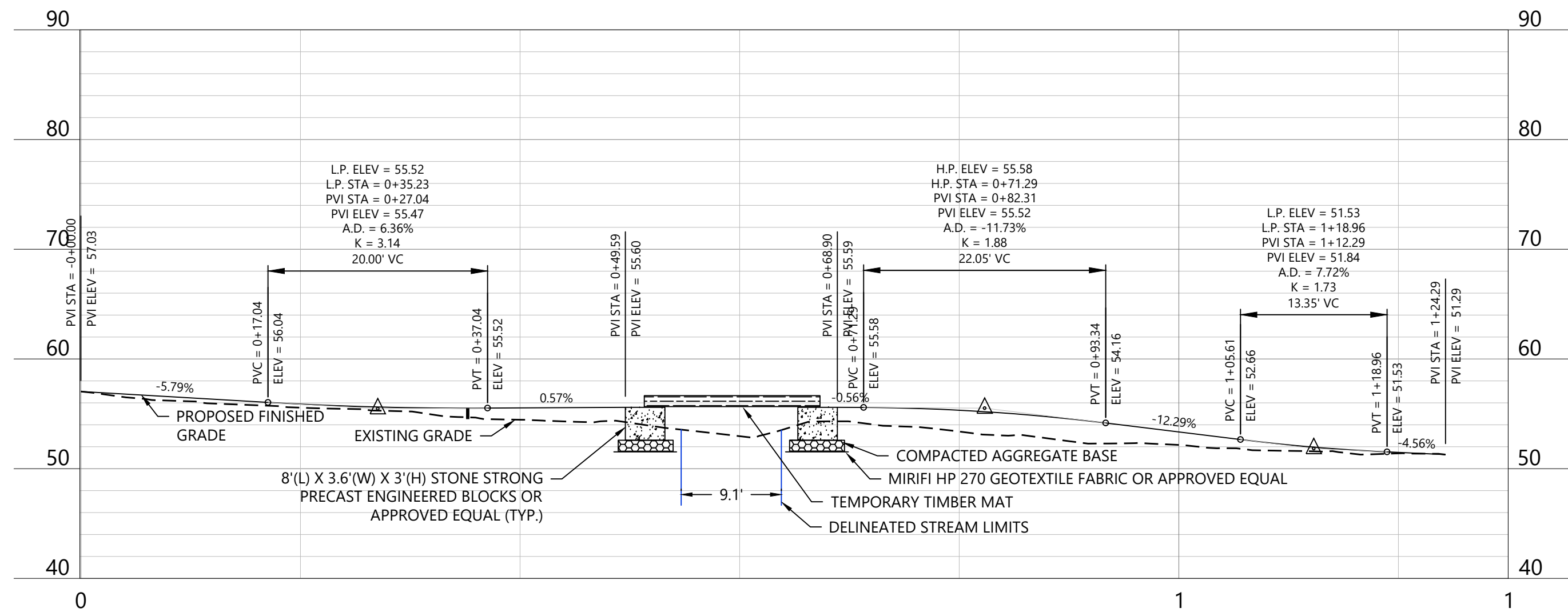

NOTE: BEARING CONDITIONS SHALL BE OBSERVED BY THE SITE GEOTECHNICAL ENGINEER. BASE DIMENSIONS MAY BE INCREASED TO ADDRESS DEFICIENT SOIL BEARING CONDITIONS.  
 \*FOR WALL HEIGHTS OF 6' OR LESS, BASE THICKNESS MAY BE REDUCED TO 6".  
 NOTE: WALL BASE SHALL NOT IMPACT STREAM OR STREAM BANKS.

**24SF WALL BASE**  
NOT TO SCALE

**STONE STRONG BLOCK EXAMPLE**  
VIA STONESTRONG.COM

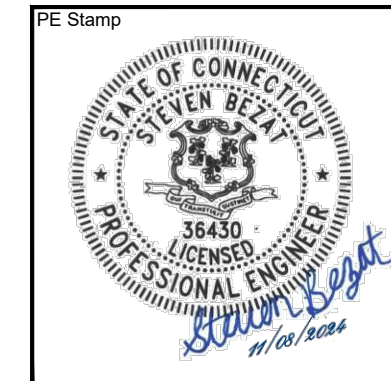
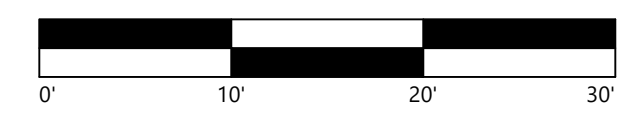

AVANGRID ENGINEERING CONFIDENTIAL, PROPRIETARY and TRADE SECRET INFORMATION Property of AVANGRID			
REV.	DATE	BY	DESCRIPTION
0-0	11/08/2024	WESTWOOD	ISSUE FOR CONSTRUCTION
APP.	MSP		

UI 115-kV RR PROJECT MILVON TO WEST RIVER DC13 DRAINAGE CROSSING	
74 OF 75	
DR.	SFB
CK.	JRD
APP.	MSP
DATE:	
SCALE:	AS SHOWN
FILE:	1500U-T88005A-1-89005B-1-697.dwg
NO.	
1500U-T88005A-1-89005B-1-697	REV. 0-0

ANSI D CADD Drawing. DO NOT REVISE MANUALLY.

Thank you for your attention and cooperation.

Sincerely,

A handwritten signature in dark ink, appearing to read "Melanie A. Bachman". The signature is fluid and cursive, with a long horizontal stroke at the end.

Melanie A. Bachman  
Executive Director

MB/MP

c: Paul Kenline, Project Manager, The United Illuminating Company ([pkenline@uinet.com](mailto:pkenline@uinet.com))