

1 OVERALL LOCUS MAP
 CP-1 SCALE: 1" = 150'-0"

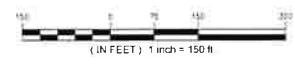





567 VALUXHALL STREET EXTENSION - SUITE 311
 WATERFORD, CT 06385 PHONE: (860) 663-1697
 WWW.ALLPOINTSTECH.COM FAX: (860) 663-0935

CSC PERMIT SET		
NO.	DATE	REVISION
0	06/07/21	FOR REVIEW: KAM
1		
2		
3		
4		
5		
6		

DESIGN PROFESSIONAL OF RECORD

PROF: KEVIN A. MCCAFFERY, P.E.
 COMP: ALL-POINTS TECHNOLOGY CORPORATION, P.C.
 ADD: 567 VALUXHALL STREET EXTENSION - SUITE 311
 WATERFORD, CT 06385

OWNER: NEWTON FAMILY TRUST CO
 ADDRESS: 1279 ARBUTUS ST
 DURHAM, CT 06422

HADDAM QUARTER SOLAR, LLC

SITE: JOHNSON LANE
 ADDRESS: DURHAM, CT

APT FILING NUMBER: CT671100

DATE: 06/07/21

DRAWN BY: JT
 CHECKED BY: KAM

SHEET TITLE:

OVERALL LOCUS MAP

SHEET NUMBER:

OP-1





ALL-POINTS TECHNOLOGY CORPORATION
 587 VAUXHALL STREET EXTENSION - SUITE 311
 WATERFORD, CT 06385 PHONE: (860)-663-1697
 WWW.ALLPOINTSTECH.COM FAX: (860)-663-0935

CSC PERMIT SET

NO.	DATE	REVISION
0	06/07/21	FOR REVIEW: KAM
1		
2		
3		
4		
5		
6		

DESIGN PROFESSIONAL OF RECORD
 PROF: KEVIN A. MCCAFFERY, P.E.
 COMP: ALL-POINTS TECHNOLOGY CORPORATION, P.C.
 ADD: 587 VAUXHALL STREET EXTENSION - SUITE 311 WATERFORD, CT 06385
 OWNER: NEWTON FAMILY TRUST CO
 ADDRESS: 1279 ARBUTUS ST DURHAM, CT 06422

HADDAM QUARTER SOLAR, LLC
 SITE: JOHNSON LANE
 ADDRESS: DURHAM, CT
 APT FILING NUMBER: CT671100
 DATE: 06/07/21
 DRAWN BY: JT
 CHECKED BY: KAM

SHEET TITLE:
 SITE & UTILITY PLAN

SHEET NUMBER:
 SP-1

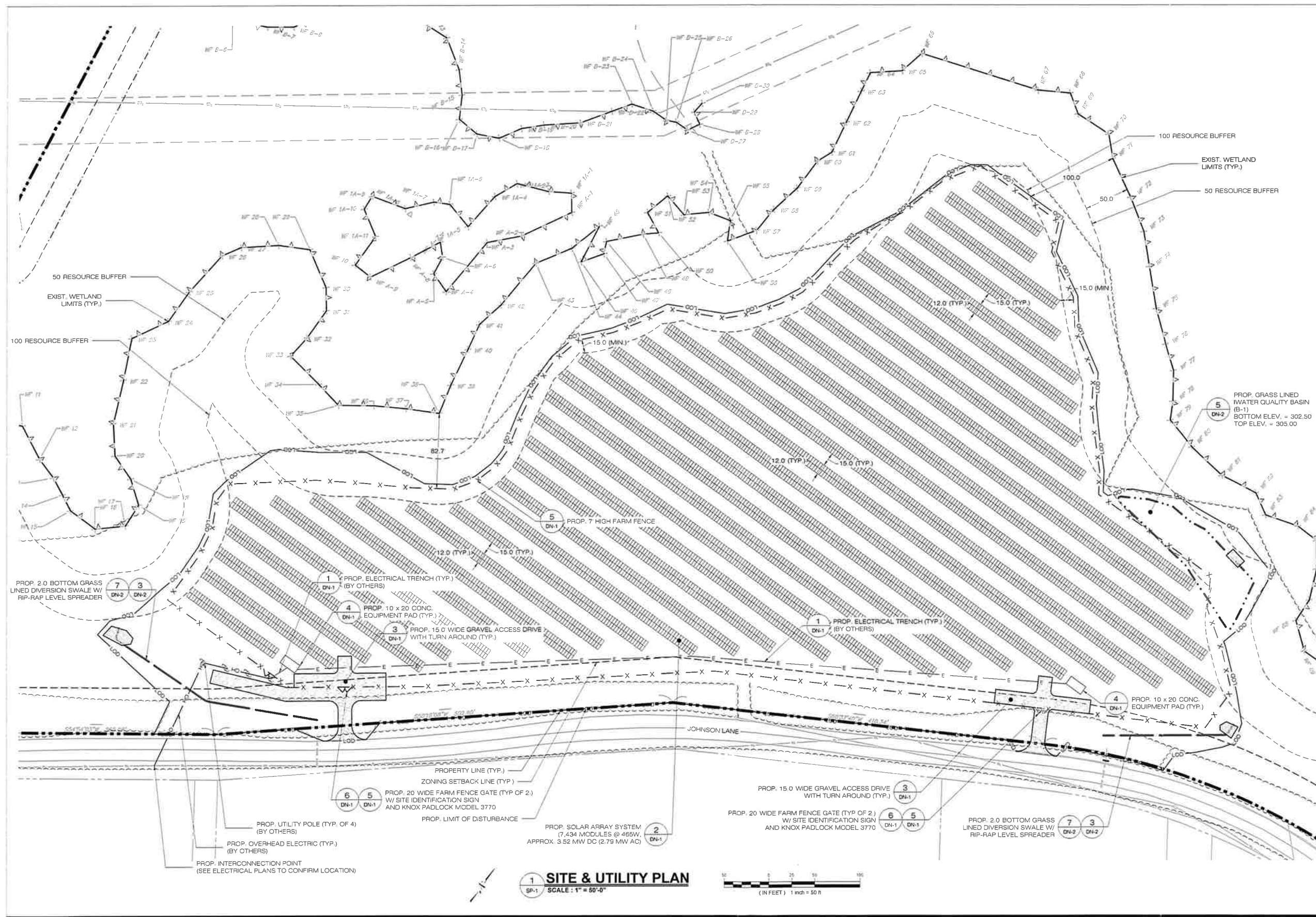

1 SITE & UTILITY PLAN
 SCALE: 1" = 50'-0"

