

Prattville, Alabama.; Mr. H. C. Cobb, Jr.

Received the following in 1938; 10 FP616, 25 MAY C. mollissima  
 in 1936; 30 MQ C. mollissima.

See diagram below, 26 survivors of 1938 stock, 2 of the 1936

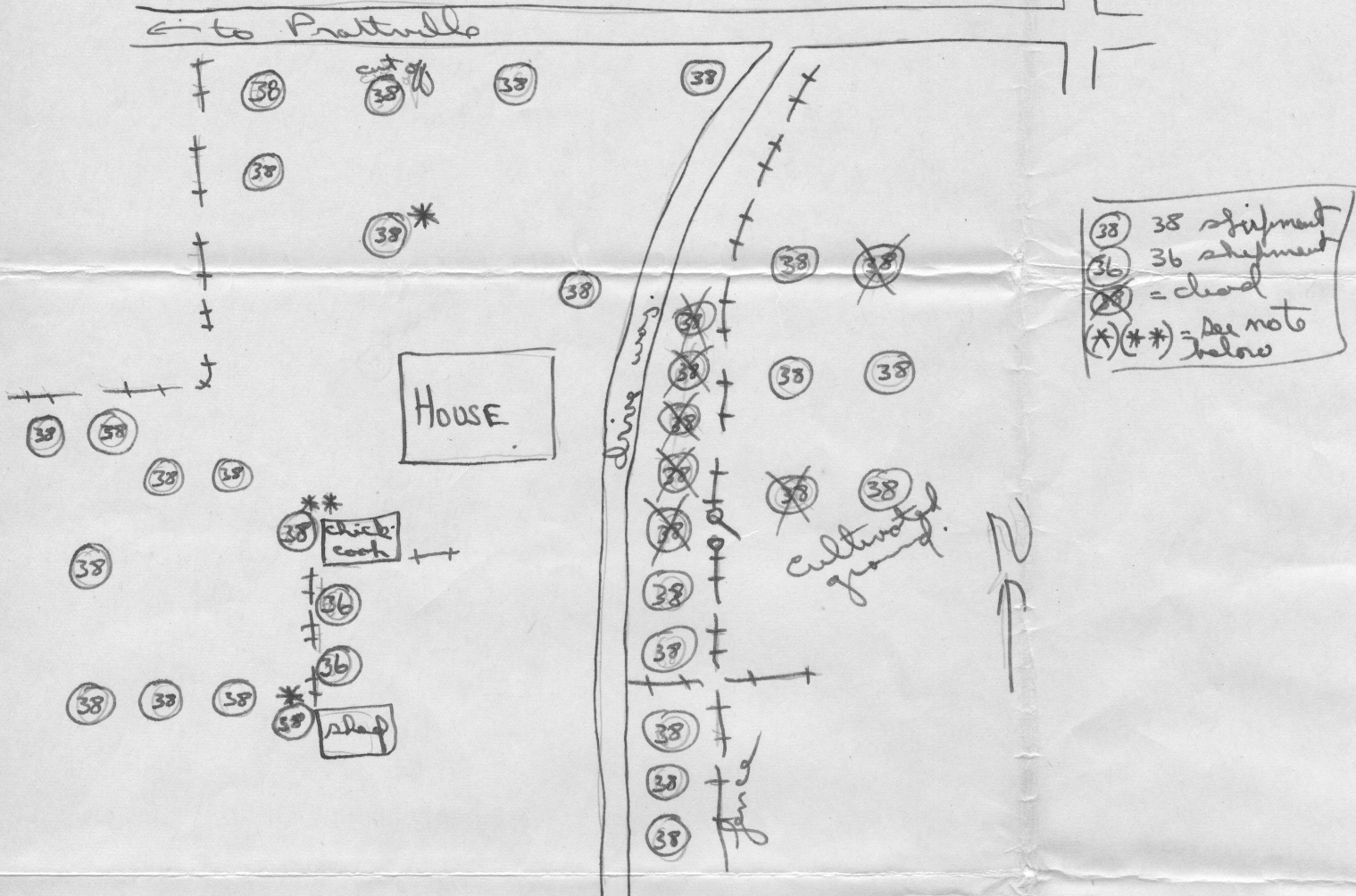

The trees planted to the east of the house in the cultivated land are making fair growth. The soil here and elsewhere around the house is sandy loam. The trees along the fence have been injured but are doing fair also. Those in the orchard west of the house are mostly surviving by sprouts, which however seem vigorous. The trees in front of the house are making good growth. Those that have been mulched are better than the others. Trees marked (\*) are better than average, having made about a three foot growth this year and are 2" in diameter. The tree marked (\*\*) has made about 5 feet of growth this year, is now about 7 feet tall and 3" in diameter. Produced nuts this year. This tree has received water from chicken pen. Only 2 trees of the 1936 shipment survive. This lot came too late in the season. The two survivors are doing very poorly.

Bowen S. Crandall  
 December 6, 1939