

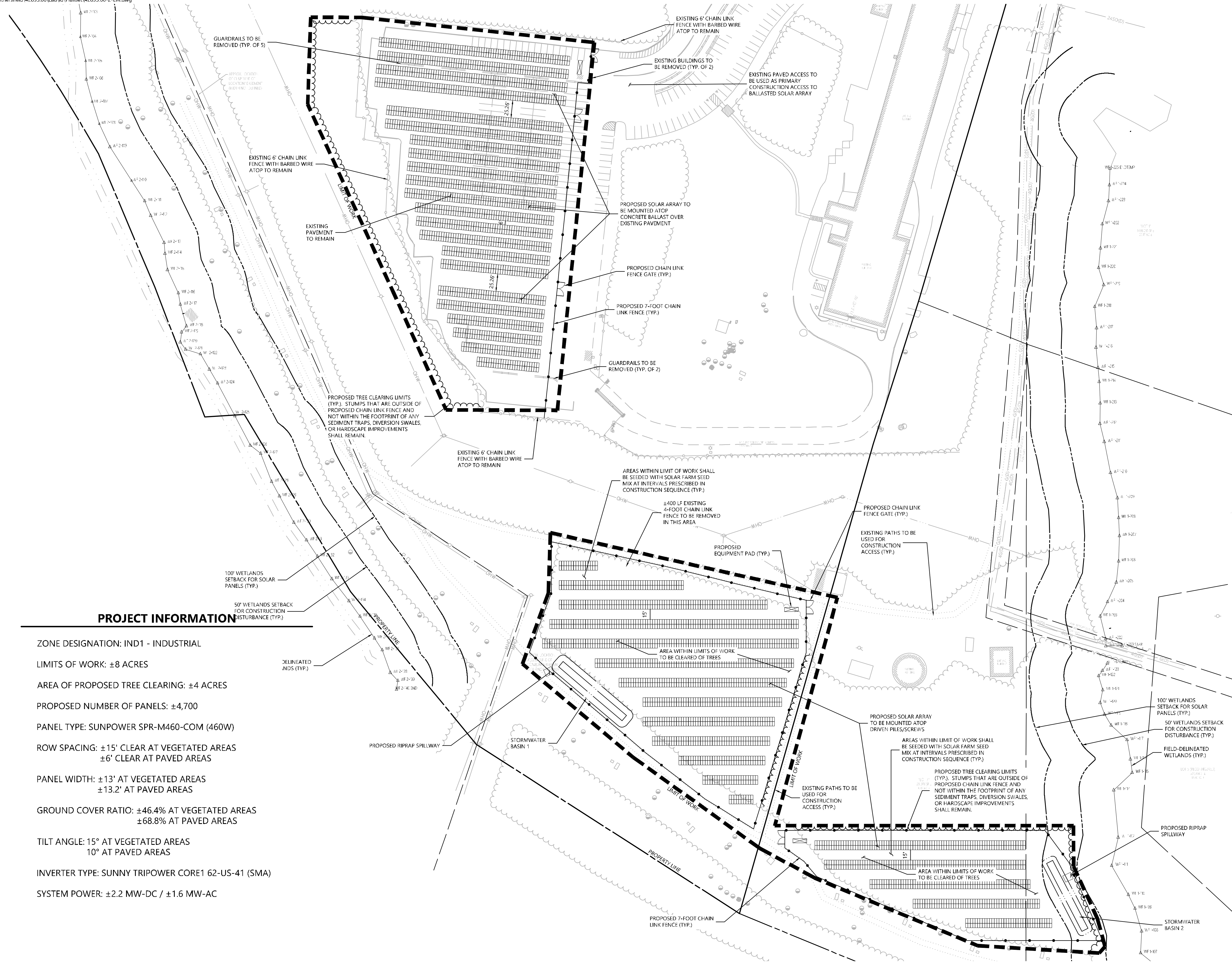

100 Great Meadow Road
Suite 200
Wethersfield, CT 06109
860.807.4300



PROJECT INFORMATION

- ZONE DESIGNATION: IND1 - INDUSTRIAL
- LIMITS OF WORK: ±8 ACRES
- AREA OF PROPOSED TREE CLEARING: ±4 ACRES
- PROPOSED NUMBER OF PANELS: ±4,700
- PANEL TYPE: SUNPOWER SPR-M460-COM (460W)
- ROW SPACING: ±15' CLEAR AT VEGETATED AREAS
±6' CLEAR AT PAVED AREAS
- PANEL WIDTH: ±13' AT VEGETATED AREAS
±13.2' AT PAVED AREAS
- GROUND COVER RATIO: ±46.4% AT VEGETATED AREAS
±68.8% AT PAVED AREAS
- TILT ANGLE: 15° AT VEGETATED AREAS
10° AT PAVED AREAS
- INVERTER TYPE: SUNNY TRIPOWER CORE1 62-US-41 (SMA)
- SYSTEM POWER: ±2.2 MW-DC / ±1.6 MW-AC

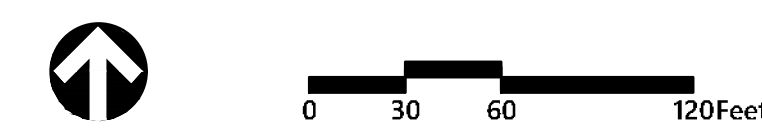

Photovoltaic Installation
1 Hamilton Ave
Windsor Locks, Connecticut

No.	Revision	Date	App'd.

Designed by: DRB Checked by: SJK
 Issued for: Application Date: October 10, 2022

Not Approved for Construction
Layout and Materials Plan

C-2.0

Sheet 2 of 6

Project Number: 42893.00