

**ADJACENT PROPERTY OWNERS**

PETITIONER: WATERTOWN SOLAR ONE, LLC AND VCP, LLC D/B/A/ VEROGY

OWNER: CATHOLIC CEMETERY ASSOCIATION OF THE ARCHDIOCESE OF  
HARTFORD, 700 MIDDLETOWN AVENUE, NORTH HAVEN, CT 06473

	<b>Property Address</b>	<b>Owner's and Mailing Address</b>
1.	669 Platt Road	Catholic Cemeteries Association 669 Platt Road Watertown, CT 06795
2.	664 Platt Road	Michael Stankus and Mary Spillane 664 Platt Road Watertown, CT 06795
3.	662 Platt Road	John Cipriano, Jr. 662 Platt Road Watertown, CT 06795
4.	680 Platt Road	Ronald and Susan Cipriano 680 Platt Road Watertown, CT 06795
5.	636 Platt Road	Mark and Marcia Werenko 636 Platt Road Watertown, CT 06795
6.	532 Platt Road	Earl Taylor, Jr. 532 Platt Road Watertown, CT 06795
7.	516 Platt Road	Dorothy Labonne 516 Platt Road Watertown, CT 06795
8.	457 Platt Road	Daniel and Sarah Moreira 457 Platt Road Watertown, CT 06795
9.	441 Platt Road	Edward and Katherine Rasmussen 441 Platt Road Watertown, CT 06795

	<b>Property Address</b>	<b>Owner's and Mailing Address</b>
10.	371 Platt Road	Jessie M. Carey 371 Platt Road Watertown, CT 06795
11.	470 Platt Road	Neil Sutton 470 Platt Road Watertown, CT 06795
12.	860 Guernseytown Road	Deluca Crescenzo 860 Guernseytown Road Watertown, CT 06795
13.	44 Hinman Road	Pamela and Kyle Kahuda 44 Hinman Road Watertown, CT 06795
14.	62 Hinman Road	Daniela and Michelle Jurkiewicz 62 Hinman Road Watertown, CT 06795
15.	72 Hinman Road	Marc and Patricia Glusto 72 Hinman Road Watertown, CT 06795
16.	86 Hinman Road	Bryant and Samantha Langdeau 86 Hinman Road Watertown, CT 06795
17.	100 Hinman Road	Alicia and Peter Maddox 100 Hinman Road Watertown, CT 06795
18.	279 Hinman Road	Renee Hodge 279 Hinman Road Watertown, CT 06795
19.	120 Hinman Road	Lillian Fontan-Oguendo 120 Hinman Road Watertown, CT 06795
20.	129 Hinman Road	Carl and Elaine Carlson 129 Hinman Road Watertown, CT 06795

**CERTIFICATION OF SERVICE**

I hereby certify that a copy of the foregoing letter was sent by certified mail, return receipt requested, to each of the parties on the attached list of abutting landowners.

June 30, 2020

Date



\_\_\_\_\_  
Kenneth C. Baldwin, Esq.  
Robinson & Cole LLP  
280 Trumbull Street  
Hartford, CT 06103

Attorneys for WATERTOWN SOLAR ONE, LLC  
AND VCP, LLC D/B/A VEROGY

KENNETH C. BALDWIN

280 Trumbull Street  
Hartford, CT 06103-3597  
Main (860) 275-8200  
Fax (860) 275-8299  
kbaldwin@rc.com  
Direct (860) 275-8345

Also admitted in Massachusetts  
and New York

June 30, 2020

*Via Certified Mail, Return Receipt Requested*

«Name\_and\_Address»

**Re: Watertown Solar One, LLC and VCP, LLC d/b/a Verogy – Notice of Intend to File a Petition for Declaratory Ruling for the Construction, Operation and Maintenance of a Solar Photovoltaic Electric Generating Facility, 669 Platt Road, Watertown, Connecticut – Adjacent Property Owner Notice**

Dear «Salutation»:

Pursuant to the provisions of §16-50j-40(a) of the Regulations of Connecticut State Agencies, this letter serves as notice that Watertown Solar One, LLC and VCP, LLC d/b/a Verogy (“Verogy”) intend to file a Petition for Declaratory Ruling (“Petition”) with the Connecticut Siting Council (“Council”) on or about July 6, 2020, seeking approval of the construction, operation and maintenance of a 1.975 megawatt (MW) AC solar generating facility, including all associated equipment, related site improvements and interconnection (the “Project”). The Project would be located on an approximately 16.6-acre portion of a larger 154-acre site, consisting of two (2) separate parcels to the west of Platt Road in Watertown, Connecticut (the “Property”). The Property is owned by the Catholic Cemeteries Association of the Archdiocese of Hartford and is bounded by Platt Road to the east, Hinman Road to the north and residential/agricultural land to the south and west. The town boundary between Watertown and the Towns of Woodbury and Bethlehem, Connecticut are located within 2,500 feet of the Project boundary.

The Project would consist of the installation of photovoltaic panels, centralized inverters and transformers, electrical lines, an electric transformer, a station controller, a perimeter fence and access roads. For additional details regarding the location of the Property and the layout of site improvements, please see the attached Project Plans.

June 30, 2020  
Page 2

Pursuant to the provisions of Connecticut General Statutes § 16-50g *et seq.*, the location of certain Project features may change as this Petition proceeds through the Council's regulatory review process.

If you have any questions, please feel free to contact me. My contact information is provided above. You may also contact the Council directly at 860-827-2935.

Respectfully,

A handwritten signature in black ink, appearing to read "Kenneth C. Baldwin", with a long horizontal flourish extending to the right.

Kenneth C. Baldwin, Esq.

KCB/kmd  
Attachment

WATERTOWN SOLAR ONE, LLC  
150 TRUMBULL STREET  
HARTFORD, CT, 06103



ALL POINTS TECHNOLOGY CORPORATION  
TECHNOLOGY CORPORATION  
150 TRUMBULL STREET, HARTFORD, CONNECTICUT 06103  
WWW.ALLPOINTSTECH.COM TEL: 860.633.1818

NO	DATE	REVISION
1		PREPARED FOR REVIEW RFP
2		
3		
4		
5		

CIC PERMIT SET

DESIGN PROFESSIONAL OF RECORD  
RFP# 00000000000000000000  
COMP: ALL-POINTS TECHNOLOGY CORPORATION  
ADDRESS: EXTENSION - STREET 311 WATERFORD, CT 06395  
PROJECT: WATERTOWN SOLAR ONE  
ADDRESS: 150 TRUMBULL STREET  
WATERTOWN, CT 06103

WATERTOWN SOLAR ONE, LLC  
SITE: 150 TRUMBULL STREET  
ADDRESS: WATERTOWN, CT 06103  
APR FILING NUMBER: 030303  
DRAWN BY: CHM  
DATE: 03/03/2010  
CHECKED BY: RJP

SHEET TITLE:  
OVERALL LOCUS MAP

SHEET NUMBER:  
OP-0

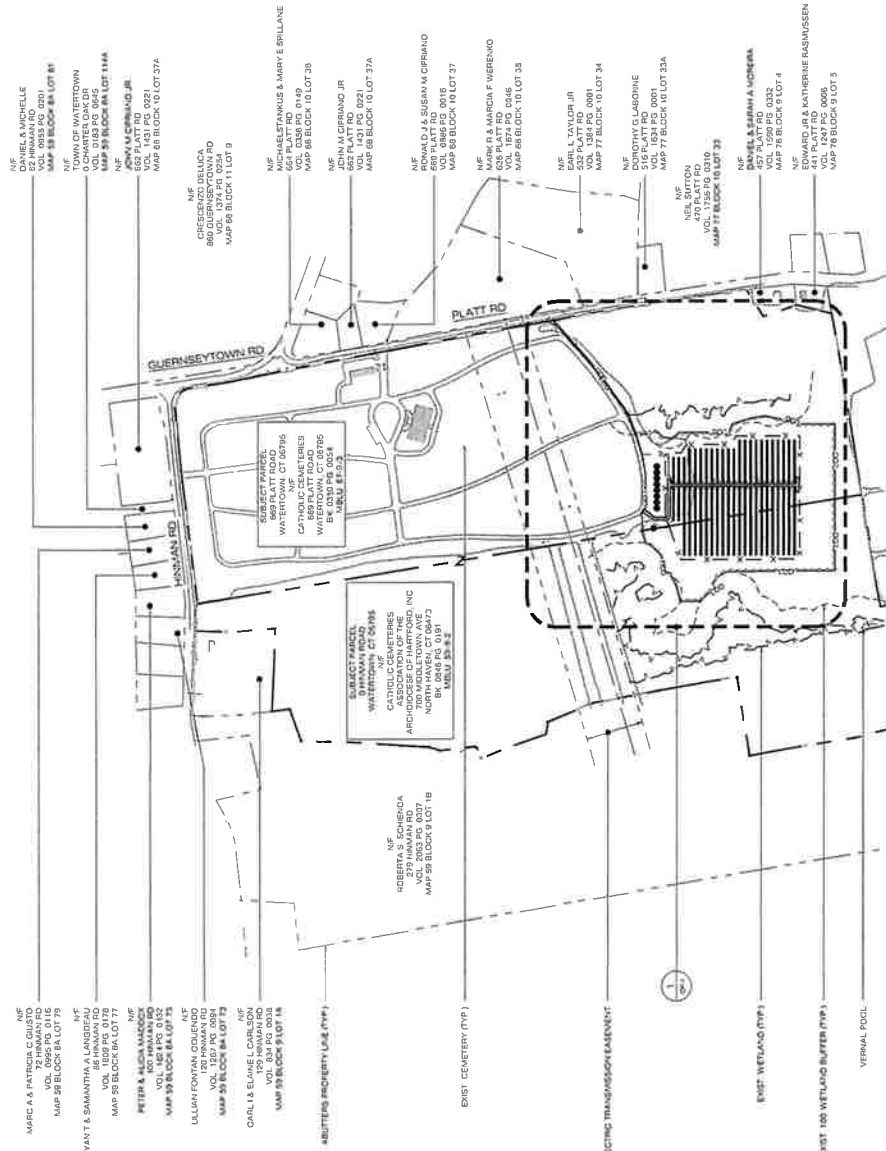

N/E  
TRUSTEE OF THE HENRY L  
& JUDY PLATT FID  
VOL 1089 PG 0093  
MAP 70 BLOCK 9 LOT 6



OVERALL LOCUS MAP  
SCALE: 1\"/>

1/4"

